

position A  
position B  
position C  
position D  
position E

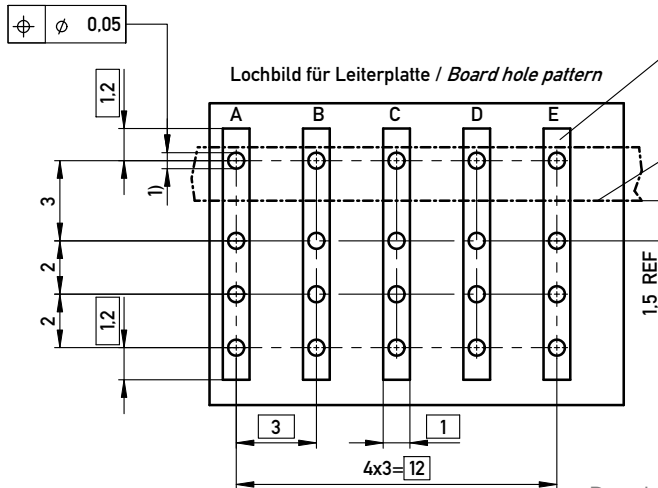

Dieser Bereich muß gleiches Potential auf LP-Oberfläche haben.  
*This area must have same electrical potential on surface of PCB*

Oberkante Tochterkarte  
*to surface of daughtercard REF*

1)  $\varnothing 0,6 \pm 0,05$  Durchmesser des metallisierten Loches  
 $\varnothing 0,6 \pm 0,05$  Diameter of finished plated-through hole

Schichtaufbau im metallisierten Loch siehe Zeichnung 114406 oder 164062 Nr.1  
*Metal plating of plated-through hole see drawing 114406 or 164062 no.1*

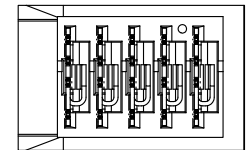
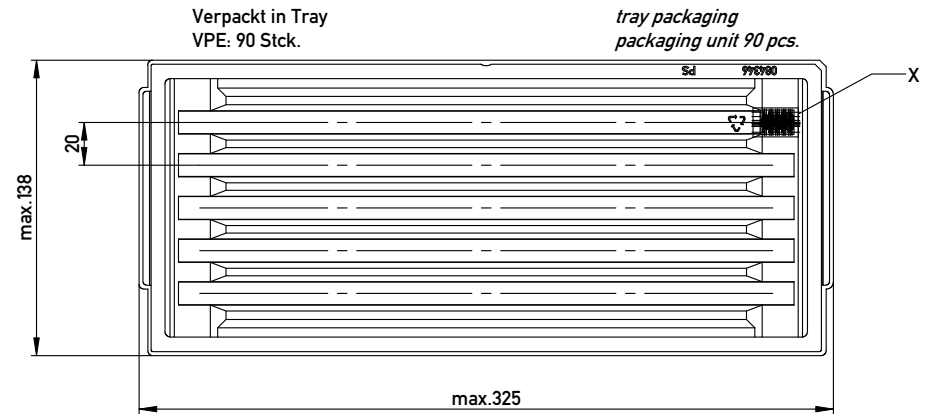
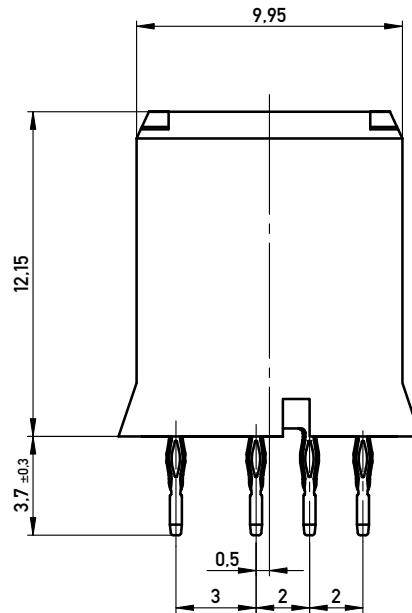

DETAIL X  
MAßSTAB 2 : 1

Gehäuse / housing:  
Kontakte / contacts:

PBTP grau 30% GF / PBTP gray 30 %GF  
Phosphor Bronze / phosphor bronze

Oberflächenbeschichtung / plating:  
Kontaktbereich / mating area:  
Anschlussbereich / termination:

2-3  $\mu$ m Ni 1.2  $\mu$ m Au  
2-3  $\mu$ m Ni 1  $\mu$ m Sn matt

Bedruckungsvorschrift siehe Id.-Nr. 294997 /  
printingcode Id.-No. 294997

Anforderungsstufe 1  
class 1

Information:		Tolerances	All Dimensions in mm	Scale	5:1
All rights reserved. Only for Information. To ensure that this is the latest version of this drawing, please contact one of the ERNI companies before using.		Subject to modification without prior notice. Drawing will not be updated.		Designation	
www.ERNI.com		www.ERNI.com		ERmet Federl. PM 5 Pol RC ERmet Female PM 5 Pin RC	
Index		Date		244995	
18.09.2007		Date		1	
Date		Date		A3	
Class				ERMPM	

单击下面可查看定价，库存，交付和生命周期等信息

[>>ERNI](#)