

PVA Short Stroke Key Switches

Features/Benefits

- Compact design
- Short stroke to latch
- Wide variety of actuator heights
- Adapted for medium power applications
- RoHS compliant and compatible

Typical Applications

- Automotive (air conditioning, lighting)
- Industrial
- Control panel

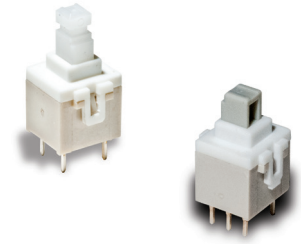

Construction

FUNCTION: Momentary, Push-Push

CONTACT ARRANGEMENT:

PVA1: 2 make contacts (DPST)

PVA2: 2 change over contacts (DPDT)

SWITCHING MODE: Non-shorting

TERMINALS: PC pins¹

Mechanical

TOTAL TRAVEL / LATCHING TRAVEL:

OA: 2,4 mm

EE: 2,4 / 1,5 mm

ELECTRICAL TRAVEL: 0.8 mm (1.1 for PVA2 OA H5)

OPERATING FORCE: 1,2N; 1,7N; 3,5N

Process

SOLDERABILITY:

Wave soldering, compatible with lead free soldering profile

Hand soldering, 350°C for 3 seconds

Note: Specifications listed above are for switches with standard options.

For information on specific and custom switches, please contact technical support using the "Ask a Specialist" option on the PVA product web page.[√]

Electrical

SWITCHING POWER MAX.: 3 W DC

SWITCHING VOLTAGE MAX.: 32 V DC

SWITCHING CURRENT MAX.: 100 mA DC*

DIELECTRIC STRENGTH (50 Hz / 1 min):

1000 V between open contacts, PVA2: 750 V

OPERATING LIFE:

OA (momentary): $\geq 1 \times 10^5$ operations

EE (push-push): $\geq 1 \times 10^5$ operations

CONTACT RESISTANCE: Initial $\leq 100 \text{ m}\Omega$

INSULATION RESISTANCE: $\geq 10^{10} \Omega$

BOUNCE TIME: $\leq 3 \text{ ms}$

Environmental

OPERATING TEMPERATURE: -40°C to 85°C.²

1) "Snap-in" contacts on request, Version SNA with pins bent inside (standard)

2) With button +70°C

How To Order

Our easy build-a-switch concept allows you to mix and match options to create the switch you need. To order, select desired option from each category and place it in the appropriate box. **Some of the configurations may not be available or could require some development.**

Switch

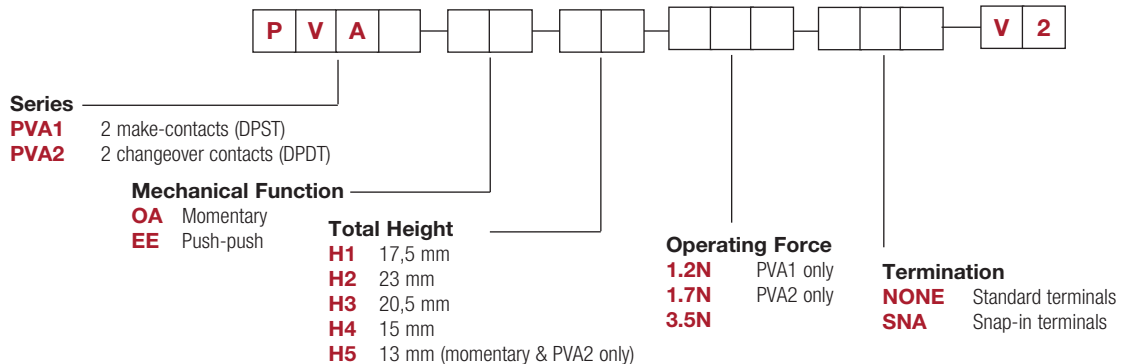

Button

Buttons must be ordered separately.
Shipped in bulk.

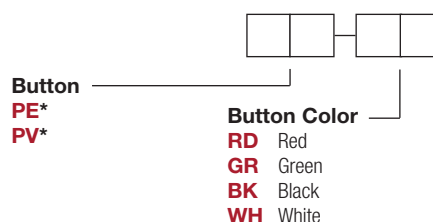

*Compatible with H1 and H3 actuator models only.

PVA Short Stroke Key Switches

SERIES

PVA1 (DPST)

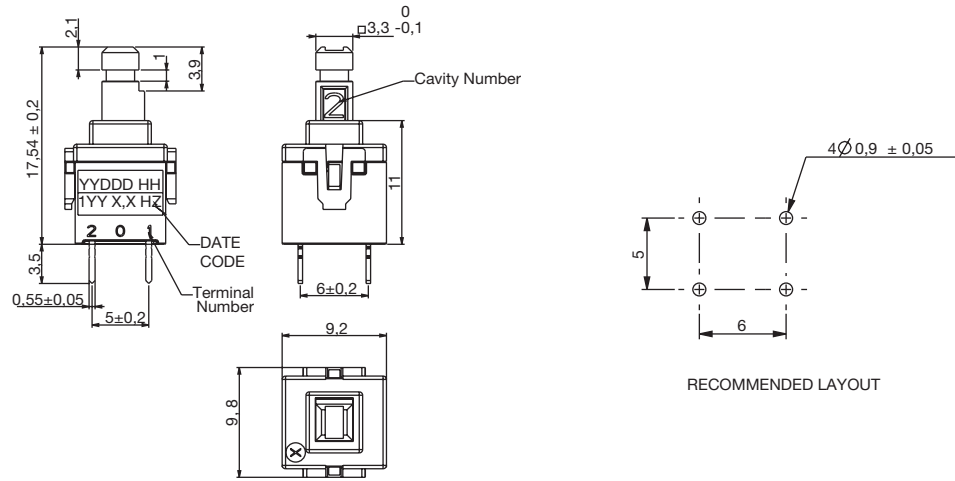

PVA2 (DPDT)

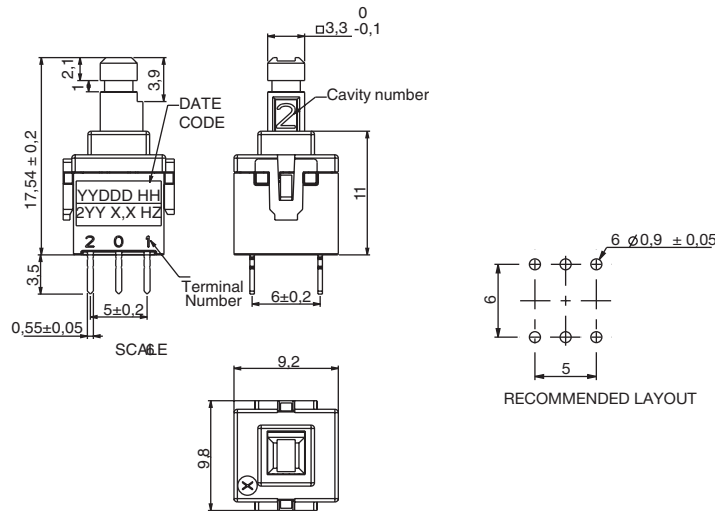
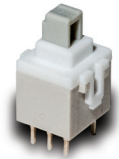

MECHANICAL FUNCTION

| OPTION CODE | FUNCTION |
|-------------|-----------|
| OA | Momentary |
| EE | Push-Push |

OA

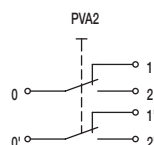
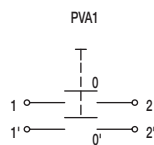

EE

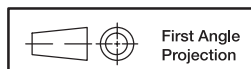
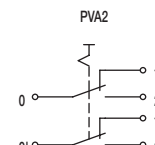
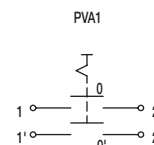

Dimensions are shown: mm
Specifications and dimensions subject to change

PVA Short Stroke Key Switches

TOTAL HEIGHT

H1 17,5 MM

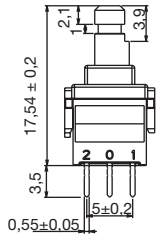

H2 23 MM

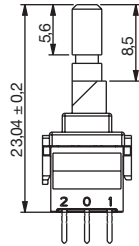

H3 20,5 MM

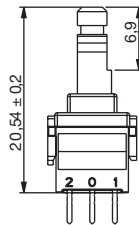

H4 15 MM

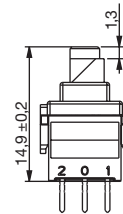

H5 13 MM
(MOMENTARY ONLY)

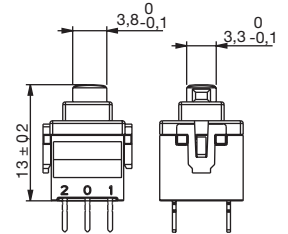

OPERATING FORCE

1.2N PVA1 ONLY
1.7N PVA2 ONLY
3.5N

TERMINATION

SNA with PVA1

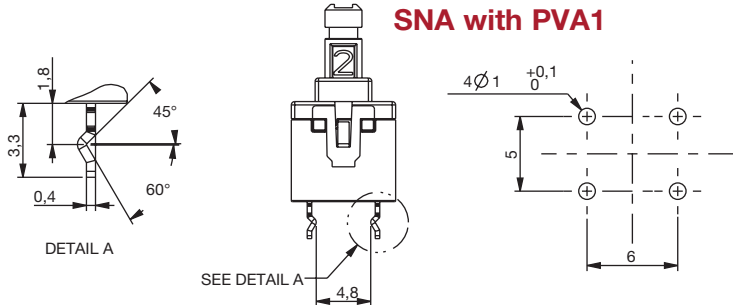

SNA with PVA2

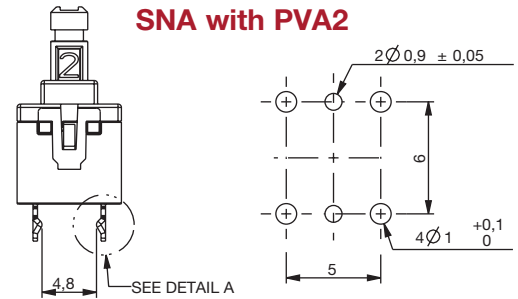

BUTTONS

BUTTONS MUST BE ORDERED SEPARATELY. SHIPPED IN BULK.

PE

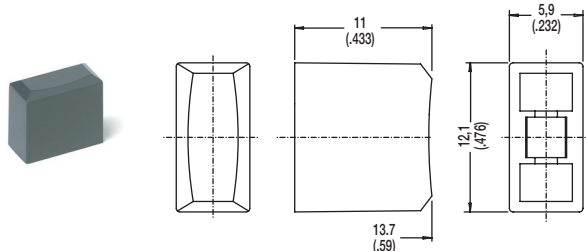

PV

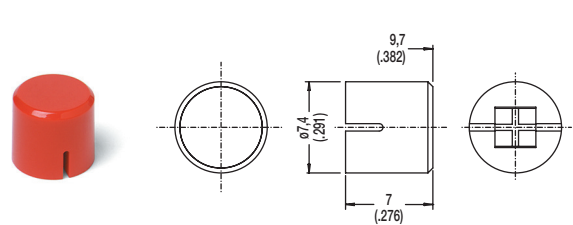

| OPTION CODE | COLOR |
|-------------|-------|
| RD | Red |
| GY | Gray |
| BK | Black |
| WH | White |



First Angle Projection

单击下面可查看定价，库存，交付和生命周期等信息

[>>C&K](#)