

THIS DOCUMENT IS SUBJECT TO CHANGE WITHOUT NOTICE. IT IS CONFIDENTIAL AND A PROPERTY OF AMPHENOL LTW. DISCLOSURE TO THIRD PARTY HAS TO BE AUTHORIZED BY AMPHENOL LTW.

REV.	ECN NO.	DATE	SIGN	DESCRIPTION
A		2023/01/10	Xiaofeng	New Initial.
B	C230410	2023/03/11	Xiaofeng	\triangle X27

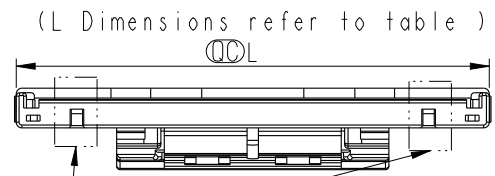

The prevention tilt insert structure is only available for 36 to 40 pin

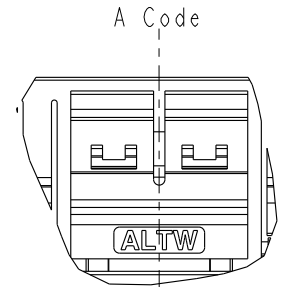

Detail: A

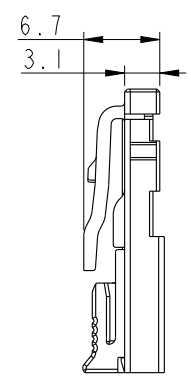
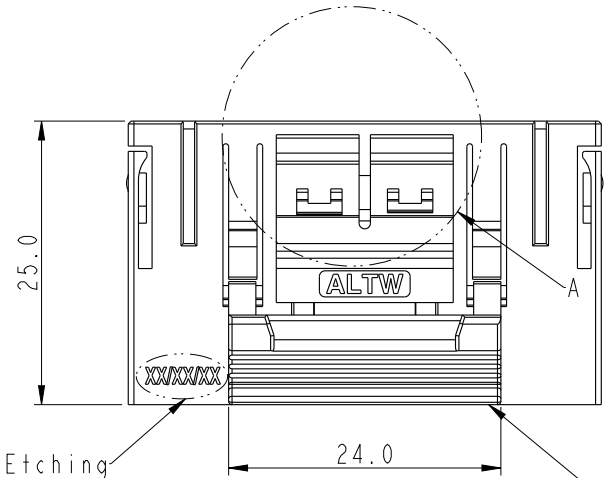

Laser Etching
Corresponding Pin Number

The secondary lock

Z2A1-XX NMAN-BN0001

XX: Number Of Contacts(Pitch)
 AA: 40(P0.9)/20(P1.8)
 AB: 38(P0.9)/19(P1.8)
 AC: 36(P0.9)/18(P1.8)/12(P2.7)

UNIT: mm		
TOLERANCE		
.X	±0.25	
.XX	±0.1	
.XXX	±0.05	
ANGLES	±1°	

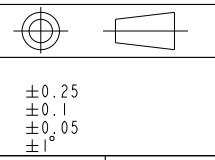

TITLE Z CONN., N SHLD, M			
SCALE 1:1	SIZE A4	SHEET 1 OF 5	
REV. B	WC-REV. .0	CCL: Inspection item	

Amphenol LTW
 安費諾亮泰企業股份有限公司

ITEM NO Z2A1-XXNMAN-BN0001	DRAWN BY Xiaofeng	DATE 2023/01/10
CUSTOMER ALTW	CHECKED BY Jerry	DATE 2023/01/10
	APPROVED BY Max	DATE 2023/01/10

DATE 2023/01/10
DATE 2023/01/10
DATE 2023/01/10

THIS DOCUMENT IS SUBJECT TO CHANGE WITHOUT NOTICE. IT IS CONFIDENTIAL AND A PROPERTY OF Amphenol LTW. DISCLOSURE TO THIRD PARTY HAS TO BE AUTHORIZED BY Amphenol LTW.

Flexible Printed Circuit
Pitch 0.9mm

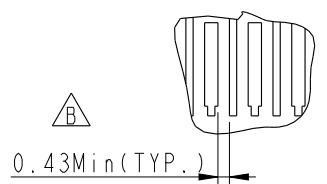
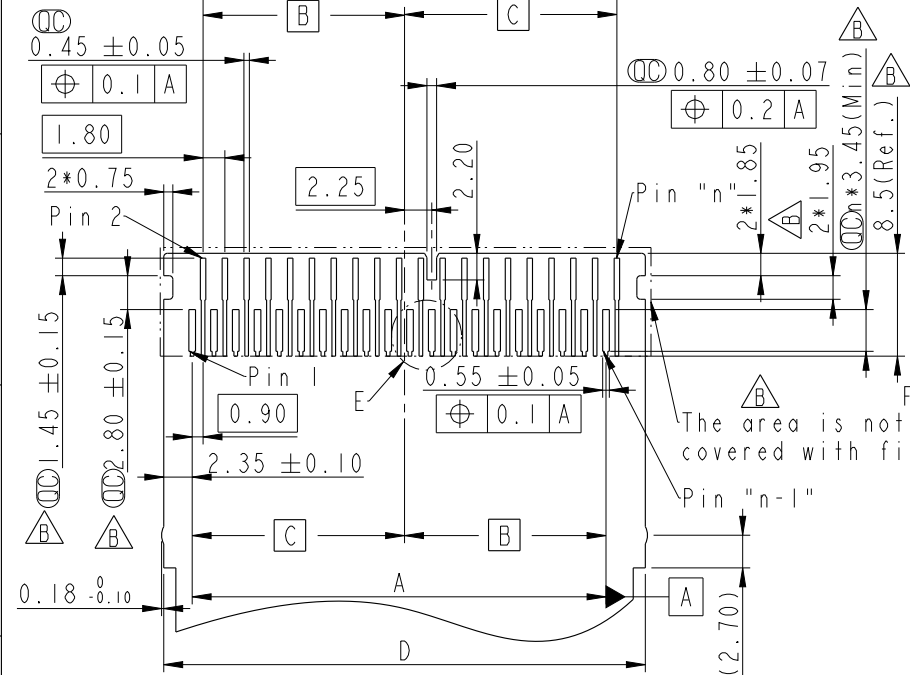

Detail: E

RECOMMENDED FPC LAYOUT

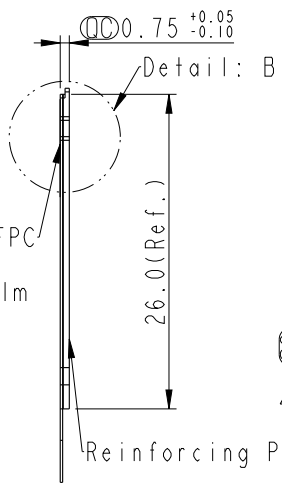

Detail: B

Recommend Optional
Gold finger
above flat surface

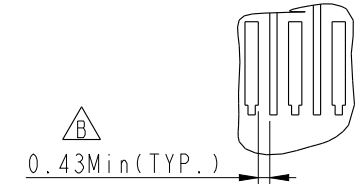
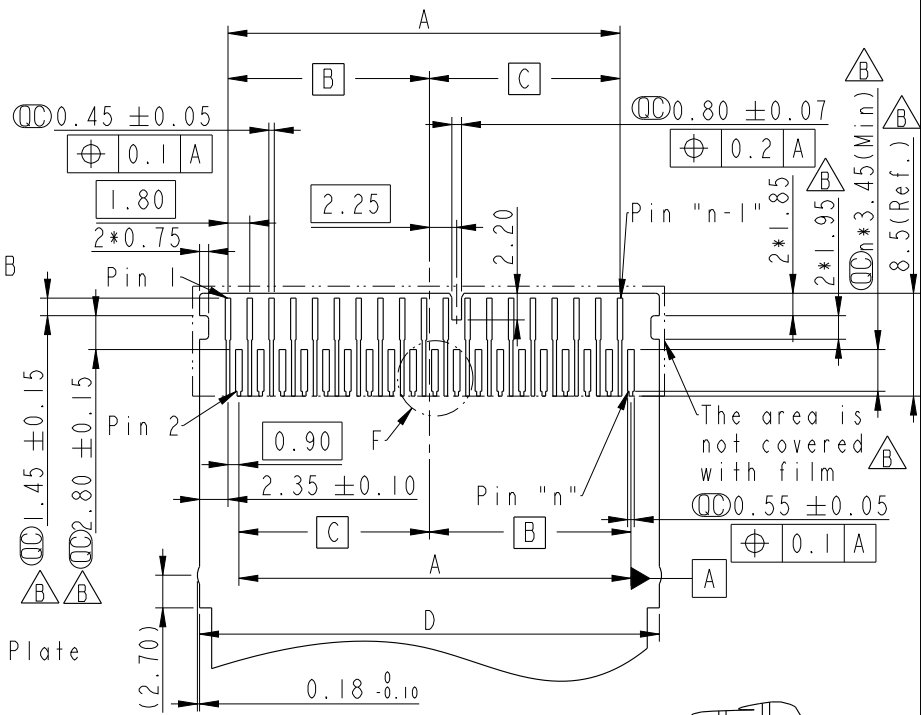
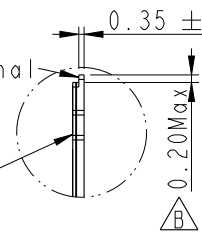

Detail: F

RECOMMENDED FPC LAYOUT

PIN	L (mm)	A (mm)	B (mm)	C (mm)	D (mm)
36	38.1	30.6	14.85	15.75	36.2
40	41.7	34.2	16.65	17.55	39.8

PIN	L (mm)	A (mm)	B (mm)	C (mm)	D (mm)
38	39.9	32.4	16.65	15.75	38

UNIT: mm

TOLERANCE
.X ±0.25
.XX ±0.1
.XXX ±0.05
ANGLES ±1°

TITLE
Z CONN., N SHLD, M

SCALE 1:1 SIZE A4 SHEET 2 OF 5

REV. B WC-REV. .0

QC: Inspection item

Amphenol LTW
安費諾亮泰企業股份有限公司

ITEM NO. Z2A1-XXNMAN-BN0001

DRAWN BY Xiaofeng DATE 2023/01/10

CHECKED BY Jerry DATE 2023/01/10

APPROVED BY Max DATE 2023/01/10

CUSTOMER ALTW

Flexible Printed Circuit
Pitch 1.8mm

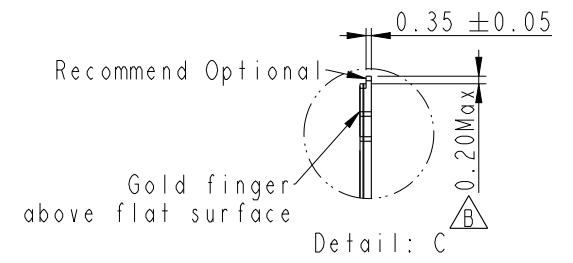
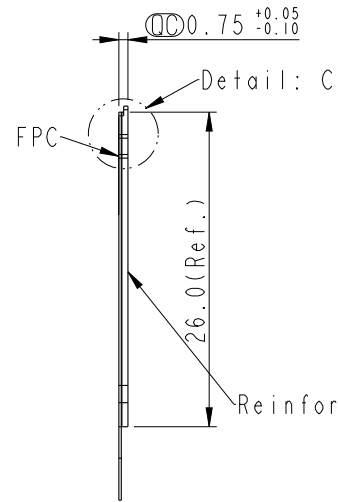
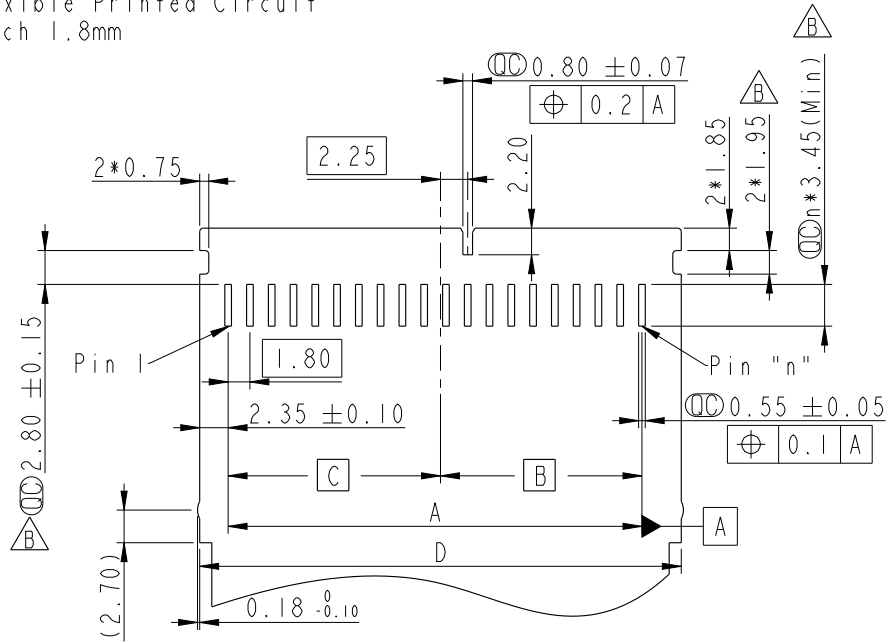

RECOMMENDED FPC LAYOUT

PIN	L (mm)	A (mm)	B (mm)	C (mm)	D (mm)
18	38.1	30.6	14.85	15.75	36.2
19	39.9	32.4	16.65	15.75	38.0
20	41.7	34.2	16.65	17.55	39.8

UNIT: mm		
TOLERANCE	.X ±0.25	
.XX	±0.1	
.XXX	±0.05	
ANGLES	±1°	

TITLE Z CONN., N SHLD, M			
SCALE 1:1	SIZE A4	SHEET 3 OF 5	
REV. B	WC-REV. .0	Ⓞ: Inspection item	

Amphenol LTW
安費諾亮泰企業股份有限公司

ITEM NO.	DRAWN BY Xiaofeng	DATE 2023/01/10
DWG NO. Z2AI-XXNMAN-BN0001	CHECKED BY Jerry	DATE 2023/01/10
CUSTOMER ALTW	APPROVED BY Max	DATE 2023/01/10

THIS DOCUMENT IS SUBJECT TO CHANGE WITHOUT NOTICE. IT IS CONFIDENTIAL AND A PROPERTY OF Amphenol LTW. DISCLOSURE TO THIRD PARTY HAS TO BE AUTHORIZED BY Amphenol LTW.

Flexible Printed Circuit
Pitch 2.7mm

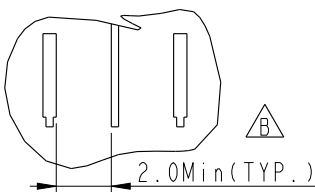
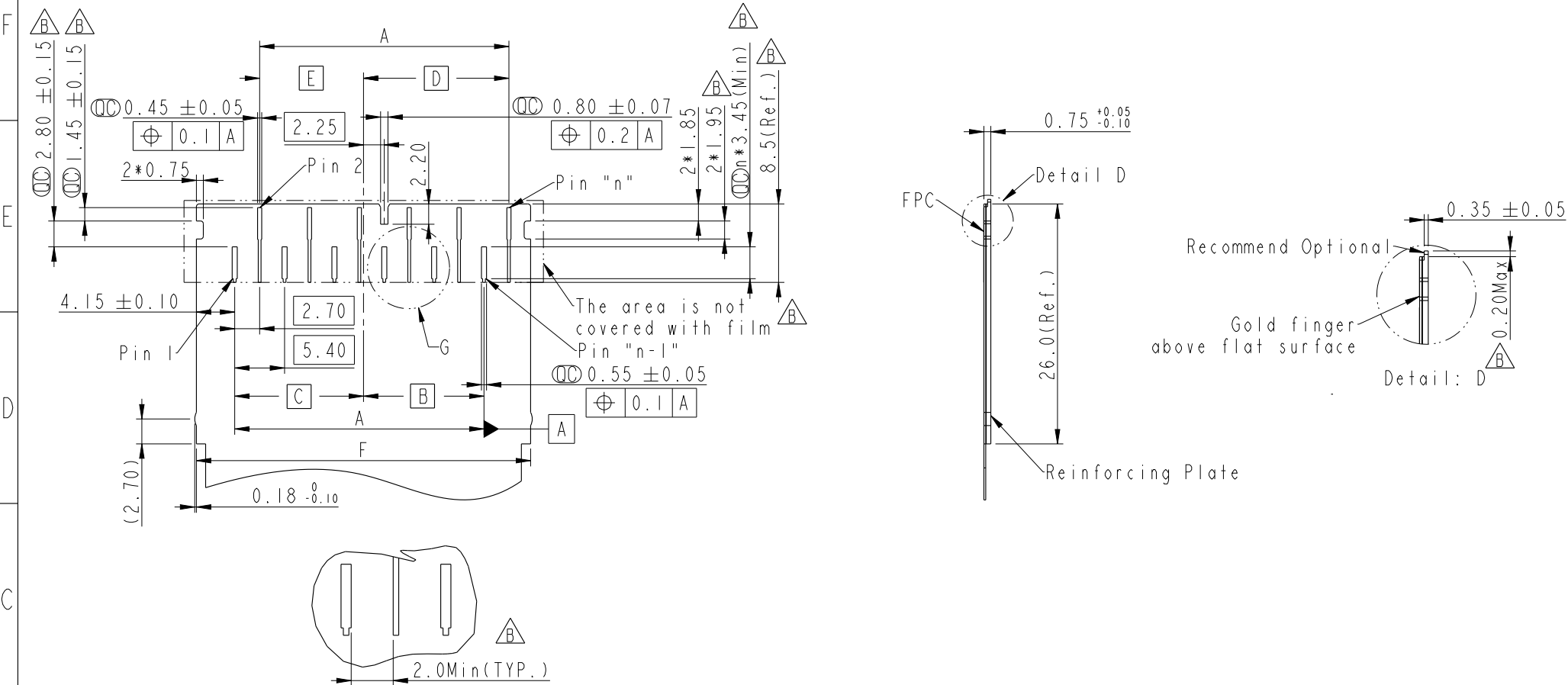

RECOMMENDED FPC LAYOUT

PIN	L (mm)	F (mm)	A (mm)	B (mm)	C (mm)	D (mm)	E (mm)
12	38.1	36.2	27.0	13.05	13.95	15.75	11.25

UNIT: mm TOLERANCE .X ±0.25 .XX ±0.1 .XXX ±0.05 ANGLES ±1°	TITLE Z CONN., N SHLD, M			Amphenol LTW 安費諾亮泰企業股份有限公司		ITEM NO	DRAWN BY Xiaofeng	DATE 2023/01/10
	SCALE 1:1	SIZE A4	SHEET 4 OF 5			DWG NO Z2A1-XXNMAN-BN0001	CHECKED BY Jerry	DATE 2023/01/10
	REV. B	WC-REV. .0	Inspection item	CUSTOMER ALTW	APPROVED BY Max	DATE 2023/01/10		
								W10814-03-001A2

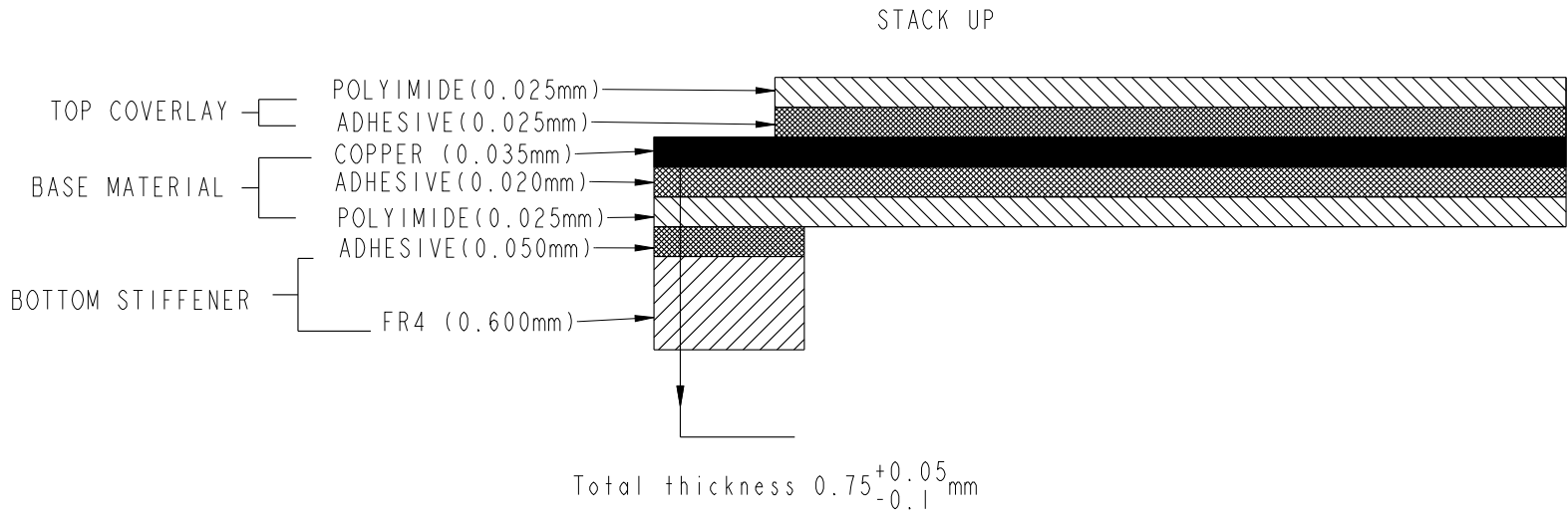

Note:
 * CC Important Dimensions To Check.
 * Material: Thermoplastic, Black.
 * All Parts Are RoHS Compliant.

UNIT: mm	
TOLERANCE	
.X	±0.25
.XX	±0.1
.XXX	±0.05
ANGLES	±1°

TITLE Z CONN., N SHLD, M			
SCALE 1:1	SIZE A4	SHEET 5 OF 5	
REV. B	WC-REV. .0	CC : Inspection item	

Amphenol LTW
 安費諾亮泰企業股份有限公司

ITEM NO	DRAWN BY Xiaofeng	DATE 2023/01/10
DWG NO Z2A1-XXNMAN-BN0001	CHECKED BY Jerry	DATE 2023/01/10
CUSTOMER ALTW	APPROVED BY Max	DATE 2023/01/10

单击下面可查看定价，库存，交付和生命周期等信息

[>>Amphenol\(安费诺\)](#)