

THIS DRAWING IS SUPPLIED FOR INFORMATION ONLY. DESIGN FEATURES, SPECIFICATIONS AND PERFORMANCE DATA SHOWN HEREON ARE THE PROPERTY OF THE AMPHENOL CORPORATION. NO RIGHTS OF REPRODUCTION ARE IMPLIED. ALL DIMENSIONS ARE SUBJECT TO NORMAL MANUFACTURING VARIATIONS.

Customer Drawing

REV	ZONE	ECO	DESCRIPTION	DATE	BY	APPR
A	---	---	INITIAL RELEASE	09/20/18	FL	JL
B	---	---	Enhance IP Rating and Flame Class, add new applicable terminals	01/22/19	FL	JL
C	---	---	Add plating type information of terminal and attention information	04/29/20	JS	JL
D	---	ECNG220404	Add plating type information of terminal	06/09/22	RJ	JL

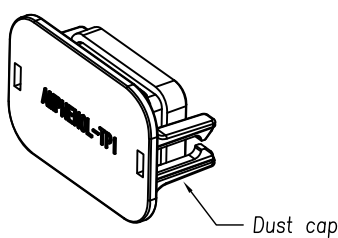
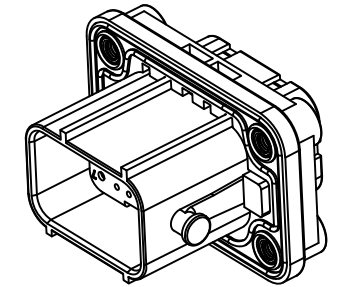
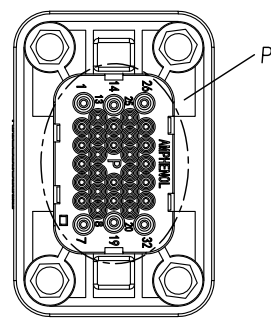
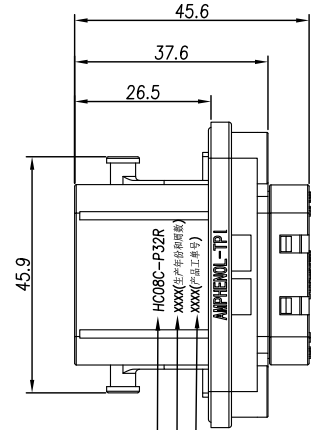
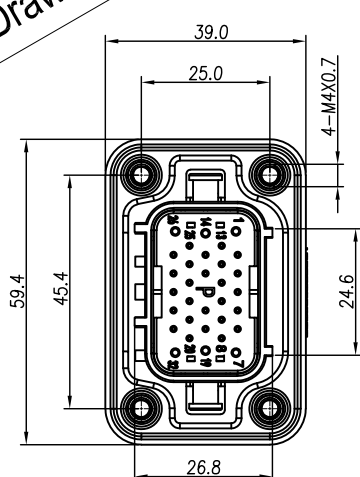

激光打标位置及内容如下:  
 HC08C-P32R  
 XXXX(生产年份和周数)  
 XXXX(产品工单号)

推荐面板开孔方向

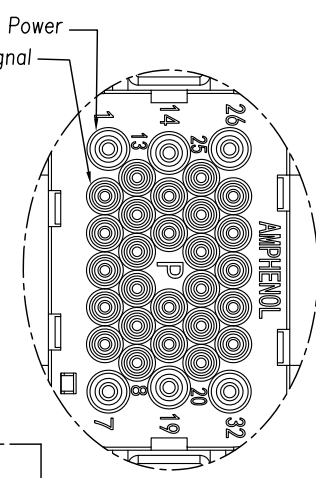
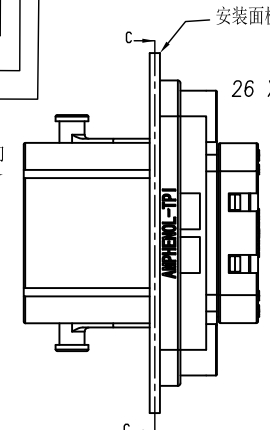

- 规格参数 (Spec.):
- 工作温度 Operating Temperature:  $-40^{\circ}\text{C} \sim +125^{\circ}\text{C}$ .
  - 额定电流 Current Rating:  
 Power: 13 A MAX.  
 Signal: 5 A MAX.
  - 配对线径 Cable Size:  
 3.1. Power: 14~18 AWG.  
 3.2. Signal: 20~22 AWG.
  - 耐电压 Dielectric Withstanding Voltage: 3000 VDC.
  - 防护等级 Protection Class: IP68 (接头配对时 Mated connector).
  - 机械寿命 Mating Cycle: 100 Min.
  - 法兰盘螺丝安装扭矩  
 Screw Assembly Torque on Flange:  $1.6 \sim 2.4 \text{ Nm}$
  - 对配插头见图纸 Mating plug see drawing: "HC18C-S32"
  - 防火等级 Flame Class: UL94V-0

- 安装面板要求:
- 厚度不超过 6.5mm  
加上螺丝头厚度不超过 8mm
  - 平面度要求 0.15mm
  - 表面粗糙度 Ra3.2

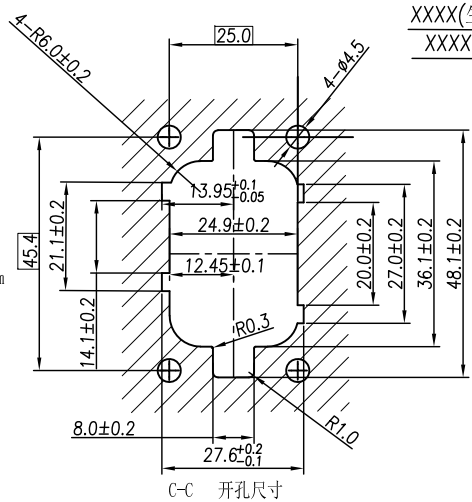

订购信息 Ordering Information

HC08 C - P32 R

键位 Key: "C", blue

安装类型 installation type: R, 法兰后 Rear the flange

注意: 镀金端子不能与镀锡端子互配。划掉的端子料号2022年10月1日起停产。  
 Note: The gold-plated terminal cannot be matched with the tin-plated terminal.  
 The terminal material number crossed out will be discontinued from October 1, 2022.

端子种类	端子料号	电镀种类	适合电线	Wire OD range	盲堵种类	盲堵料号
Terminal type	Terminal P/N	Plating type	Wire range	电线外径范围	Seal type	Seal P/N
16# (Power)	HCTM21401	镀底镀金 Flash Gold	14~18 AWG	2.24~3.00mm	16# (Power)	AC-CP000383
	HCTM21504	镀底镀锡 Tin Plated				
	HCTM21601	镀底镀金 Flash Gold				
	HCTM16161	镀底镀金 Flash Gold				
20# (Signal)	HCTM16164	镀底镀锡 Tin Plated	20~22 AWG	1.35~2.50mm	20# (Signal)	AC-CP000382
	HCTM12061	镀底镀金 Flash Gold				
	HCTM12104	镀底镀锡 Tin Plated				
	HCTM20101	镀底镀金 Flash Gold				
	HCTM20104	镀底镀锡 Tin Plated				

AMPHENOL Technical Products International GZ

第三角投影 THIRD ANGLE PROJECTION

页面 SHEET: 1 of 1

幅面 SIZE: A3

版次 REV: D

比例 SCALE: D

PART NAME: HC 32CKT Rcpt Rear Code C

DWG NO: HC08C-P32R

CUST PART #: N/A

CUST REV: -

签名 SIGNATURE: RJ

日期 DATE: 06/09/22

UNLESS OTHERWISE SPECIFIED

1) All dimensions are in metric(mm).

2) Tolerances are as follows:

0 PL DEC ±1.00

1 PL DEC ±0.50

2 PL DEC ±0.20

Angles ±1°

Key Characteristics: Critical 关键特性

Amphenol for Label: Significant 重要特征

制图 DRAWN: RJ

审核 CHECKED: JG

批准 APPROVAL: JL

单击下面可查看定价，库存，交付和生命周期等信息

[>>Amphenol\(安费诺\)](#)