

REVISIONS					
REV	ECO	DESCRIPTION	DATE	BY	APPR
B1	-	RELEASE NEW DWG FORMAT	06/16/14	TOD	TOMMY
B2	-	UPDTAED SPECIFICATION	09/14/15	TOD	TOMMY

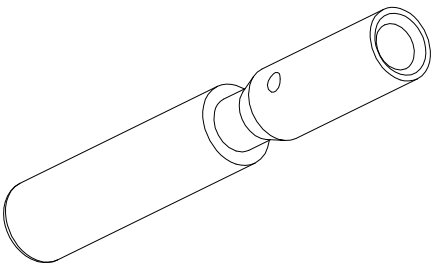
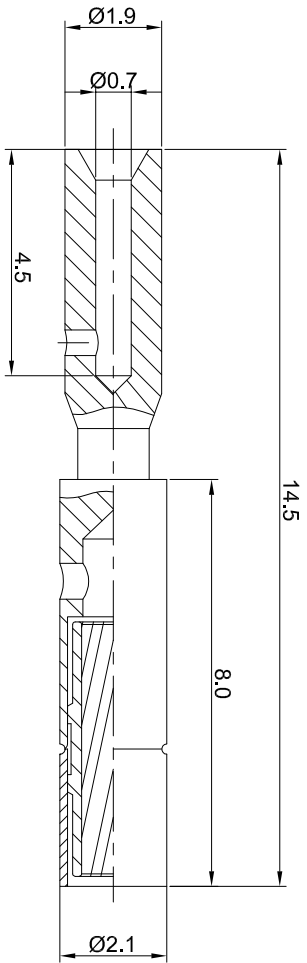

- NOTES: UNLESS OTHERWISE SPECIFIED
1. MATERIAL: COPPER ALLOY; GOLD PLATED
 2. SPECIFICATIONS:
 - 2.1 RATED CURRENT: 10 AMPS
 - 2.2 CONTACT RESISTANCE: <5 milliohm
 - 2.3 AVAILABLE WIRE RANGE: 28AWG~24AWG
 - 2.4 ROHS COMPLIANT
 3. ALL DIMENSIONS ARE FOR REFERENCE USE ONLY.

TITLE:

Socket contact,20#,Chmp 28-24AWG

DWG NO:

SC000030

REV: B2

SH: 1

OF: 1

QUANTITY	SEE PART NUMBER CHART	PART NUMBER	DESCRIPTION	ITEM
MATERIALS LIST				
UNLESS OTHERWISE SPECIFIED				
1) All dimensions are in millimeters.				
2) Tolerances are as follows:				
1 Pt. DEC 20.00				
2 Pt. DEC 20.00				
3 Pt. DEC 20.08				
3) Note reference = A				
MATERIAL SPECIFICATIONS:				
CUSTOMER:				
THE DRAWING IS SUPPLIED FOR INFORMATION ONLY. DESIGN FEATURES, SPECIFICATIONS AND PERFORMANCE DATA ARE SUBJECT TO CHANGE WITHOUT NOTICE. THE APPLICABLE SPECIFICATION NO RIGHTS OF REPRODUCTION ARE IMPLIED. ALL MANUFACTURING VARIATIONS.				
PROCESS SPECIFICATIONS:				
NEXT ASSY:				
DRAWN: tod		DATE: 09/14/15		
CHECKED:		ENGINEER:		
APPROVAL:		CUSTOMER:		
SIZE: B		TYPE: C-		
SCALE: NONE		DWG NO: SC000030		
REVISION: B2		SHEET: 1 OF 1		

Amphenol

Sine Systems - www.amphenol-sine.com
44724 Model Drive
Clifton Township, MI 48036

Socket contact,20#,Chmp 28-24AWG

单击下面可查看定价，库存，交付和生命周期等信息

[>>Amphenol\(安费诺\)](#)