



**Gas Discharge Tube  
Features**

- Small Size Design 4.0×3.2×2.7mm Current
- Handling Capability 2,000A @ 8/20μ s
- Low Capacitance and Insertion Loss
- Fast Response and Long Service Life
- Reliable to Protect Electrostatic Surge
- Moisture sensitivity level: Level 1

**Application information**

- AC Power

**Agency Approvals**

Icon	Description
<b>RoHS</b>	Compliance with 2011/65/EU
<b>HF</b>	Compliance with IEC61249-2-21:2003
	Mean lead free
	Compliance with UL1449, Certificated E337906
	NO.B 104564 0001 Rev.00

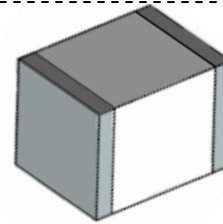
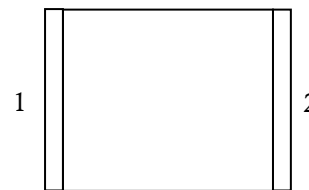
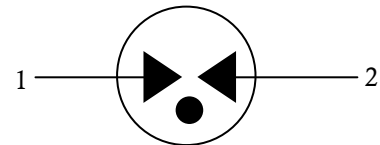
**Exterior**

**SMD**
**Package (Top View)**

**Schematic Symbol**

DC Breakdown Voltage 1)2)	100V/s	1200-1800	V
Impulse Spark-over Voltage	At 1KV/μs	For 99% of measured values ≤2400	V
	At 1KV/μs	Typical values of distribution ≤2200	V
Impulse Discharge Current 3)	8/20μs ±5times	2,000	A
Impulse Discharge Current 3)	10/1000μs ±5Times	10	A
AC Discharge Current	2A1S	1	Time
Arc Voltage	At 1A	~15	V
Insulation Resistance	DC=100V	≥1	GΩ
Capacitance at 1 MHz	VDC=0.5V	≤1	pF
Weight		~0.20	g
Operating And Storage Temperature		-40-125	°C
Marking		Without	

1) At delivery AQL 0.65 level II ISO 2859

2) In ionized mode

3) Terms and waveforms in accordance with ITU-T Rec. K. 12; IEC 61643-21

**Part Numbering System**

BC 1500

(1) (2)

(1) Bencent Gas Discharge Tube

(2) Series: DC Breakdown Voltage, e.g.: 1500=1500V

**Product Characteristics**

Lead Material	Copper or iron nickel alloy
Body Material	Ceramics
Terminal Finish	100% Matte-Tin Plated

**Environmental Reliability Characteristics**

Testing items	Technical standards
High Temperature Storage Test	Temperature: 125°C Time: 2H
Low Temperature Storage Test	Temperature: -40°C Time: 2H
Vibration	Frequency: 10-500Hz Amplitude: 0.15mm Time: 45mins
Resistance of soldering heat	Temperature: 260±5°C Time of dip soldering: 10s, 1time

Note: Up-screen program can be specified by customer's request via contacting Bencent service

**Solderability test**

Solderability	Solder Pot Temperature:	245°C ± 5°C
	Solder Dwell Time:	4-6 seconds

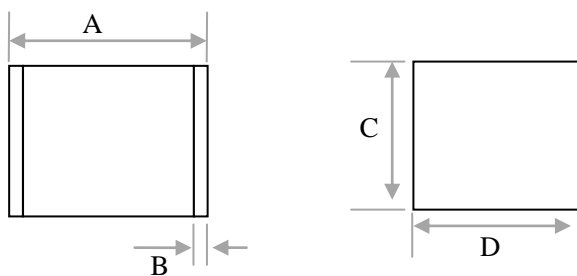
**Product Dimensions**

REF	mm	inch
A	4.0±0.3	0.157±0.012
B	0.3±0.2	0.012±0.008
C	2.7±0.2	0.106±0.008
D	3.2±0.2	0.126±0.008

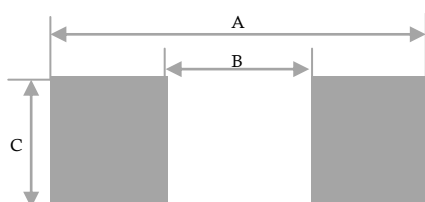
**Recommended Soldering Pad**

REF	mm	inch
A	5.0	0.197
B	3.0	0.118
C	3.5	0.138

**Reflow Profile**

Reflow Condition		Pb-Free assembly
Pre Heat	Temperature Min	150 °C
	Temperature Max	200 °C
	Time (min to max)	60 – 180 secs
Average ramp up rate (Liquids) $T_{amp}$ ( $T_L$ ) to peak		3 °C/second max
$T_{S(max)}$ to $T_L$ - Ramp-up Rate		3 °C/second max
Reflow	- Temperature ( $T_L$ ) (Liquids)	217 °C
	- Temperature ( $T_L$ )	60 – 150 seconds
Peak Temperature ( $T_P$ )		260+0/-5 °C
Time within 5 °C of actual peak Temperature ( $t_p$ )		8 – 20 seconds
Ramp-down Rate		6 °C/second max
Time 25 °C to peak Temperature ( $T_P$ )		8 minutes Max.
Do not exceed		260 °C

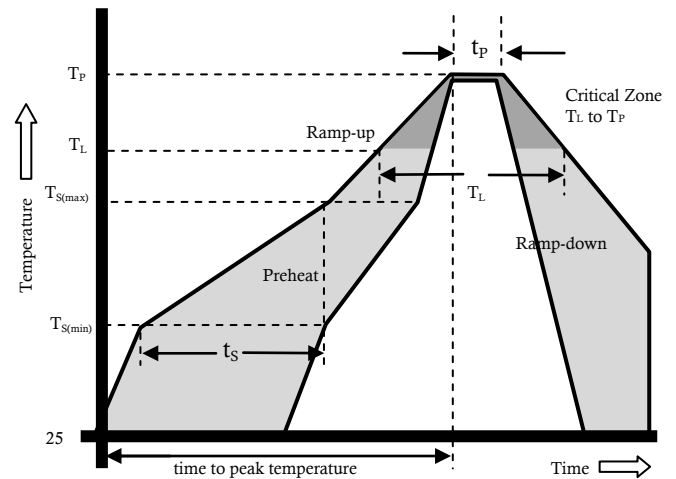
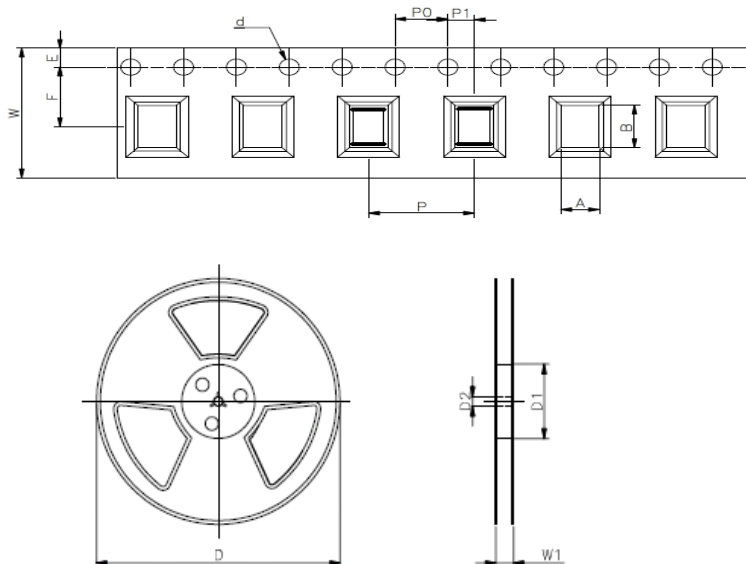
**Package Reel Information**

REF	mm	inch
A	3.7±0.2	0.146±0.008
B	5.0±0.1	0.197±0.004
d	Φ 1.5±0.1	Φ 0.059±0.004
E	1.75±0.1	0.069±0.004
F	5.5±0.1	0.217±0.002
P	8.0±0.1	0.315±0.004
P0	4.0±0.1	0.157±0.004
P1	2.0±0.1	0.079±0.004
W	12.0±0.2	0.472±0.008
D	Φ330.0	Φ13.0
D1	Φ50Min	Φ1.97Min
D2	Φ13±0.5	0.512±0.02
W1	16.8±2.0	0.661±0.079

OUTLINE	REEL (PCS)	PER CARTON (PCS)	REEL DIAMETERS (mm)	CARTON SIZE(mm)		
				L	W	H
TAPING	2,500	40,000	330	360	360	380

单击下面可查看定价，库存，交付和生命周期等信息

[>>Bencent \(槟城\)](#)