

PTS526 Series

Microminiature SMT Top Actuated



Description

The PTS526 series tactile switch is a small 5.2 x 5.2 form factor in SMT version with 4 different heights and 3 available actuation forces, ideal for general usage applications. PTS526 tactile switch also includes ground pin options.

Features & Benefits

- 5.2 x 5.2 mm footprint
- Variable thickness
- Commercial grade

Applications

- IoT devices
- Home automation
- Remote controls

Specifications

Function	Momentary action
Contact Arrangement	1 make contact SPST NO
Terminals	J and G type for SMT
Travel	0.25 mm +/- 0.1 mm
Packaging	In reels of 5,000 pieces for 0.8 mm height. In reels of 4,000 pieces for 1.5 ; 1.7 and 2.0 mm height. Dimensions of reels according to EIA 481B. External diameter 330 mm.

Electrical Characteristics

Maximum Voltage	12 VDC
Maximum Current DC	50 mA
Dielectric Strength	250 vA C (1mn)
Contact Resistance	≤ 100 mΩ initial
Insulation Resistance	≥ 100 MΩ
Bounce Time	≤ 10 ms

Environmental Characteristics

Operating Temperature	-40°C to 85°C
------------------------------	---------------

Process

Soldering	This component is suited to the following methods: Infrared Reflow Soldering in accordance with IEC61760-1
------------------	---

PTS526 Series

Microminiature SMT Top Actuated



Mechanical Characteristics

Item Description	Operation Force (gf)	Operating Life	Ground Pin
PTS526SM1SMTR2 LFS	160 ± 50	500,000	Without ground pin
PTS526SK1SMTR2 LFS	250 ± 50	200,000	
PTS526SP1SMTR2 LFS	320 ± 50	100,000	
PTS526SMG1SMTR2 LFS	160 ± 50	500,000	With ground pin
PTS526SKG1SMTR2 LFS	250 ± 50	200,000	
PTS526SPG1SMTR2 LFS	320 ± 50	100,000	
PTS526SM1SMTR21 LFS	160 ± 50	1,000,000	Without ground pin
PTS526SMG1SMTR21 LFS	160 ± 50	1,000,000	With ground pin

Notes:

1. PTS526SX08 SMTR2 LFS 160gf version with 200,000 life cycles

Specifications listed above are for switches with standard options. For information on specific and custom switches, consult Customer Service Center. The PTS series is not certified for using in Automotive application and no PPAP. However, in the case of some automotive accessories and specific applications for 2 and 3 wheeled vehicles the PTS is widely used and very suitable. Please contact your local representative to discuss your application and the best switch solution.

Dimensions (mm)

0.8 mm Height – G Leads Lead Only, No Ground Pin

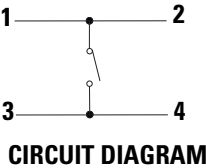
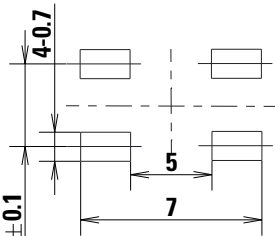
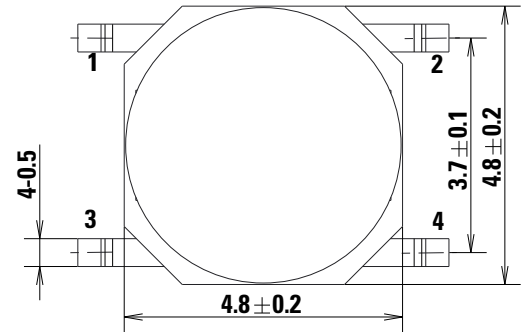

PCB LAND DIMENSION

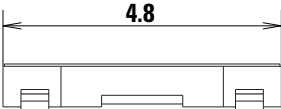
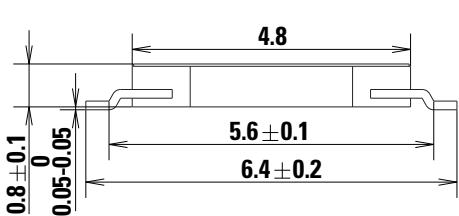

PTS526 Series

Microminiature SMT Top Actuated



1.5 ; 1.7 and 2.0 mm Height – G Leads, with Ground Pin

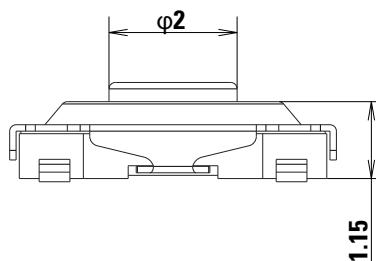
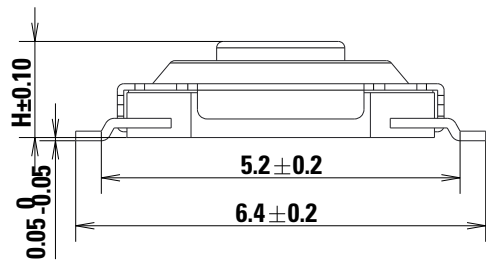
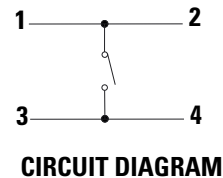
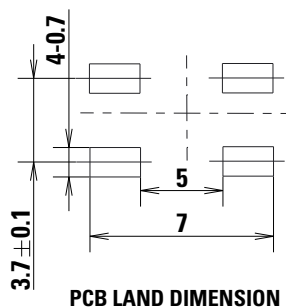
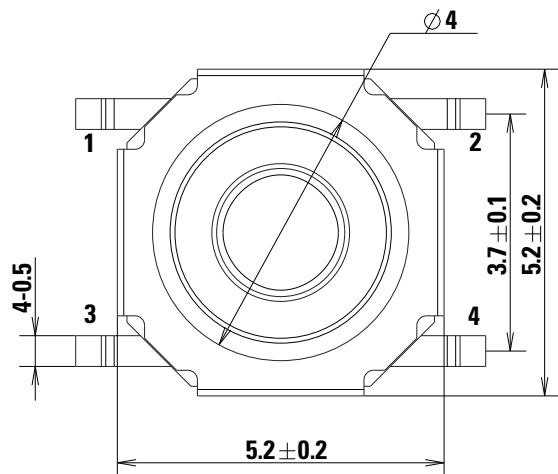

PTS526 Series

Microminiature SMT Top Actuated



1.5 ; 1.7 and 2.0 mm Height – G Leads, No Ground Pin

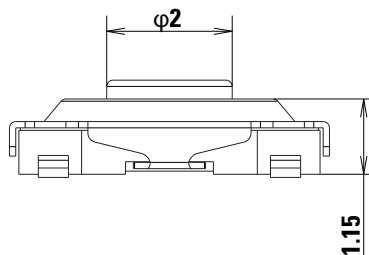
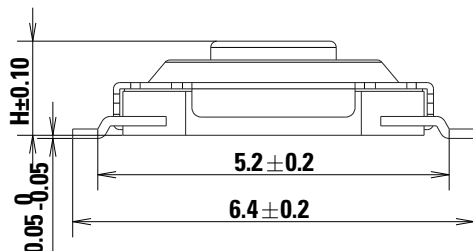
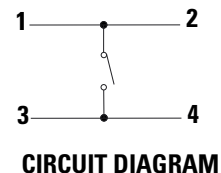
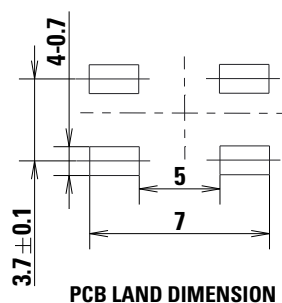
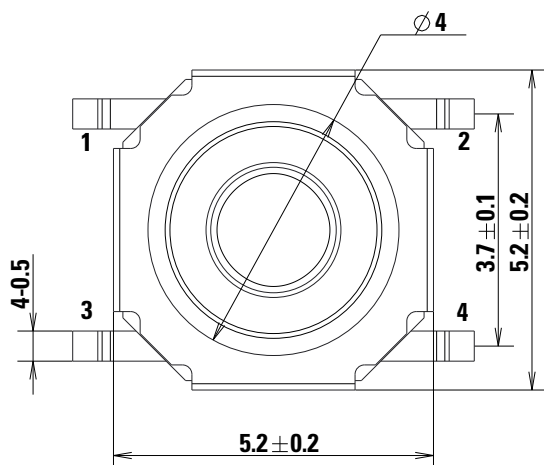

1.5 ; 1.7 and 2.0 mm height – J leads, with ground pin

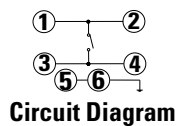
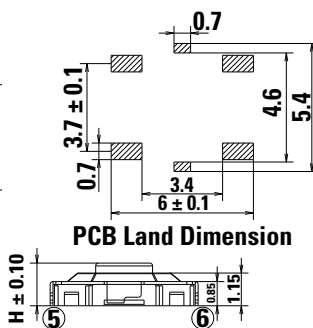
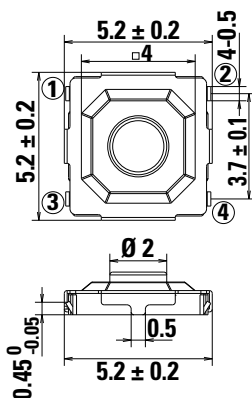

PTS526 Series

Microminiature SMT Top Actuated



Tape & Reel

0.8 mm Height
5,000 Pieces per Reel

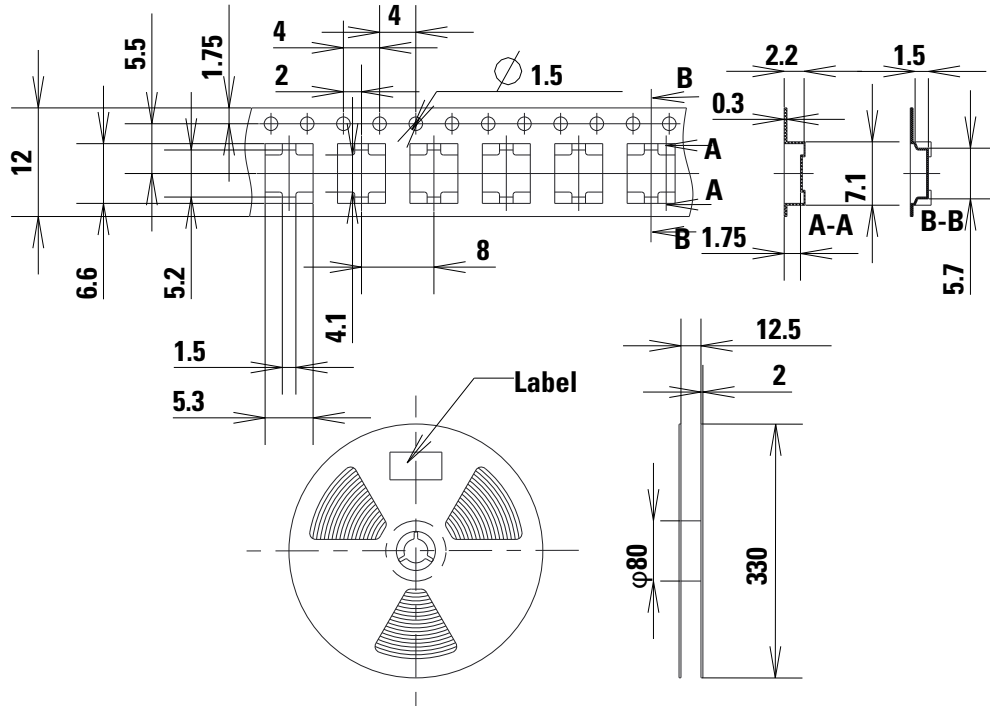

1.5; 1.7 and 2.0 mm Height
4,000 Pieces per Reel

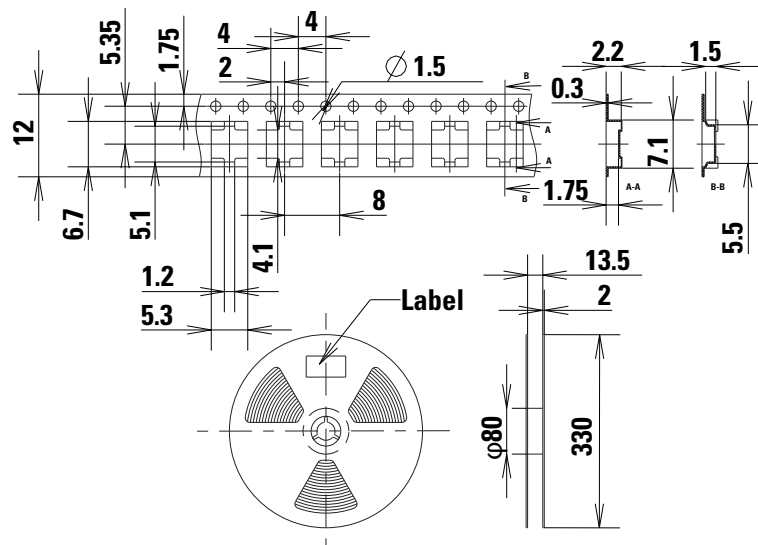

PTS526 Series

Microminiature SMT Top Actuated



Ordering Number

Our easy build-a-switch concept allows you to mix and match options to create the switch you need. To order, select desired option from each category and place it in the appropriate box. For any part number different from those listed above, please consult your local representative.

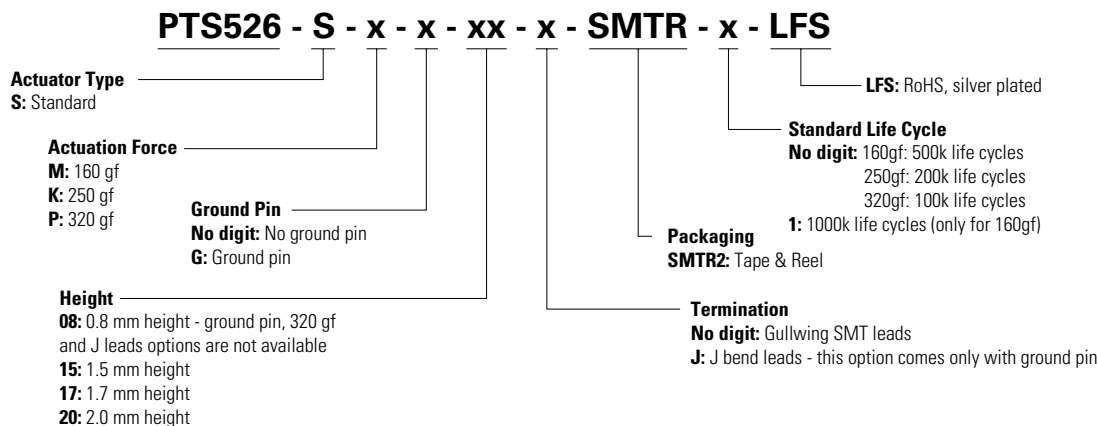

Liability Limitation

This datasheet does not provide enough information for applications that require a certain level of quality or safety such as automotive, medical systems, or safety equipment. Please contact customer service for the contractual specification package.

Disclaimer Notice - Information furnished is believed to be accurate and reliable. However, users should independently evaluate the suitability of and test each product selected for their own applications. Littelfuse products are not designed for, and may not be used in, all applications. Read complete Disclaimer Notice at <http://www.littelfuse.com/disclaimer-electronics>.

单击下面可查看定价，库存，交付和生命周期等信息

[>>C&K](#)