

Specifications

- Current rating: 2A AC, DC
- Voltage rating: 100V AC, DC
- Temperature range: -40°C ~ +105°C
- Contact resistance: 10mΩ Max.
- Insulation resistance: 1000MΩ Min.
- Withstanding voltage: 800V AC/minute
- *Compliant with RoHS and REACH*
- *Meet the HF/Halogen Free, need to customize*
- *Contact CJT for details*

Standards



Assembly layout

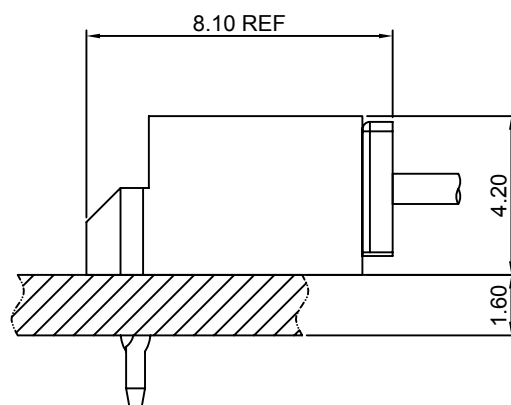
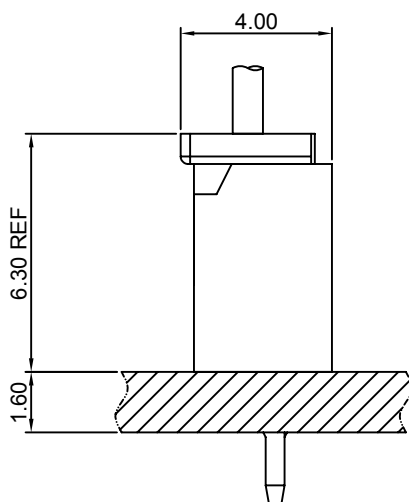

A2010-T

2.00mm Pitch Crimp Terminal

Reference Informations:

*Used in CJT A2010H, HA-XP, A2010HA-2xXP, A2008HA-XP series Housing

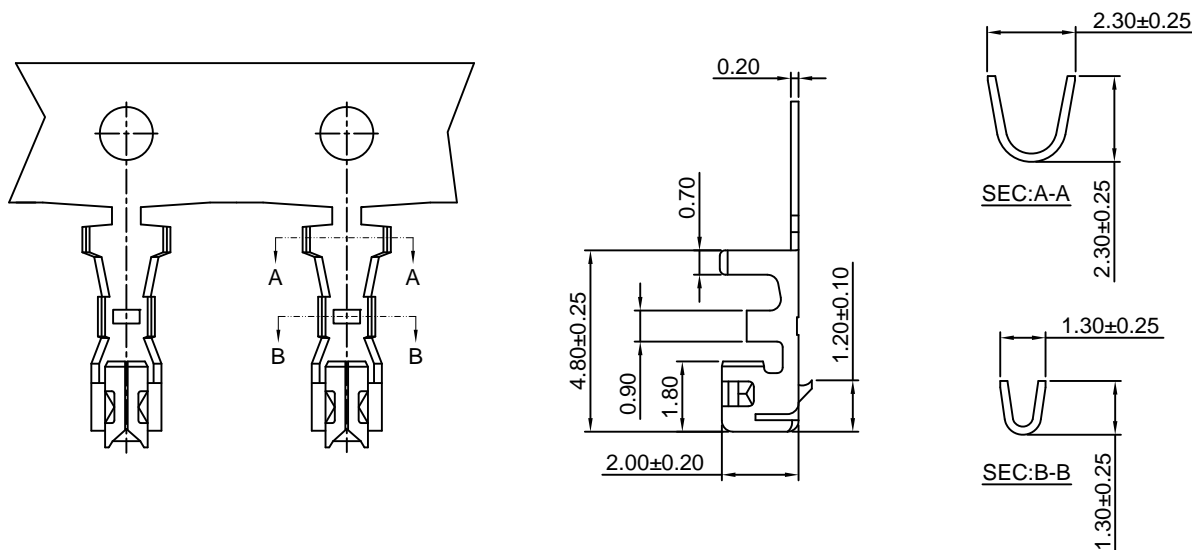

Ordering information & Specifications:

Unit:mm

| Part NO. | Wire Range | Insulation O.D. | Material | Finish | Qty/reel |
|----------|------------|-----------------|-----------------|------------------|------------|
| A2010-TP | AWG#24-#30 | 1.40mm(max) | Phosphor Bronze | Tin over Nickel | 10,000 PCS |
| A2010-GP | AWG#24-#30 | 1.40mm(max) | Phosphor Bronze | Gold over Nickel | 10,000 PCS |

Optional Gold plating available but MOQ requested

A2010H-XP

2.00mm Pitch Housing

Reference Informations:

*Material:PBT+15%GF,UL94V-0

*Suitable CJT A2010-T series Terminal

*Mates with CJT A2010WV,WR-XP,A2010WV-F-XP series Wafer

*Color:White

Ordering Information:

A2010H-XP - *** - **
1 2 3

1. Part No.

2. Material:

(Blank):PBT+15%GF,UL94V-0

GWT:PBT,UL94V-0,GWT 750 °C

3. Color:

(Blank):White

BK:Black

RD:Red

YL:Yellow

BL:Blue

GN:Green

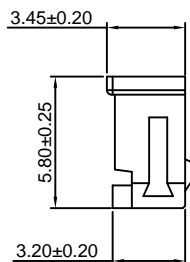
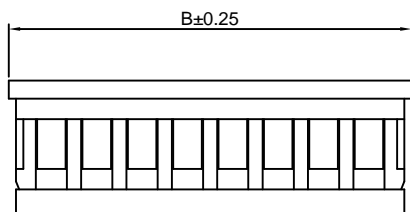
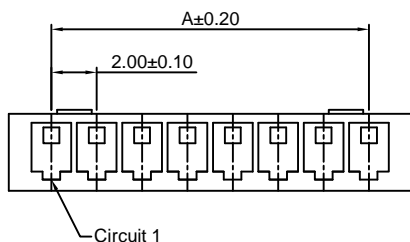
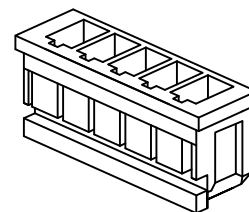

Ordering Information & Dimensions:

| PART NO. | Dimensions | |
|----------|------------|-------|
| | A | B |
| 2P | 2.00 | 5.80 |
| 3P | 4.00 | 7.80 |
| 4P | 6.00 | 9.80 |
| 5P | 8.00 | 11.80 |
| 6P | 10.00 | 13.80 |
| 7P | 12.00 | 15.80 |
| 8P | 14.00 | 17.80 |
| 9P | 16.00 | 19.80 |
| 10P | 18.00 | 21.80 |
| 11P | 20.00 | 23.80 |
| 12P | 22.00 | 25.80 |
| 13P | 24.00 | 27.80 |
| 14P | 26.00 | 29.80 |
| 15P | 28.00 | 31.80 |

Unit: mm

A2010HA-XP

2.00mm Pitch Housing

Reference Informations:

- *Material: PBT+15%GF, UL94V-0
- *Suitable CJT A2010-T series Terminal
- *Color: White

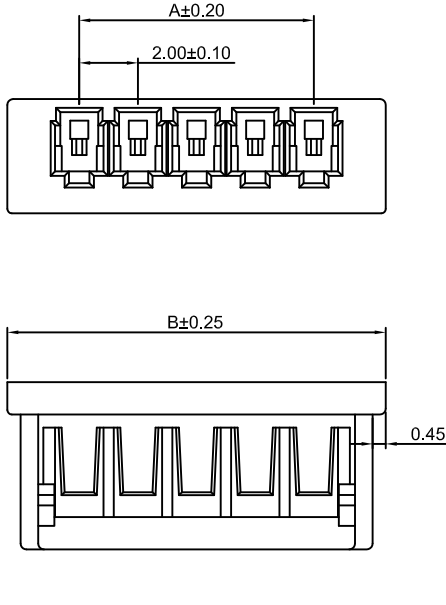

Ordering Information:

A2010HA-XP - ***
1 2

1. Part No.

2. Material:

(Blank): PBT+15%GF, UL94V-0

GWT: PBT, UL94V-0, GWT 750 °C

Ordering Information & Dimensions:

| PART NO. | Dimensions | |
|----------|------------|-------|
| | A | B |
| 2P | 2.00 | 6.90 |
| 3P | 4.00 | 8.90 |
| 4P | 6.00 | 10.90 |
| 5P | 8.00 | 12.90 |
| 6P | 10.00 | 14.90 |
| 7P | 12.00 | 16.90 |
| 8P | 14.00 | 18.90 |
| 9P | 16.00 | 20.90 |
| 10P | 18.00 | 22.90 |
| 11P | 20.00 | 24.90 |
| 12P | 22.00 | 26.90 |
| 13P | 24.00 | 28.90 |
| 14P | 26.00 | 30.90 |
| 15P | 28.00 | 32.90 |

Unit: mm

A2010HC-XP

2.00mm Pitch Housing

Reference Informations:

- *Material: PBT, UL94V-0
- *Suitable CJT A2010-T series Terminal
- *Mates with CJT A2010WVC, WRC-XP, series Wafer
- *Color: White

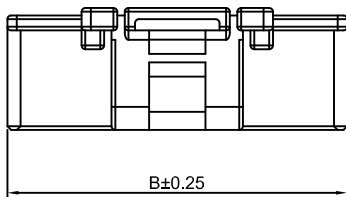

Ordering Information:

A2010HC-XP - ***
1 2

1. Part No.

2. Color:

(blank) - Natural

BK - Black

RD - Red

BL - Blue

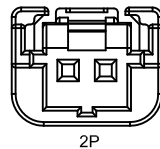
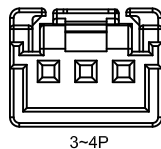
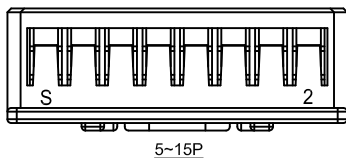
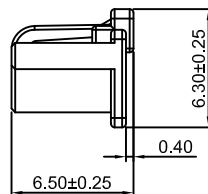
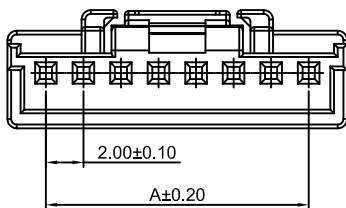
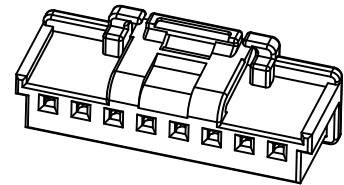

Ordering Information & Dimensions:

| PART NO. | Dimensions | |
|----------|------------|-------|
| | A | B |
| 2P | 2.00 | 8.00 |
| 3P | 4.00 | 8.10 |
| 4P | 6.00 | 10.10 |
| 5P | 8.00 | 12.10 |
| 6P | 10.00 | 14.10 |
| 7P | 12.00 | 16.10 |
| 8P | 14.00 | 18.10 |
| 9P | 16.00 | 20.10 |
| 10P | 18.00 | 22.10 |
| 11P | 20.00 | 24.10 |
| 12P | 22.00 | 26.10 |
| 13P | 24.00 | 28.10 |
| 14P | 26.00 | 30.10 |
| 15P | 28.00 | 32.10 |

Unit: mm

A2010HA-2xXP

2.00mm Pitch Dual Row Housing

Reference Informations:

- *Material: Nylon 66, UL94V-0
- *Suitable CJT A2010-T series Terminal
- *Mates with CJT A2010WVA-F-2xXP, A2012WVB-F-2xXP series Dual Row Wafer
- *Color: Gray

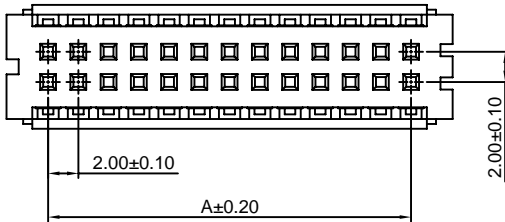

Ordering Information:
A2010HA-2xXP - ***
 1
 2
 1. Part No.
 2. Material:
 (Blank): Nylon 66, UL94V-0
 GWT: Nylon 66, UL94V-0, GWT 750 °C

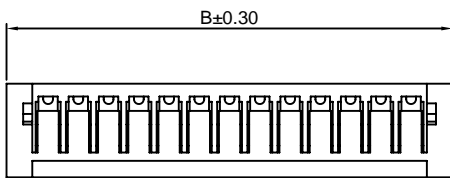
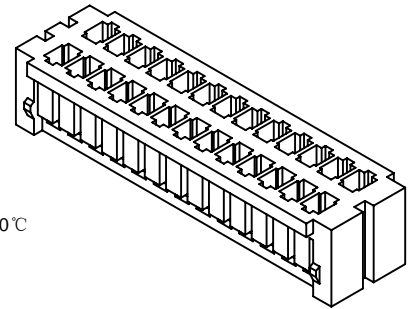

2x5P~2x14P

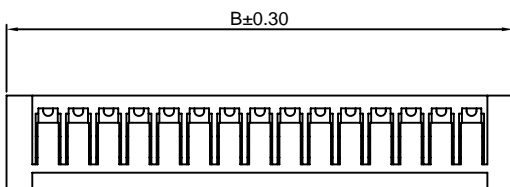
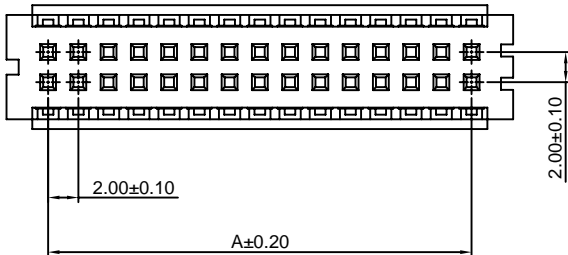
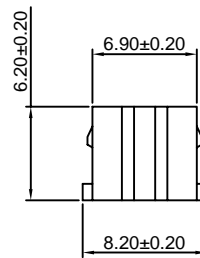

2x15P~2x30P

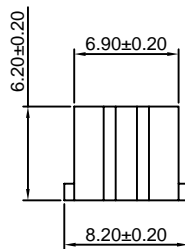

Ordering Information & Dimensions:

| PART NO. | Dimensions | |
|----------|------------|-------|
| | A | B |
| 2x5P | 8.00 | 13.50 |
| 2x6P | 10.00 | 15.50 |
| 2x7P | 12.00 | 17.50 |
| 2x8P | 14.00 | 19.50 |
| 2x9P | 16.00 | 21.50 |
| 2x10P | 18.00 | 23.50 |
| 2x11P | 20.00 | 25.50 |
| 2x12P | 22.00 | 27.50 |
| 2x13P | 24.00 | 29.50 |
| 2x14P | 26.00 | 31.50 |
| 2x15P | 28.00 | 33.50 |
| 2x16P | 30.00 | 35.50 |
| 2x17P | 32.00 | 37.50 |
| 2x20P | 38.00 | 43.50 |
| 2x25P | 48.00 | 53.50 |
| 2x30P | 58.00 | 63.50 |

Unit: mm

A2010WV-XP

2.00mm Pitch 180° Wafer

Reference Informations:

- *Material:Pin:Brass/Tin over Nickel
Insulator:Nylon 66+30%GF,UL94V-0
- *Mates with CJT A2010H-XP series Housing
- *Color:White

Ordering Information:

A2010WV-XP - *** - **
1 2 3

- 1.Part No.
- 2.Material:
(Blank):Nylon 66+30%GF,UL94V-0
GWT:Nylon 66,UL94V-0,GWT 750 °C
- 3.Color:
(Blank):White
BK:Black
RD:Red
YL:Yellow
BL:Blue
GN:Green

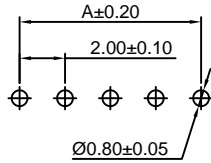
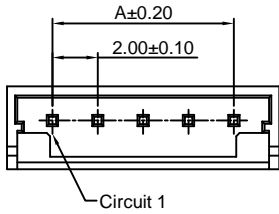
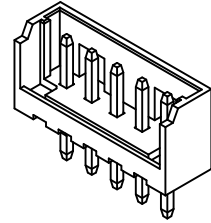

P.C.B LAYOUT

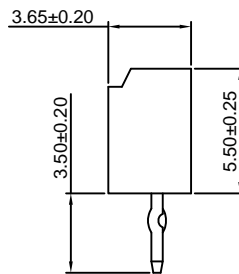
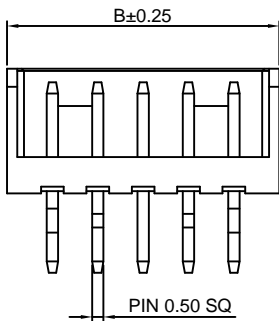

Ordering Information & Dimensions:

| PART NO. | Dimensions | |
|----------|------------|-------|
| | A | B |
| 2P | 2.00 | 6.00 |
| 3P | 4.00 | 8.00 |
| 4P | 6.00 | 10.00 |
| 5P | 8.00 | 12.00 |
| 6P | 10.00 | 14.00 |
| 7P | 12.00 | 16.00 |
| 8P | 14.00 | 18.00 |
| 9P | 16.00 | 20.00 |
| 10P | 18.00 | 22.00 |
| 11P | 20.00 | 24.00 |
| 12P | 22.00 | 26.00 |
| 13P | 24.00 | 28.00 |
| 14P | 26.00 | 30.00 |
| 15P | 28.00 | 32.00 |

Unit: mm

A2010WR-XP

2.00mm Pitch 90° Wafer

Reference Informations:

- *Material:Pin:Brass/Tin over Nickel
Insulator:Nylon 66+30%GF,UL94V-0
- *Mates with CJT A2010H-XP series Housing
- *Color:White

Ordering Information:

A2010WR-XP - *** - **
1 2 3

- 1.Part No.
- 2.Material:
(Blank):Nylon 66+30%GF,UL94V-0
GWT:Nylon 66,UL94V-0,GWT 750 °C
- 3.Color:
(Blank):White
BK:Black
RD:Red
YL:Yellow
BL:Blue
GN:Green

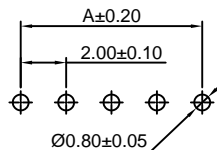
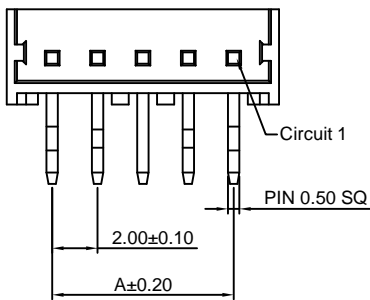
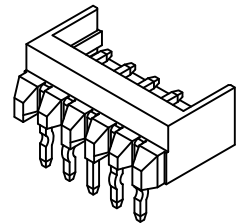

P.C.B LAYOUT

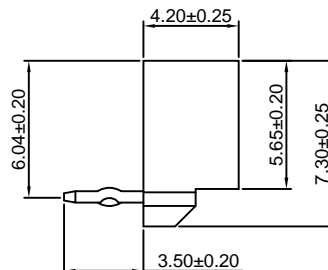
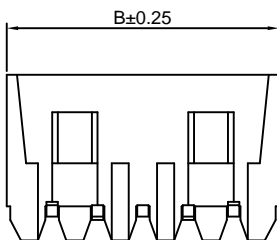

Ordering Information & Dimensions:

| PART NO. | Dimensions | |
|----------|------------|-------|
| | A | B |
| 2P | 2.00 | 6.00 |
| 3P | 4.00 | 8.00 |
| 4P | 6.00 | 10.00 |
| 5P | 8.00 | 12.00 |
| 6P | 10.00 | 14.00 |
| 7P | 12.00 | 16.00 |
| 8P | 14.00 | 18.00 |
| 9P | 16.00 | 20.00 |
| 10P | 18.00 | 22.00 |
| 11P | 20.00 | 24.00 |
| 12P | 22.00 | 26.00 |
| 13P | 24.00 | 28.00 |
| 14P | 26.00 | 30.00 |
| 15P | 28.00 | 32.00 |

Unit: mm

A2010WV-F-XP

2.00mm Pitch 180° Wafer

Reference Informations:

- *Material:Pin:Brass/Tin over Nickel
Insulator:Nylon 66+30%GF,UL94V-0
- *Mates with CJT A2010H-XP series Housing
- *Color:White

Ordering Information:

A2010WV-F-XP - *** - **
1 2 3

- Part No.
- Material:
(Blank):Nylon 66+30%GF,UL94V-0
GWT:Nylon 66,UL94V-0,GWT 750 °C
- Color:
(Blank):White
BK:Black
RD:Red
YL:Yellow
BL:Blue
GN:Green

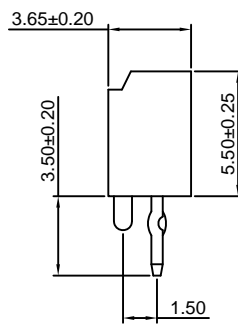
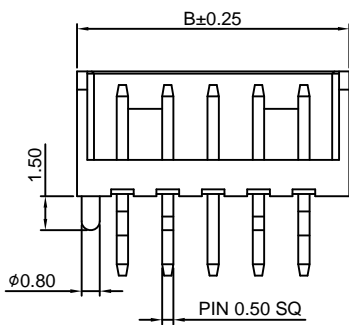
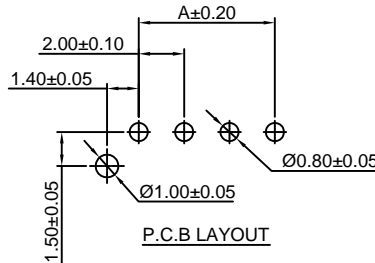
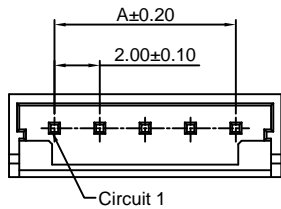

Ordering Information & Dimensions:

| PART NO. | Dimensions | |
|----------|------------|-------|
| | A | B |
| 2P | 2.00 | 6.00 |
| 3P | 4.00 | 8.00 |
| 4P | 6.00 | 10.00 |
| 5P | 8.00 | 12.00 |
| 6P | 10.00 | 14.00 |
| 7P | 12.00 | 16.00 |
| 8P | 14.00 | 18.00 |
| 9P | 16.00 | 20.00 |
| 10P | 18.00 | 22.00 |
| 11P | 20.00 | 24.00 |
| 12P | 22.00 | 26.00 |
| 13P | 24.00 | 28.00 |
| 14P | 26.00 | 30.00 |
| 15P | 28.00 | 32.00 |

Unit: mm

A2010WVA-F-2xXP

2.00mm Pitch 180° Dual Row Wafer

Reference Informations:

- *Material:Pin:Brass/Tin over Nickel
Insulator:Nylon 66,UL94V-0
- *Mates with CJT A2010HA-2xXP series Dual Row Housing
- *Color:Gray

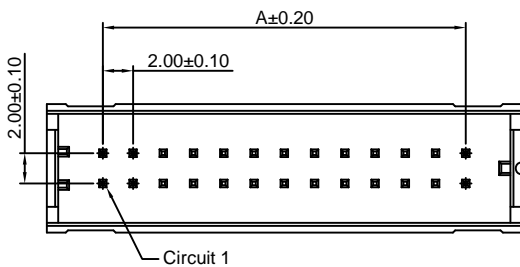
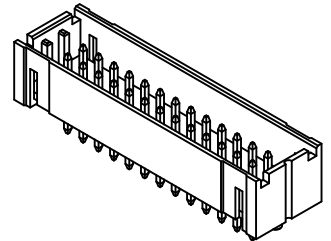
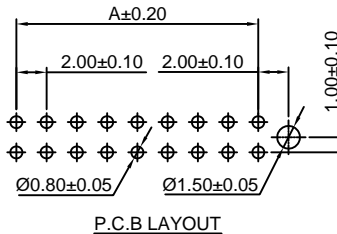

Ordering Information:

A2010WVA-F-2xXP - ***
1 2

- Part No.
- Material:
(Blank):Nylon 66,UL94V-0
GWT:Nylon 66,UL94V-0,GWT 750 °C

Ordering Information & Dimensions:

| PART NO. | Dimensions | |
|----------|------------|-------|
| | A | B |
| 2x2P | 2.00 | 9.40 |
| 2x3P | 4.00 | 11.40 |
| 2x4P | 6.00 | 13.40 |
| 2x5P | 8.00 | 15.40 |
| 2x6P | 10.00 | 17.40 |
| 2x7P | 12.00 | 19.40 |
| 2x8P | 14.00 | 21.40 |
| 2x9P | 16.00 | 23.40 |
| 2x10P | 18.00 | 25.40 |
| 2x11P | 20.00 | 27.40 |
| 2x12P | 22.00 | 29.40 |
| 2x13P | 24.00 | 31.40 |
| 2x14P | 26.00 | 33.40 |
| 2x15P | 28.00 | 35.40 |
| 2x16P | 30.00 | 37.40 |
| 2x17P | 32.00 | 39.40 |
| 2x20P | 38.00 | 45.40 |
| 2x25P | 48.00 | 55.40 |
| 2x30P | 58.00 | 65.40 |

Unit: mm

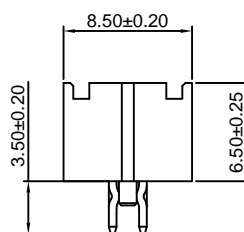
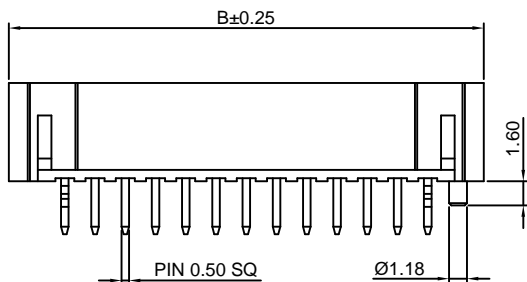

A2010WVB-F-2xXP

2.00mm Pitch 180° Dual Row Wafer

Reference Informations:

- *Material:Pin:Brass/Tin over Nickel
Insulator:Nylon 66,UL94V-0
- *Mates with CJT A2010HA-2xXP series Dual Row Housing
- *Color:Gray

Ordering Information:

- A2010WVB-F-2xXP - ***
1 2
- Part No.
 - Material:
(Blank):Nylon 66,UL94V-0
GWT:Nylon 66,UL94V-0,GWT 750 °C

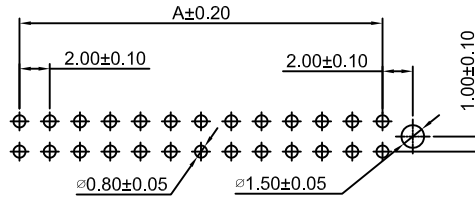
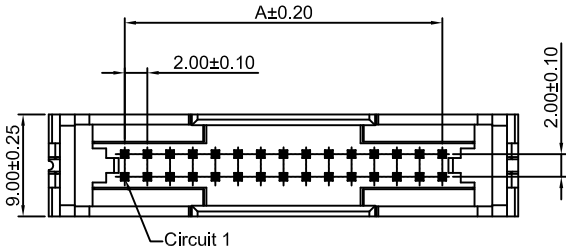
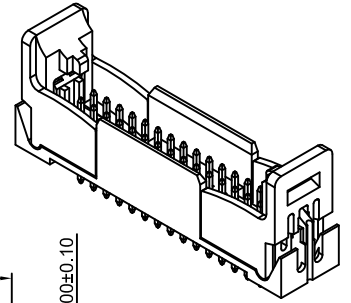

P.C.B LAYOUT

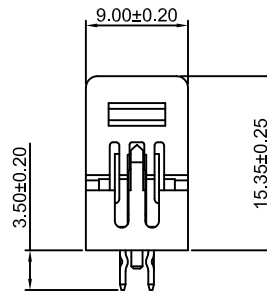
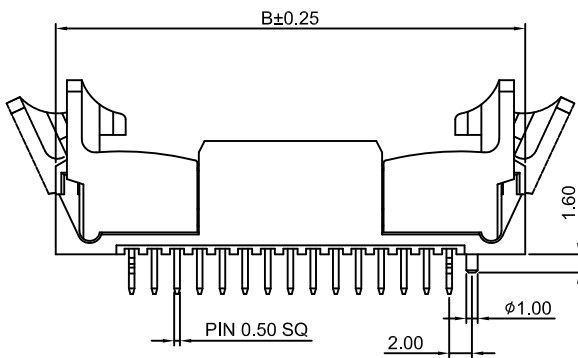

Ordering Information & Dimensions:

| PART NO. | Dimensions | |
|----------|------------|-------|
| | A | B |
| 2x15P | 28.00 | 41.40 |
| 2x17P | 32.00 | 45.40 |
| 2x20P | 38.00 | 51.40 |
| 2x25P | 48.00 | 61.40 |
| 2x30P | 58.00 | 71.40 |

Unit: mm

A2010WVC-S-XP

2.00mm Pitch 180° Wafer

Reference Informations:

- *Material:Pin:Brass/Tin over Nickel
Insulator:Nylon 9T,UL94V-0
- *Mates with CJT A2010HC-XP series Housing
- *Color:White

Ordering Information:

- A2010WVC-S-NP - *** - ***
1 2 3
- Part No.
 - Color:
(blank) - Natural
BK - Black
RD - Red
BL - Blue
 - Finish:
(blank) - Tin over Nickel
G - Gold over Nickel

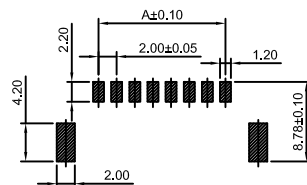
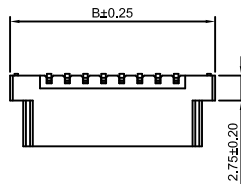
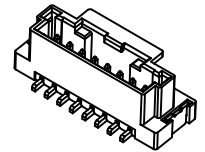

P.C.B LAYOUT

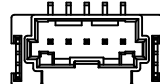
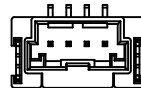
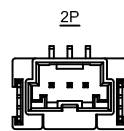
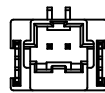
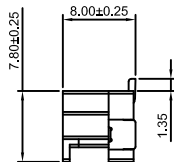
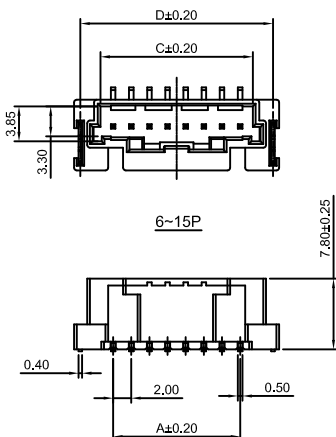

Ordering Information & Dimensions:

| PART NO. | Dimensions | | | |
|----------|------------|-------|-------|-------|
| | A | B | C | D |
| 2P | 2.00 | 10.60 | 4.80 | 9.23 |
| 3P | 4.00 | 12.60 | 6.80 | 11.23 |
| 4P | 6.00 | 14.60 | 8.80 | 13.23 |
| 5P | 8.00 | 16.60 | 10.80 | 15.23 |
| 6P | 10.00 | 18.60 | 12.80 | 17.23 |
| 7P | 12.00 | 20.60 | 14.80 | 19.23 |
| 8P | 14.00 | 22.60 | 16.80 | 21.23 |
| 9P | 16.00 | 24.60 | 18.80 | 23.23 |
| 10P | 18.00 | 26.60 | 20.80 | 25.23 |
| 11P | 20.00 | 28.60 | 22.80 | 27.23 |
| 12P | 22.00 | 30.60 | 24.80 | 29.23 |
| 13P | 24.00 | 32.60 | 26.80 | 31.23 |
| 14P | 26.00 | 34.60 | 28.80 | 33.23 |
| 15P | 28.00 | 36.60 | 30.80 | 35.23 |

Unit: mm

A2010WRC-S-XP

2.00mm Pitch 90° Wafer

Reference Informations:

*Material:Pin:Brass/Tin over Nickel

Insulator:Nylon 9T,UL94V-0

*Mates with CJT A2010HC-XP series Housing

*Color:White

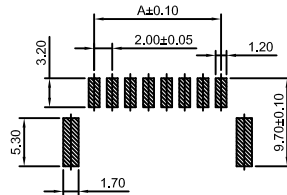
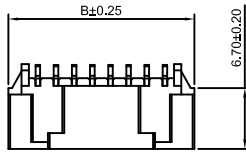
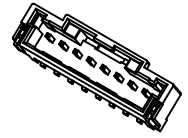

P.C.B LAYOUT

Ordering Information:
A2010WRC-S-XP - *** - ***
1 2 3
1.Part No.
2.Color:
(blank) - Natural
BK - Black
RD - Red
BL - Blue
3.Finish:
(blank) - Tin over Nickel
G - Gold over Nickel

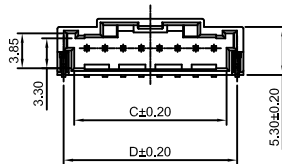

6~15P

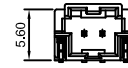
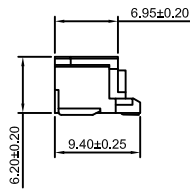

2P

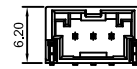

3P

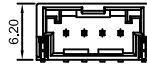

4P



5P

Ordering Information & Dimensions:

| PART NO. | Dimensions | | | |
|----------|------------|-------|-------|-------|
| | A | B | C | D |
| 2P | 2.00 | 8.50 | 4.80 | 7.13 |
| 3P | 4.00 | 10.50 | 6.80 | 9.13 |
| 4P | 6.00 | 12.50 | 8.80 | 11.13 |
| 5P | 8.00 | 14.50 | 10.80 | 13.13 |
| 6P | 10.00 | 16.50 | 12.80 | 15.13 |
| 7P | 12.00 | 18.50 | 14.80 | 17.13 |
| 8P | 14.00 | 20.50 | 16.80 | 19.13 |
| 9P | 16.00 | 22.50 | 18.80 | 21.13 |
| 10P | 18.00 | 24.50 | 20.80 | 23.13 |
| 11P | 20.00 | 26.50 | 22.80 | 25.13 |
| 12P | 22.00 | 28.50 | 24.80 | 27.13 |
| 13P | 24.00 | 30.50 | 26.80 | 29.13 |
| 14P | 26.00 | 32.50 | 28.80 | 31.13 |
| 15P | 28.00 | 34.50 | 30.80 | 33.13 |

Unit: mm

单击下面可查看定价，库存，交付和生命周期等信息

[>>CJT\(长江连接器\)](#)

[>>点击查看相关商品](#)