

## Specifications

- Current rating: 1A AC, DC
- Voltage rating: 150V AC, DC
- Temperature range: -40°C ~ +105°C
- Contact resistance: 30mΩ Max.
- Insulation resistance: 500MΩ Min.
- Withstanding voltage: 500V AC/minute
- \*Compliant with RoHS and REACH\*
- \*Meet the HF/Halogen Free, need to customize\*
- \*Contact CJT for details\*

## Standards



## Assembly layout

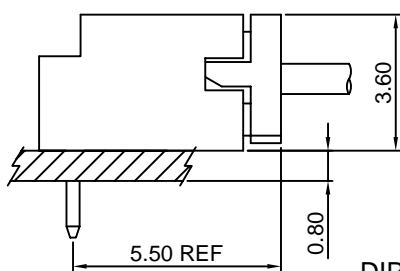

DIP TYPE

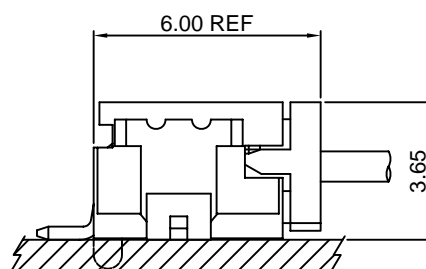
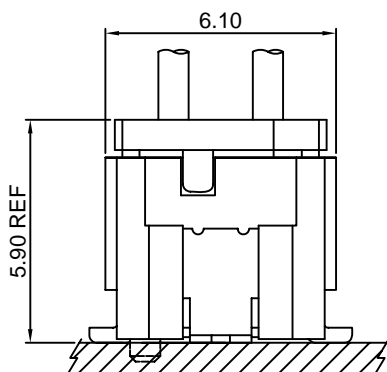
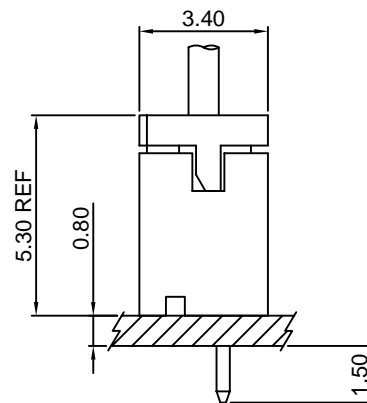

SMT TYPE

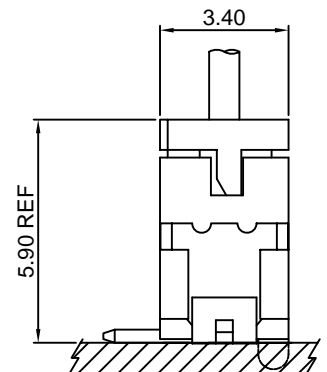

# A1252-T

1.25mm pitch Crimp Terminal

#### Reference Informations:

\*Used in CJT A1252H-XP, A1252HA-XP series Housing

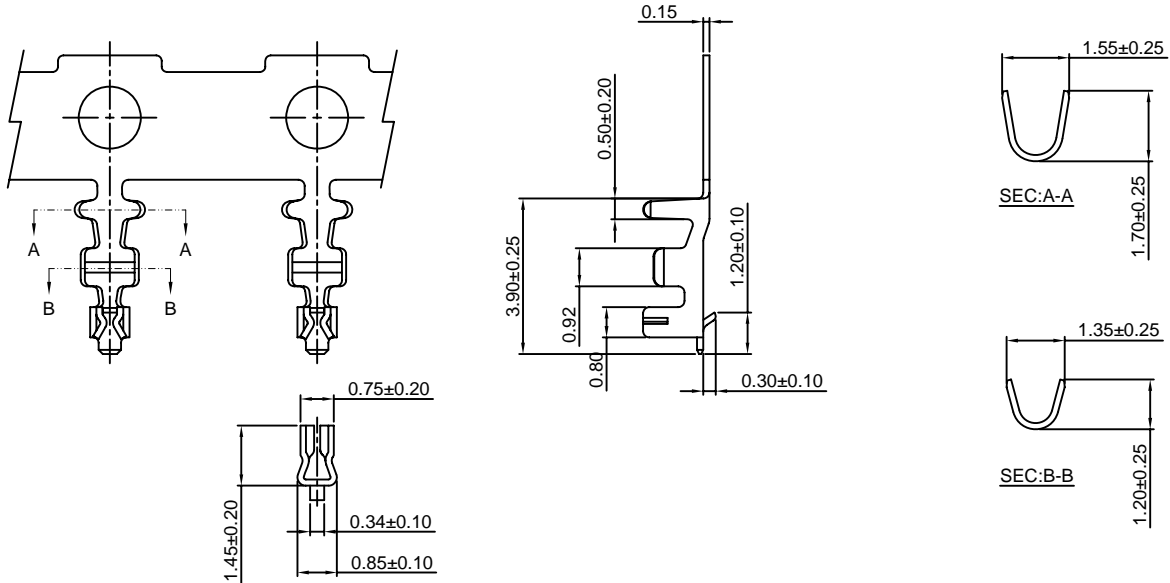

#### Ordering information & Specifications:

Unit:mm

Part NO.	Wire Range	Insulation O.D.	Material	Finish	Qty/reel
A1252-TP	AWG#26-#30	1.00mm(max)	Phosphor Bronze	Tin over Nickel	10,000 PCS
A1252-GP	AWG#26-#30	1.00mm(max)	Phosphor Bronze	Gold over Nickel	10,000 PCS

Optional Gold plating available but MOQ requested

# A1252H-XP

1.25mm pitch Single Row Housing

#### Reference Informations:

\*Material:Nylon 66,UL94V-0

\*Suitable CJT A1252-T series Terminal

\*Mates with CJT A1252WV,WR,WV-S,WV-S-F,WR-S,WR-S-F-XP

series Single Row Wafer

\*Color:Gray

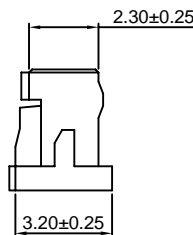
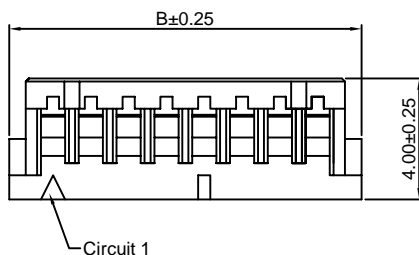
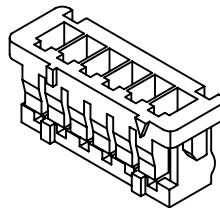
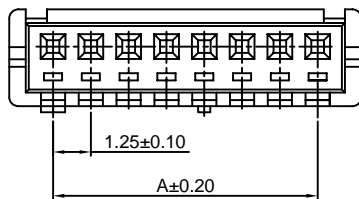

#### Ordering Information:

A1252H-XP - \*\*\*

1 2

1.Part No.

2.Material:

(Blank):Nylon 66,UL94V-0

GWT :Nylon 66,UL94V-0 GWT 750 °C

#### Ordering Information & Dimensions:

PART NO.	Dimensions	
	A	B
2P	1.25	4.15
3P	2.50	5.40
4P	3.75	6.65
5P	5.00	7.90
6P	6.25	9.15
7P	7.50	10.40
8P	8.75	11.65
9P	10.00	12.90
10P	11.25	14.15
11P	12.50	15.40
12P	13.75	16.65
13P	15.00	17.90
14P	16.25	19.15
15P	17.50	20.40

Unit: mm

### A1252HA-XP

1.25mm pitch Single Row Housing

**Reference Informations:**

- \*Material:Nylon 66,UL94V-0
- \*Suitable CJT A1252-T series Terminal
- \*Color:White

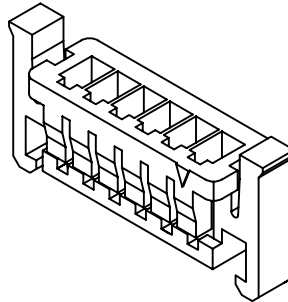
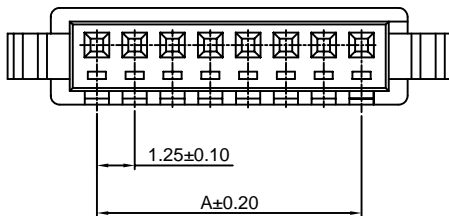

**Ordering Information:**

A1252HA-XP - \*\*\*  
1 2

- 1.Part No.
- 2.Material:  
(Blank):Nylon 66,UL94V-0  
GWT :Nylon 66,UL94V-0 GWT 750 °C

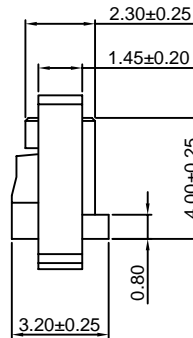
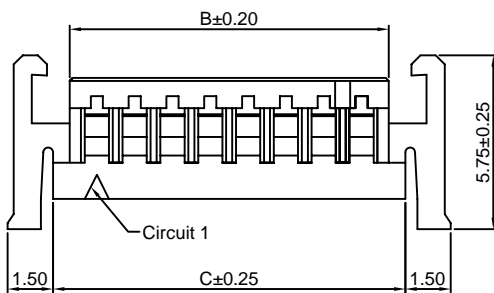

**Ordering Information & Dimensions:**

PART NO.	Dimensions		
	A	B	C
2P	1.25	2.90	4.15
3P	2.50	4.15	5.40
4P	3.75	5.40	6.65
5P	5.00	6.65	7.90
6P	6.25	7.90	9.15
7P	7.50	9.15	10.40
8P	8.75	10.40	11.65
9P	10.00	11.65	12.90
10P	11.25	12.90	14.15
11P	12.50	14.15	15.40
12P	13.75	15.40	16.65
13P	15.00	16.65	17.90
14P	16.25	17.90	19.15
15P	17.50	19.15	20.40

Unit: mm

### A1252H-2xXP

1.25mm pitch Dual Row Housing

**Reference Informations:**

- \*Material:Nylon 66,UL94V-0
- \*Suitable CJT A1252-T series Terminal
- \*Mates with CJT A1252WV-S,WV-S-F-2xXP series Dual Row Wafer
- \*Color:Gray

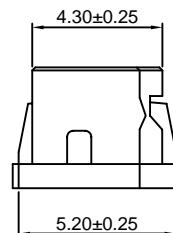
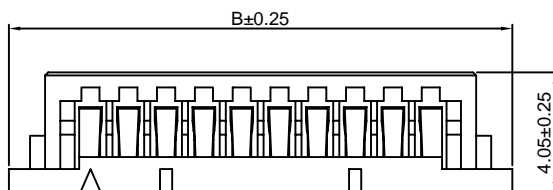
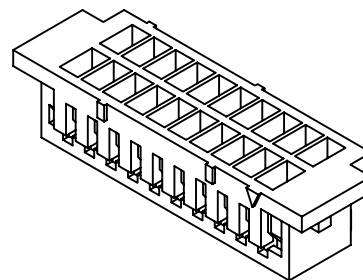
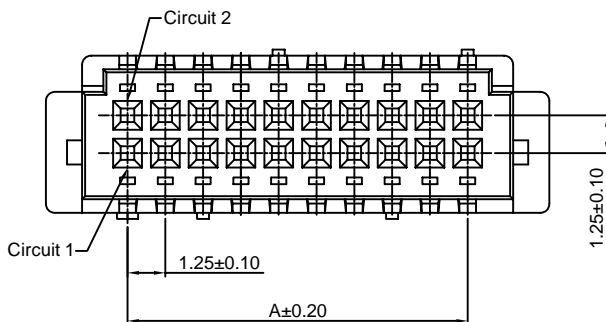

**Ordering Information:**

A1252H-2xXP - \*\*\*  
1 2

- 1.Part No.
- 2.Material:  
(Blank):Nylon 66,UL94V-0  
GWT :Nylon 66,UL94V-0 GWT 750 °C

**Ordering Information & Dimensions:**

PART NO.	Dimensions	
	A	B
2x5P	5.00	10.40
2x7P	7.50	12.90
2x10P	11.25	16.65
2x15P	17.50	22.90
2x20P	23.75	29.15

Unit: mm

### A1252WV-XP

1.25mm pitch 180° Single Row Wafer

#### Reference Informations:

- \*Material:Pin:Brass/Tin over Nickel  
Insulator:Nylon 66,UL94V-0
- \*Mates with CJT A1252H-XP series Single Row Housing
- \*Color:Gray

#### Ordering Information:

A1252WV-XP - \*\*\* - \*\*  
1 2 3

- 1.Part No.
- 2.Material:  
(Blank):Nylon 66,UL94V-0  
GWT:Nylon 66,UL94V-0,GWT 750°C
- 3.Finish:  
(Blank):Tin over Nickel  
G:Gold over Nickel

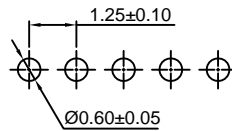
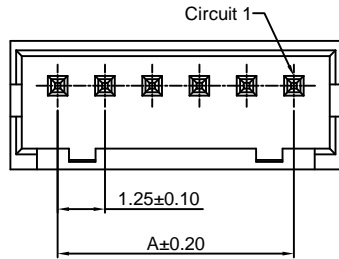
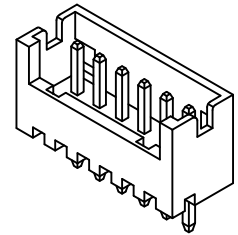

P.C.B LAYOUT

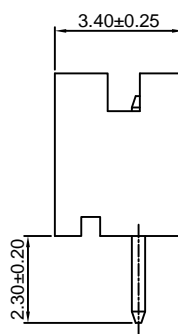
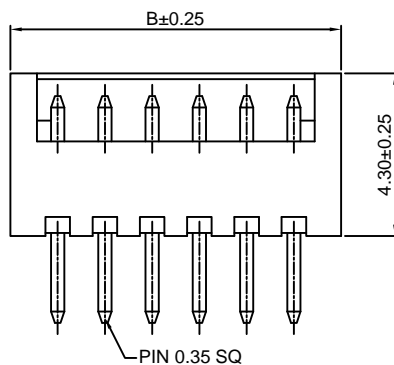

#### Ordering Information & Dimensions:

PART NO.	Dimensions	
	A	B
2P	1.25	3.75
3P	2.50	5.00
4P	3.75	6.25
5P	5.00	7.50
6P	6.25	8.75
7P	7.50	10.00
8P	8.75	11.25
9P	10.00	12.50
10P	11.25	13.75
11P	12.50	15.00
12P	13.75	16.25
13P	15.00	17.50
14P	16.25	18.75
15P	17.50	20.00

Unit: mm

### A1252WR-XP

1.25mm pitch 90° Single Row Wafer

#### Reference Informations:

- \*Material:Pin:Brass/Tin over Nickel  
Insulator:Nylon 66,UL94V-0
- \*Mates with CJT A1252H-XP series Single Row Housing
- \*Color:Gray

#### Ordering Information:

A1252WR-XP - \*\*\* - \*\*  
1 2 3

- 1.Part No.
- 2.Material:  
(Blank):Nylon 66,UL94V-0  
GWT:Nylon 66,UL94V-0,GWT 750°C
- 3.Finish:  
(Blank):Tin over Nickel  
G:Gold over Nickel

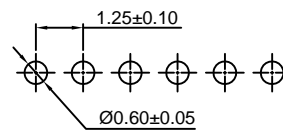
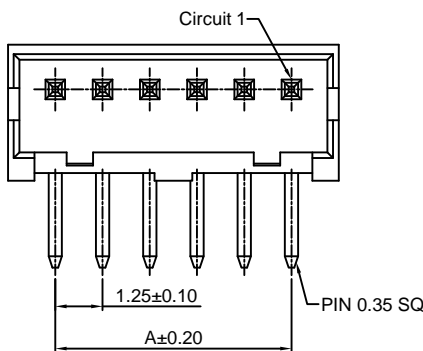
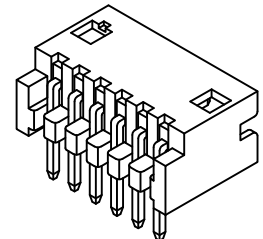

P.C.B LAYOUT

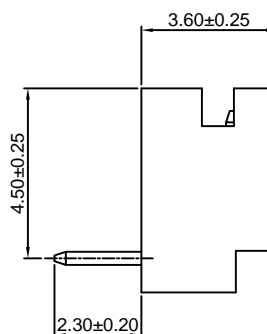
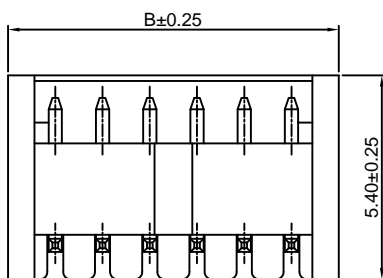

#### Ordering Information & Dimensions:

PART NO.	Dimensions	
	A	B
2P	1.25	3.75
3P	2.50	5.00
4P	3.75	6.25
5P	5.00	7.50
6P	6.25	8.75
7P	7.50	10.00
8P	8.75	11.25
9P	10.00	12.50
10P	11.25	13.75
11P	12.50	15.00
12P	13.75	16.25
13P	15.00	17.50
14P	16.25	18.75
15P	17.50	20.00

Unit: mm

### A1252WV-S-XP

1.25mm pitch 180° Single Row Wafer-SMT TYPE

#### Reference Informations:

- \*Material: Pin: Brass/Tin over Nickel  
Insulator: Nylon 6T, UL94V-0  
Cap: Nylon 6T, UL94V-0
- \*Mates with CJT A1252H-XP series Single Row Housing
- \*Color: Ivory

#### Ordering Information:

A1252WV-S-XP - \*\*\* - \*\*  
1 2 3

1. Part No.
2. Material:  
(Blank): Nylon 6T, UL94V-0  
GWT: Nylon 6T, UL94V-0, GWT 750°C
3. Finish:  
(Blank): Tin over Nickel  
G: Gold over Nickel

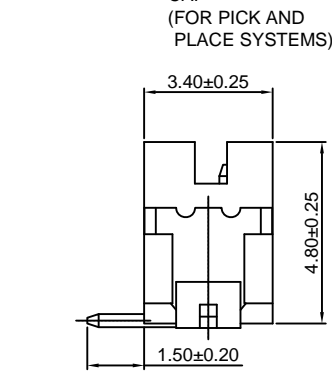
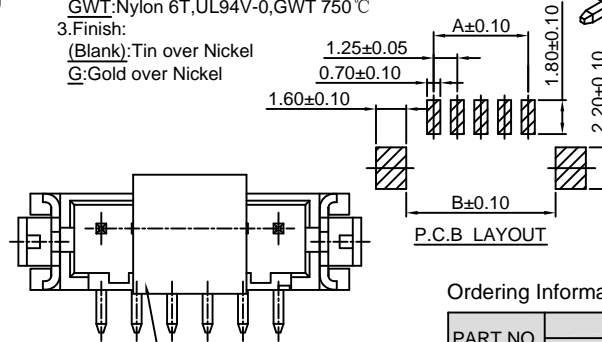
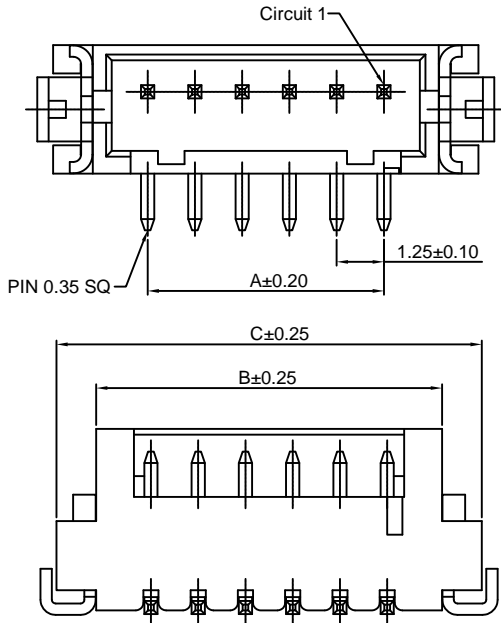
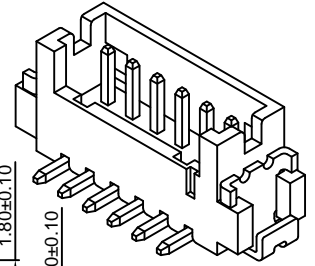

#### Ordering Information & Dimensions:

PART NO.	Dimensions		
	A	B	C
2P	1.25	4.15	6.25
3P	2.50	5.40	7.50
4P	3.75	6.65	8.75
5P	5.00	7.90	10.00
6P	6.25	9.15	11.25
7P	7.50	10.40	12.50
8P	8.75	11.65	13.75
9P	10.00	12.90	15.00
10P	11.25	14.15	16.25
11P	12.50	15.40	17.50
12P	13.75	16.65	18.75
13P	15.00	17.90	20.00
14P	16.25	19.15	21.25
15P	17.50	20.40	22.50

Unit: mm

### A1252WV-S-F-XP

1.25mm pitch 180° Single Row Wafer-SMT TYPE

#### Reference Informations:

- \*Material: Pin: Brass/Tin over Nickel  
Solder Tabs: Phosphor Bronze/Tin over Nickel  
Insulator: Nylon 6T, UL94V-0  
Cap: Nylon 6T, UL94V-0
- \*Mates with CJT A1252H-XP series Single Row Housing
- \*Color: Ivory

#### Ordering Information:

A1252WV-S-F-XP - \*\*\* - \*\*  
1 2 3

1. Part No.
2. Material:  
(Blank): Nylon 6T, UL94V-0  
GWT: Nylon 6T, UL94V-0, GWT 750°C
3. Finish:  
(Blank): Tin over Nickel  
G: Gold over Nickel

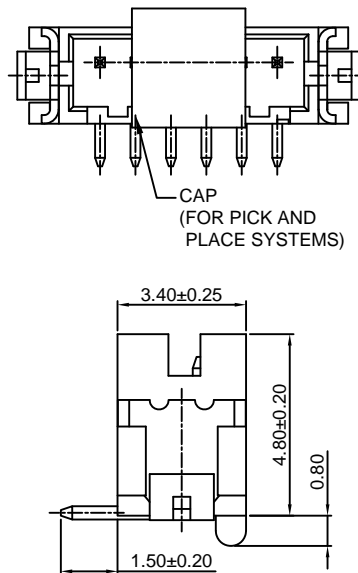
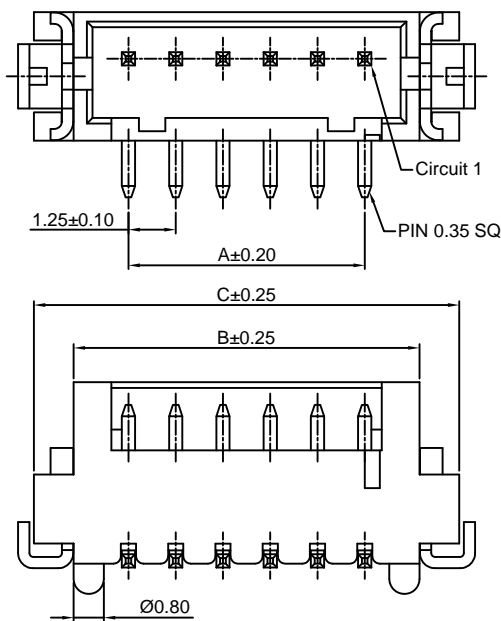
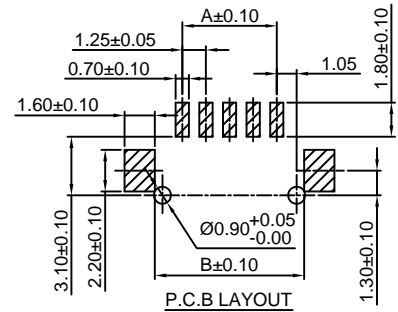

#### Ordering Information & Dimensions:

PART NO.	Dimensions		
	A	B	C
2P	1.25	4.15	6.25
3P	2.50	5.40	7.50
4P	3.75	6.65	8.75
5P	5.00	7.90	10.00
6P	6.25	9.15	11.25
7P	7.50	10.40	12.50
8P	8.75	11.65	13.75
9P	10.00	12.90	15.00
10P	11.25	14.15	16.25
11P	12.50	15.40	17.50
12P	13.75	16.65	18.75
13P	15.00	17.90	20.00
14P	16.25	19.15	21.25
15P	17.50	20.40	22.50

Unit: mm

### A1252WR-S-XP

1.25mm pitch 90° Single Row Wafer-SMT TYPE

#### Reference Informations:

- \*Material: Pin: Brass/Tin over Nickel  
Solder Tabs: Phosphor Bronze/Tin over Nickel  
Insulator: Nylon 6T, UL94V-0
- \*Mates with CJT A1252H-XP series Single Row Housing
- \*Color: Ivory

#### Ordering Information:

- A1252WR-S-XP - \*\*\* - \*\*
- 1                      2                      3
1. Part No.
  2. Material:  
(Blank): Nylon 6T, UL94V-0  
GWT: Nylon 6T, UL94V-0 GWT 750°C
  3. Finish:  
(Blank): Tin over Nickel  
G: Gold over Nickel

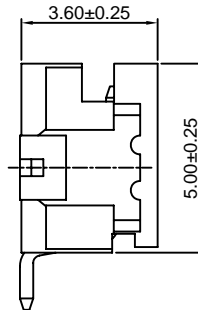
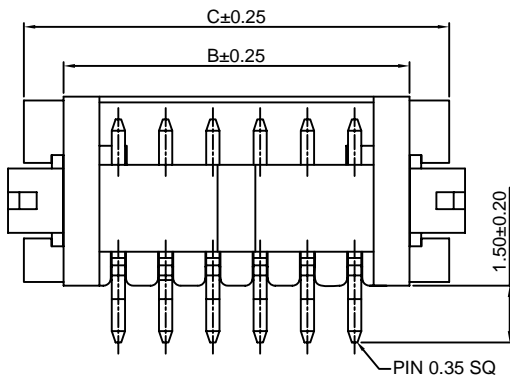
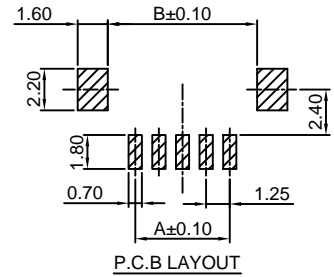
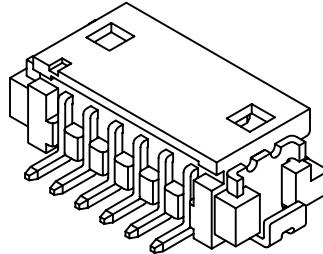
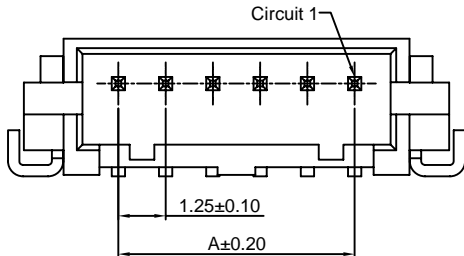

#### Ordering Information & Dimensions:

PART NO.	Dimensions		
	A	B	C
2P	1.25	4.15	6.25
3P	2.50	5.40	7.50
4P	3.75	6.65	8.75
5P	5.00	7.90	10.00
6P	6.25	9.15	11.25
7P	7.50	10.40	12.50
8P	8.75	11.65	13.75
9P	10.00	12.90	15.00
10P	11.25	14.15	16.25
11P	12.50	15.40	17.50
12P	13.75	16.65	18.75
13P	15.00	17.90	20.00
14P	16.25	19.15	21.25
15P	17.50	20.40	22.50

Unit: mm

### A1252WR-S-F-XP

1.25mm pitch 90° Single Row Wafer-SMT TYPE

#### Reference Informations:

- \*Material: Pin: Brass/Tin over Nickel  
Solder Tabs: Phosphor Bronze/Tin over Nickel  
Insulator: Nylon 6T, UL94V-0
- \*Mates with CJT A1252H-XP series Single Row Housing
- \*Color: Ivory

#### Ordering Information:

- A1252WR-S-XP - \*\*\* - \*\*
- 1                      2                      3
1. Part No.
  2. Material:  
(Blank): Nylon 6T, UL94V-0  
GWT: Nylon 6T, UL94V-0 GWT 750°C
  3. Finish:  
(Blank): Tin over Nickel  
G: Gold over Nickel

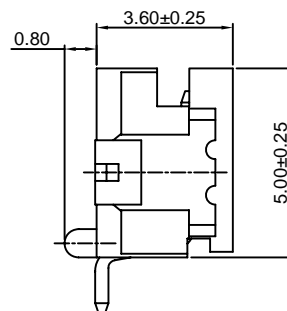
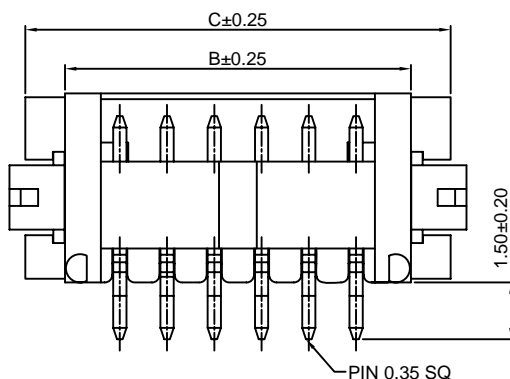
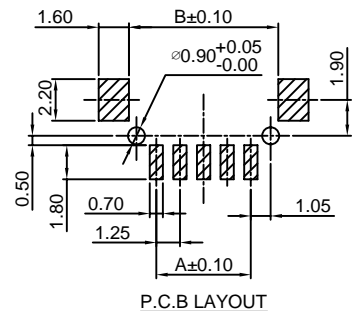
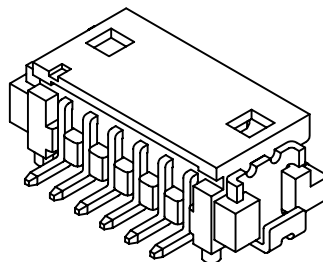
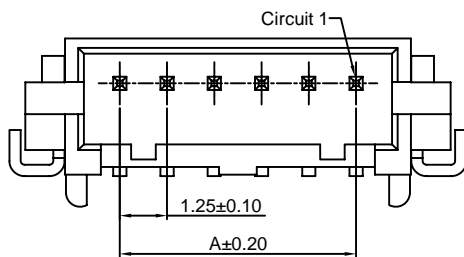

#### Ordering Information & Dimensions:

PART NO.	Dimensions		
	A	B	C
2P	1.25	4.15	6.25
3P	2.50	5.40	7.50
4P	3.75	6.65	8.75
5P	5.00	7.90	10.00
6P	6.25	9.15	11.25
7P	7.50	10.40	12.50
8P	8.75	11.65	13.75
9P	10.00	12.90	15.00
10P	11.25	14.15	16.25
11P	12.50	15.40	17.50
12P	13.75	16.65	18.75
13P	15.00	17.90	20.00
14P	16.25	19.15	21.25
15P	17.50	20.40	22.50

Unit: mm

### A1252WV-S-2xXP

1.25mm pitch 180° Dual Row Wafer-SMT TYPE

**Reference Informations:**

- \*Material:Pin:Brass/Tin over Nickel  
Solder Tabs:Phosphor Bronze/Tin over Nickel  
Insulator:Nylon 6T,UL94V-0  
Cap:Nylon 6T,UL94V-0
- \*Mates with CJT A1252H-2xXP series Dual Row Housing
- \*Color:Ivory

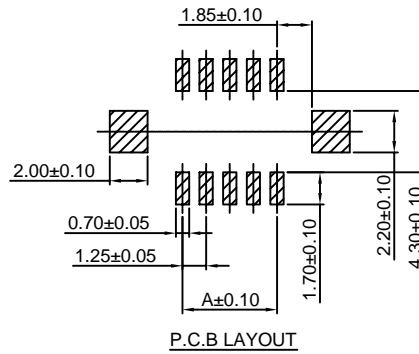
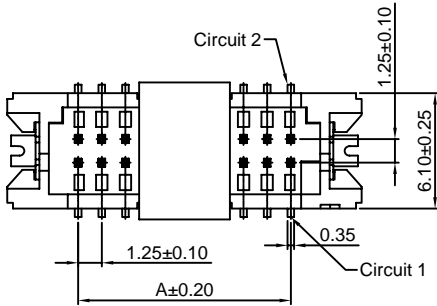
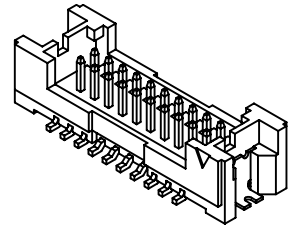

Ordering Information:  
A1252WV-S-2xXP - \*\*\* - \*\*  
1 2 3

- 1.Part No.
- 2.Material:  
(Blank):Nylon 6T,UL94V-0  
GWT:Nylon 6T,UL94V-0,GWT 750 °C
- 3.Finish:  
(Blank):Tin over Nickel  
G:Gold over Nickel

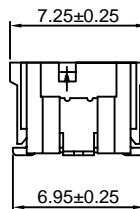
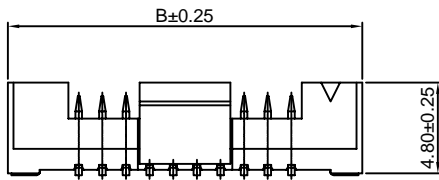

**Ordering Information & Dimensions:**

PART NO.	Dimensions	
	A	B
2x5P	5.00	12.50
2x7P	7.50	15.00
2x10P	11.25	18.75
2x15P	17.50	25.00
2x20P	23.75	31.25

Unit: mm

### A1252WV-S-F-2xXP

1.25mm pitch 180° Dual Row Wafer-SMT TYPE

**Reference Informations:**

- \*Material:Pin:Brass/Tin over Nickel  
Solder Tabs:Phosphor Bronze/Tin over Nickel  
Insulator:Nylon 6T,UL94V-0  
Cap:Nylon 6T,UL94V-0
- \*Mates with CJT A1252H-2xXP series Dual Row Housing
- \*Color:Ivory

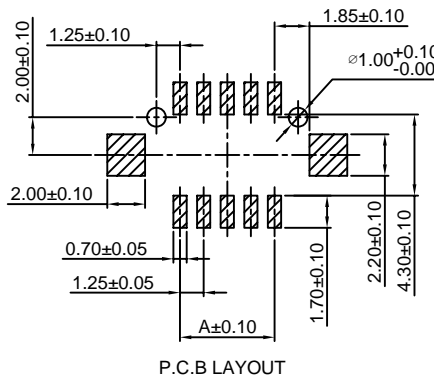
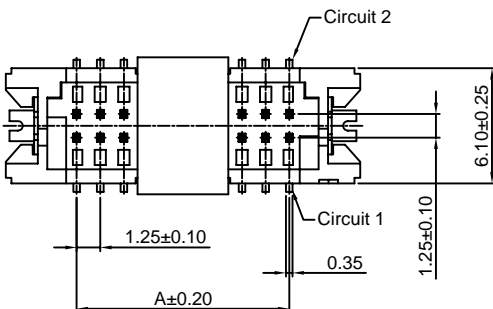
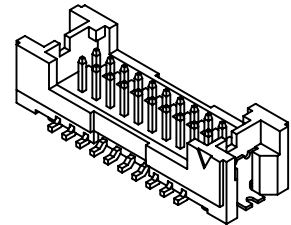

Ordering Information:  
A1252WV-S-F-2xXP - \*\*\* - \*\*  
1 2 3

- 1.Part No.
- 2.Material:  
(Blank):Nylon 6T,UL94V-0  
GWT:Nylon 6T,UL94V-0,GWT 750 °C
- 3.Finish:  
(Blank):Tin over Nickel  
G:Gold over Nickel

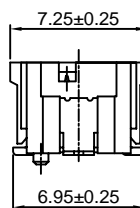
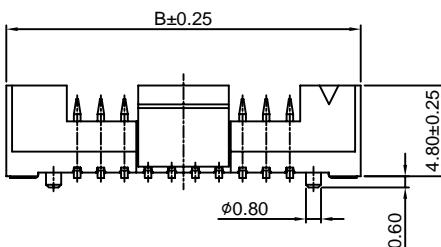

**Ordering Information & Dimensions:**

PART NO.	Dimensions	
	A	B
2x5P	5.00	12.50
2x7P	7.50	15.00
2x10P	11.25	18.75
2x15P	17.50	25.00
2x20P	23.75	31.25

Unit: mm

单击下面可查看定价，库存，交付和生命周期等信息

[>>CJT\(长江连接器\)](#)