

# CMI-CMMPP13070LH-SERIES



## Features

- ▶ High current and low profile.
- ▶ Metal powder molding type for EMC protection.
- ▶ Available tape and reel for auto insertion.
- ▶ RoHS compliant
- ▶ AEC-Q200 qualified.
- ▶ Halogen-Free

## Applications

- ▶ Equipment using for automobiles (ECM, airbags, headlights, electronic Powder steering, motors, ABS, other)

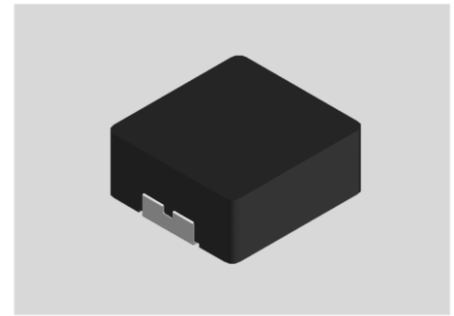

## Dimension (Unit:mm)

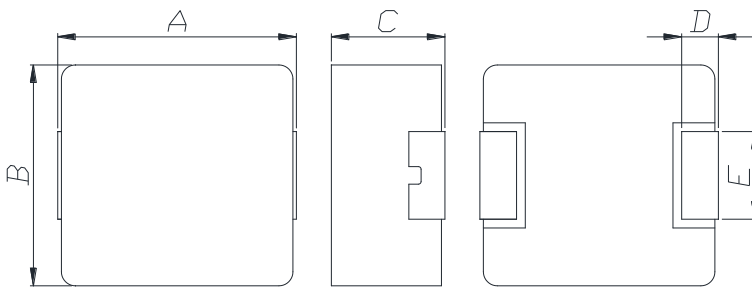

A	B	C	D	E
13.65±0.5	12.6±0.4	7.0 Max	2.0±0.5	5.0±0.2

## Land Pattern (Unit:mm)

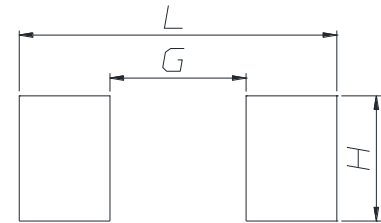

L	G	H
15.0	7.0	5.5

## Specifications

Part Number	Inductance (uH) ±20%	DCR(mohm) Max(Typ)	Isat(A) Max(Typ)	Itemp(A) Max(Typ)	Test Frequency (Hz)
CMI-CMMPP13070LH-1R5M	1.5	3.6(3.0)	48.00(50.00)	22.00(24.00)	1M
CMI-CMMPP13070LH-2R2M	2.2	4.0(3.3)	45.00(48.00)	19.80(22.00)	1M
CMI-CMMPP13070LH-3R3M	3.3	6.5(5.4)	38.00(40.00)	18.00(20.00)	1M
CMI-CMMPP13070LH-4R7M	4.7	10.5(9.0)	32.00(35.00)	14.00(15.00)	1M
CMI-CMMPP13070LH-100M	10	16(13.2)	21.00(23.00)	13.00(14.00)	1M
CMI-CMMPP13070LH-220M	22	38(32)	14.50(16.00)	11.00(12.00)	1M
CMI-CMMPP13070LH-470M	47	84(70)	11.00(12.00)	6.20(6.30)	1M

- Isat: When based on the inductance change rate (approximately 30% below in the initial value)
- Itemp: When based on the temperature increase (Temperature increase of approximately 40°C by self heating)
- Operating Temperature Range(including self temperature) : -40°C ~ +165 °C

Note 1 : Circuit design, component placement, PCB trace size and thickness, airflow and other cooling. Provision all affect the part Temperature. Part temperature should be verified in the end application.

• You can also contact us by e-mail : [coilmaster@coilmaster.com](mailto:coilmaster@coilmaster.com)

- All specifications are subject to change without notice.
- Update date : 2019.02.07

[www.coilmaster.com](http://www.coilmaster.com)

## DC BIAS vs INDUCTANCE

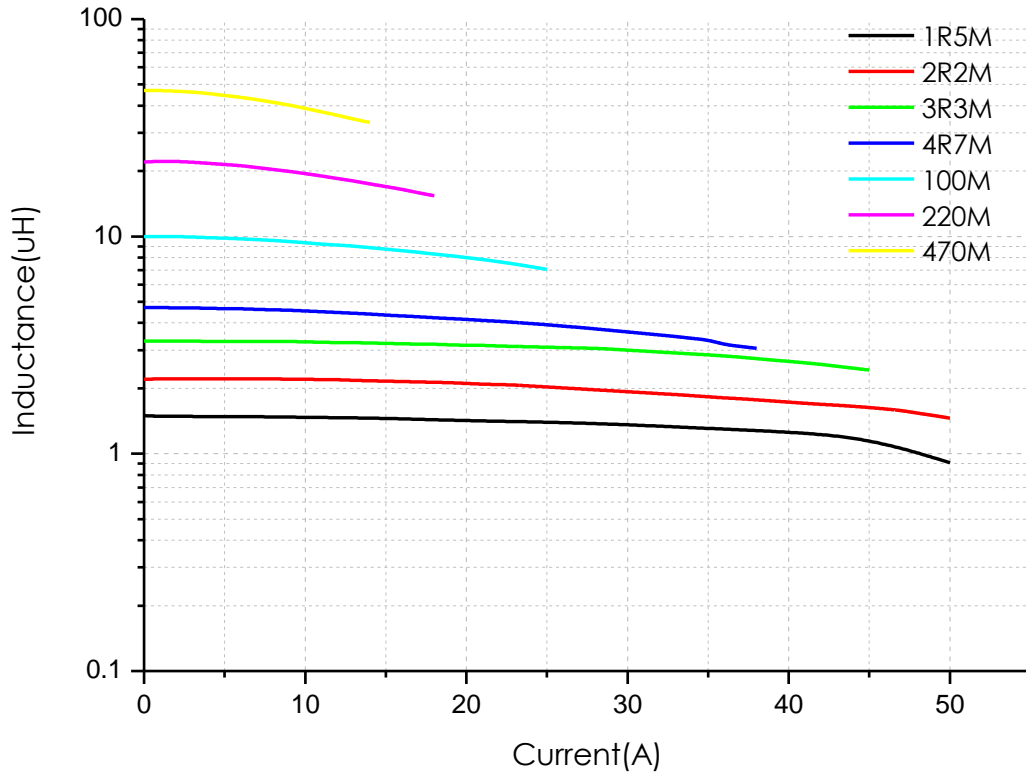

## DC BIAS vs TEMPERATURE

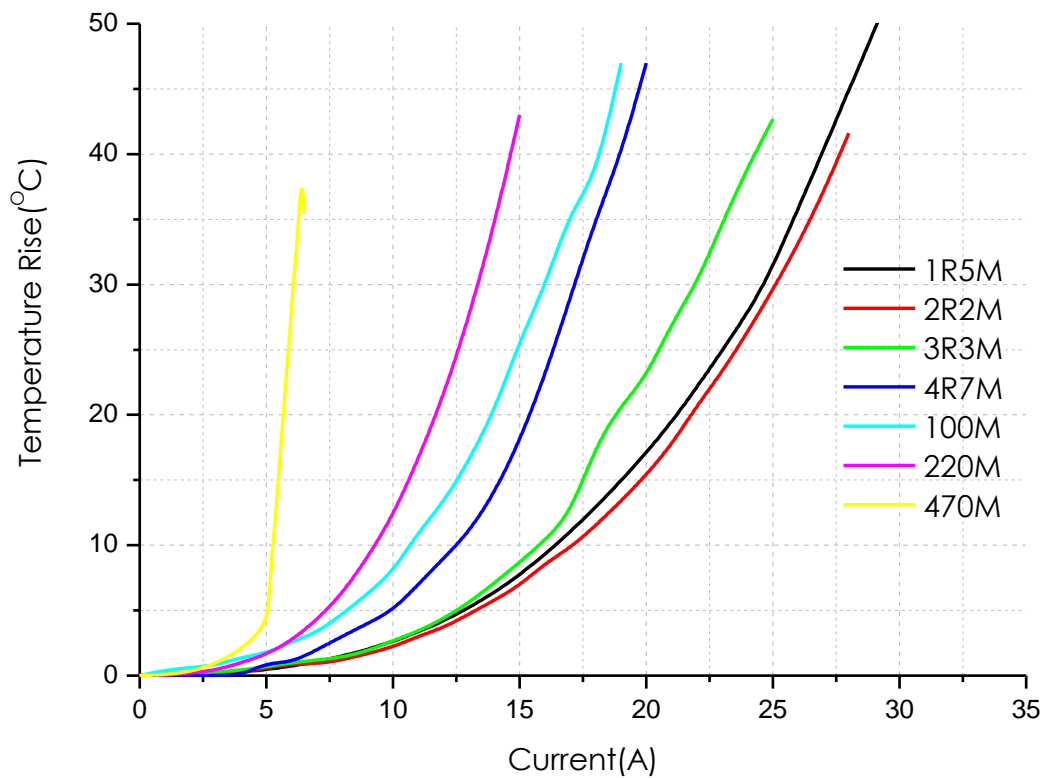

- You can also contact us by e-mail : [coilmaster@coilmaster.com](mailto:coilmaster@coilmaster.com)
- All specifications are subject to change without notice.
- Update date : 2019.02.07

## Packaging

(1) Package quantity : 300 (pcs/reel)

(2) Reel Dimensions (unit:mm)

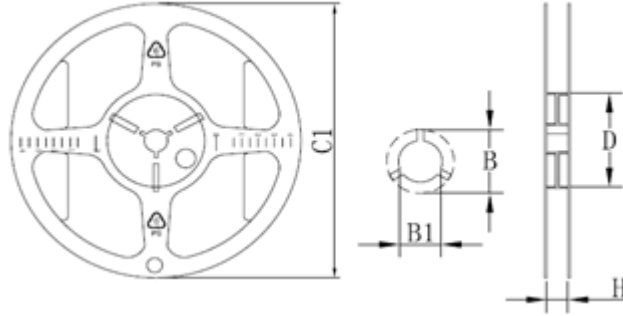

C1	B	B1	D	H
Φ330	Φ21.0±0.8	Φ13.0±0.4	Φ100	24.5

(3) Tape Dimensions

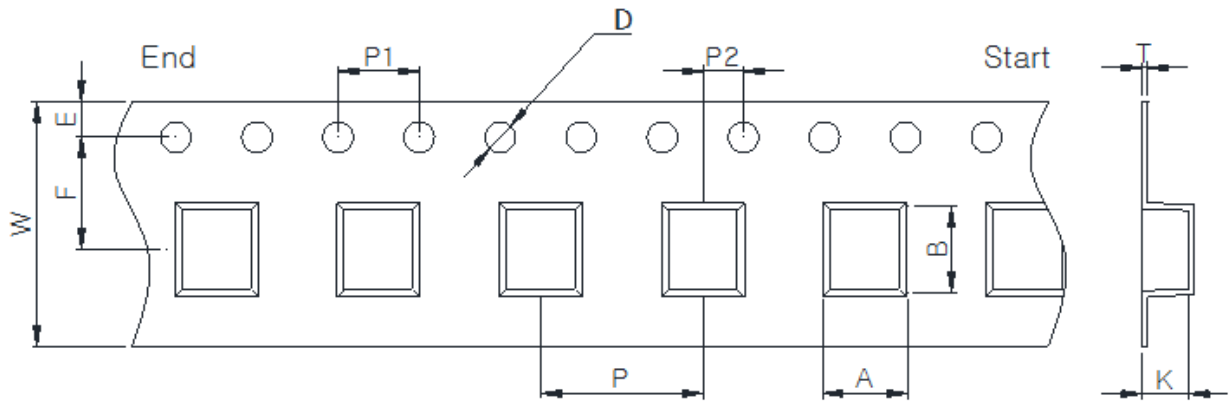

W	A	B	K	E	F	P	P1	P2	D	T
24.00	14.20	13.00	7.30	1.75	11.50	20.00	4.00	2.00	1.50	0.40
+0.30	+0.10	+0.10	+0.10	+0.10	+0.10	+0.10	+0.10	+0.10	+0.10	+0.05
-0.30	-0.10	-0.10	-0.10	-0.10	-0.10	-0.10	-0.10	-0.10	-0.00	-0.05

Ilisan Sales Office (KOREA) +82)31-904-1444  
 Shenzhen Sales Office (CHINA) +86)755-8663-6929  
 Hungary Sales office (EUROPE) +36)30-913-7706

H.K Sales Office (HONGKONG) +852)2711-5551  
 LA Sales Office (USA) +1)866-446-3586

• You can also contact us by e-mail : [coilmaster@coilmaster.com](mailto:coilmaster@coilmaster.com)

- All specifications are subject to change without notice.
- Update date : 2019.02.07

[www.coilmaster.com](http://www.coilmaster.com)

单击下面可查看定价，库存，交付和生命周期等信息

[>>coilmaster\(卡尔马斯特\)](#)