

CMI-CMMPP252012MH-SERIES



Features

- ▶ Small size, high current and low profile.
- ▶ Metal powder molding type for EMC protection.
- ▶ Lower DCR with applying flat wire.
- ▶ Available tape and reel for auto insertion.
- ▶ Halogen-Free
- ▶ RoHS compliant.
- ▶ AEC-Q200 qualified.



Applications

- ▶ Equipment using for automobiles (ECM, airbags, headlights, electronic Powder steering, motors, ABS, other)

Dimension (Unit:mm)

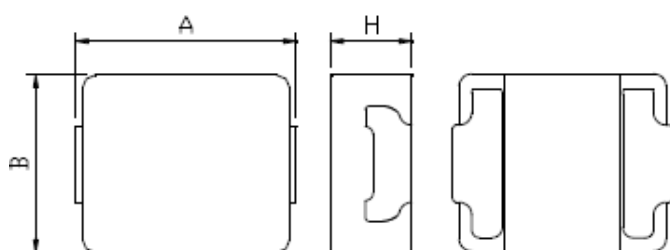

A	B	H
2.5±0.2	2.0±0.2	1.2Max

Land Pattern (Unit:mm)

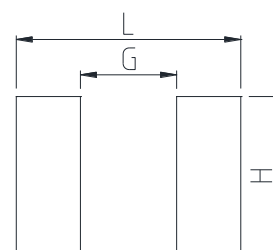

L	G	H
2.80	1.20	2.00

Specifications

Part Number	Inductance (uH) ±20%	DCR(mohm) Max(Typ)	IDC1(A) Max(Typ)	IDC2(A) Max(Typ)	Test Frequency (Hz)
CMI-CMMPP252012MH-R24M	0.24	16.9(13.0)	9.20(9.70)	6.40(7.10)	1M
CMI-CMMPP252012MH-R33M	0.33	19.5(15.0)	6.70(7.20)	5.40(6.00)	1M
CMI-CMMPP252012MH-R47M	0.47	30.0(24.0)	5.30(5.90)	4.00(4.50)	1M
CMI-CMMPP252012MH-R68M	0.68	40.0(29.0)	4.60(5.20)	3.80(4.30)	1M
CMI-CMMPP252012MH-1R0M	1.0	66.0(47.0)	3.50(4.00)	2.90(3.30)	1M
CMI-CMMPP252012MH-1R5M	1.5	80.0(60.0)	2.90(3.30)	2.50(2.90)	1M
CMI-CMMPP252012MH-2R2M	2.2	100.0(85.0)	2.20(2.50)	2.10(2.40)	1M
CMI-CMMPP252012MH-4R7M	4.7	240.0(188.0)	1.70(1.90)	1.40(1.60)	1M
CMI-CMMPP252012MH-6R8M	6.8	320.0(260.0)	1.70(1.90)	1.30(1.50)	1M

- IDC1: When based on the inductance change rate (approximately 30% below in the initial value)
- IDC2: When based on the temperature increase (Temperature increase of approximately 40°C by self heating)
- Operating Temperature Range(including self temperature) : -40°C ~ +165 °C

Ilisan Sales Office (KOREA) +82)31-904-1444
 Shenzhen Sales Office (CHINA) +86)755-8663-6929
 Hungary Sales office (EUROPE) +36)30-913-7706

H.K Sales Office (HONGKONG) +852)2711-5551
 LA Sales Office (USA) +1)866-446-3586

• You can also contact us by e-mail : coilmaster@coilmaster.com

- All specifications are subject to change without notice.
- Update date : 2018.10.25

www.coilmaster.com

单击下面可查看定价，库存，交付和生命周期等信息

[>>coilmaster\(卡尔马斯特\)](#)