



**DS520-30 Schottky Barrier Diode**

**Feature**

- Small surface mounting type
- Low reverse current and low forward voltage
- High reliability

**Application**

- High speed switch for detection
- For portable equipment:( Mobile phone, MP3, MD, CD-ROM, DVD-ROM, Note book PC, etc.)

**MARKING:**



Front Side

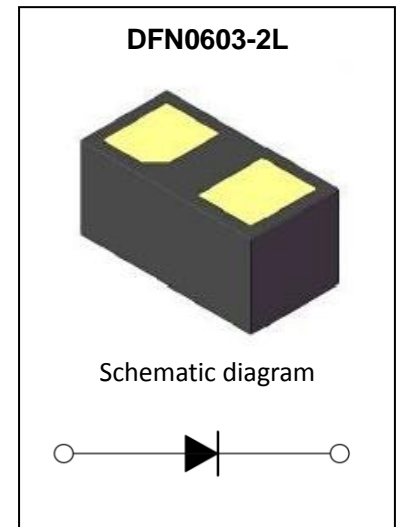

**ABSOLUTE MAXIMUM RATINGS (T<sub>a</sub>=25°C unless otherwise noted)**

Parameter	Symbol	Value	Unit
DC reverse voltage	V <sub>R</sub>	30	V
RMS reverse Voltage	V <sub>R(RMS)</sub>	21	V
Mean rectifying current	I <sub>o</sub>	0.1	A
Non-repetitive Peak Forward Surge Current @ t=8.3ms	I <sub>FSM</sub>	0.5	A
Power Dissipation	P <sub>D</sub>	100	mW
Thermal Resistance from Junction to Ambient	R <sub>θJA</sub>	1000	°C/W
Junction Temperature	T <sub>J</sub>	125	°C
Storage Temperature	T <sub>STG</sub>	-55 ~ +150	°C

**ELECTRICAL CHARACTERISTICS (T<sub>a</sub>=25°C unless otherwise noted)**

Parameter	Symbol	Test Condition	Min	Type	Max	Unit
Reverse voltage	V <sub>BR</sub>	I <sub>R</sub> =50uA	30			V
Reverse current	I <sub>R</sub>	V <sub>R</sub> =10V			0.3	μA
		V <sub>R</sub> =30V			20	μA
Forward voltage	V <sub>F</sub>	I <sub>F</sub> =10mA			0.45	V
		I <sub>F</sub> =100mA			0.65	V

**Typical Characteristics**

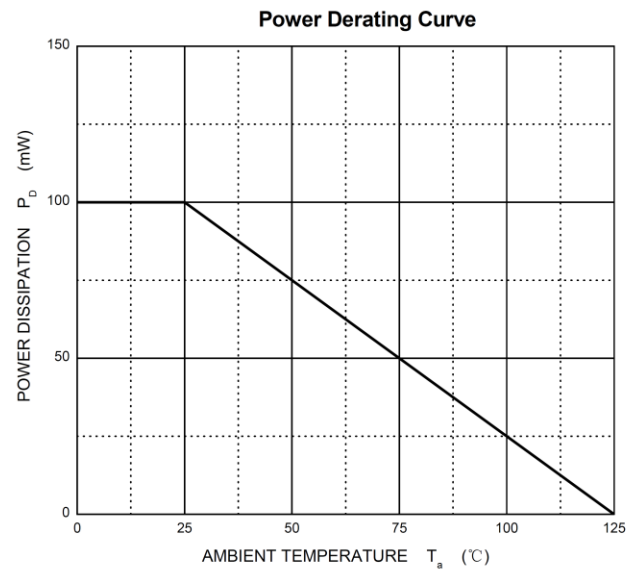
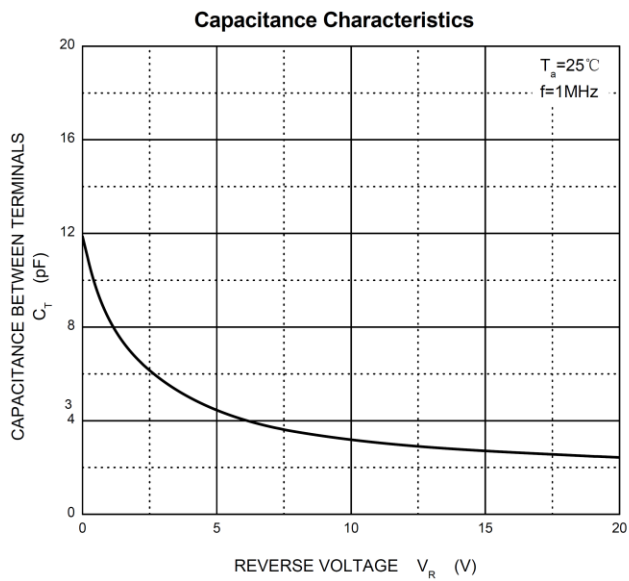
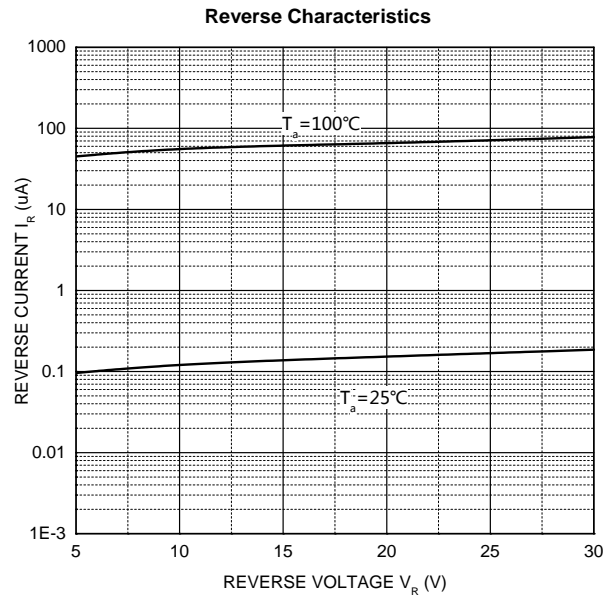
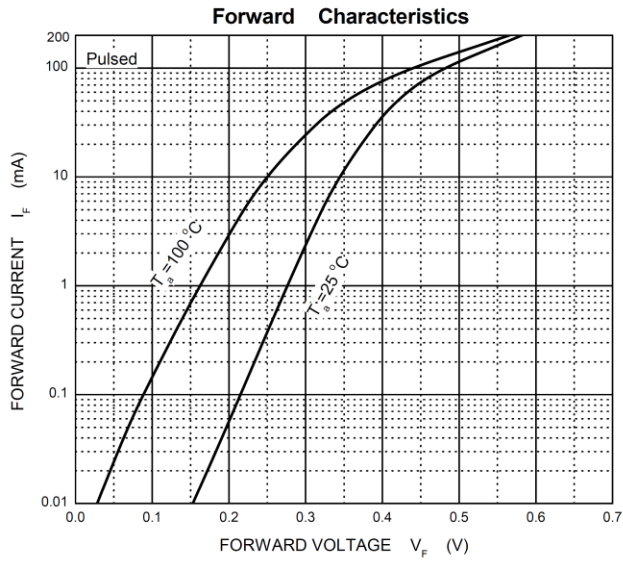

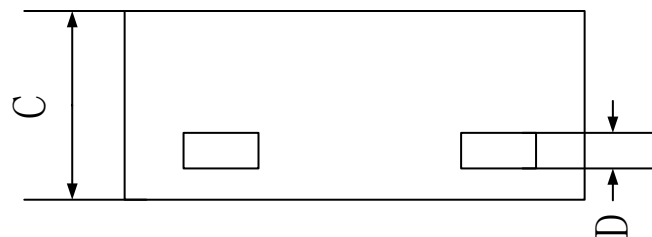
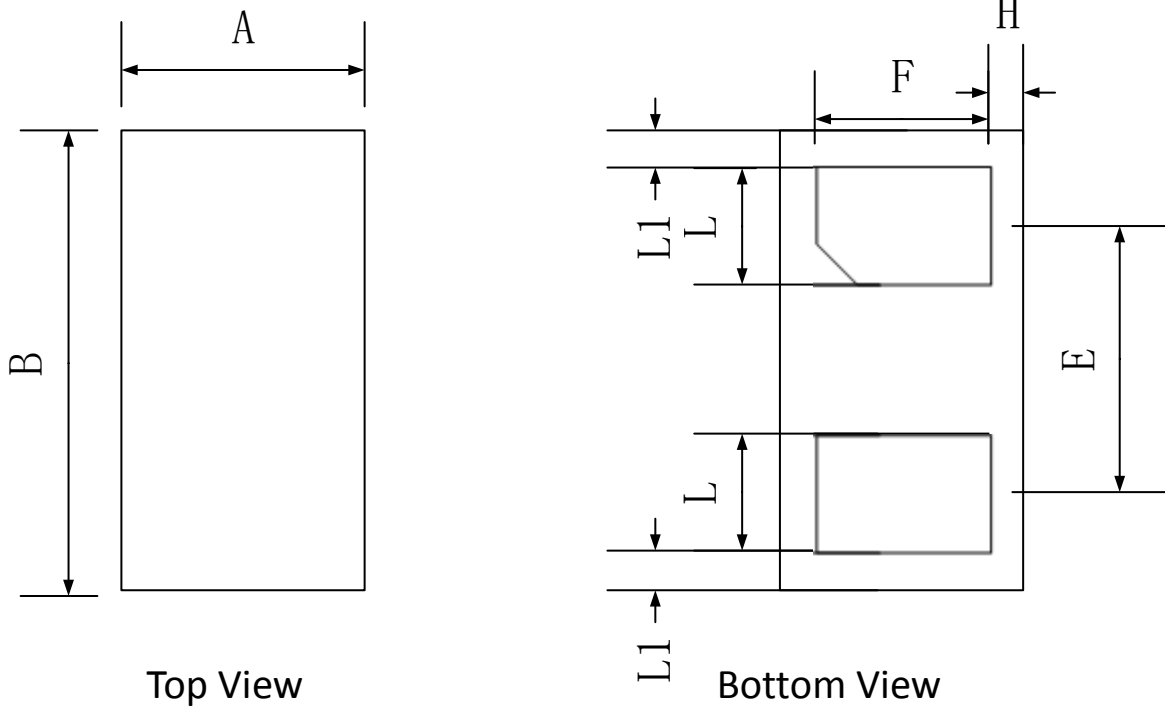
**DFN0603-2L Package Outline Dimensions**

	Dimensions In Millimeters		
	Min.	Typ.	Max.
A	0.25	0.30	0.35
B	0.55	0.60	0.65
C	0.27	0.30	0.34
D	0.050REF		
E	-	0.35	-
F	0.20	0.25	0.35
H	0.045 REF		
L	0.13	0.18	0.23
L1	0.045REF		

单击下面可查看定价，库存，交付和生命周期等信息

[>>GP\(格瑞宝\)](#)