

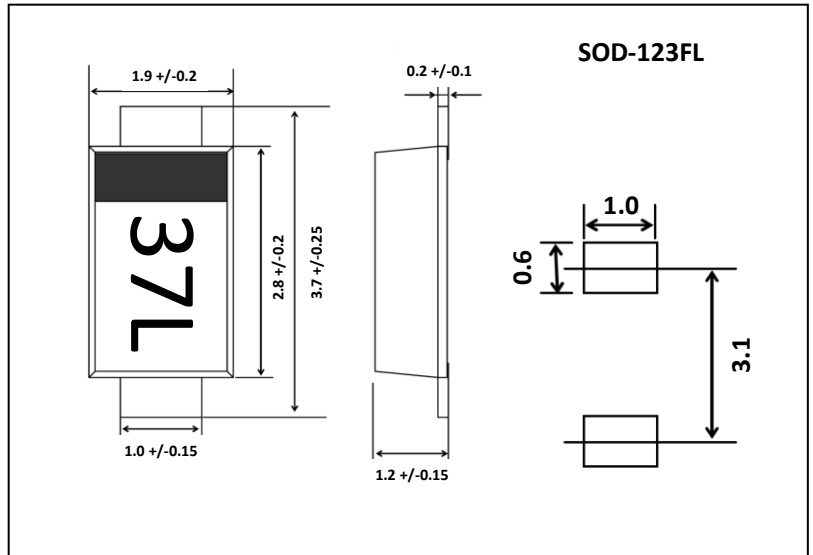

RB060M-60L Schottky Barrier Diode

Feature

- Small Power Mold Type
- Low VF
- Low IR
- High Reliability



MARKING:



ABSOLUTE MAXIMUM RATINGS (T_a=25°C unless otherwise noted)

Parameter	Symbol	Value	Unit
DC reverse voltage	V _R	60	V
Mean rectifying current	I _O	2	A
Non-repetitive Peak Forward Surge Current @ t=8.3ms	I _{FSM}	30	A
Power Dissipation	P _D	0.35	W
Thermal Resistance from Junction to Ambient	R _{θJA}	357	°C/W
Junction Temperature	T _J	150	°C
Storage Temperature	T _{STG}	-55 ~ +150	°C

ELECTRICAL CHARACTERISTICS(T_a=25°C unless otherwise noted)

Parameter	Symbol	Test Condition	Min	Type	Max	Unit
Reverse voltage	V _{BR}	I _R =250μA	60	70		V
Forward voltage	V _F	I _F =1.0A	0	0.44	0.50	V
		I _F =2.0A	0	0.50	0.58	V
Reverse current	I _R	V _R =60V		2	20	μA

Typical Characteristics

Forward Characteristics

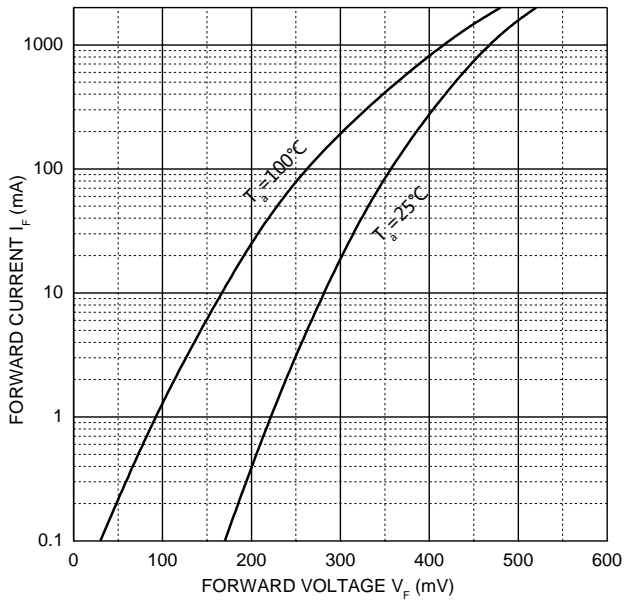

Reverse Characteristics

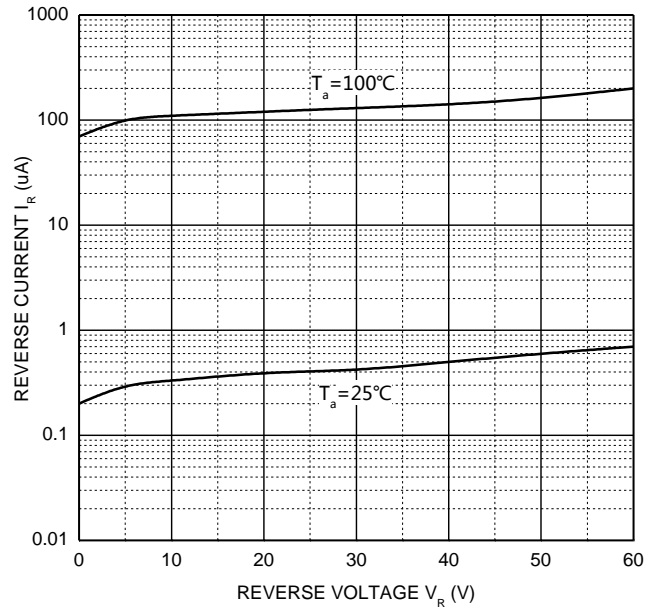

Capacitance Characteristics

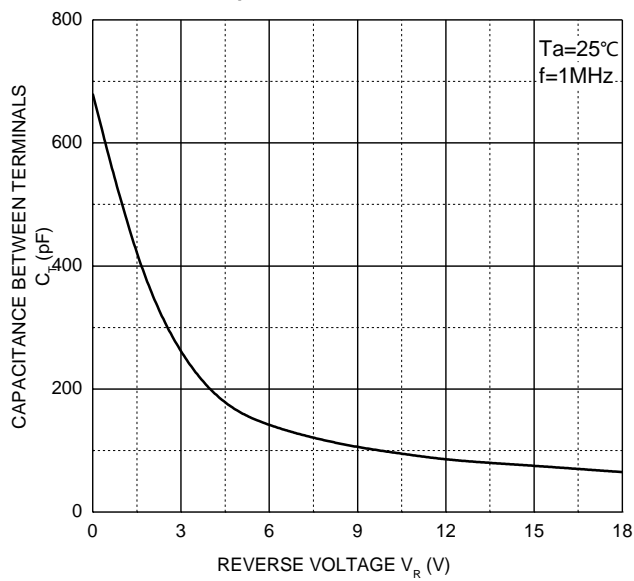

Power Derating Curve

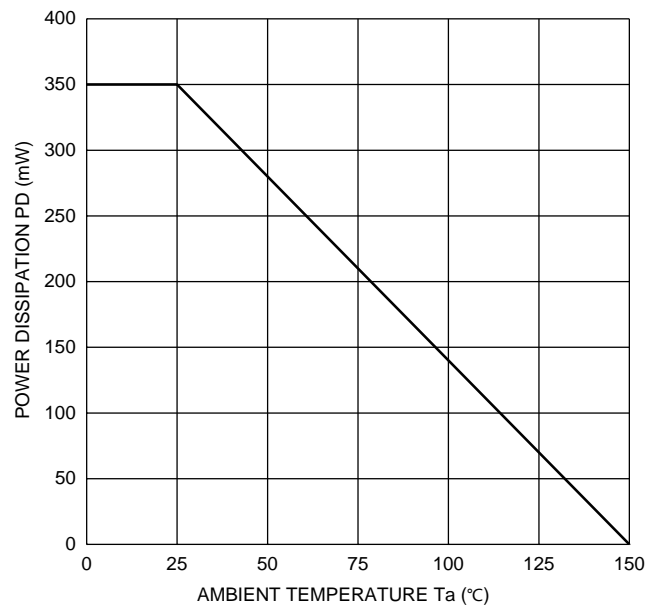

SOD-123FL Tape and Reel

SOD-123FL Tape

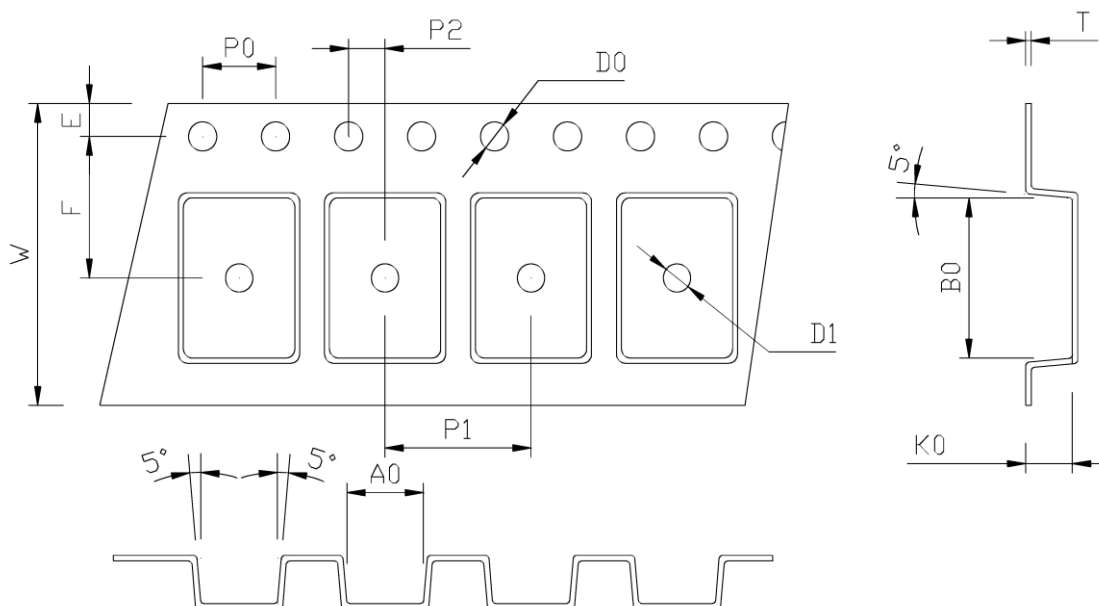

W	E	F	D0	D1	P0	P1	P2	A0	B0	K0	T
8.00±0.1	1.75±0.1	3.50±0.05	1.55±0.1	1.1±0.1	4.00±0.1	4.00±0.1	2.00±0.05	1.9±0.1	3.93±0.1	1.34±0.05	0.23±0.05

SOD-123FL Reel

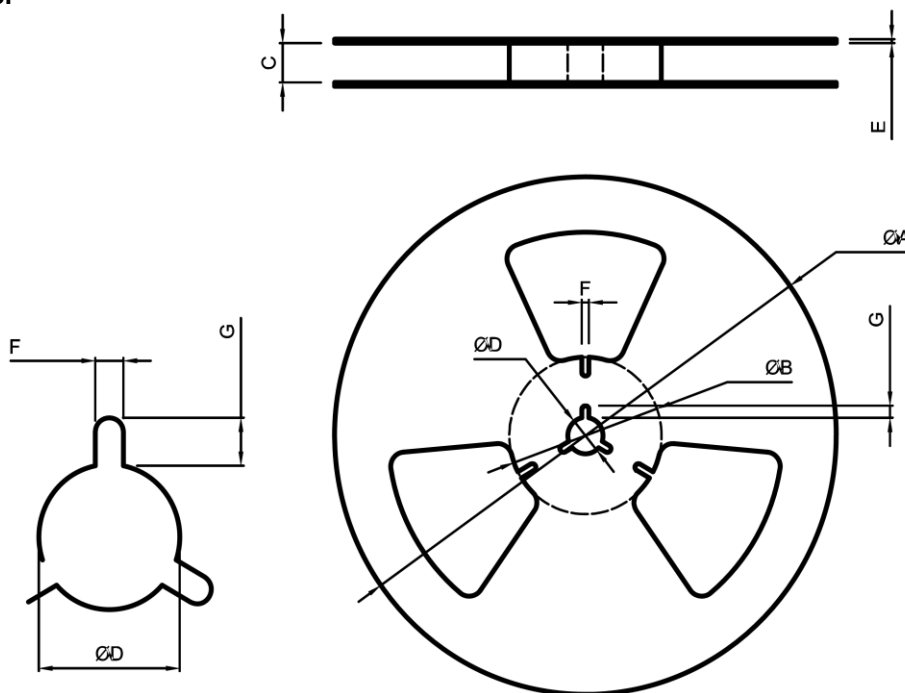

13寸盘卷

型号	A	B	C	D	E	F	G
13'SOD-123FL	330±1.0	75±1.0	13.5±1.0	13.5±0.5	2.3±0.1	3.0±0.5	4.5±0.5

单击下面可查看定价，库存，交付和生命周期等信息

[>>GP\(格瑞宝\)](#)