

Alle Rechte vorbehalten/ All rights reserved

Y
(Lochbild)
(board drillings)

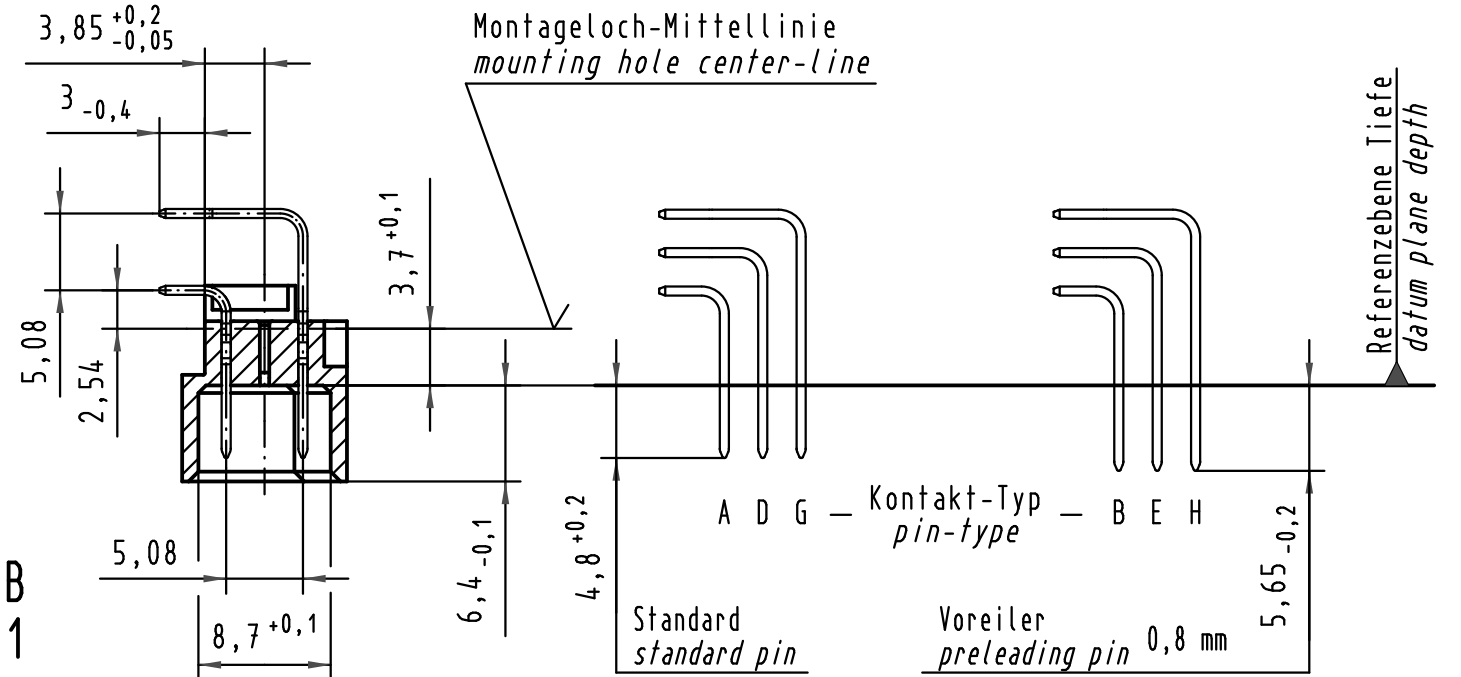

X Kontaktbelegung
contact loading

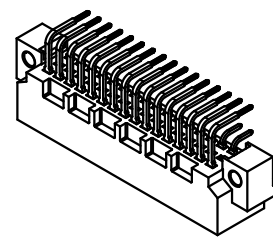
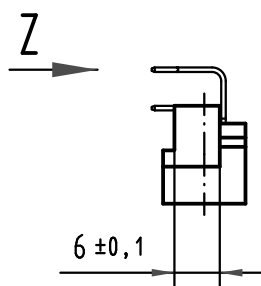
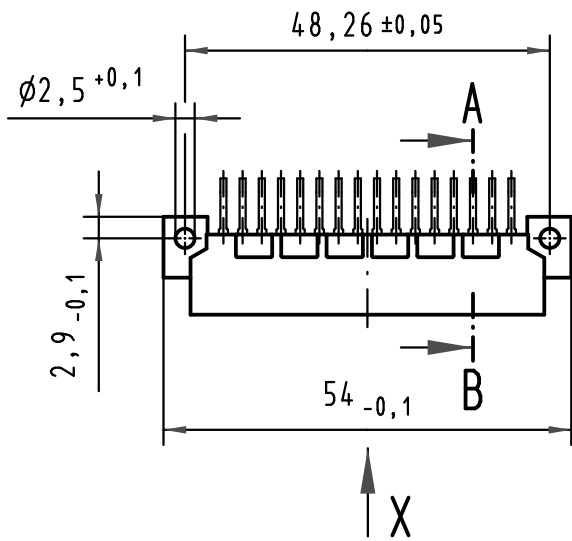
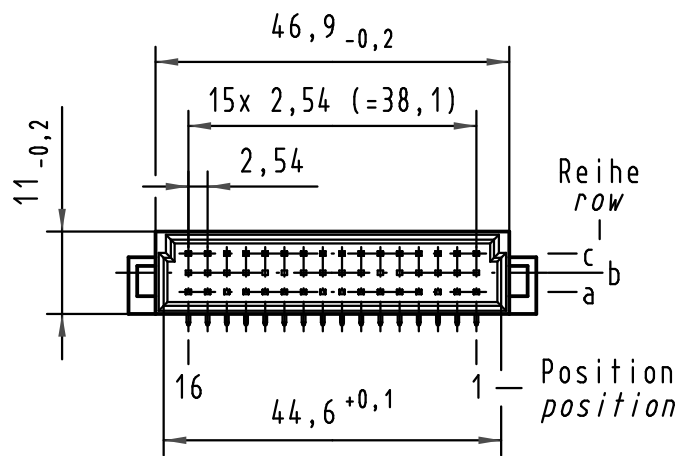
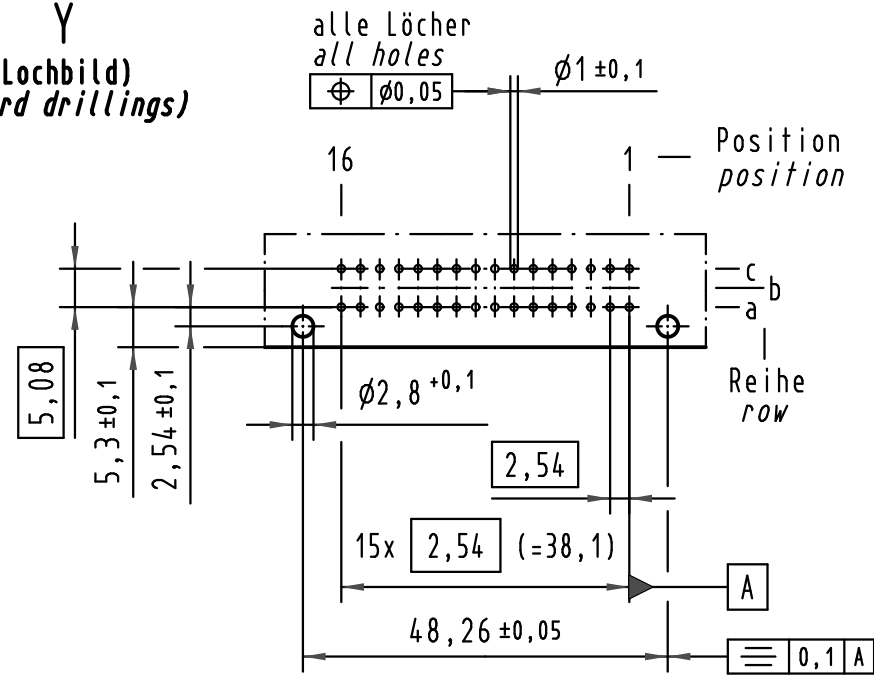
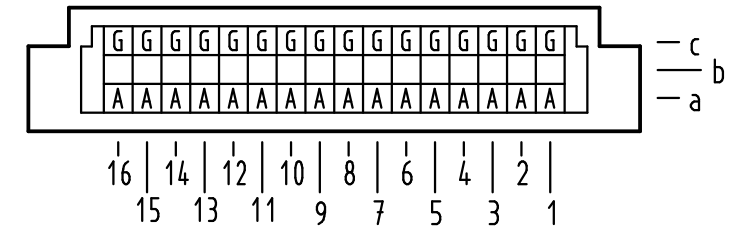

09 23 132 7921	3	Au flash over PdNi over Ni
09 23 132 6921	2	Au flash over PdNi over Ni
09 23 132 2921	1	Au flash over PdNi over Ni
Bestell-Nr. part-no.	Anforderungsstufe nach IEC performance level acc. to IEC	Kontaktoberfläche contact plating

Z
10:1
Querschnitt der
Lötanschlüsse:
cross-section of
solder terminations:

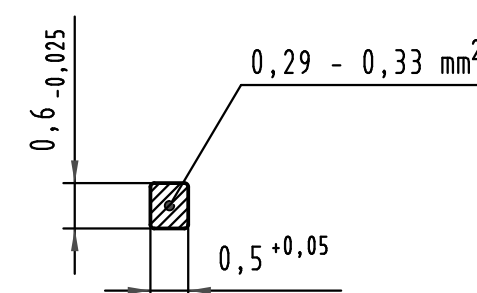

All Dimensions in mm Original Size DIN A 3			Techn. Character.			Nicht tolerierte Maßel/Free size tolerances IEC 60603-2			
			Dat.	Name	Maßstab/Scale	Bauform 2C Messerleiste Einlöt, 32 pol. type 2C male connector solder, 32 pol.			
			Detail.	28.07.00	Rie.				1:1
			Insp.	28.07.00	Pa.				2:1
			Stand.						10:1
35345	24.10.08	Hage.	HARTING Electronics GmbH & Co. KG			TB 09 23 132 x921			
34650	12.12.07	Hage.	D-32339 ESPELKAMP						
28047									
Mod.	Dat.	Name				Blatt/ page Sub.			

单击下面可查看定价，库存，交付和生命周期等信息

[>>HARTING](#)