

SIPMOS[®] Power-Transistor
Features

- P-Channel
- Enhancement mode
- Avalanche rated
- dv/dt rated
- 175°C operating temperature
- ° Pb-free lead plating: RoHS compliant
- ° Halogen-free according to IEC61249-2-21
- ° Qualified according to AEC Q101

Product Summary

| | | | |
|----------------------------------|--------------|-------|----------|
| Drain source voltage | V_{DS} | -60 | V |
| Drain-source on-state resistance | $R_{DS(on)}$ | 0.023 | Ω |
| Continuous drain current | I_D | -80 | A |

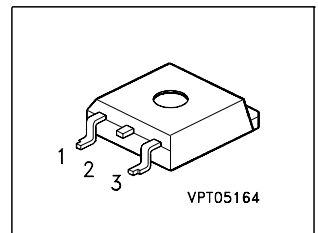

| Type | Package | Lead free |
|-------------|------------|-----------|
| SPB80P06P G | PG-TO263-3 | Yes |

| Pin 1 | PIN 2/4 | PIN 3 |
|-------|---------|-------|
| G | D | S |

Maximum Ratings, at $T_j = 25\text{ °C}$, unless otherwise specified

| Parameter | Symbol | Value | Unit |
|---|-------------------|------------|--------------------|
| Continuous drain current $T_C = 25\text{ °C}$, 1) $T_C = 100\text{ °C}$ | I_D | -80 -64 | A |
| Pulsed drain current $T_C = 25\text{ °C}$ | I_D puls | -320 | |
| Avalanche energy, single pulse $I_D = -80\text{ A}$, $V_{DD} = -25\text{ V}$, $R_{GS} = 25\ \Omega$ | E_{AS} | 823 | mJ |
| Avalanche energy, periodic limited by T_{jmax} | E_{AR} | 34 | |
| Reverse diode dv/dt $I_S = -80\text{ A}$, $V_{DS} = -48$, $di/dt = 200\text{ A}/\mu\text{s}$, $T_{jmax} = 175\text{ °C}$ | dv/dt | 6 | kV/ μs |
| Gate source voltage | V_{GS} | ± 20 | V |
| Power dissipation $T_C = 25\text{ °C}$ | P_{tot} | 340 | W |
| Operating and storage temperature | T_j , T_{stg} | -55...+175 | $^{\circ}\text{C}$ |
| IEC climatic category; DIN IEC 68-1 | | 55/175/56 | |

¹Current limited by bondwire; with an $R_{thJC} = 0.4\text{ K/W}$ the chip is able to carry $I_D = -91\text{ A}$

Thermal Characteristics

| Parameter | Symbol | Values | | | Unit |
|---|------------|--------|------|----------|------|
| | | min. | typ. | max. | |
| Characteristics | | | | | |
| Thermal resistance, junction - case | R_{thJC} | - | - | 0.4 | K/W |
| Thermal resistance, junction - ambient, leaded | R_{thJA} | - | - | 62 | |
| SMD version, device on PCB: @ min. footprint @ 6 cm ² cooling area ¹⁾ | R_{thJA} | - | - | 62 40 | |

Electrical Characteristics, at $T_j = 25\text{ °C}$, unless otherwise specified

| Parameter | Symbol | Values | | | Unit |
|--|---------------|--------|-------------|------------|---------------|
| | | min. | typ. | max. | |
| Static Characteristics | | | | | |
| Drain- source breakdown voltage $V_{GS} = 0\text{ V}$, $I_D = -250\text{ }\mu\text{A}$ | $V_{(BR)DSS}$ | -60 | - | - | V |
| Gate threshold voltage, $V_{GS} = V_{DS}$ $I_D = -5.5\text{ mA}$ | $V_{GS(th)}$ | -2.1 | -3 | -4 | |
| Zero gate voltage drain current $V_{DS} = -60\text{ V}$, $V_{GS} = 0\text{ V}$, $T_j = 25\text{ °C}$ $V_{DS} = -60\text{ V}$, $V_{GS} = 0\text{ V}$, $T_j = 150\text{ °C}$ | I_{DSS} | - | -0.1 -10 | -1 -100 | μA |
| Gate-source leakage current $V_{GS} = -20\text{ V}$, $V_{DS} = 0\text{ V}$ | I_{GSS} | - | -10 | -100 | nA |
| Drain-source on-state resistance $V_{GS} = -10\text{ V}$, $I_D = -64\text{ A}$ | $R_{DS(on)}$ | - | 0.021 | 0.023 | Ω |

¹⁾Device on 40mm*40mm*1.5mm epoxy PCB FR4 with 6cm² (one layer, 70 μm thick) copper area for drain connection. PCB is vertical without blown air.

Electrical Characteristics, at $T_j = 25\text{ °C}$, unless otherwise specified

| Parameter | Symbol | Values | | | Unit |
|--|--------------|--------|------|------|------|
| | | min. | typ. | max. | |
| Dynamic Characteristics | | | | | |
| Transconductance $V_{DS} \geq 2 \cdot I_D \cdot R_{DS(on)max}$, $I_D = -64\text{ A}$ | g_{fs} | 18 | 36 | - | S |
| Input capacitance $V_{GS} = 0\text{ V}$, $V_{DS} = -25\text{ V}$, $f = 1\text{ MHz}$ | C_{iss} | - | 4026 | 5033 | pF |
| Output capacitance $V_{GS} = 0\text{ V}$, $V_{DS} = -25\text{ V}$, $f = 1\text{ MHz}$ | C_{oss} | - | 1252 | 1565 | |
| Reverse transfer capacitance $V_{GS} = 0\text{ V}$, $V_{DS} = -25\text{ V}$, $f = 1\text{ MHz}$ | C_{rss} | - | 437 | 546 | |
| Turn-on delay time $V_{DD} = -30\text{ V}$, $V_{GS} = -10\text{ V}$, $I_D = -64\text{ A}$, $R_G = 1\ \Omega$ | $t_{d(on)}$ | - | 24 | 36 | ns |
| Rise time $V_{DD} = -30\text{ V}$, $V_{GS} = -10\text{ V}$, $I_D = -64\text{ A}$, $R_G = 1\ \Omega$ | t_r | - | 18 | 27 | |
| Turn-off delay time $V_{DD} = -30\text{ V}$, $V_{GS} = -10\text{ V}$, $I_D = -64\text{ A}$, $R_G = 1\ \Omega$ | $t_{d(off)}$ | - | 56 | 84 | |
| Fall time $V_{DD} = -30\text{ V}$, $V_{GS} = -10\text{ V}$, $I_D = -64\text{ A}$, $R_G = 1\ \Omega$ | t_f | - | 30 | 45 | |

Electrical Characteristics, at $T_j = 25\text{ °C}$, unless otherwise specified

| Parameter | Symbol | Values | | | Unit |
|---|-----------------|--------|------|------|------|
| | | min. | typ. | max. | |
| Dynamic Characteristics | | | | | |
| Gate to source charge $V_{DD} = -48\text{ V}, I_D = -80\text{ A}$ | Q_{gs} | - | 27.4 | 41 | nC |
| Gate to drain charge $V_{DD} = -48\text{ V}, I_D = -80\text{ A}$ | Q_{gd} | - | 50 | 75 | |
| Gate charge total $V_{DD} = -48\text{ V}, I_D = -80\text{ A}, V_{GS} = 0\text{ to }-10\text{ V}$ | Q_g | - | 115 | 173 | |
| Gate plateau voltage $V_{DD} = -48\text{ V}, I_D = -80\text{ A}$ | $V_{(plateau)}$ | - | -6.2 | - | V |

| Parameter | Symbol | Values | | | Unit |
|--|----------|--------|------|------|------|
| | | min. | typ. | max. | |
| Reverse Diode | | | | | |
| Inverse diode continuous forward current $T_C = 25\text{ °C}$ | I_S | - | - | -80 | A |
| Inverse diode direct current, pulsed $T_C = 25\text{ °C}$ | I_{SM} | - | - | -320 | |
| Inverse diode forward voltage $V_{GS} = 0\text{ V}, I_F = -80\text{ A}$ | V_{SD} | - | -1.2 | -1.6 | V |
| Reverse recovery time $V_R = -30\text{ V}, I_F = I_S, di_F/dt = 100\text{ A}/\mu\text{s}$ | t_{rr} | - | 117 | 175 | ns |
| Reverse recovery charge $V_R = -30\text{ V}, I_F = I_S, di_F/dt = 100\text{ A}/\mu\text{s}$ | Q_{rr} | - | 420 | 630 | nC |

Power dissipation

$$P_{\text{tot}} = f(T_C)$$

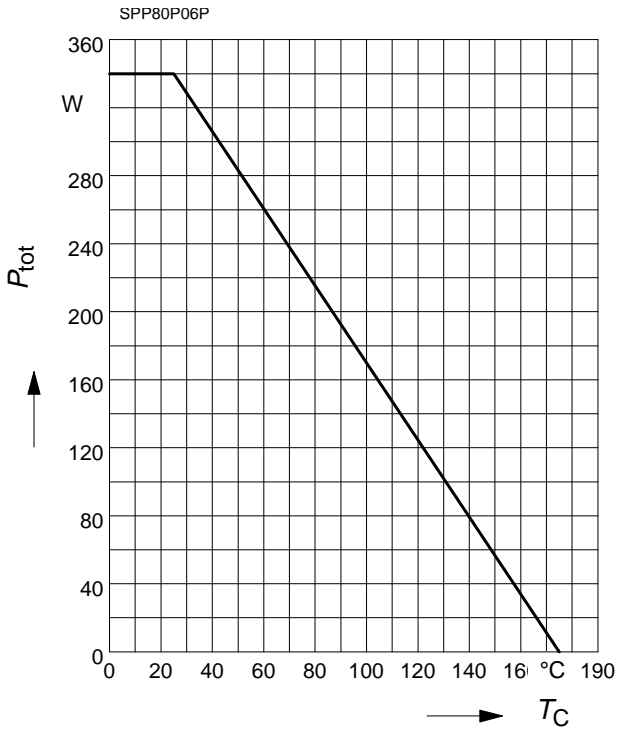

Drain current

$$I_D = f(T_C)$$

parameter: $V_{GS} \geq 10 \text{ V}$

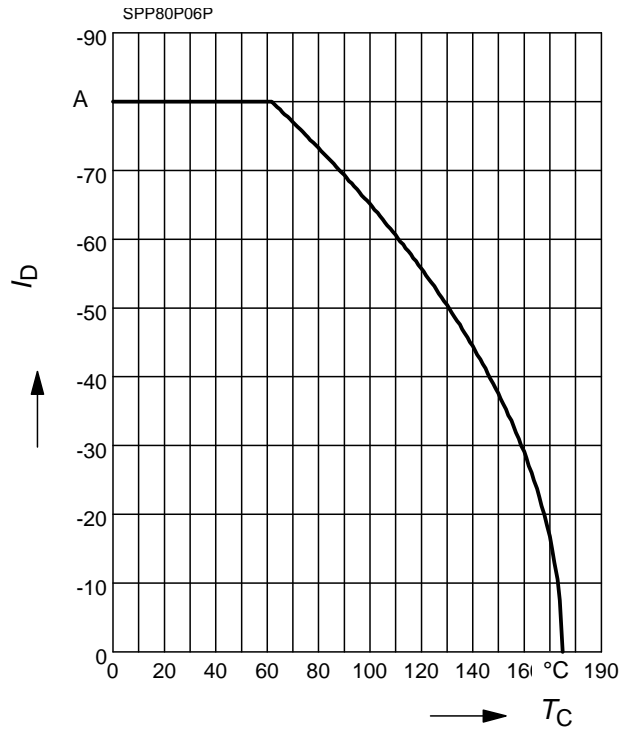

Safe operating area

$$I_D = f(V_{DS})$$

parameter: $D = 0$, $T_C = 25 \text{ °C}$

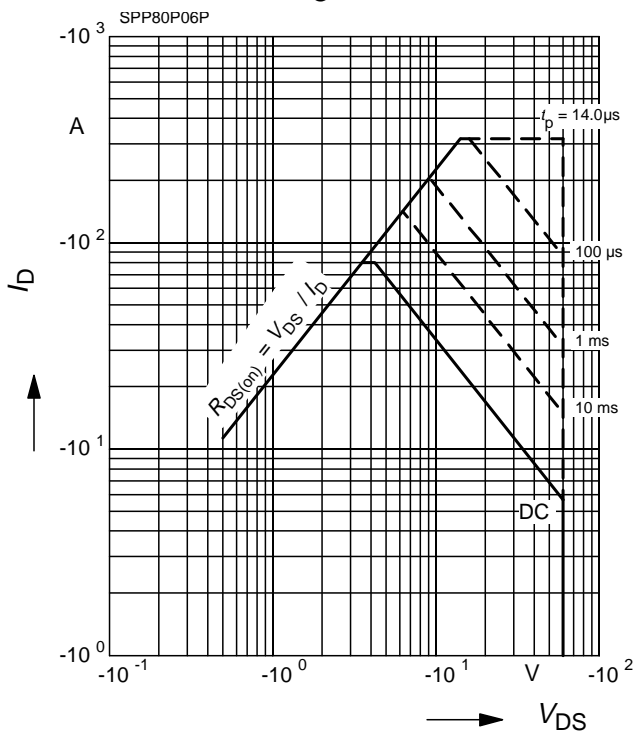

Transient thermal impedance

$$Z_{\text{thJC}} = f(t_p)$$

parameter: $D = t_p/T$

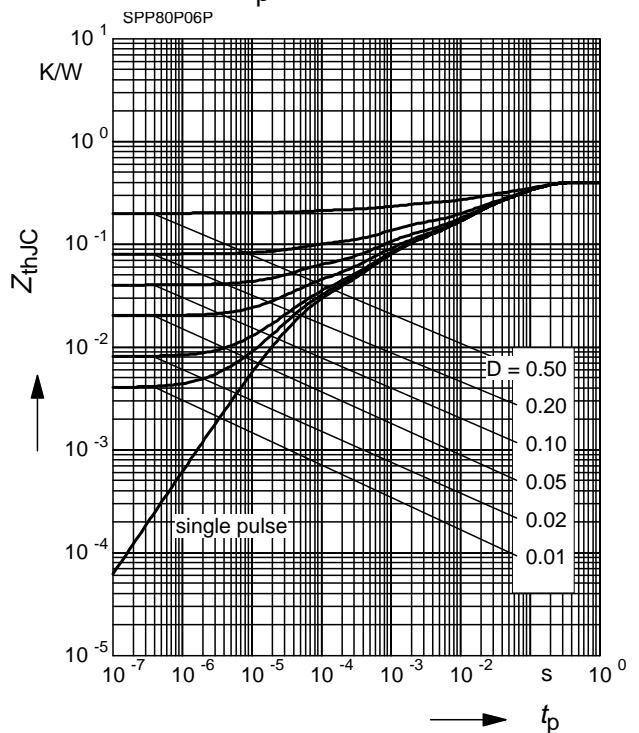

Typ. output characteristic

$$I_D = f(V_{DS}); T_j = 25^\circ\text{C}$$

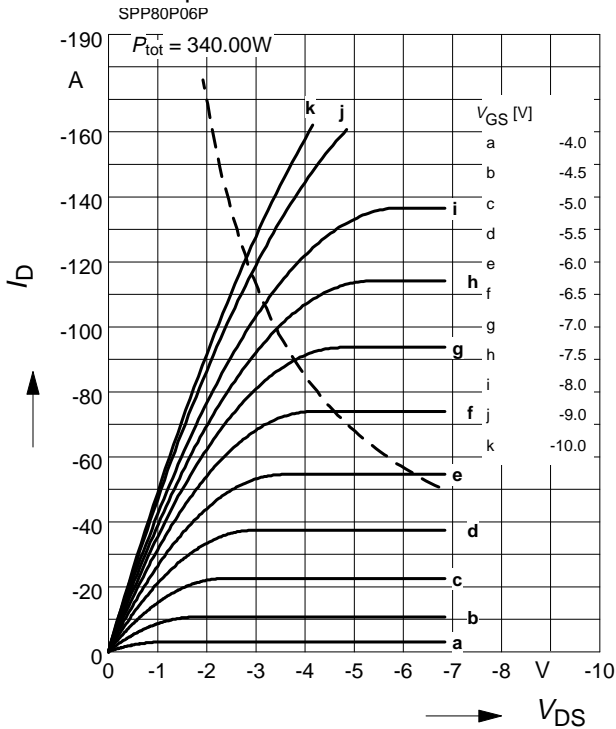
 parameter: $t_p = 80 \mu\text{s}$

Typ. drain-source-on-resistance

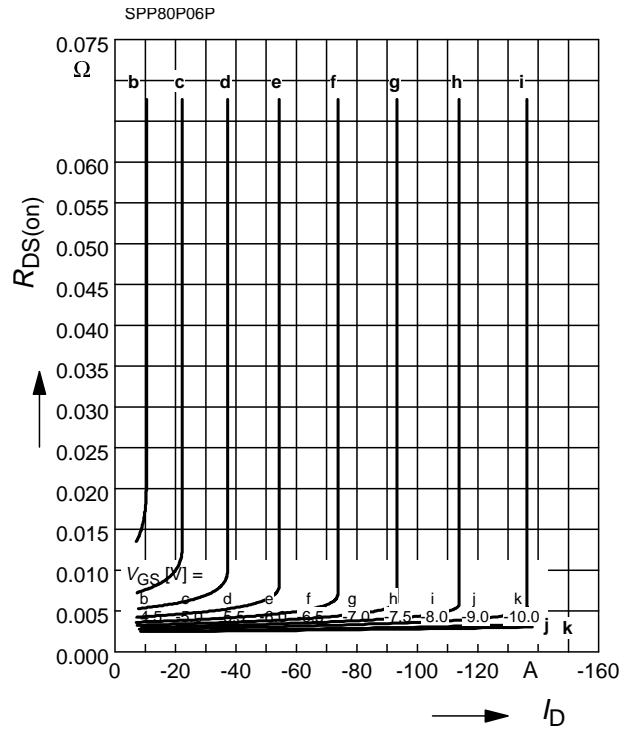
$$R_{DS(on)} = f(I_D)$$

 parameter: V_{GS}

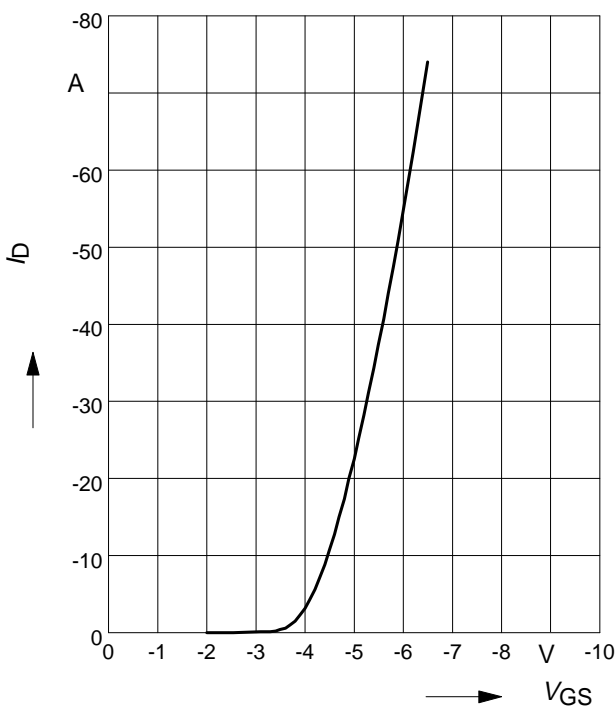
Typ. transfer characteristics $I_D = f(V_{GS})$

$$V_{DS} \geq 2 \times I_D \times R_{DS(on)max}$$

 parameter: $t_p = 80 \mu\text{s}$

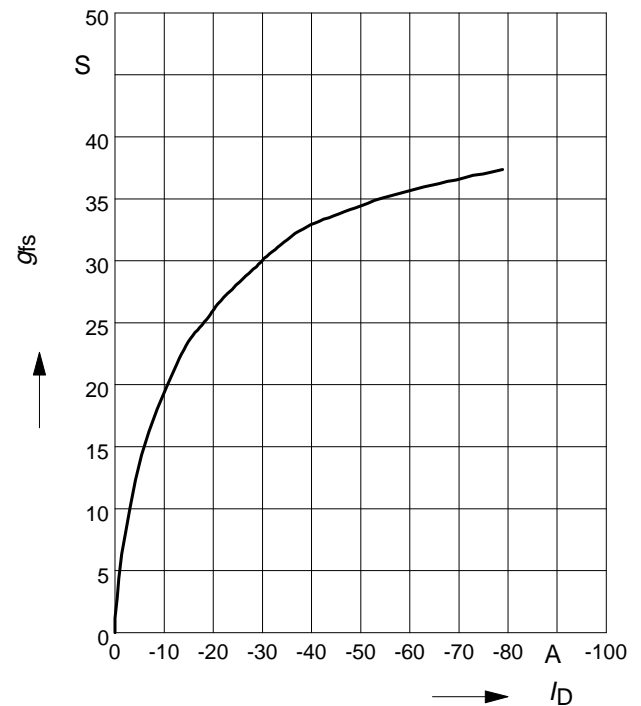
Typ. forward transconductance

$$g_{fs} = f(I_D); T_j = 25^\circ\text{C}$$

 parameter: g_{fs}

Drain-source on-state resistance

$$R_{DS(on)} = f(T_j)$$

parameter: $I_D = -64 \text{ A}$, $V_{GS} = -10 \text{ V}$

SPP80P06P

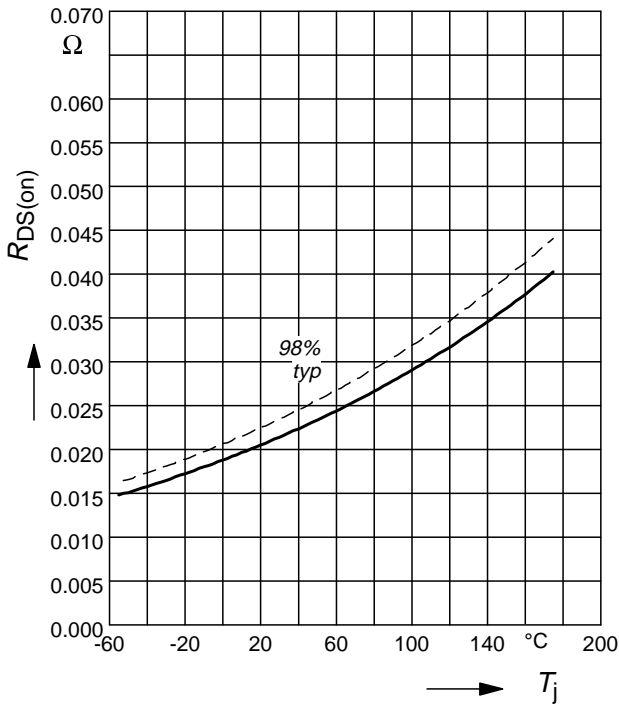

Gate threshold voltage

$$V_{GS(th)} = f(T_j)$$

parameter: $V_{GS} = V_{DS}$, $I_D = -5.5 \text{ mA}$

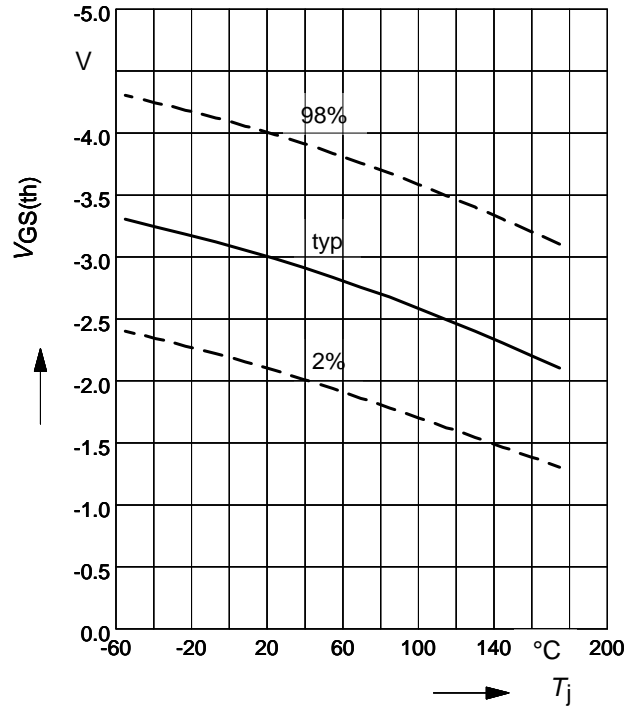

Typ. capacitances

$$C = f(V_{DS})$$

parameter: $V_{GS} = 0 \text{ V}$, $f = 1 \text{ MHz}$

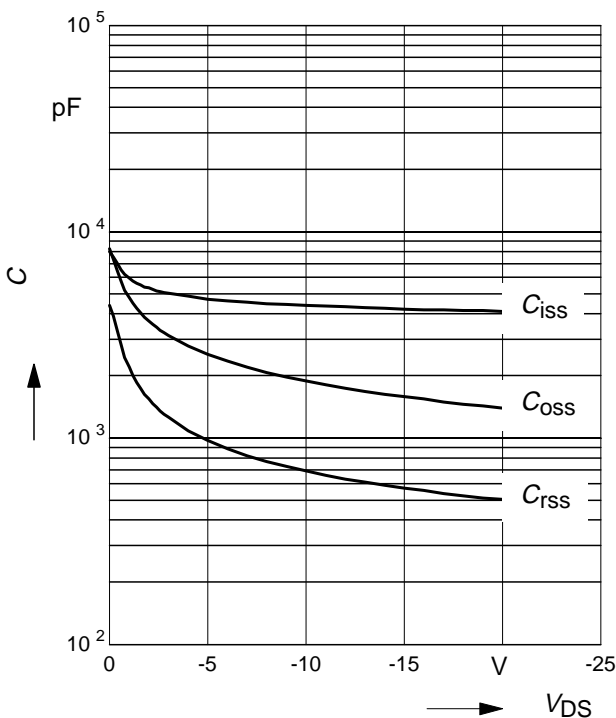

Forward characteristics of reverse diode

$$I_F = f(V_{SD})$$

parameter: T_j , $t_p = 80 \mu\text{s}$

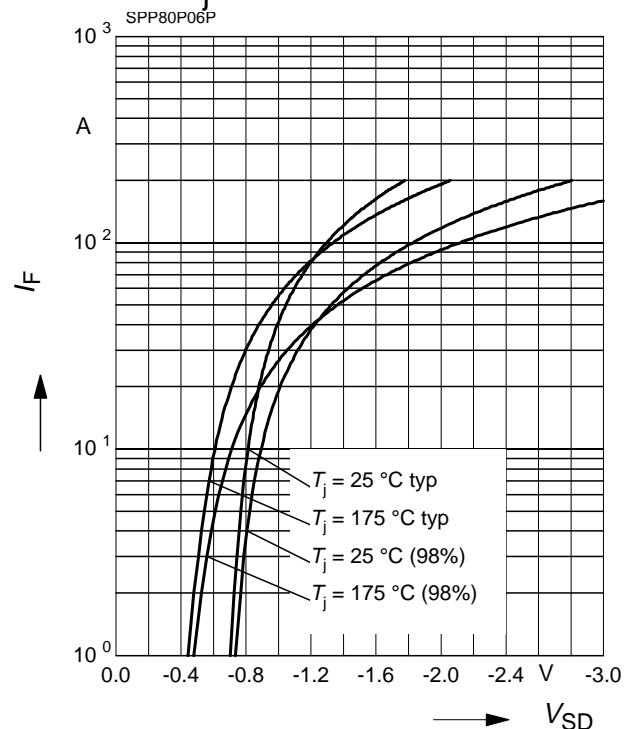

Avalanche energy

$$E_{AS} = f(T_j)$$

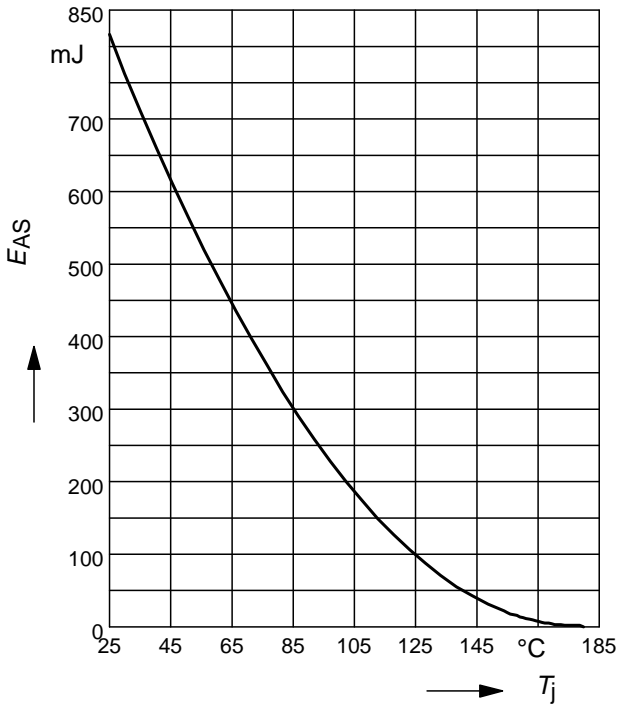
 para.: $I_D = -80 \text{ A}$, $V_{DD} = -25 \text{ V}$, $R_{GS} = 25 \text{ } \Omega$

Typ. gate charge

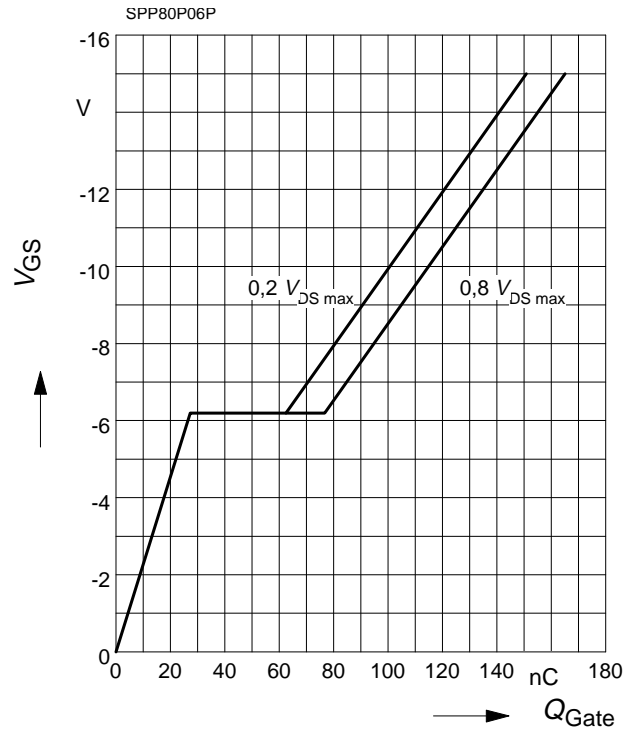
$$V_{GS} = f(Q_{Gate})$$

 parameter: $I_D = -80 \text{ A}$ pulsed

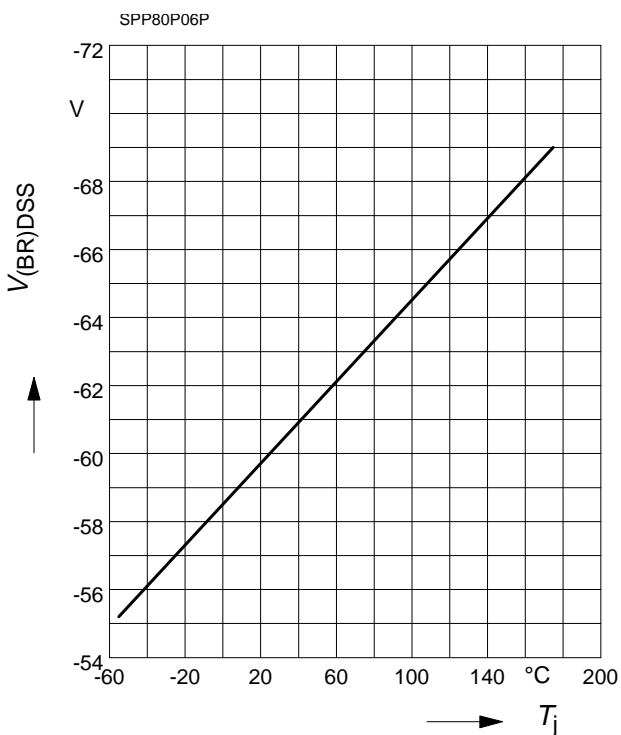
Drain-source breakdown voltage

$$V_{(BR)DSS} = f(T_j)$$

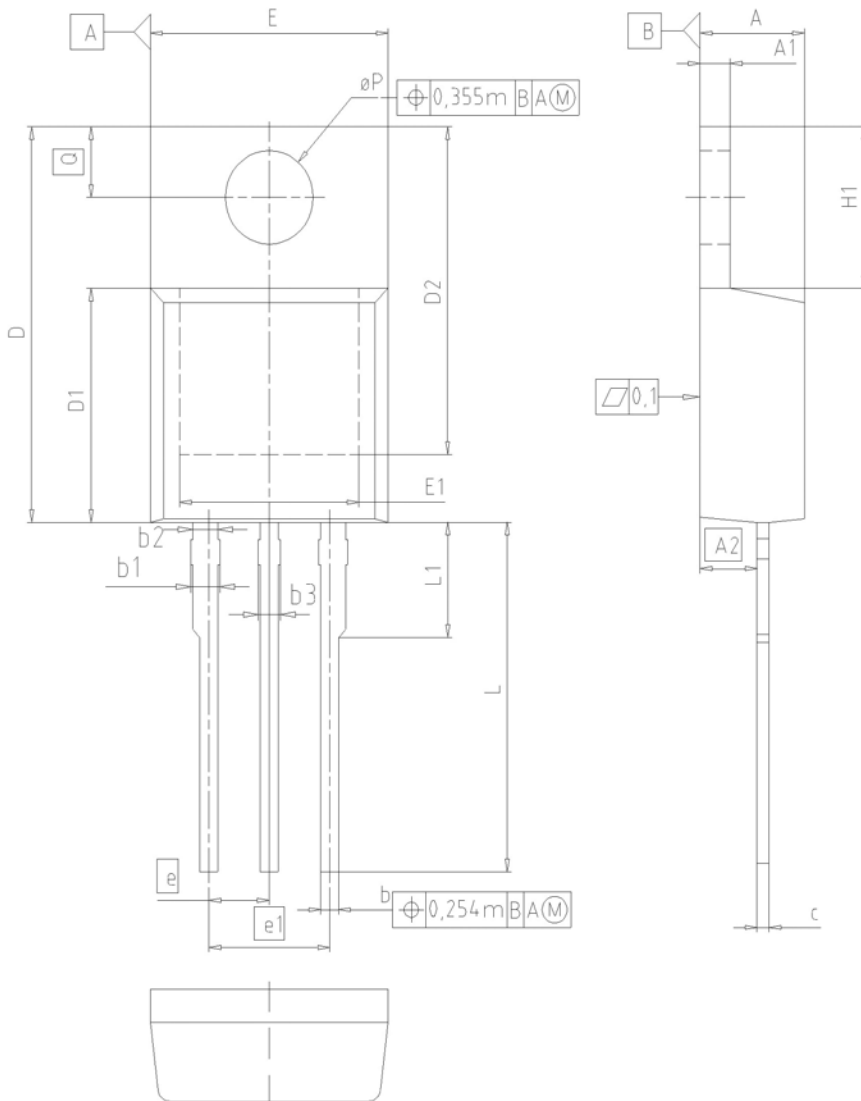

PG-TO220-3



| DIM | MILLIMETERS | | INCHES | |
|----------|-------------|-------|--------|-------|
| | MIN | MAX | MIN | MAX |
| A | 4.30 | 4.57 | 0.169 | 0.180 |
| A1 | 1.17 | 1.40 | 0.046 | 0.055 |
| A2 | 2.15 | 2.72 | 0.085 | 0.107 |
| b | 0.65 | 0.86 | 0.026 | 0.034 |
| b1 | 0.95 | 1.40 | 0.037 | 0.055 |
| b2 | 0.95 | 1.15 | 0.037 | 0.045 |
| b3 | 0.65 | 1.15 | 0.026 | 0.045 |
| c | 0.33 | 0.60 | 0.013 | 0.024 |
| D | 14.81 | 15.95 | 0.583 | 0.628 |
| D1 | 8.51 | 9.45 | 0.335 | 0.372 |
| D2 | 12.19 | 13.10 | 0.480 | 0.516 |
| E | 9.70 | 10.36 | 0.382 | 0.408 |
| E1 | 6.50 | 8.60 | 0.256 | 0.339 |
| e | 2.54 | | 0.100 | |
| e1 | 5.08 | | 0.200 | |
| N | 3 | | 3 | |
| H1 | 5.90 | 6.90 | 0.232 | 0.272 |
| L | 13.00 | 14.00 | 0.512 | 0.551 |
| L1 | - | 4.80 | - | 0.189 |
| ϕP | 3.60 | 3.89 | 0.142 | 0.153 |
| Q | 2.60 | 3.00 | 0.102 | 0.118 |

DOCUMENT NO.
Z8B00003318

SCALE

EUROPEAN PROJECTION

ISSUE DATE
23-08-2007

REVISION
05

PG-TO263-3

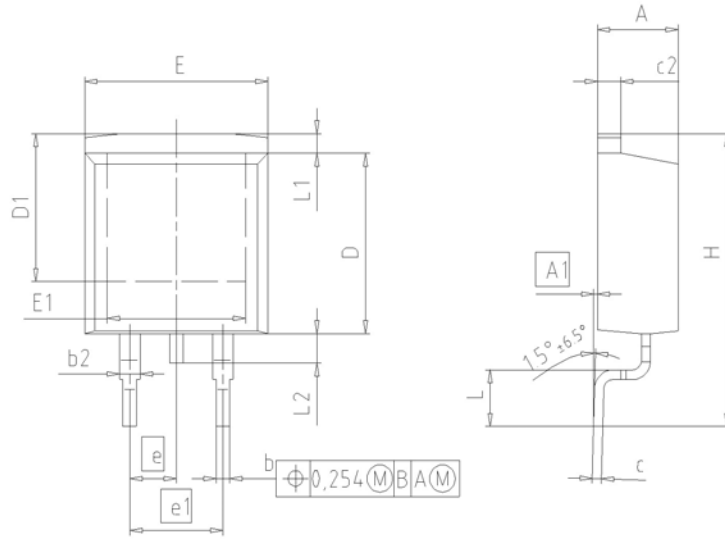

FOOTPRINT

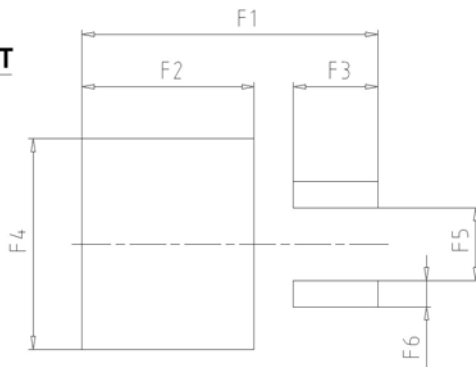

| DIM | MILLIMETERS | | INCHES | |
|-----|-------------|-------|--------|-------|
| | MIN | MAX | MIN | MAX |
| A | 4.30 | 4.57 | 0.169 | 0.180 |
| A1 | 0.00 | 0.25 | 0.000 | 0.010 |
| b | 0.65 | 0.85 | 0.026 | 0.033 |
| b2 | 0.95 | 1.15 | 0.037 | 0.045 |
| c | 0.33 | 0.65 | 0.013 | 0.026 |
| c2 | 1.17 | 1.40 | 0.046 | 0.055 |
| D | 8.51 | 9.45 | 0.335 | 0.372 |
| D1 | 7.10 | 7.90 | 0.280 | 0.311 |
| E | 9.80 | 10.31 | 0.386 | 0.406 |
| E1 | 6.50 | 8.60 | 0.256 | 0.339 |
| e | 2.54 | | 0.100 | |
| e1 | 5.08 | | 0.200 | |
| N | 2 | | 2 | |
| H | 14.61 | 15.88 | 0.575 | 0.625 |
| L | 2.29 | 3.00 | 0.090 | 0.118 |
| L1 | 0.70 | 1.60 | 0.028 | 0.063 |
| L2 | 1.00 | 1.78 | 0.039 | 0.070 |
| F1 | 16.05 | 16.25 | 0.632 | 0.640 |
| F2 | 9.30 | 9.50 | 0.366 | 0.374 |
| F3 | 4.50 | 4.70 | 0.177 | 0.185 |
| F4 | 10.70 | 10.90 | 0.421 | 0.429 |
| F5 | 3.65 | 3.85 | 0.144 | 0.152 |
| F6 | 1.25 | 1.45 | 0.049 | 0.057 |

DOCUMENT NO.
Z8B00003324

SCALE

7.5mm

EUROPEAN PROJECTION

ISSUE DATE
30-08-2007

REVISION
01

Published by
Infineon Technologies AG
81726 Munich, Germany
© 2008 Infineon Technologies AG
All Rights Reserved.

Legal Disclaimer

The information given in this document shall in no event be regarded as a guarantee of conditions or characteristics. With respect to any examples or hints given herein, any typical values stated herein and/or any information regarding the application of the device, Infineon Technologies hereby disclaims any and all warranties and liabilities of any kind, including without limitation, warranties of non-infringement of intellectual property rights of any third party.

Information

For further information on technology, delivery terms and conditions and prices, please contact the nearest Infineon Technologies Office (www.infineon.com).

Warnings

Due to technical requirements, components may contain dangerous substances. For information on the types in question, please contact the nearest Infineon Technologies Office. Infineon Technologies components may be used in life-support devices or systems only with the express written approval of Infineon Technologies, if a failure of such components can reasonably be expected to cause the failure of that life-support device or system or to affect the safety or effectiveness of that device or system. Life support devices or systems are intended to be implanted in the human body or to support and/or maintain and sustain and/or protect human life. If they fail, it is reasonable to assume that the health of the user or other persons may be endangered.

单击下面可查看定价，库存，交付和生命周期等信息

[>>Infineon\(英飞凌\)](#)