

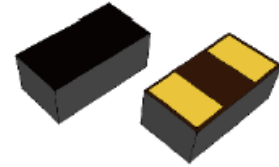

FEATURES

- ✧ Ultra-low capacitance (0.05pF typical).
- ✧ Low leakage current(<10nA).
- ✧ Fast response time (<1ns).
- ✧ Bi-directional, single line protection.

Polymeric ESD suppressor



0402

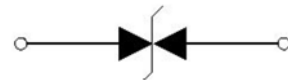

MAIN APPLICATIONS

- ✧ HDTV/Smart TV
- ✧ Set-Top box.
- ✧ Laptop/Desktop computer
- ✧ HDMI、USB 3.0
- ✧ USB 3.1、Lightning、Thunderbolt

ELECTRICAL PARAMETERS (T=25°C)

Parameter	Symbol	Conditions	Min	Typ	Max	Unit
Working voltage	V_{DC}				18	V
Trigger voltage	V_T	IEC61000-4-2 8kV Contact discharge		450		V
clamping voltage	V_C	IEC61000-4-2 8kV Contact discharge		40		V
Leakage current	I_L	$V_{DC}=18V$			10	nA
Junction capacitance	C_J	f =10MHz		0.05		pF
ESD pulse withstand	Pulses	IEC61000-4-2 8kV Contact discharge	1000			

CHARACTERITICS CURVE

FIG.1: Typical ESD Response (IEC 61000-4-2, 8KV contact discharge)

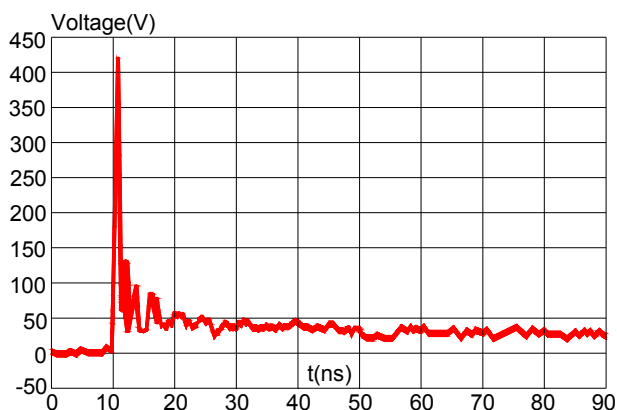
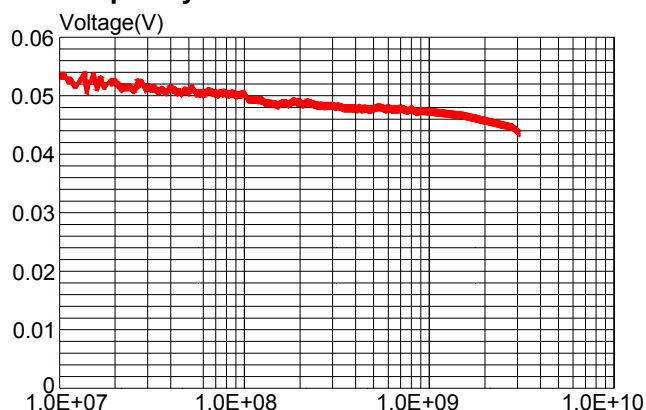
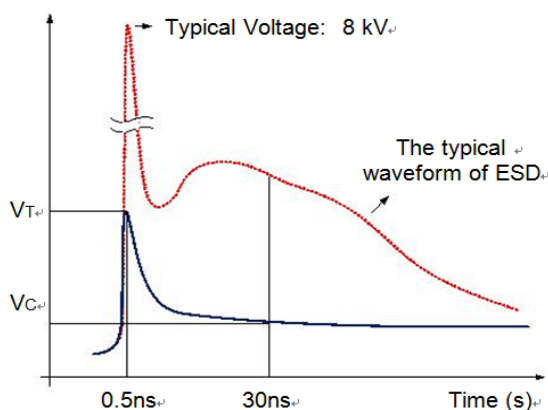

FIG.2: Typical Device Capacitance VS. Frequency



GENERAL CHARACTERISTICS



IEC61000-4-2 Standards

Level	First Peak Current (A)	Peak Current at 30 ns (A)	Peak Current at 60 ns (A)	Test Voltage (Contact Discharge) (kV)	Test Voltage (Air Discharge) (kV)
1	7.5	4	2	2	2
2	15	8	4	4	4
3	22.5	12	6	6	8
4	30	16	8	8	15

Operating temperature range	-50°C to +85°C
Storage temperature range	-50°C to +125°C
ESD Capability: IEC61000-4-2 Contact discharge IEC61000-4-2 Air discharge	8kV typical 15kV typical

ENVIRONMENTAL SPECIFICATIONS

	Test Conditions	Pass/Fail Criteria
Bias Humidity Test	85°C, 85% RH, V _{DC(max)} , 1000hrs	I _L % 10 μA
Thermal Shock	-55°C to 125°C, 30 min Dwell, 1000 Cycles	I _L % 10 μA
Bias Heat Test	125°C, V _{DC(max)} , 1000 hrs	I _L % 10 μA
Bias Low Temp Test	-55°C, V _{DC(max)} , 1000 hrs	I _L % 10 μA
Solderability	250°C±5°C, 3±1s	95% Coverage
Solder Heat	260°C, 10s	90% Coverage

SOLDER REFLOW RECOMMENDATIONS

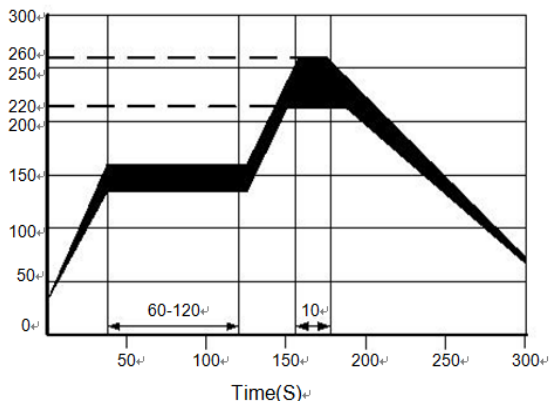

- Recommended reflow methods: IR, vapor phase oven, hot air oven.
- The device can be exposed to a maximum temperature of 260°C for 10 seconds.
- Devices can be cleaned using standard industry methods and solvents.

Notes: If reflow temperatures exceed the recommended profile, devices may not meet the performance requirements.

PRODUCT DIMENSIONS

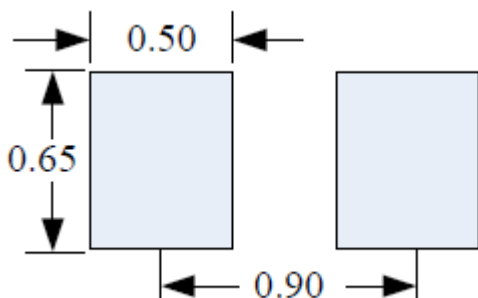
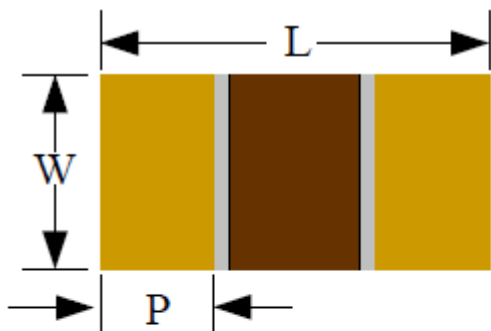

Size in mm
Land pattern

Symbol	Millimeters			Inches		
	Min.	Typ.	Max.	Min.	Typ.	Max.
L	0.90	1.00	1.10	0.035	0.039	0.043
W	0.42	0.52	0.62	0.017	0.020	0.024
P	0.15	0.25	0.35	0.006	0.010	0.014
H	0.25	0.38	0.45	0.010	0.015	0.018

TAPE AND REEL INFORMATION

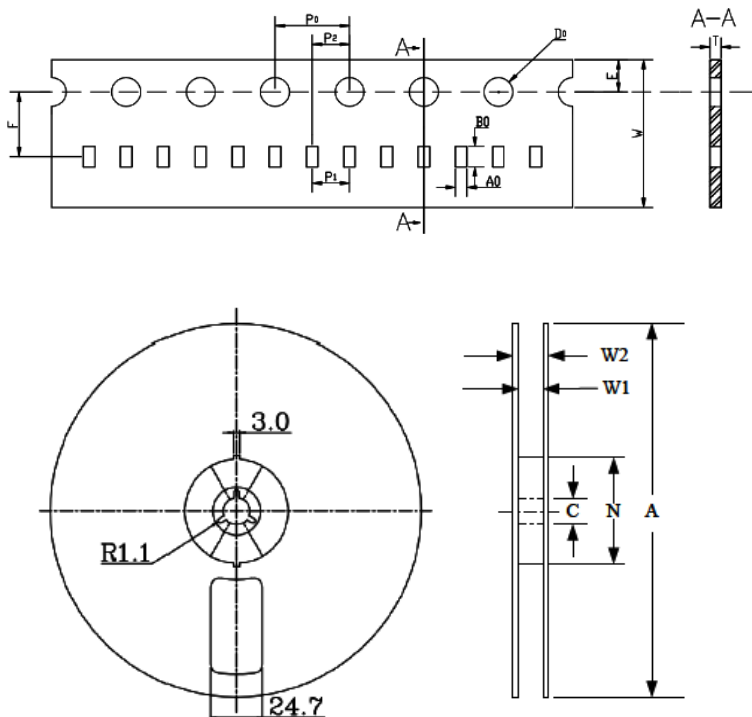

Symbol	Millimeters	Inches
A0	0.68±0.03	0.027±0.001
B0	1.17±0.03	0.046±0.001
W	8.00±0.10	0.315±0.004
F	3.50±0.05	0.138±0.002
E	1.75±0.10	0.069±0.004
P1	2.00±0.05	0.079±0.002
P2	2.00±0.05	0.079±0.002
P0	4.00±0.10	0.157±0.004
ΦD0	1.55±0.05	0.061±0.002
T	0.43±0.03	0.017±0.001
A	178±2.0	7.008±0.079
N(min.)	50	1.969
C	13.0±0.2	0.512±0.008
W2(max.)	14.4	0.567
W1(min.)	8.4	0.331
W1(max.)	9.9	0.390

PART NUMBERING SYSTEM

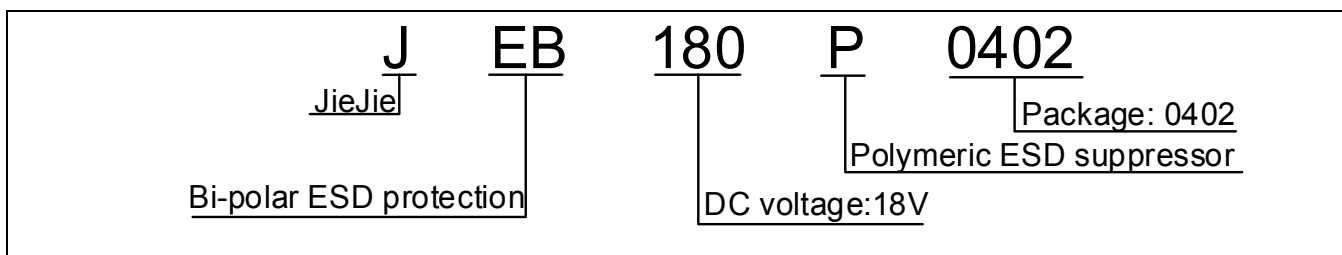

ORDERING INFORMATION

PART No.	PACKAGE TYPE	QUANTITY(PCS) REEL	DESCRIPTION
JEB180P0402	0402	10,000	7 inch reel pack

Information furnished in this document is believed to be accurate and reliable. However, Jiangsu JieJie Microelectronics Co.,Ltd assumes no responsibility for the consequences of use without consideration for such information nor use beyond it.

Information mentioned in this document is subject to change without notice, apart from that when an agreement is signed, Jiangsu JieJie complies with the agreement.

Products and information provided in this document have no infringement of patents. Jiangsu JieJie assumes no responsibility for any infringement of other rights of third parties which may result from the use of such products and information.

This document is the 1.1st version which is made in 5-June-2020. This document supersedes and replaces all information previously supplied.

 is a registered trademark of Jiangsu JieJie Microelectronics Co.,Ltd.

Copyright ©2020 Jiangsu JieJie Microelectronics Co.,Ltd. Printed All rights reserved.

单击下面可查看定价，库存，交付和生命周期等信息

[>>JW\(捷捷微\)](#)