

| linear dimension(Tolerances Standard GB/T 14486-2008) |       |        |         |         |         |          |          | — ▯ ⊥ |         |          |
|---|-------|--------|---------|---------|---------|----------|----------|-------|---------|----------|
| variable range  | to 6  | over 6 | over 10 | over 30 | over 60 | over 100 | over 160 | to 10 | over 10 | over 100 |
|   |       | to 10  | to 30   | to 60   | to 100  | to 160   | to 100   |       | to 100  |          |
| tolerance   | ±0.20 | ±0.30  | ±0.50   | ±0.70   | ±1.00   | ±1.30    | ±1.60    | 0.10  | 0.30    | 0.60     |

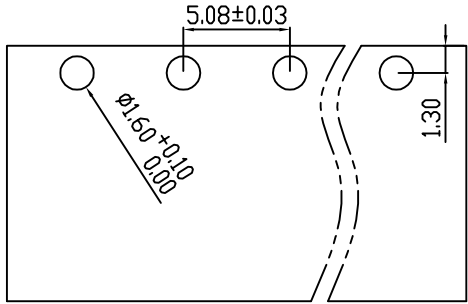

PCB LAYOUT

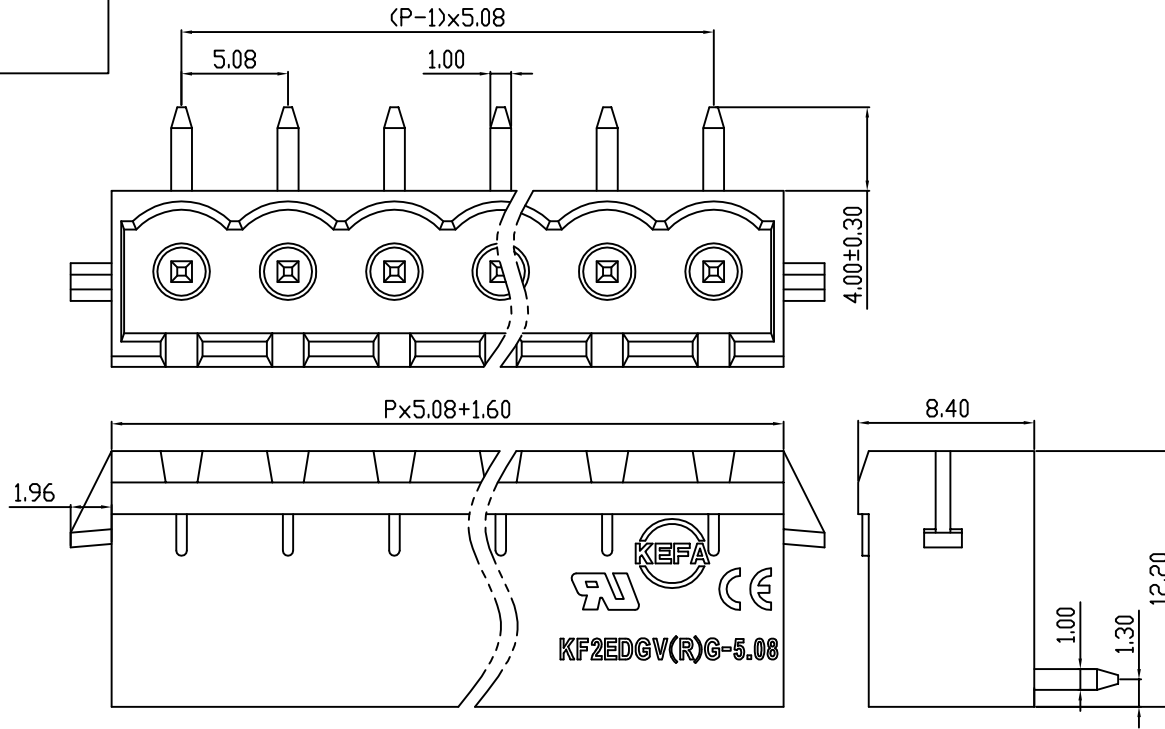

KEFA  
KF2EDGV(R)G-5.08

| REVISION RECORD |             |         |          |          |
|-----------------|-------------|---------|----------|----------|
| REV.            | DESCRIPTION | ECN No. | APPROVED | DATE     |
| A               | 新发行         |         | CLF      | 22.06.13 |
|                 |             |         |          |          |
|                 |             |         |          |          |

| UL/CUL 技术参数<br>UL/CUL Technical Data                          |                  |     |     |
|---|------------------|-----|-----|
| 等级 Use Group  | B                | C   | D   |
| 额定电压 Rated Voltage [V]  | 300              | -   | 300 |
| 额定电流 Rated Current [A]  | 10               | -   | 10  |
| 接线范围 Wire Range   | -                |     |     |
| 单/多芯线 Solid/Stranded [AWG]                                    | -                |     |     |
| 耐电压 Withstanding Voltage                                      | 1600V/1Min       |     |     |
| IEC 技术参数<br>IEC Technical Data                                |                  |     |     |
| 过电压类别 Overvoltage Category                                    | III              | III | II  |
| 污染等级 Contamination Class                                      | 3                | 2   | 2   |
| 额定电压 Rated Voltage [V]  | -                | 320 | 630 |
| 额定电流 Rated Current [A]  | -                | 15  | 15  |
| 额定冲击电压 Impulse withstand voltagea [KV]                        | -                | 4.0 | 4.0 |
| 导线截面积 Conductor cross section<br>硬质/柔性导线 Solid/flexible [mm²] | -                |     |     |
| 材料 Material   |                  |     |     |
| 绝缘材料 Insulation Material                                      | PA66             |     |     |
| 阻燃等级 Imflammability   | UL94V-0          |     |     |
| 导体材料 Contactor Material                                       | 铜合金 Copper alloy |     |     |
| 导体表面镀层 Contactive Coating                                     | 镀锡 Tin Plated    |     |     |
| 一般参数 Other Data   |                  |     |     |
| 间距 Pitch [mm]   | 5.08             |     |     |
| 极数 Poles [P]  | 2-24             |     |     |
| 剥线长度 Stripping Length [mm]                                    | -                |     |     |
| 螺丝 Screw/扭矩 Torque(Max) [N.m]                                 | -                |     |     |
| 工作温度 Operating temperatur [°C]                                | -40~+105         |     |     |
| 引针尺寸 Pin Dimensions [mm]                                      | 4.0              |     |     |
| PCB板孔径 PCB Hole Diameter [mm]                                 | 1.6              |     |     |

|      |     |      |          |  |    |         |    |          |               |                             |        |   |
|------|-----|------|----------|--|----|---------|----|----------|---------------|-----------------------------|--------|---|
| DES. | LQQ | DATE | 22.06.13 | 单位/UNITS                                     | mm | 尺寸/SIZE | A4 | 比例/SCALE | 1:1           | 第三视角/THIRD ANGLE PROJECTION | 版本/REV | A |
| CHK. | BY  | DATE | 22.06.13 | 慈溪市科发电子有限公司<br>CIXI KEFA ELECTRONIC CO., LTD |    |         |    | 名称/TITLE | KF2EDGRG-5.08 |                             |        |   |
| APP. | CLF | DATE | 22.06.13 |  |    |         |    |          |               |                             |        |   |

单击下面可查看定价，库存，交付和生命周期等信息

[>>KEFA\(科发\)](#)