

linear dimension(Tolerances Standard GB/T 14486-2008)								—		
variable range	to 6	over 6 to 10	over 10 to 30	over 30 to 60	over 60 to 100	over 100 to 160	over 160 to	to 10	over 10 to 100	over 100 to
tolerance	±0.20	±0.30	±0.50	±0.70	±1.00	±1.30	±1.60	0.10	0.30	0.60

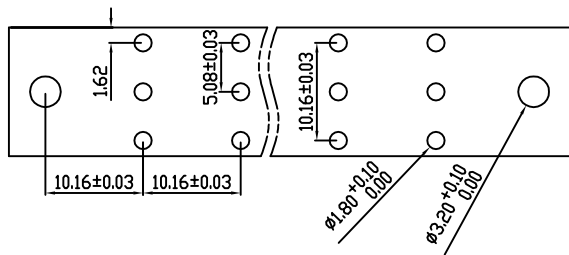

PCB Layout

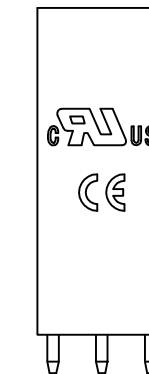
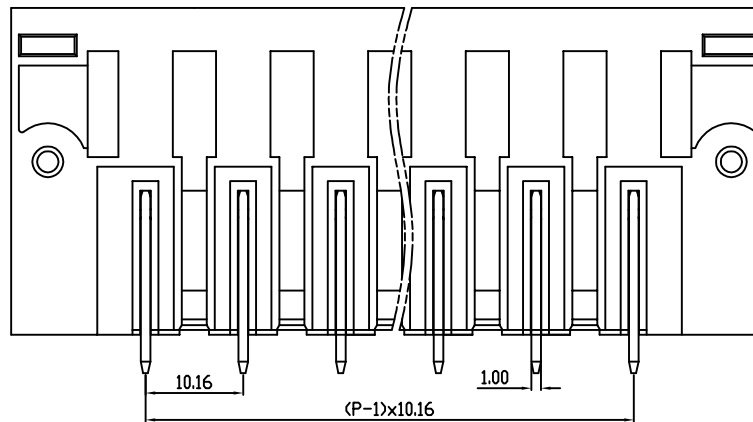
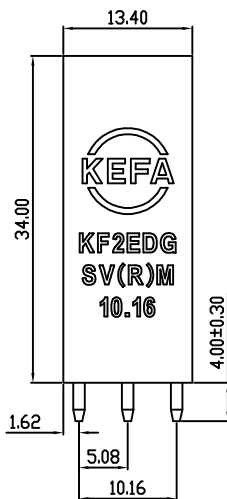
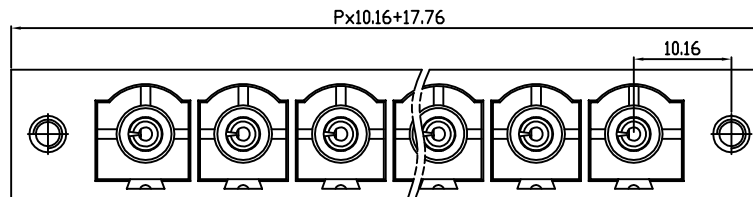

REVISION RECORD				
REV.	DESCRIPTION	ECN No.	APPROVED	DATE
A	新发行		GLF	22.02.19

UL/CUL 技术参数 UL/CUL Technical Data			
等级 Use Group		B	C D
额定电压 Rated Voltage [V]		600	600 600
额定电流 Rated Current [A]		65	65 5
接线范围 Wire Range		-	
单/多芯线 Solid/Stranded [AWG]		-	
耐电压 Withstanding Voltage		2200V/1Min	
IEC 技术参数 IEC Technical Data			
过电压类别 Overvoltage Category		III	III II
污染等级 Contamination Class		2	2 2
额定电压 Rated Voltage [V]		1000	1000 1000
额定电流 Rated Current [A]		57	57 57
额定冲击电压 Impulse withstand voltagea [KV]		8.0	8.0 6.0
导线截面积 Conductor cross section		-	
硬质/柔性导线 Solid/flexible [mm ²]		-	
材料 Material			
绝缘材料 Insulation Material		PA66	
阻燃等级 Inflammability		UL94V-0	
导体材料 Contactor Material		铜合金 Copper alloy	
导体表面镀层 Contactive Coating		镀金 Gold plated	
一般参数 Other Data			
间距 Pitch [mm]		10.16	
极数 Poles [P]		2-12	
剥线长度 Stripping Length [mm]		-	
螺丝 Screw/扭矩 Torque(Max) [N.m]		-	
工作温度 Operating temperatur [°C]		-40~+105	
引针尺寸 Pin Dimensions [mm]		4.0	
PCB板孔径 PCB Hole Diameter [mm]		1.8/3.2	

DES.	SJD	DATE	22.02.19	单位/UNITS	mm	尺寸/SIZE	A4	比例/SCALE	1:1	第三视角/THIRD ANGLE PROJECTION	版本/REV	A
CHK.	BY	DATE	22.02.19	慈溪市科发电子有限公司 CIXI KEFA ELECTRONIC CO., LTD				名称/TITLE	KF2EDGSVM-10.16			
APP.	CLF	DATE	22.02.19									

单击下面可查看定价，库存，交付和生命周期等信息

[>>KEFA\(科发\)](#)