

CT-06-100

Aliases (USEN0610000000)

KEMET, CT, Current, Round - Toroidal, AC, Overcurrent/Current Detection, High Sensitivity, High Performance

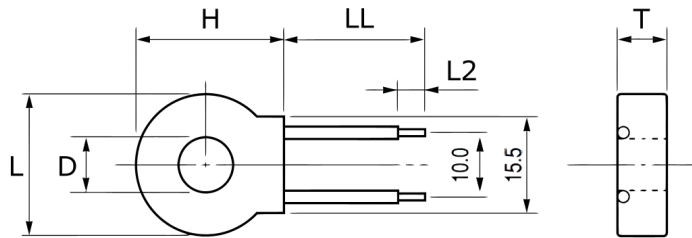

General Information

Series	CT
Type	Current
Style	Round - Toroidal
Description	Low Alternating Current Sensor
Features	Overcurrent/Current Detection, High Sensitivity, High Performance
Lead	Cables, Sheathed
RoHS	Yes
Notes	0.5 mm Diameter Single Wire

Specifications

Temperature Range	-20/+80°C
Miscellaneous	Lead = Polyethylene Sheath 0.5 mm Diameter Single Wire. Materials = Phenolic Resin Case, Silicon-Filled. 1000 turns.

Click [here](#) for the 3D model.

Dimensions

D	6mm NOM
L	18mm NOM
L2	5mm +/-2mm
H	22.4mm NOM
T	7.1mm MAX
LL	85mm +/-5mm

Packaging Specifications

Packaging	Tray
Packaging Quantity	560
Component Weight	5 g

Statements of suitability for certain applications are based on our knowledge of typical operating conditions for such applications, but are not intended to constitute - and we specifically disclaim - any warranty concerning suitability for a specific customer application or use. This information is intended for use only by customers who have the requisite experience and capability to determine the correct products for their application. Any technical advice inferred from this information or otherwise provided by us with reference to the use of our products is given gratis, and we assume no obligation or liability for the advice given or results obtained.

单击下面可查看定价，库存，交付和生命周期等信息

[>>KEMET\(基美\)](#)