

SIDE VIEW

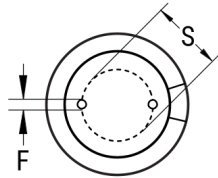

TERMINAL END VIEW



Click [here](#) for the 3D model.

### Dimensions

|             |               |
|-------------|---------------|
| D           | 13mm +/-0.5mm |
| L           | 20mm +2.0mm   |
| S           | 5mm +/-0.5mm  |
| LL Negative | 15mm MIN      |
| LL Positive | 20mm MIN      |
| F           | 0.6mm NOM     |

### Packaging Specifications

|                    |           |
|--------------------|-----------|
| Packaging          | Bulk, Bag |
| Packaging Quantity | 2000      |

### General Information

|             |                                    |
|-------------|------------------------------------|
| Series      | ESZ                                |
| Dielectric  | Aluminum Electrolytic              |
| Description | Single Ended Aluminum Electrolytic |
| RoHS        | Yes                                |
| Lead        | Wire Leads                         |
| AEC-Q200    | No                                 |

### Specifications

|                         |   |
|-------------------------|---|
| Capacitance             | 47 uF   |
| Capacitance Tolerance   | 20%   |
| Voltage DC              | 200 VDC, 250 VDC (Surge)                        |
| Temperature Range       | -40/+105°C                                      |
| Rated Temperature       | 105°C   |
| Life                    | 10000 Hrs                                       |
| Dissipation Factor      | 20%   |
| Ripple Current          | 330 mAmps (120Hz 105C), 660 mAmps (100kHz 105C) |
| Leakage Current         | 476 uA (2min 20°C)                              |
| Impedance Ratio at -25C | 3   |
| Impedance Ratio at -40C | 6   |

单击下面可查看定价，库存，交付和生命周期等信息

[>>KEMET\(基美\)](#)