

## MPCH1250L1R5

Aliases (UPIC1250L1R500)

KEMET, MPCH, Power, 1.5 uH, 20%, 1250(5350)

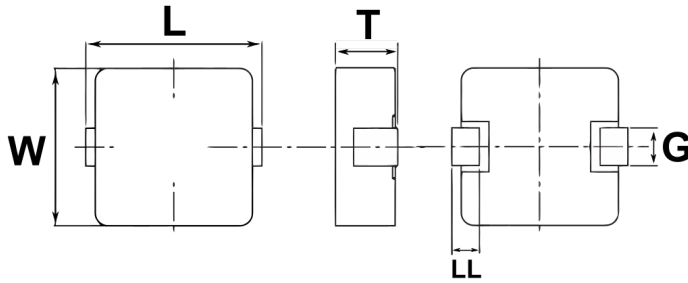

Click [here](#) for the 3D model.

### Dimensions

|    |                 |
|----|-----------------|
| L  | 14.3mm MAX      |
| W  | 12.5mm +/-0.3mm |
| T  | 5mm MAX         |
| LL | 2.2mm NOM       |
| G  | 2.5mm NOM       |

### Packaging Specifications

|                    |            |
|--------------------|------------|
| Packaging          | T&R, 380mm |
| Packaging Quantity | 500        |

### General Information

|               |                                  |
|---------------|----------------------------------|
| Series        | MPCH                             |
| Style         | SMD                              |
| Chip Size     | 1250(5350)                       |
| Description   | Shielded, Surface Mount Inductor |
| Features      | Large Current Inductors          |
| RoHS          | Yes                              |
| Core          | Composite                        |
| Miscellaneous | 40 (K) Temperature Rise Max.     |

### Specifications

|                      |  |
|----------------------|--|
| Inductance           | 1.5 uH   |
| Inductance Tolerance | 20%  |
| Temperature Range    | -40/+125°C   |
| Rated Temperature    | 120°C  |
| Shielded             | Yes  |
| Current              | 21 A (Isat, 20% Drop In Inductance), 21 A (Irms, 40C Rise By Self Heating) |
| DC Resistance        | 2.2 mOhms  |

Statements of suitability for certain applications are based on our knowledge of typical operating conditions for such applications, but are not intended to constitute - and we specifically disclaim - any warranty concerning suitability for a specific customer application or use. This information is intended for use only by customers who have the requisite experience and capability to determine the correct products for their application. Any technical advice inferred from this information or otherwise provided by us with reference to the use of our products is given gratis, and we assume no obligation or liability for the advice given or results obtained.

单击下面可查看定价，库存，交付和生命周期等信息

[>>KEMET\(基美\)](#)