

Kinghelm®

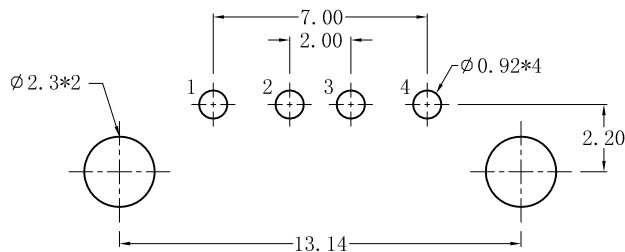
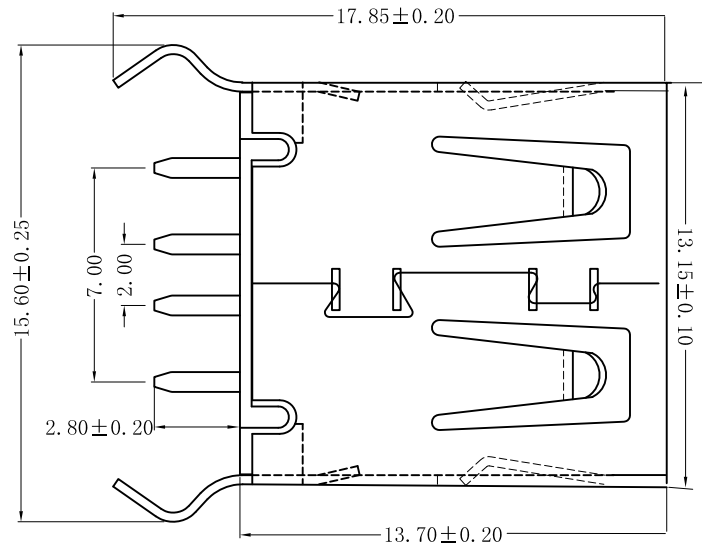
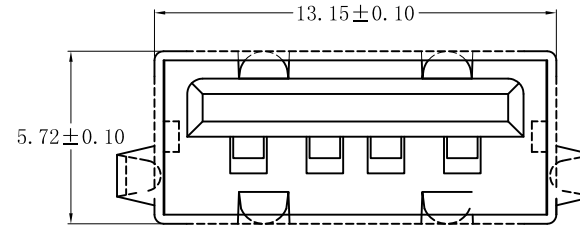
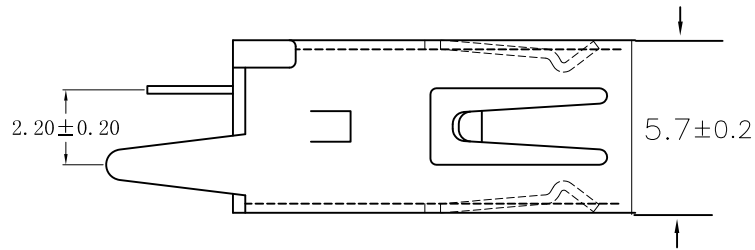

规格说明: Specifications:

电气特性: Electrical:

- 额定电流: Current Rating
1.5A/contact terminal
- 额定电压: Voltage Rating
30V DC
- 接触阻抗: Contact Resistance
30 milliohms MAX
- 耐电压: Dielectric Withstanding Voltage:
500 V AC AT Sea Level
- 绝缘阻抗: Insulation Resistance:
1000MEGA ohms MIN

原材料: Material:

- 塑胶: Housing:
High Temperature Thermoplastics,
PBT/LCP White/Black
- 端子: Contact: Copper Alloy C2680
- 外壳: Shell: Copper Alloy C2680/SPCC

电镀: Finish:

- 端子: Contact: Plated Gold in Mating Area;
Tin On Solder Tails
- 外壳: Shell:
Nickel Plating

深圳市金航标电子有限公司		WWW.BDS666.COM	图号 (DWG NO)	单位 (UNIT): MM
KH-AF180WJ-13.7		0755-83044319	版本 (REV)	A/1
品名 (ITEM NO)			日期 (DATE)	
料号 (PART NO)			设计 (DESIGN)	未注公差 TOLERANCE UNSPECIFIED
模号 (MODEL NO)		UB001G	审核 (CHECKED)	X.X ±0.30 X.XX ±0.20 X.XXX ±0.10 X° ±5° X.X° ±2°
			核准 (APPROVED)	

单击下面可查看定价，库存，交付和生命周期等信息

[>>kinghelm\(金航标\)](#)