

PCB LAYOUT
S=2:1

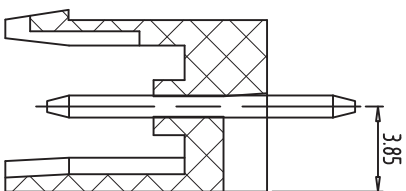

SECTION:A-A

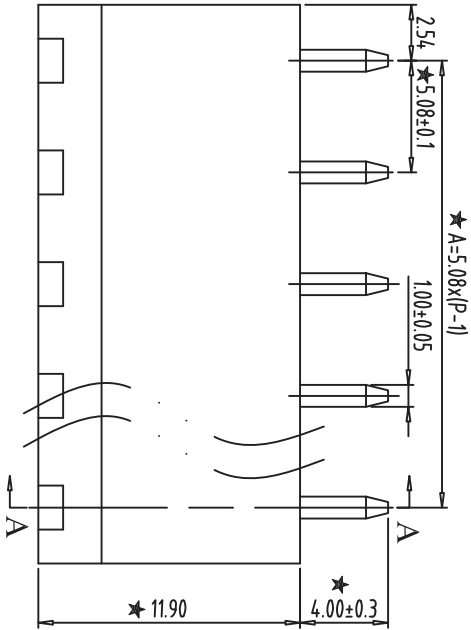
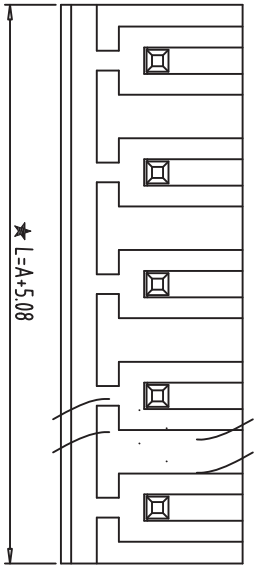
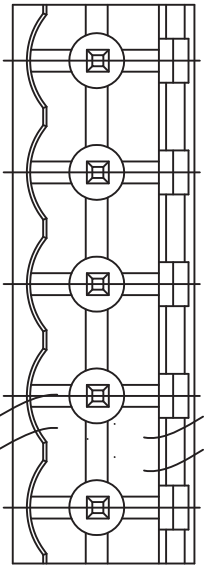
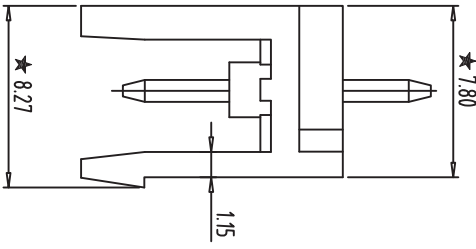

- NOTES:
1. Rating: 300V 15A ;
 2. Insulation Withstands Voltage: AC2000V/MIN
 3. Insulation Resistance: 500M Ω or more at DC500V
 4. Using Temperature Range: -40°C~+105°C
 5. "★" is the important dimension
 6. RoHS compliance

Total Pitch Tolerances		Nominal dimension range																																																								
In mm		In mm																																																								
0	to	0	to	53	to	70	to	90	to	115	to	150	to	250	to	350	to	500	to	700	to	1000																																				
±0.18	to	±0.20	to	±0.25	to	±0.3	to	±0.35	to	±0.44	to	±0.60	to	±0.70	to	±0.85	to	±0.20	to	±0.25	to	±0.30	to	±0.35	to	±0.44	to	±0.55	to	±0.70	to	±0.80	to	±0.90	to	0	to	0	to	10	to	100	to	100	to	150	to	0.2	to	0.3	to	0.3	to	0.2	to	0.3	to	0.5

ITEM	NAME OF PART	NO. OF PART	Q'TY	MATERIAL	NOTE
DWG	SK	DATE	2014/08/19	SIZE	A4
CHK		DATE		SCALE	3:1
APP.		DATE		SCALE	2EDG-5.08
深圳市金航标电子有限公司			WWW. BDS666. COM		
KH-F400V-6P-5. 08G			0755-83044319		

单击下面可查看定价，库存，交付和生命周期等信息

[>>kinghelm\(金航标\)](#)