

F

E

D

C

B

A

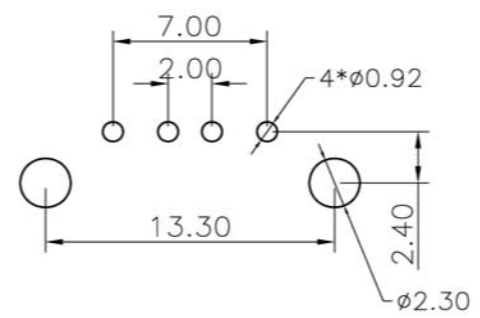
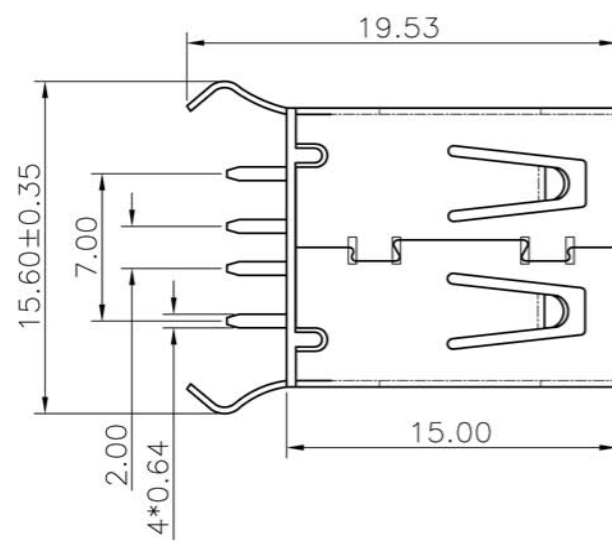
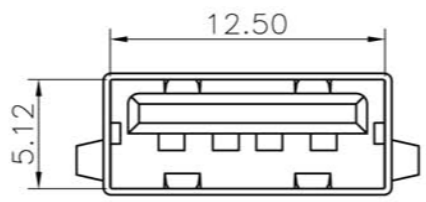
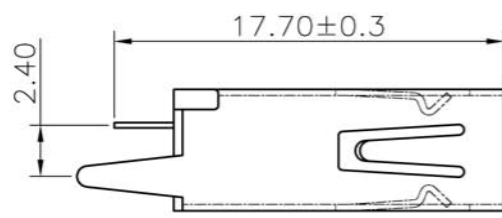

PCB.LAYOUT

NOTES:

1.MATERIAL:

- 1.1 Housing:PBT White,
- 1.2 terminals:Copper Alloy
Gold plated in contact area:
Tin 40u"min plated in termination
Nickel Plated overall
- 1.3 Shell:SPCC t=0.30mm,
Nickel 40u"min Plated overall

2.ELECTRICAL CHARACTERISTICS:

- 2.1 Rating Current :1.5 Ampere
- 2.2 Rating Voltage :30 V Max
- 2.3 Contact Resistance:30 Milli ohms
- 2.4 Insulation Resistance:1000 Mega ohms Min.

3.MECHANICAL CHARACTERISTICS:

- 3.1 Connector Mating force: 35N MAX(3.57Kgf)
- 3.2 Connector Unmating force:10N min(1.02Kgf)
- 3.3 Durability:1500Cycles.

4.ENVIRONMENT CHARACTERISTICS:

- 4.1 Operating temperature:-0°C to +50°C
- 4.2 Storage temperature:-20°C to +60°C

TOLERANCE UNLESS OTHERWISE SPECIFIED
.XXX ±0.10
.XX ±0.20
.X ±0.30
.X' ±3°

产品名称	USB AF180度直插弯脚15.0无卷边	
PART NAME:		
料号	91-US01-472	C
PART No:		

REV:	DESCRIPTION	REV BY	APPROVED	DATE	MATL:	SEE SPECIFICATION	APPROVED
					PROJECTION:	THIRD ANGLE PROJECTION	CHECKED
					UNIT:	SCALE REV(NO) SHEET	DRAWN
					1:1 A 1 OF 1		ZouJianhui
							DATE
							2011.06.11

深圳市金航标电子有限公司	WWW.BDS666.COM
KH-AF180WJ-15	0755-83044319

单击下面可查看定价，库存，交付和生命周期等信息

[>>kinghelm\(金航标\)](#)