

PACKING SPECIFICATION:

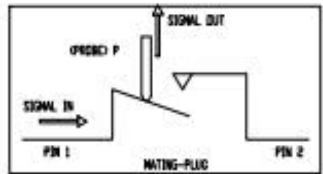

- NOTES:**
- 1.1 Rated Voltage: 50V AC max.
 - 1.2 Frequency Range: DC ~11GHz
 - 1.3 Impedance: 50Ω
 - 1.4 Power Rating: 2W
 - 1.5 Operating Temperature: -40°C ~+85°C
 - 1.6 Insertion Loss: 0.90dB min.
 - 1.7 Withstanding Voltage: 300V AC & Inverse
 - 1.8 Initial Contact Resistance (Without conductor resistance): 70mΩ max.
 - 2.1 Voltage Standing Wave Ratio(VSWR)
 - 1.2 max. (0~3GHz)
 - 1.3 max. (3~8GHz)
 - 1.5 max. (8~11GHz)
 - 2.2 Insertion Loss
 - 0.18dBmax. (0~3GHz)
 - 0.30dBmax. (3~8GHz)
 - 0.60dBmax. (8~11GHz)
 - 2.3 Isolation
 - 20 dBmin. (0~3GHz)
 - 15 dBmin. (3~8GHz)
 - 10 dBmin. (8~11GHz)
 - 2.4 Durability: 100 cycles
 - 3.1 Packing: tape & reel: 2000Pcs/Reel (φ178mm)
 - 3.2 TR ReFlow CYCLE: Sapelec

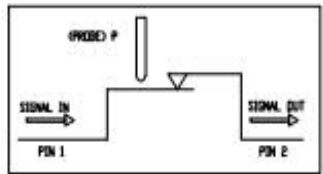
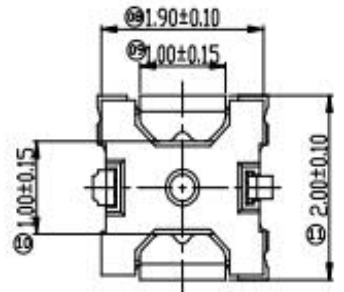
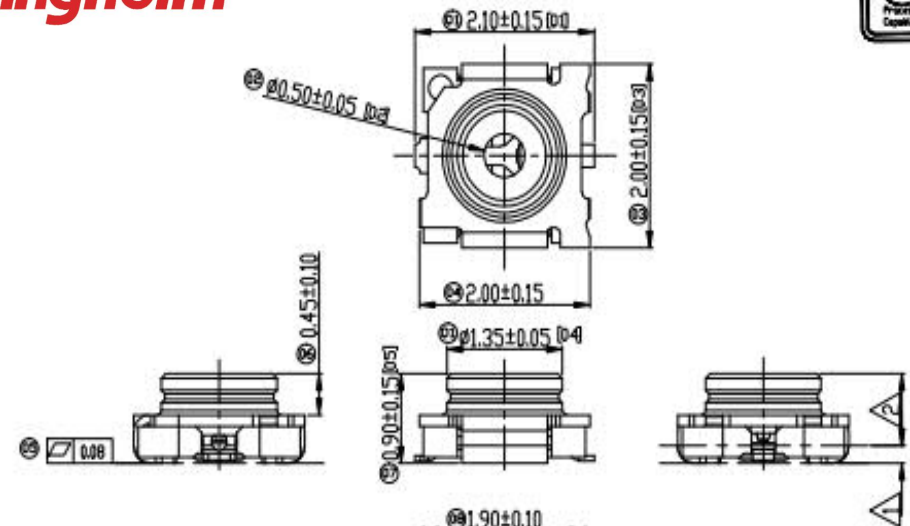
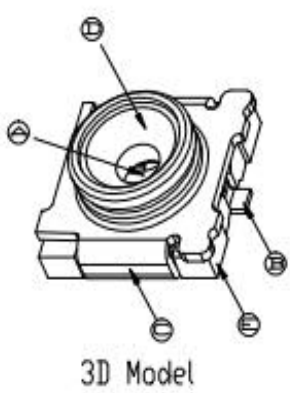
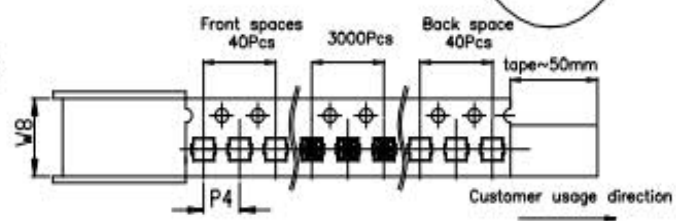
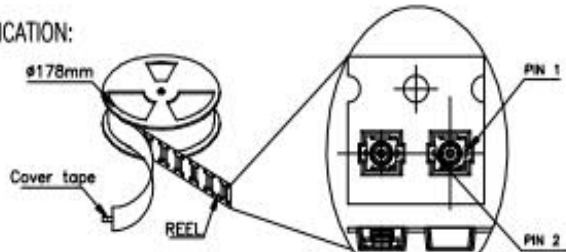
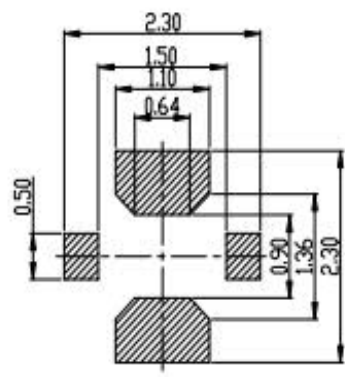

RECOMMENDED PCB LAYOUT
TOLERANCE ±0.05MM

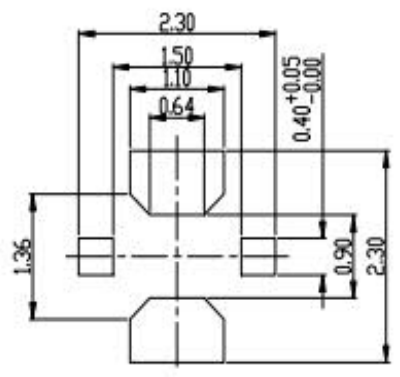

RECOMMEND METAL MASK
(Thickness:0.08mm)

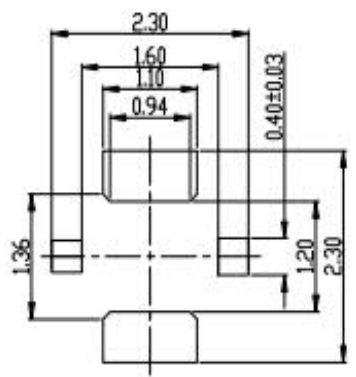

RECOMMEND METAL MASK
(Thickness:0.10mm)

ITEM	DESCRIPTION	Q'TY	MATERIAL/FINISH
①	DOWN HOUSING	1	LCP UL94V-0/BLACK
②	TOP HOUSING	1	LCP UL94V-0/BLACK
③	SHELL	1	Copper Alloy/ Ni:50u" Min Copper Alloy/Au:2u" Min; Ni:50u" Min
④	PIN 2	1	Stainless SteelAu:2u" Min; Ni:50u" Min
⑤	PIN 1	1	Stainless Steel/Au:5u" Min; Ni:50u" Min

BOM LIST

深圳市金航标电子
有限公司
WWW.BDS666.COM
0755-83044319

GENERAL TOLERANCE	SCALE: 1:1	DRAWN: Martin	DATE: 03/07/17	DWG. NO.: 600-11998-01	TITLE: CUSTOMER DRAWING	REV.: A
XX ±0.50	UNIT: mm	CHECK: Ken	DATE: 03/07/17	PARTS NO.(INTENDED USE): KH-202110-3	MINI RF III CONN., L2.00*W2.00*H0.90mm	SHEET 1/1
X ±0.35			DATE: 03/07/17			
.X ±0.25			DATE: 03/07/17			
.XX ±0.15			DATE: 03/07/17			

单击下面可查看定价，库存，交付和生命周期等信息

[>>kinghelm\(金航标\)](#)