

# 产品规格书

型号: KH-PH-PT2.0

## 技术参数 SPECIFICATIONS

线数 ( Poles ): 2~30

适用线规 ( Applicable wires ): AWG30#~24#

适用基板厚度 ( Applicable PC board thickness ): 1.6mm

温度范围 ( Temperature range ):  $-25^{\circ}\text{C}\sim 85^{\circ}\text{C}$

额定电压 ( Voltage rating ): 250V.AC/DC

额定电流 ( Current rating ): 2A

接触电阻 ( Contact resistance ):  $\leq 0.02\Omega$

绝缘电阻 ( Insulation resistance ):  $\geq 1000\text{M}\Omega$

耐压 ( Withstand voltage ): 800V.AC/1min

## 材 料 MATERIAL

端子 ( Terminal ): 磷青铜 ( Phos.bronze Tin/plated )

PH-PT

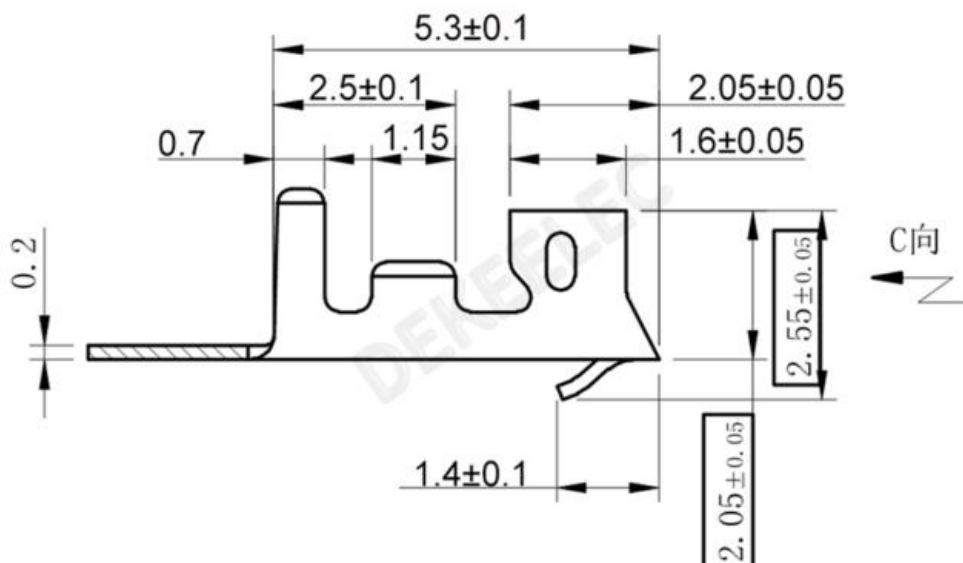

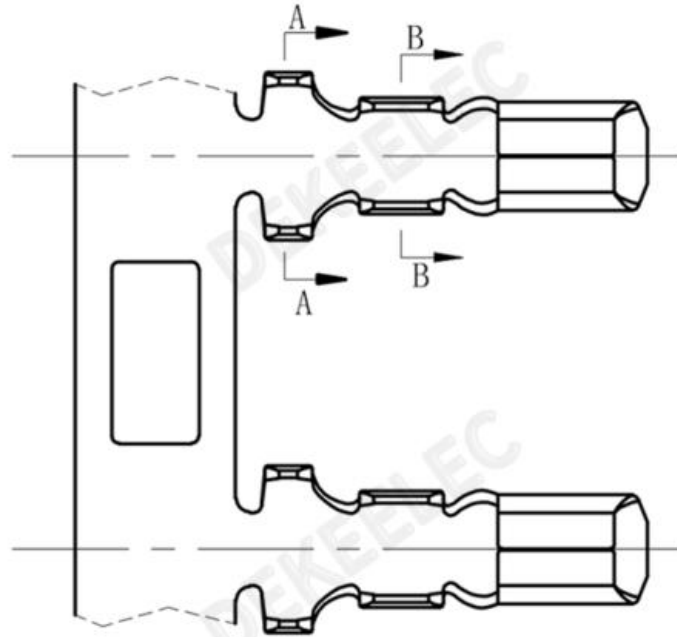
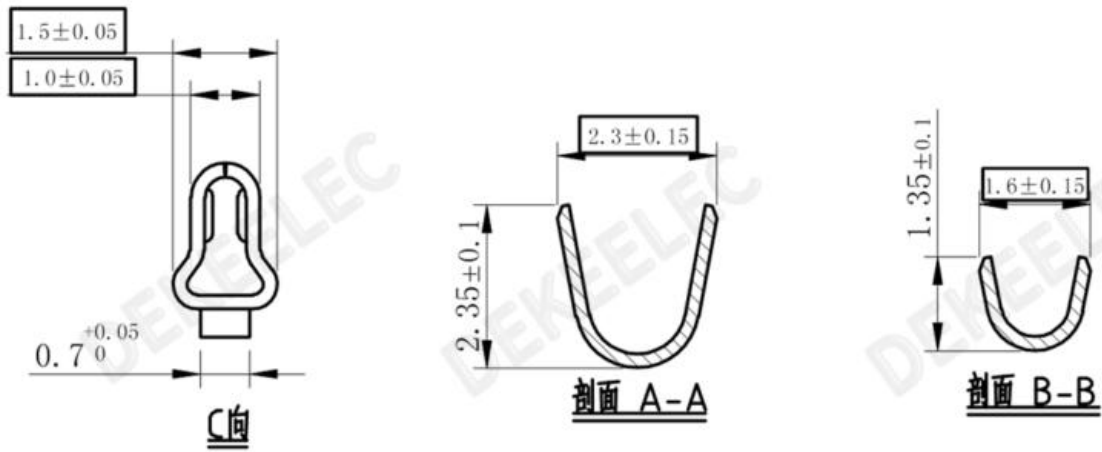

### 端子Terminal(PH)

型号 Type	适用线规 Applicable wires		电线外径 O.D of wire ins
	mm <sup>2</sup>	AWG#	mm
PH-PT	0.05~0.22	30~24	0.9~1.5

单击下面可查看定价，库存，交付和生命周期等信息

[>>kinghelm\(金航标\)](#)