

The 1.5SMC series is designed specifically to protect sensitive electronic equipment from voltage transients induced by lightning and other transient voltage events.

Features

- Halogen-free
- Rohs compliant
- Typical maximum temperature coefficient
- $\Delta V_{BR} = 0.1\% \times V_{BR}@25^{\circ}\text{C} \times \Delta T$
- Glass passivated Chip junction in DO-214AB package
- 1500W peak pulse capability at 10x1000μs waveform, repetition rate (duty cycles):0.01%
- Fast response time:typically less than 1.0ps from 0 Volts to BV min
- Excellent clamping capability
- Low incremental surge resistance
- Typical I_R less than 5μA above 12V
- High temperature soldering guaranteed: 260°C/40 seconds / 0.375",
- (9.5mm) lead length, 5lbs., (2.3kg) tension
- Plastic package has underwriters laboratory flammability classification 94v-0
- AEC -Q101 qualified.

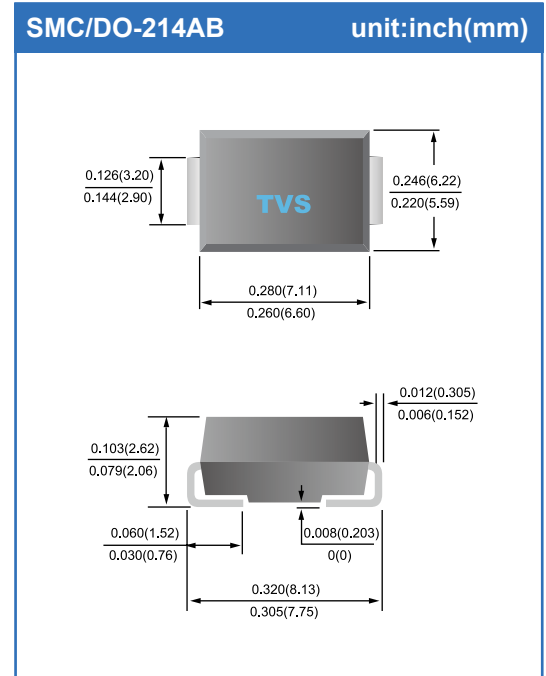

Applications

TVS devices are ideal for the protection of I/O interfaces, V_{CC} bus and other vulnerable circuits used in telecom, computer, industrial and consumer electronic applications.

Maximum Ratings And Characteristics (TA=25°C unless otherwise noted)

Rating	Symbol	Value	Units
Peak Pulse Power Dissipation at TA=25°C by 10x1000μs waveform (Fig.1)(Note 1), (Note 2)	P _{PPM}	1500	Watts
Power Dissipation on infinite heat sink at TA=50°C	P _D	6.5	Watts
Peak Forward Surge Current, 8.3ms Single Half Sine Wave (Note 3)	I _{FSM}	200	Amps
Maximum Instantaneous Forward Voltage at 25A for Unidirectional only (Note 4)	V _F	3.5V/5.0	V
Operating junction and Storage Temperature Range.	T _J , T _{STG}	-55 to 150	°C
Typical Thermal Resistance Junction to Lead	R _{θJL}	15	°C/W
Typical Thermal Resistance Junction to Ambient	R _{θJA}	75	°C/W

Notes:

1. Non-repetitive current pulse, per Fig. 3 and derated above T_A = 25°C per Fig. 2.
2. Measured on 8.3ms single half sine wave or equivalent square wave, duty cycle=4 per minute maximum.
3. V_F<3.5V for devices of V_{BR} < 200V and V_F<5.0V for devices of V_{BR} > 201V.

Electrical Characteristics

Type Number		Reverse Stand-Off Voltage	Breakdown Voltage@I _T		Test Current	Maximum Clamping Voltage@I _{PP}	Peak Pulse Current	Reverse Leakage @V _{RWM}
(UNI)	(BI)	V _{RWM} (V)	V _{BR MIN.} (V)	V _{BR MAX.} (V)	I _T (mA)	V _C (V)	I _{PP} (A)	I _R (μA)
1.5SMC6.8A	1.5SMC6.8CA	5.80	6.40	7.25	10	9.2	163.0	800
1.5SMC7.5A	1.5SMC7.5CA	6.40	7.22	8.30	10	10.3	145.7	800
1.5SMC8.2A	1.5SMC8.2CA	7.02	7.78	8.95	10	12.0	125.0	200
1.5SMC9.1A	1.5SMC9.1CA	7.78	8.33	9.58	1	12.9	116.3	100
1.5SMC10A	1.5SMC10CA	8.55	9.44	10.82	1	13.6	110.3	50
1.5SMC11A	1.5SMC11CA	9.40	10.00	11.50	1	18.2	82.5	5
1.5SMC12A	1.5SMC12CA	10.20	11.10	12.80	1	19.9	75.4	5
1.5SMC13A	1.5SMC13CA	11.10	12.20	14.00	1	21.5	69.8	5
1.5SMC15A	1.5SMC15CA	12.80	14.40	16.50	1	24.4	61.5	5
1.5SMC16A	1.5SMC16CA	13.60	15.60	17.90	1	26.0	57.7	5
1.5SMC18A	1.5SMC18CA	15.30	16.70	19.20	1	29.2	51.4	5
1.5SMC20A	1.5SMC20CA	17.10	18.90	21.70	1	32.4	46.3	5
1.5SMC22A	1.5SMC22CA	18.80	20.00	23.30	1	35.5	42.3	5
1.5SMC24A	1.5SMC24CA	20.50	22.20	25.50	1	38.9	38.6	5
1.5SMC27A	1.5SMC27CA	23.10	24.40	28.00	1	42.1	35.7	5
1.5SMC30A	1.5SMC30CA	25.60	28.90	33.20	1	48.4	31.0	5
1.5SMC33A	1.5SMC33CA	28.20	31.10	35.80	1	53.3	28.2	5
1.5SMC36A	1.5SMC36CA	30.80	33.30	38.30	1	58.1	25.9	5
1.5SMC39A	1.5SMC39CA	33.30	36.70	42.20	1	64.5	23.3	5
1.5SMC43A	1.5SMC43CA	36.80	40.00	46.00	1	69.4	21.7	5
1.5SMC47A	1.5SMC47CA	40.20	44.40	51.10	1	72.7	20.6	5
1.5SMC51A	1.5SMC51CA	43.60	47.80	54.90	1	82.4	18.2	5
1.5SMC56A	1.5SMC56CA	47.80	50.00	57.50	1	87.1	17.3	5
1.5SMC62A	1.5SMC62CA	53.00	56.70	65.20	1	96.8	15.5	5
1.5SMC68A	1.5SMC68CA	58.10	64.40	74.10	1	103.0	14.6	5
1.5SMC75A	1.5SMC75CA	64.10	71.10	81.80	1	121.0	12.4	5
1.5SMC82A	1.5SMC82CA	70.10	77.80	89.50	1	137.0	11.0	5
1.5SMC91A	1.5SMC91CA	77.80	86.70	99.70	1	146.0	10.3	5
1.5SMC100A	1.5SMC100CA	85.50	94.40	108.20	1	162.0	9.3	5
1.5SMC110A	1.5SMC110CA	94.00	100.00	115.50	1	177.0	8.5	5
1.5SMC120A	1.5SMC120CA	102.00	111.00	128.00	1	193.0	7.8	5
1.5SMC130A	1.5SMC130CA	111.00	122.00	140.50	1	209.0	7.2	5
1.5SMC150A	1.5SMC150CA	128.00	144.00	165.50	1	243.0	6.2	5
1.5SMC180A	1.5SMC180CA	154.00	167.00	192.60	1	292.0	5.1	5
1.5SMC200A	1.5SMC200CA	171.00	189.00	217.50	1	324.0	4.6	5
1.5SMC220A	1.5SMC220CA	185.00	209.00	243.20	1	356.0	4.3	5
1.5SMC250A	1.5SMC250CA	214.00	242.00	272.00	1	405.0	3.7	5

Ratings and Characteristic Curves ($T_A=25^\circ\text{C}$ unless otherwise noted)

Figure 1 - Peak Pulse Power Rating

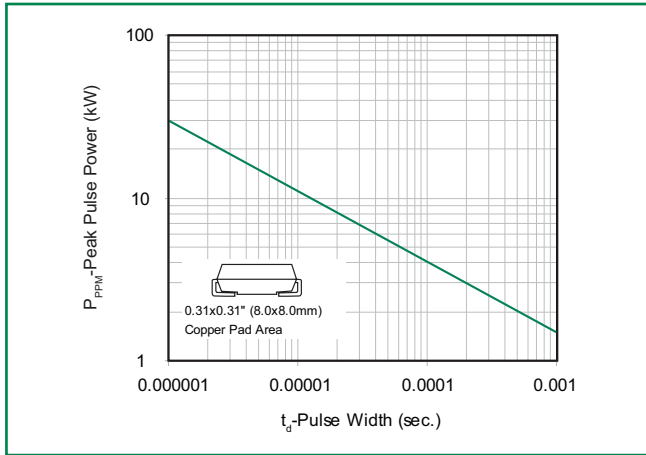

Figure 2 - Pulse Derating Curve

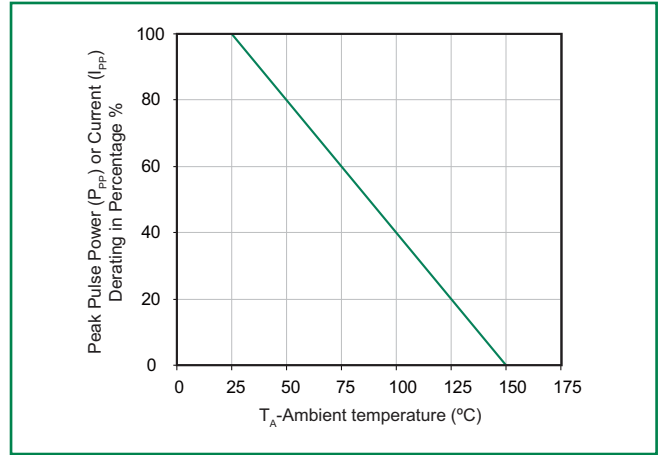

Figure 3 - Pulse Waveform

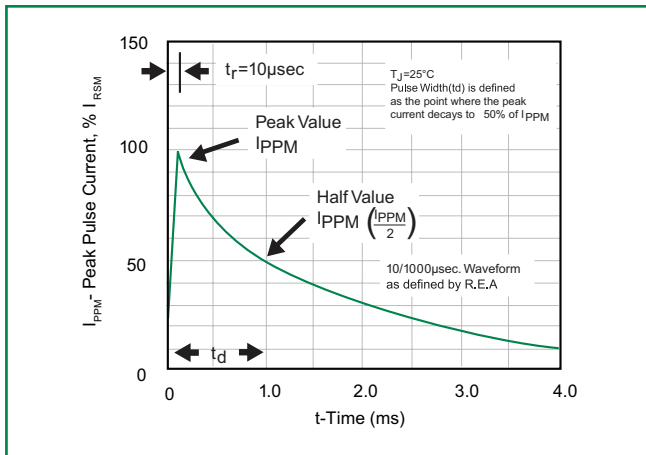

Figure 4 - Typical Junction Capacitance

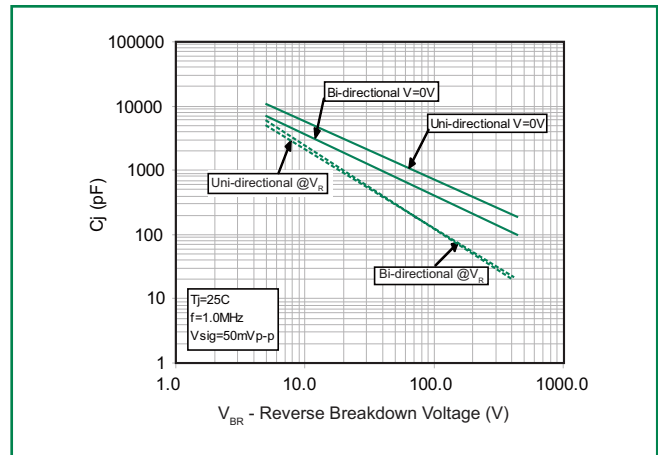

Figure 5 - Steady State Power Dissipation Derating Curve

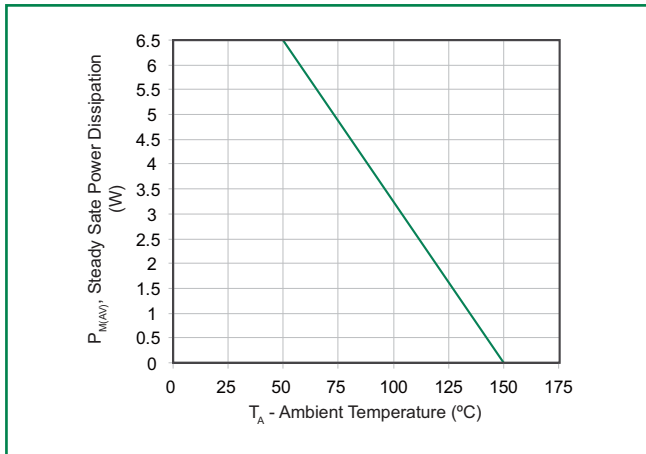
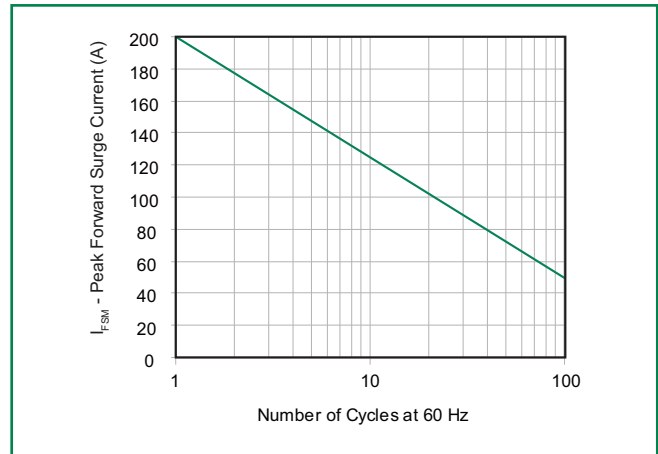
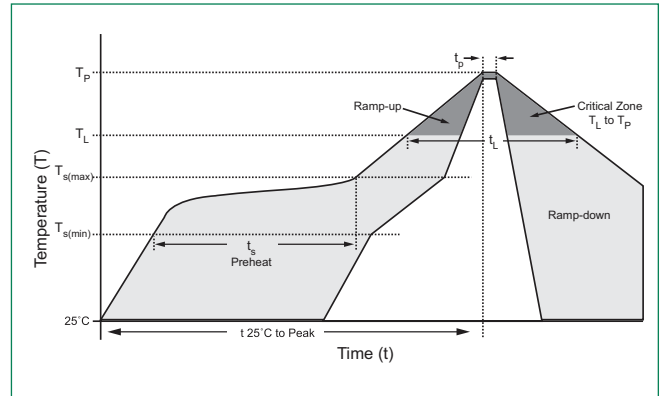

Figure 6 - Maximum Non-Repetitive Peak Forward Surge Current Uni-Directional Only



Soldering Parameters

Reflow Condition		Lead-free assembly
Pre Heat	- Temperature Min ($T_{s(min)}$)	150°C
	- Temperature Max ($T_{s(max)}$)	200°C
	- Time (min to max) (t_s)	60 – 180 secs
Average ramp up rate (Liquidus Temp (T_L) to peak)		3°C/second max
$T_{s(max)}$ to T_L - Ramp-up Rate		3°C/second max
Reflow	- Temperature (T_L) (Liquidus)	217°C
	- Time (min to max) (t_s)	60 – 150 seconds
Peak Temperature (T_p)		260 ^{+0/-5} °C
Time within 5°C of actual peak Temperature (t_p)		20 – 40 seconds
Ramp-down Rate		6°C/second max
Time 25°C to peak Temperature (T_p)		8 minutes Max.
Do not exceed		280°C



Physical Specifications

Weight	0.007 ounce, 0.21 grams
Case	JEDEC DO214AB. Molded plastic body over glass passivated junction
Polarity	Color band denotes positive end (cathode) except Bidirectional.
Terminal	Matte Tin-plated leads, Solderable per JESD22-B102D

Environmental Specifications

Temperature Cycle	JESD22-A104
Pressure Cooker	JESD 22-A102
High Temp. Storage	JESD22-A103
HTRB	JESD22-A108
Thermal Shock	JESD22-A106

Dimensions

DO-214AB (SMC J-Bend)

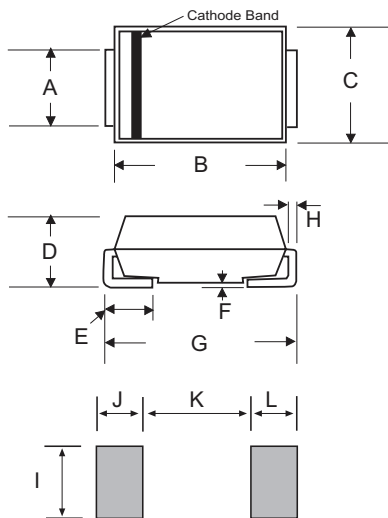

Dimensions	Inches		Millimeters	
	Min	Max	Min	Max
A	0.114	0.126	2.900	3.200
B	0.260	0.280	6.600	7.110
C	0.220	0.245	5.590	6.220
D	0.079	0.103	2.060	2.620
E	0.030	0.060	0.760	1.520
F	-	0.008	-	0.203
G	0.305	0.320	7.750	8.130
H	0.006	0.012	0.152	0.305
I	0.129	-	3.300	-
J	0.094	-	2.400	-
K	-	0.165	-	4.200
L	0.094	-	2.400	-

Shanghai Leiditech Electronic Co.,Ltd
 Email: sale1@leiditech.com
 Tel : +86- 021 50828806
 Fax : +86- 021 50477059

单击下面可查看定价，库存，交付和生命周期等信息

[>>Leiditech\(雷卯电子\)](#)