

08010100 BATTERY DISCONNECT SWITCHES

300A • SPST • IP65 • 360° Rotation



Description

Manual Battery Disconnect Switch features a fixed handle and metal body. The handle and contacts are designed with a unique 360° operation for activating the switch ON-OFF. The handle can be rotated either left or right to switch the circuit status.

Features/Benefits

- 300A continuous current rating
- Switch is ON when handle is aligned with the terminals and OFF when perpendicular with the terminals
- Highly visible bright red handle
- Waterproof and dustproof to IP65

Dimensions

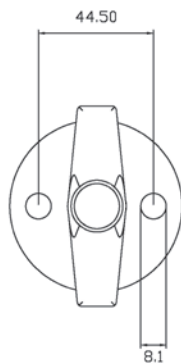

Specifications

Max Operating Voltage:	24V DC
Max Continuous Current:	300A
Intermittent Current:	1000A at 10 sec
Operating Temp:	-40°C to +80°C
Ingress Protection:	IP65
Contacts:	Copper
Terminals:	M10

Applications

- Heavy Truck
- Off-Road
- Emergency Vehicles
- Material Handling
- Mining
- Agricultural
- Marine
- Construction

Web Resources

Download 2D prints and additional technical resources at: littelfuse.com/ManualBatterySwitches

Electrical Diagram

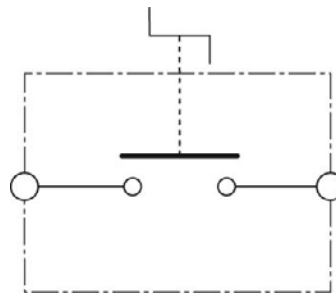

Ordering Information

PART NUMBERS		VOLTAGE	AMPERAGE	CIRCUITRY	MOUNTING	INGRESS	NOTES
BULK	BOXED						
08010100	08010100-BX	24V DC	300A	SPST	Flange Mount	IP65	360° Handle Rotation

单击下面可查看定价，库存，交付和生命周期等信息

[>>Littelfuse\(美国力特\)](#)