



CF Fuses

CF Fuses Rated 58V

Main Fuse for mounting with battery clamp on the battery pole. Voltage rating 58 VDC, Current rating 50A - 300A. With transparent cover material for visual inspection of melting element.

Specifications

| | |
|---------------------------|---|
| Insulating Body Material: | Ceramic |
| Cover Material: | PES |
| | Visible melting-element |
| Interrupting Rating: | 2,000A @58 VDC |
| Complies with: | ISO 8820-6, DIN 72581-5, UL 248 Special Purpose Fuses |
| cULus Recognized: | File No. E211637 |



Ordering Information

Time-Current Characteristics

| Part Number | Package Size | % of Rating | Opening Time Min / Max (s) |
|---------------|--------------|-------------|----------------------------|
| 155.0892.xxx1 | 100 | 100 | 360,000 s / - |
| | | 135 | - / 3,600 s |
| | | 150 | 1 s / 600 s |
| | | 200 | 0.200 s / 60 s |
| | | 300 | 0.050 s / 1.5 s |
| | | 400 | 0.020 s / 0.50 s |
| | | 600 | - / 0.20 s |

Ratings

| Part Number | Current Rating (A) | Typ. Voltage Drop (mV) | Cold Resistance (mΩ) | I ² t (A ² s) |
|---------------|--------------------|------------------------|----------------------|-------------------------------------|
| 155.0892.5501 | 50 | 100 | 1.20 | 1,900 |
| 155.0892.5751 | 75 | 90 | 0.60 | 12,000 |
| 155.0892.6101 | 100 | 80 | 0.60 | 14,000 |
| 155.0892.6121 | 125 | 75 | 0.45 | 51,000 |
| 155.0892.6151 | 150 | 70 | 0.35 | 63,800 |
| 155.0892.6171 | 175 | 70 | 0.25 | 120,000 |
| 155.0892.6201 | 200 | 65 | 0.25 | 172,800 |
| 155.0892.6251 | 250 | 70 | 0.20 | 330,000 |
| 155.0892.6301 | 300 | 70 | 0.15 | 372,000 |

Pre-Arcing Time-Limits

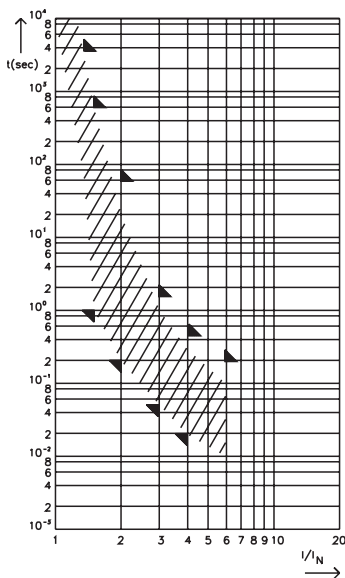

FI = 1.25 (max. operating current:
0.8 x I_{rat} at 23°C)

Insert CF8-Fuse links only in conjunction with the insulating nuts, see Section "Fuse Holders."
Corresponding battery clamp see Section "Fuse Holders."

Dimensions

Dimensions in mm

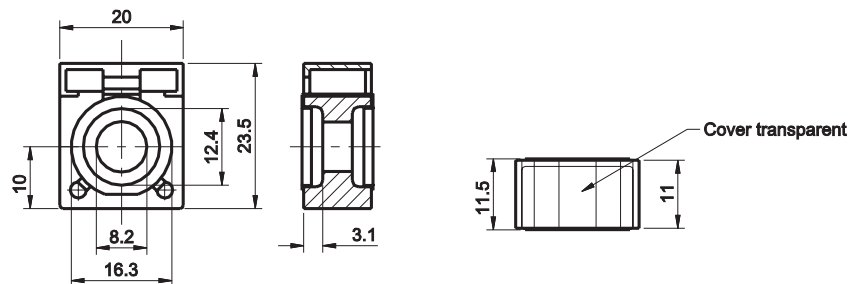

Littelfuse products are not designed for, and shall not be used for, any purpose (including, without limitation, automotive, military, aerospace, medical, life-saving, life-sustaining or nuclear facility applications, devices intended for surgical implant into the body, or any other application in which the failure or lack of desired operation of the product may result in personal injury, death, or property damage) other than those expressly set forth in applicable Littelfuse product documentation. Warranties granted by Littelfuse shall be deemed void for products used for any purpose not expressly set forth in applicable Littelfuse documentation. Littelfuse shall not be liable for any claims or damages arising out of products used in applications not expressly intended by Littelfuse as set forth in applicable Littelfuse documentation. The sale and use of Littelfuse products is subject to Littelfuse Terms and Conditions of Sale, unless otherwise agreed by Littelfuse.

单击下面可查看定价，库存，交付和生命周期等信息

[>>Littelfuse\(美国力特\)](#)