

59075 Heavy Duty Features and Benefits



Features

- 2 Part Magnetically Operated Proximity Sensor
- Heavy Duty Stainless Steel Threaded Barrel with retaining nuts
- M12 by 1.00mm thread
- 5000mm (197") Heavy duty double insulated flying leads

Benefits

- Robust construction makes this sensor well suited to harsh industrial environments
- Simple installation and adjustment using supplied retaining nuts
- No standby power requirement
- Operates through non-ferrous materials such as wood, plastic or aluminium
- Hermetically sealed, magnetically operated contacts continue to operate long after optical and other technologies fail due to contamination

Applications

- Off road and heavy vehicles
- Farm machinery

DIMENSIONS

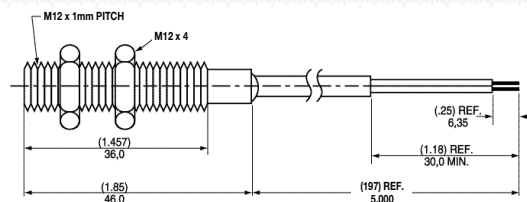
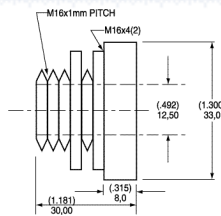

Recommended Activating Positions:

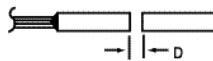

Sensors and Matching Actuators (Note 2)		Actuator	Sensor
Must Actuate	Must Release		
.393 (10,0)	1.18 (30,0)	57075-000	59075-010

Electrical Specifications and Operating Characteristics			Form A SST-NO Standard
Contact Type			
Contact Rating		Watt - max.	10
Voltage	Switching	Vdc - max.	200
	Breakdown	Vdc - min.	250
Current	Switching	A - max.	0.5
	Carry	A - max.	1.2
Resistance	Contact, Initial	- max.	0.2
	Insulation	- min.	10 ¹⁰
Capacitance	Contact	p F - typ.	0.3
Temperature	Operating	°C	-40 to + 105
	Storage	°C	-65 to + 105
Time	Operate	ms - typ.	1.0
	Release	ms - typ.	1.0
Shock	11ms 1/2 sine	G - max.	100
Vibration	50-2000 Hz	G - max.	30

- Notes:
1. Flying Leads
 2. Order Actuators as a separate item.
 3. 59075 PVC Double Insulated Cable, BS 6500, 3A 16/0.2 (0.5mm)

INFORMATION PROVIDED ON THIS DATA SHEET IS PROVIDED FOR INFORMATION PURPOSES ONLY AND SHOULD NOT BE RELIED UPON AS BEING ACCURATE FOR ANY PARTICULAR PURPOSE. Product performance may be affected by the application to which the product is put. Upon request, HAMLIN will assist purchasers by providing information specific to any particular application. HAMLIN disclaims any and all liability whatsoever for any purchaser's reliance upon the information contained on this data sheet without further consultation with authorised representatives of HAMLIN.

Breed Electronics USA Tel: 001 920 648 3000 • Fax: 001 920 648 3001 • Email: sales@hamlin.com
Breed Electronics UK Tel: +44 (0)1379 649700 • Fax: +44 (0)1379 649702 • Email: uksales@breedtech.com
Breed Electronics Germany Tel: +49 (0) 6181 953660 • Fax: +49 (0) 6181 9536666 • Email: hamlin-electronics.de@breedtech.com
Breed Electronics France Tel: +33 1 46 87 02 02 • Fax: +33 1 46 86 67 86 • Email: hamectrol@hamectrol.fr
www.breedelectronics.com

单击下面可查看定价，库存，交付和生命周期等信息

[>>Littelfuse\(美国力特\)](#)