

Product Preview Transient Voltage Suppressors

LTVS2013H4.5CT5G

Features

- Reverse stand-off voltage: $\pm 4.5V$ Max
- Low clamping voltage
- Complies with IEC 61000-4-2 standards:
 Air discharge: $\pm 30kV$
 Contact discharge: $\pm 30kV$
- RoHS Compliant

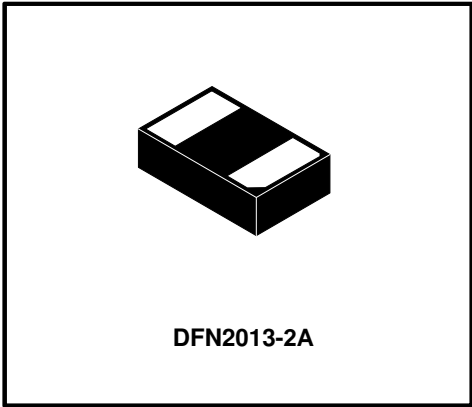

Ordering information

Device	Marking	Shipping
LTVS2013H4.5CT5G	3H	4000/Tape&Reel

Absolute Maximum Ratings ($T_A=25^\circ C$ unless otherwise specified)

Parameter	Symbol	Value	Unit
Peak Pulse Power (8/20 μs)	Ppk	1920	W
Peak Pulse Current (8/20 μs)	I _{PP}	160	A
Operating Temperature Range	T _J	-55 to +125	$^\circ C$
Storage Temperature Range	T _{stg}	-55 to +150	$^\circ C$

LTVS2013H4.5CT5G

ELECTRICAL CHARACTERISTICS

($T_A = 25^\circ\text{C}$ unless otherwise noted)

Symbol	Parameter
I_{PP}	Maximum Reverse Peak Pulse Current
V_C	Clamping Voltage @ I_{PP}
V_{RWM}	Reverse standoff voltage
I_R	Maximum Reverse Leakage Current @ V_{RWM}
V_{BR}	Breakdown Voltage @ I_T
I_T	Test Current
V_{TRIG}	Reverse trigger voltage
I_{TRIG}	Reverse trigger current

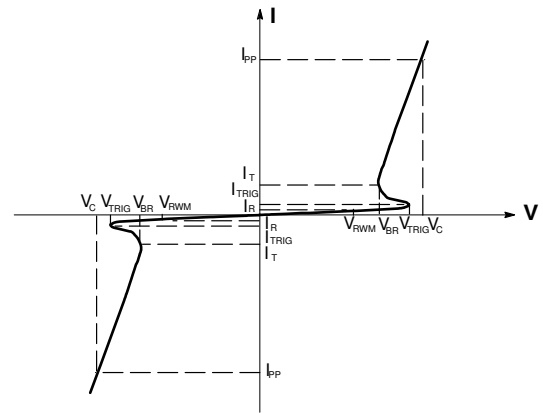

Bi-Directional TVS

Electrical Characteristics ($T_A=25^\circ\text{C}$ unless otherwise specified)

Parameter	Symbol	Min	Typ	Max	Unit	Test Condition
Reverse Working Voltage	V_{RWM}			4.5	V	
Breakdown Voltage	V_{BR}	4.8		6.2	V	$I_T = 1\text{ mA}$
Reverse trigger voltage	V_{TRIG}	5			V	$I_{TRIG} = 2\mu\text{A}$
Reverse Leakage Current	I_R			0.8	μA	$V_R = 4.5\text{V}$
Clamping Voltage	V_C			7.5	V	$I_{PP} = 36\text{A}$ (8 x 20 μs pulse)
Clamping Voltage	V_C			9	V	$I_{PP} = 70\text{A}$ (8 x 20 μs pulse)
Clamping Voltage	V_C			14	V	$I_{PP} = 160\text{A}$ (8 x 20 μs pulse)
Clamping Voltage	V_C			6	V	$I_{TLP} = 16\text{A}$ IEC 61000-4-2 $\pm 8\text{kV}$ Pin 1 to Pin 2
Junction Capacitance	C_J		500	600	pF	$V_R = 0\text{V}$, $f = 1\text{MHz}$

LTVS2013H4.5CT5G

Typical Performance Characteristics ($T_A=25^\circ\text{C}$ unless otherwise Specified)

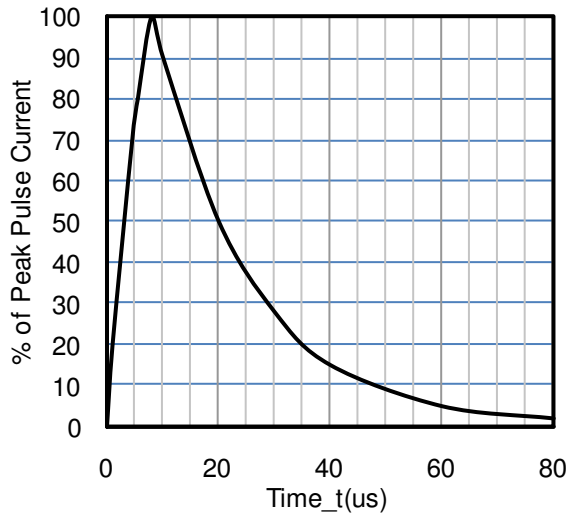

Fig1. 8/20us Pulse Waveform

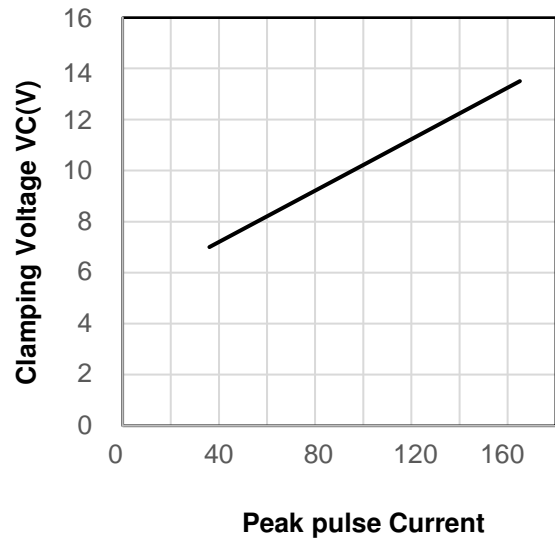

Fig2. Clamping Voltage Vs. Peak pulse Current

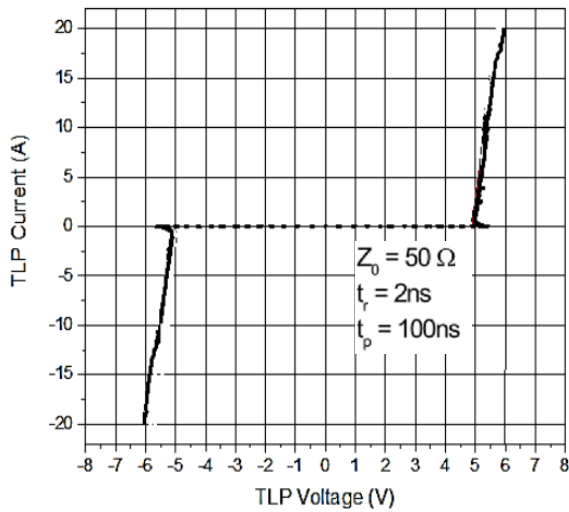

Fig3. TLP Measurement

LTVS2013H4.5CT5G



Fig4. ESD Clamping Voltage Screenshot Positive 8 kV Contact per IEC61000-4-2

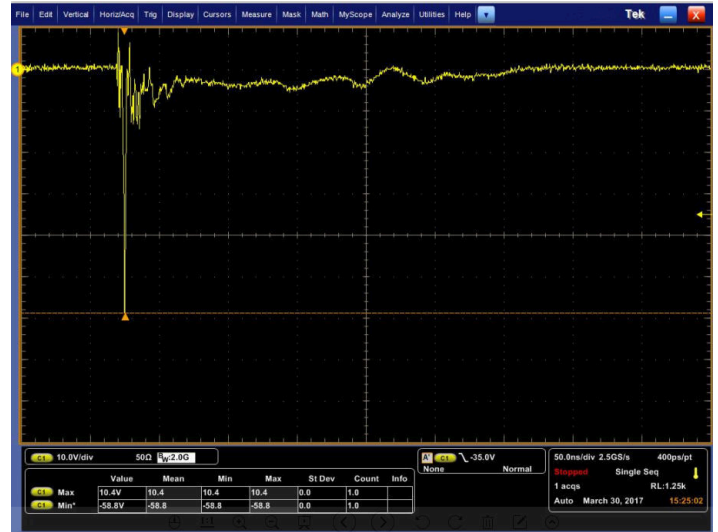
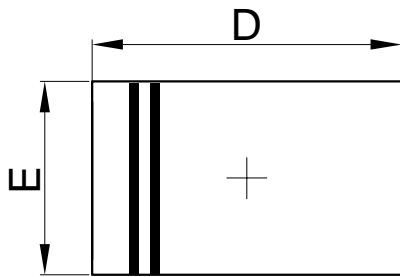

Fig5. ESD Clamping Voltage Screenshot Negative 8 kV Contact per IEC61000-4-2

LTVS2013H4.5CT5G

DFN2013-2A



TOP VIEW

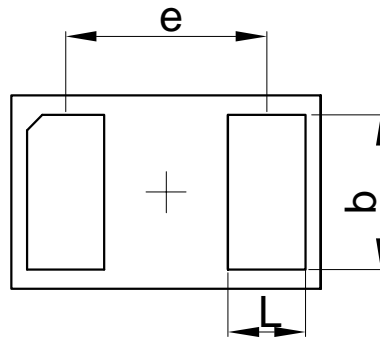

BOTTOM VIEW

DFN2013-2A			
Dim	Min	Typ	Max
A	0.57	0.62	0.67
A1	0.00	0.02	0.05
b	0.95	1.00	1.05
D	1.95	2.00	2.05
E	1.20	1.25	1.30
e	-	1.30	-
L	0.45	0.50	0.55
All Dimensions in mm			

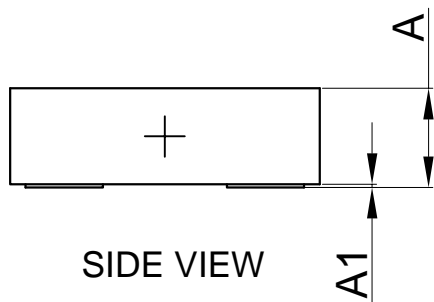

SIDE VIEW

Suggested solder pad layout

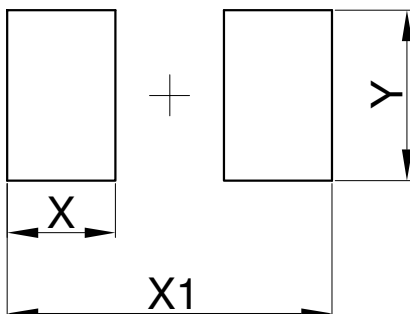

Dimensions	(mm)
X	0.70
X1	2.10
Y	1.10

单击下面可查看定价，库存，交付和生命周期等信息

[>>LRC\(乐山无线电\)](#)