

General Description

The MDD1503 uses advanced Magnachip's MOSFET Technology, which provides high performance in on-state resistance, fast switching performance and excellent quality. MDD1503 is suitable device for DC to DC converter and general purpose applications.

Features

- $V_{DS} = 30V$
- $I_D = 87.5A @ V_{GS} = 10V$
- $R_{DS(ON) (MAX)} < 4.7m\Omega @ V_{GS} = 10V$
 $< 6.8m\Omega @ V_{GS} = 4.5V$
- 100% UIL Tested
- 100% Rg Tested

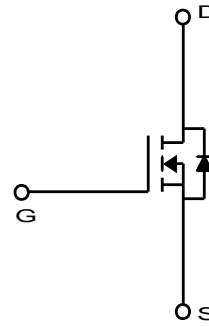
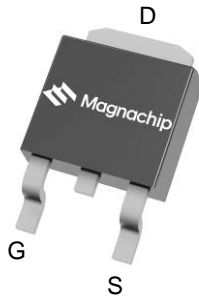

Absolute Maximum Ratings (Ta = 25°C)

Characteristics		Symbol	Rating	Unit
Drain-Source Voltage		V_{DSS}	30	V
Gate-Source Voltage		V_{GSS}	±20	V
Continuous Drain Current ⁽¹⁾	$T_C=25^\circ C$	I_D	87.5	A
	$T_C=70^\circ C$		70.0	
	$T_A=25^\circ C$		28.2 ⁽³⁾	
	$T_A=70^\circ C$		22.7 ⁽³⁾	
Pulsed Drain Current		I_{DM}	350	A
Power Dissipation	$T_C=25^\circ C$	P_D	59.5	W
	$T_C=70^\circ C$		38.0	
	$T_A=25^\circ C$		6.2 ⁽³⁾	
	$T_A=70^\circ C$		4.0 ⁽³⁾	
Single Pulse Avalanche Energy ⁽²⁾		E_{AS}	146	mJ
Junction and Storage Temperature Range		T_J, T_{stg}	-55~150	°C

Thermal Characteristics

Characteristics	Symbol	Rating	Unit
Thermal Resistance, Junction-to-Ambient ⁽¹⁾	$R_{\theta JA}$	20.0	°C/W
Thermal Resistance, Junction-to-Case	$R_{\theta JC}$	2.1	

Ordering Information

Part Number	Temp. Range	Package	Packing	Quantity	Rohs Status
MDD1503RH	-55~150°C	D-PAK	Tape & Reel	3000 units	Halogen Free

Electrical Characteristics (T_J =25°C)

Characteristics	Symbol	Test Condition	Min	Typ	Max	Unit
Static Characteristics						
Drain-Source Breakdown Voltage	BV _{DSS}	I _D = 250μA, V _{GS} = 0V	30	-	-	V
Gate Threshold Voltage	V _{GS(th)}	V _{DS} = V _{GS} , I _D = 250μA	1.3	1.9	2.7	V
Drain Cut-Off Current	I _{DSS}	V _{DS} = 30V, V _{GS} = 0V	-	-	1	μA
Gate Leakage Current	I _{GSS}	V _{GS} = ±20V, V _{DS} = 0V	-	-	±0.1	μA
Drain-Source ON Resistance	R _{DS(ON)}	V _{GS} = 10V, I _D = 22A	-	4.1	4.7	mΩ
		T _J =125°C	-	5.9	6.8	
Forward Transconductance	g _{fs}	V _{DS} = 5V, I _D = 10A	-	27	-	S
Dynamic Characteristics						
Total Gate Charge	Q _{g(10V)}	V _{DS} = 15.0V, I _D = 22A, V _{GS} = 10V	21	28	35	nC
Total Gate Charge	Q _{g(4.5V)}		10	13.3	16.6	
Gate-Source Charge	Q _{gs}		-	5.9	-	
Gate-Drain Charge	Q _{gd}		-	4.2	-	
Input Capacitance	C _{iss}	V _{DS} = 15.0V, V _{GS} = 0V, f = 1.0MHz	1349	1799	2249	pF
Reverse Transfer Capacitance	C _{rss}		132	177	221	
Output Capacitance	C _{oss}		266	354	443	
Turn-On Delay Time	t _{d(on)}	V _{GS} = 10V, V _{DS} = 15.0V, I _D = 22A, R _G = 3.0Ω	-	12	-	ns
Rise Time	t _r		-	12.7	-	
Turn-Off Delay Time	t _{d(off)}		-	30.6	-	
Fall Time	t _f		-	9.2	-	
Gate Resistance	R _g	f=1 MHz	-	1.2	2.0	Ω
Drain-Source Body Diode Characteristics						
Source-Drain Diode Forward Voltage	V _{SD}	I _S = 22A, V _{GS} = 0V	-	0.84	1.1	V
Body Diode Reverse Recovery Time	t _{rr}	I _F = 22A, di/dt = 100A/μs	-	27.1	40.7	ns
Body Diode Reverse Recovery Charge	Q _{rr}		-	20.6	30.9	nC

Note :

- Surface mounted FR-4 board by JEDEC (jesd51-7)
- E_{AS} is tested at starting T_J = 25 °C, L = 0.1mH, I_{AS} = 30.0A, V_{DD} = 27V, V_{GS} = 10V.
- T < 10sec.

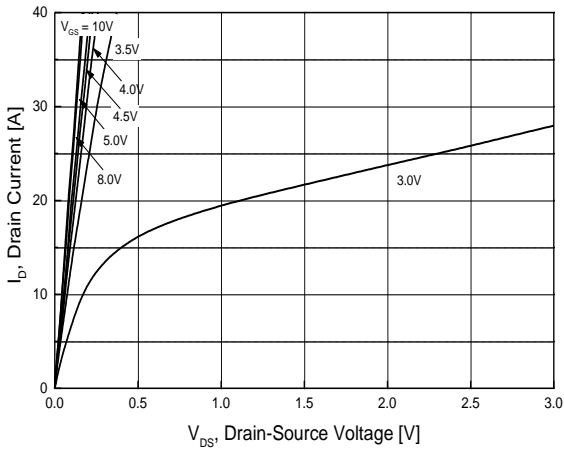

Fig.1 On-Region Characteristics

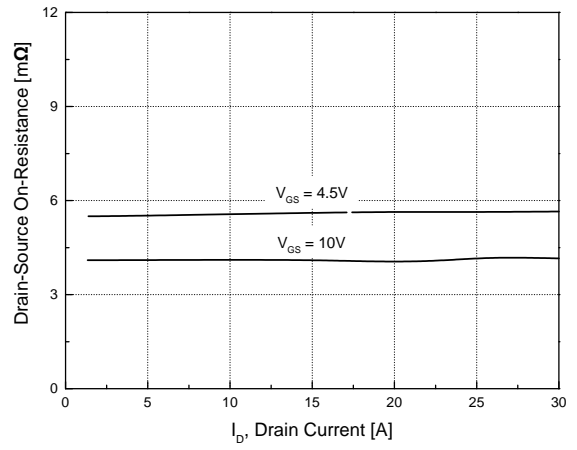

Fig.2 On-Resistance Variation with Drain Current and Gate Voltage

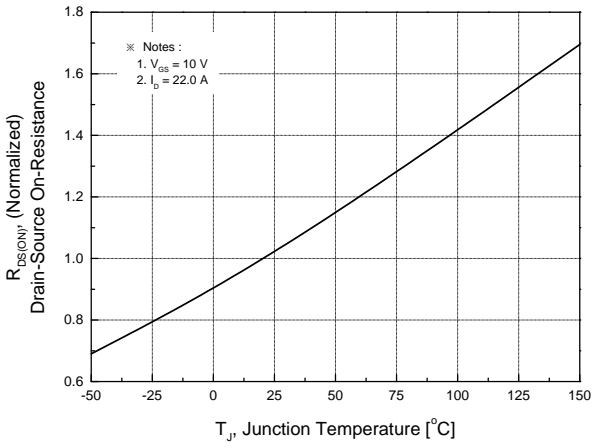

Fig.3 On-Resistance Variation with Temperature

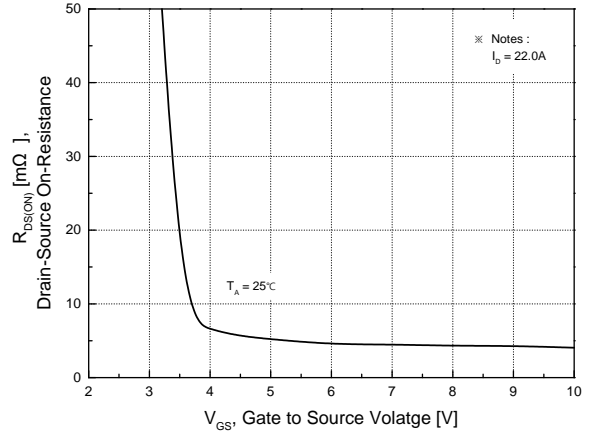

Fig.4 On-Resistance Variation with Gate to Source Voltage

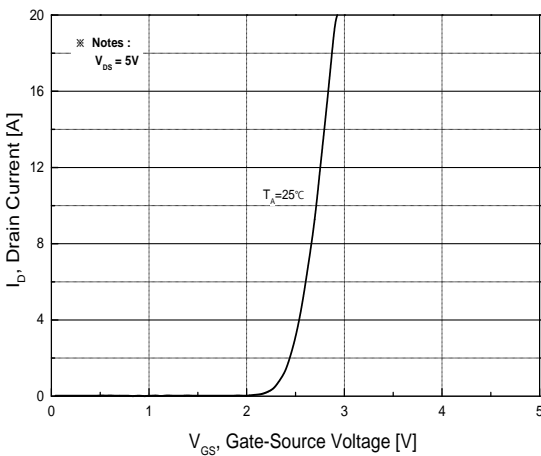

Fig.5 Transfer Characteristics

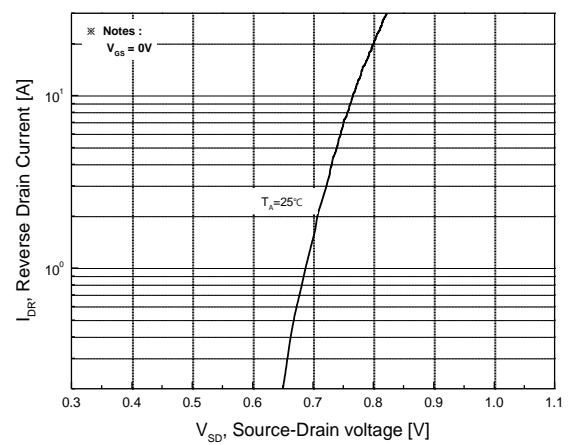

Fig.6 Body Diode Forward Voltage Variation with Source Current and Temperature

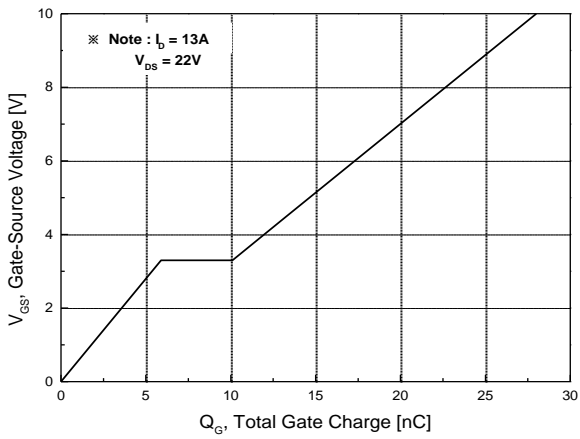

Fig.7 Gate Charge Characteristics

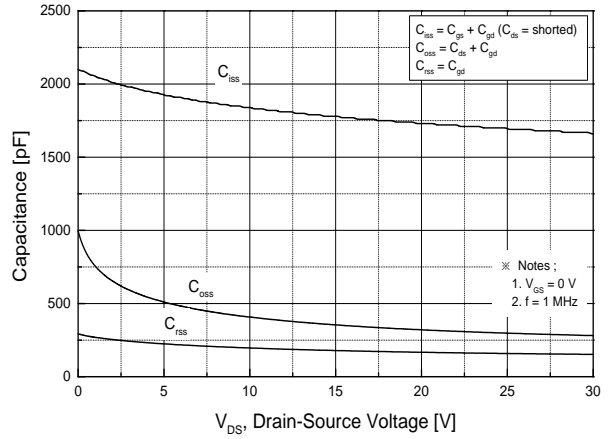

Fig.8 Capacitance Characteristics

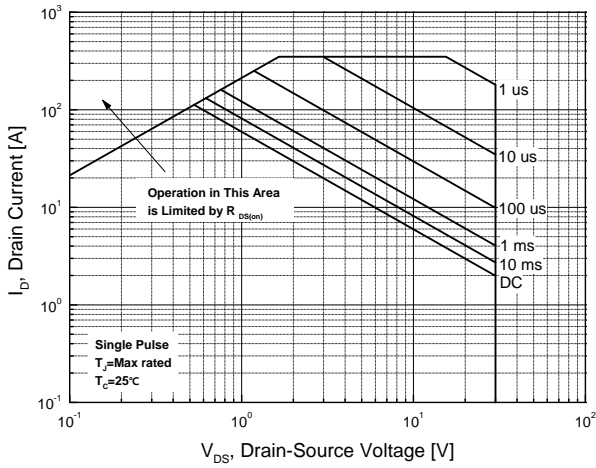

Fig.9 Maximum Safe Operating Area

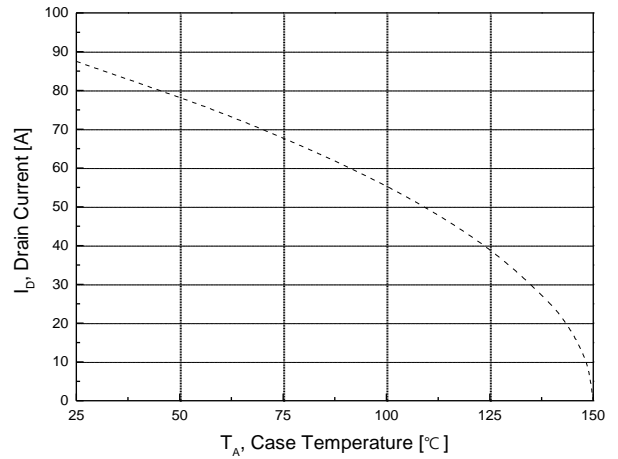

Fig.10 Maximum Drain Current vs. Case Temperature

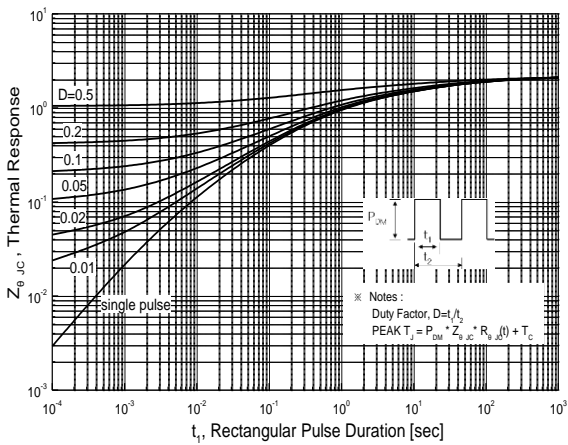
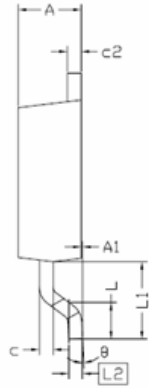
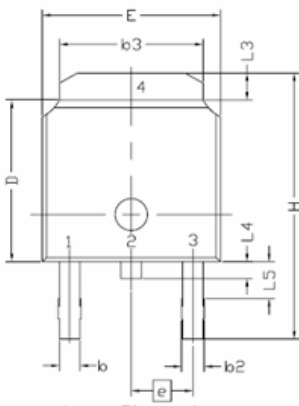

Fig.11 Transient Thermal Response Curve

Package Dimension

TO-252

Dimensions are in millimeters, unless otherwise specified



Symbol	Min.	Nom.	Max.
E	6,35	-	6,73
L	1,40	1,52	1,78
L1	2,74 REF		
L2	0,508 BCS		
L3	0,89	-	1,27
L4	-	-	1,02
L5	1,14	-	1,52
D	5,97	6,10	6,22
H	9,40	-	10,41
b	0,64	-	0,89
b2	0,76	-	1,14
b3	4,95	-	5,46
e	2,286 BSC		
A	2,18	-	2,39
A1	-	-	0,13
c	0,46	-	0,61
c2	0,46	-	0,89
D1	5,21	-	-
E1	4,32	-	-
⌀	0,00	-	10,00

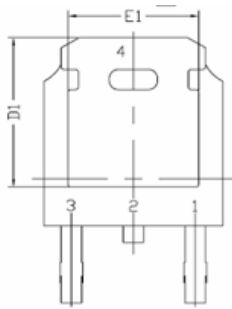

Note : Package body size, length and width do not include mold flash, protrusions and gate burrs.

DISCLAIMER:

The Products are not designed for use in hostile environments, including, without limitation, aircraft, nuclear power generation, medical appliances, and devices or systems in which malfunction of any Product can reasonably be expected to result in a personal injury. Seller's customers using or selling Seller's products for use in such applications do so at their own risk and agree to fully defend and indemnify Seller.

Magnachip reserves the right to change the specifications and circuitry without notice at any time. Magnachip does not consider responsibility for use of any circuitry other than circuitry entirely included in a Magnachip product.  Magnachip is a registered trademark of Magnachip Semiconductor Ltd.

单击下面可查看定价，库存，交付和生命周期等信息

[>>MAGNACHIP\(美格纳\)](#)