

General Description

The MDS1656 uses advanced Magnachip's trench MOSFET Technology to provide high performance in on-state resistance, switching performance and reliability

Low $R_{DS(ON)}$, low gate charge can be offering superior benefit in the application.

Features

- $V_{DS} = 30V$
- $I_D = 7.2A$ @ $V_{GS} = 10V$
- $R_{DS(ON)}$
 $< 28m\Omega$ @ $V_{GS} = 10V$
 $< 42m\Omega$ @ $V_{GS} = 4.5V$

Applications

- Inverters
- General purpose applications

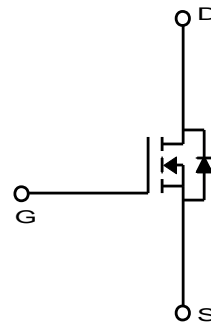
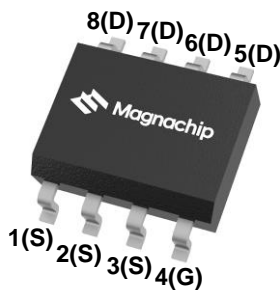

Absolute Maximum Ratings ($T_a = 25^\circ C$ unless otherwise noted)

Characteristics	Symbol	Rating	Unit
Drain-Source Voltage	V_{DSS}	30	V
Gate-Source Voltage	V_{GSS}	± 20	V
Continuous Drain Current ⁽¹⁾	I_D	$T_C = 25^\circ C$	7.2
		$T_C = 70^\circ C$	6.2
Pulsed Drain Current	I_{DM}	30	A
Power Dissipation	P_D	$T_C = 25^\circ C$	2
		$T_C = 70^\circ C$	1.44
Single Pulse Avalanche Energy ⁽²⁾	E_{AS}	20	mJ
Junction and Storage Temperature Range	T_J, T_{stg}	-55~150	$^\circ C$

Thermal Characteristics

Characteristics	Symbol	Rating	Unit
Thermal Resistance, Junction-to-Ambient(Steady-State) ⁽¹⁾	$R_{\theta JA}$	100	$^\circ C/W$
Thermal Resistance, Junction-to-Case	$R_{\theta JC}$	60	

Ordering Information

Part Number	Temp. Range	Package	Packing	RoHS Status
MDS1656R	-55~150°C	SOIC-8	Tape & Reel	Halogen Free

Electrical Characteristics (T_a =25°C unless otherwise noted)

Characteristics	Symbol	Test Condition	Min	Typ	Max	Unit
Static Characteristics						
Drain-Source Breakdown Voltage	BV _{DSS}	I _D = 250μA, V _{GS} = 0V	30	-	-	V
Gate Threshold Voltage	V _{GS(th)}	V _{DS} = V _{GS} , I _D = 250μA	1.0	1.9	3.0	
Drain Cut-Off Current	I _{DSS}	V _{DS} = 24V, V _{GS} = 0V	-		1	μA
Gate Leakage Current	I _{GSS}	V _{GS} = ±20V, V _{DS} = 0V	-	-	0.1	
Drain-Source ON Resistance	R _{DS(ON)}	V _{GS} = 10V, I _D = 6.9A	-	21.5	28	mΩ
		V _{GS} = 4.5V, I _D = 5.0A	-	31.5	42	
On-State Drain Current	I _{D(ON)}	V _{DS} = 5V, V _{GS} = 4.5V	20	-	-	A
Forward Transconductance	g _{FS}	V _{DS} = 5V, I _D = 6.9A	10	15.4	-	S
Maximum Body-Diode Continuous Current			-	-		
Dynamic Characteristics						
Total Gate Charge	Q _g	V _{DS} = 15V, I _D = 6.9A, V _{GS} = 10V	-	6.94	-	nC
Gate-Source Charge	Q _{gs}		-	1.54	-	
Gate-Drain Charge	Q _{gd}		-	1.4	-	
Input Capacitance	C _{iss}	V _{DS} = 15V, V _{GS} = 0V, f = 1.0MHz	-	334	-	pF
Reverse Transfer Capacitance	C _{rss}		-	48	-	
Output Capacitance	C _{oss}		-	83	-	
Turn-On Delay Time	t _{d(on)}	V _{GS} = 10V, V _{DS} = 15V, R _L = 2.2Ω, R _{GEN} = 3Ω	-	3.5	-	ns
Turn-On Rise Time	t _r		-	25.4	-	
Turn-Off Delay Time	t _{d(off)}		-	14.2	-	
Turn-Off Fall Time	t _f		-	10.5	-	
Drain-Source Body Diode Characteristics						
Source-Drain Diode Forward Voltage	V _{SD}	I _S = 1A, V _{GS} = 0V	-	0.75	1.0	V
Body Diode Reverse Recovery Time	t _{rr}	I _F = 6.9A, di/dt = 100A/μs	-	16.5	20	ns
Body Diode Reverse Recovery Charge	Q _{rr}		-	7.8	10	nC

Notes :

1. Surface mounted FR-4 board with 2oz. Copper..
2. Starting T_J = 25°C, L = 1mH, I_{AS} = 5A, V_{DD} = 15V, V_{GS} = 10V.

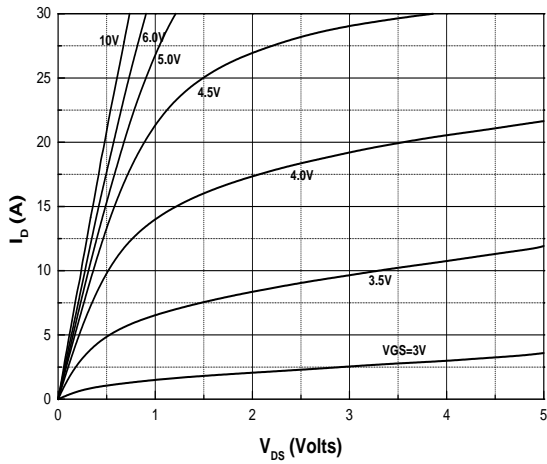

Fig.1 On-Region Characteristics

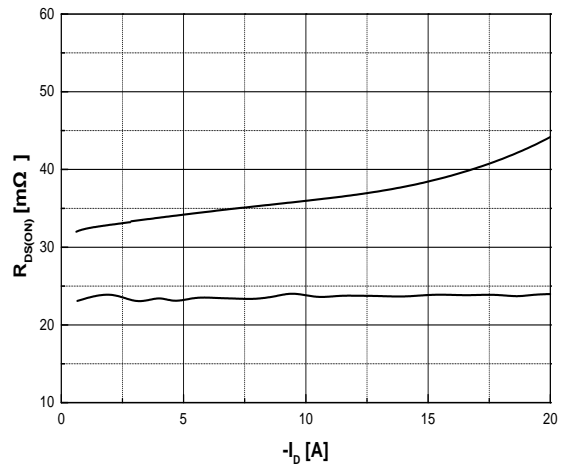

Fig.2 On-Resistance Variation with Drain Current and Gate Voltage

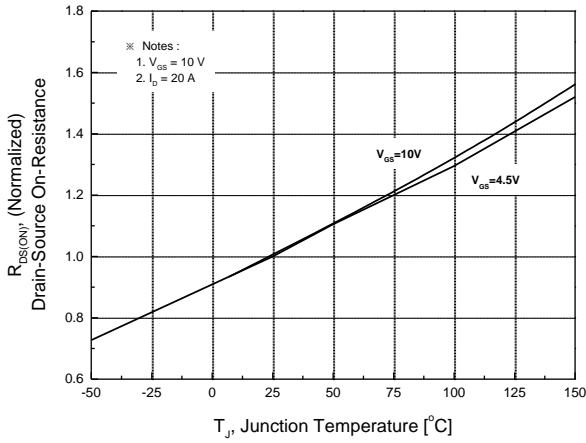

Fig.3 On-Resistance Variation with Temperature

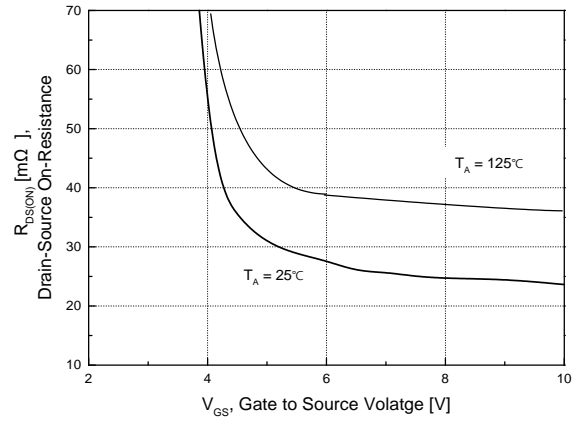

Fig.4 On-Resistance Variation with Gate to Source Voltage

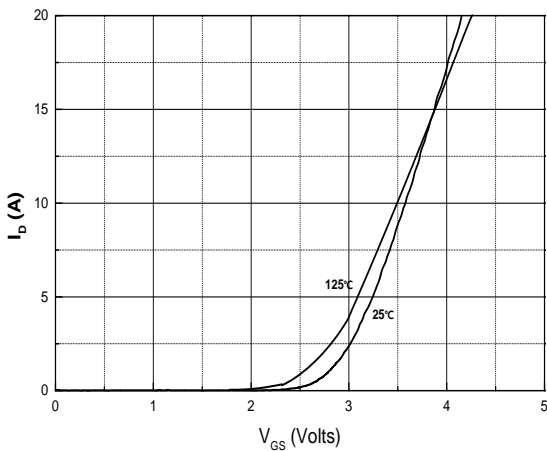

Fig.5 Transfer Characteristics

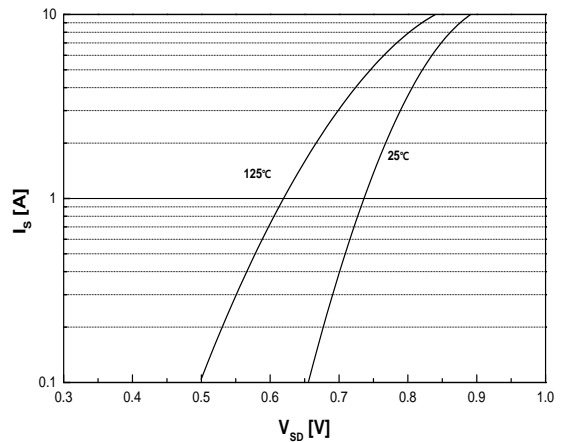

Fig.6 Body Diode Forward Voltage Variation with Source Current and Temperature

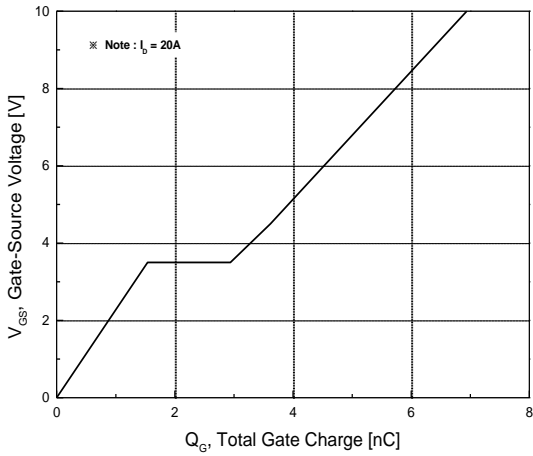

Fig.7 Gate Charge Characteristics

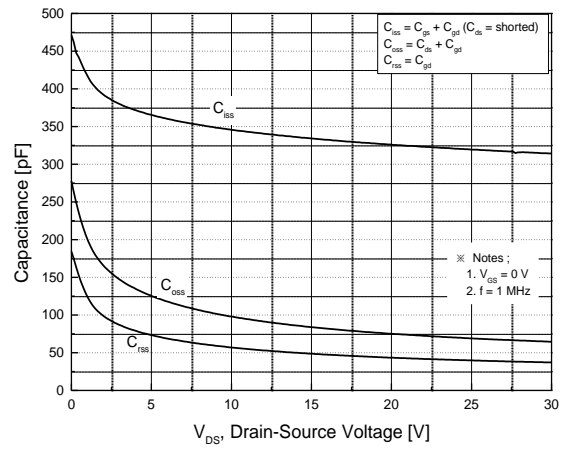

Fig.8 Capacitance Characteristics

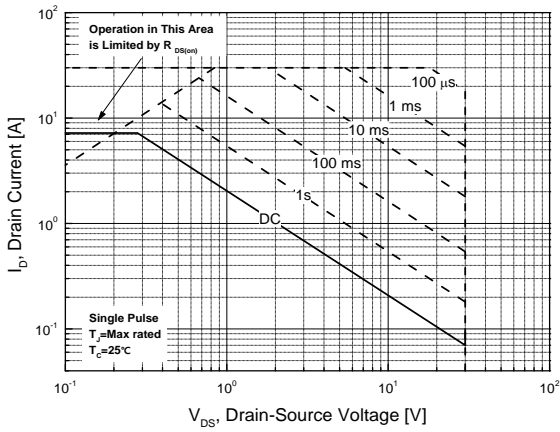

Fig.9 Maximum Safe Operating Area

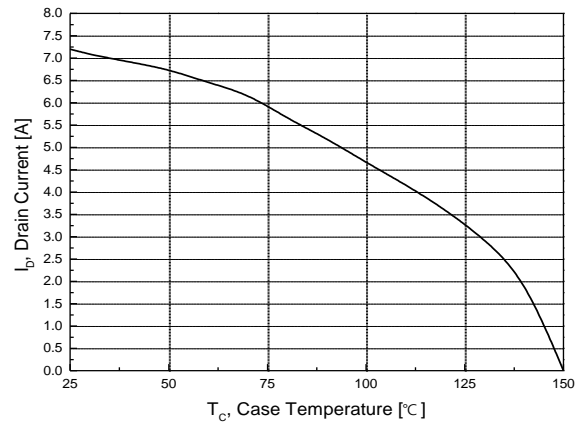

Fig.10 Maximum Drain Current vs. Case Temperature

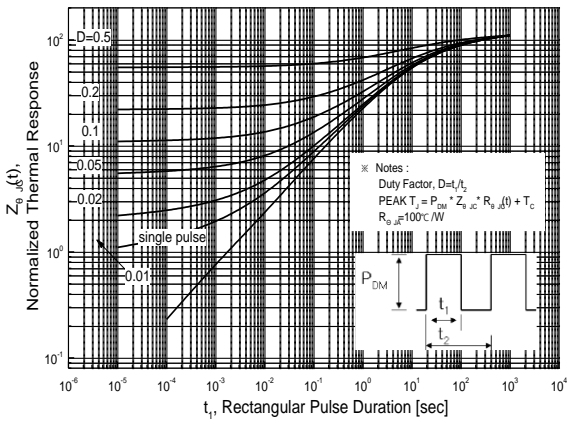
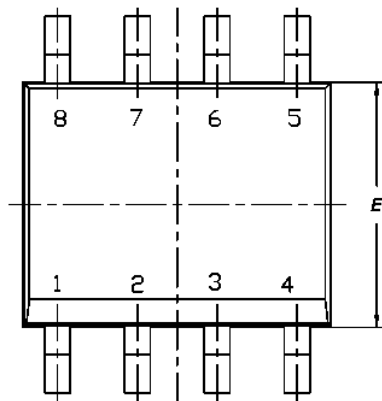

Fig.11 Transient Thermal Response Curve

Physical Dimensions

SOIC-8L

Dimensions are in millimeters unless otherwise specified



DIM.	MILLIMETERS		
	MIN.	NOM.	MAX.
A	1.35	1.55	1.75
A(1)	0.10	0.175	0.25
B	0.38	0.445	0.51
C	0.19	0.22	0.25
D	4.80	4.90	5.00
E	3.80	3.90	4.00
e	1.27 BSC		
H	5.80	6.00	6.20
L	0.50	0.715	0.93
α	0°	4°	8°
h	0.25	0.375	0.50

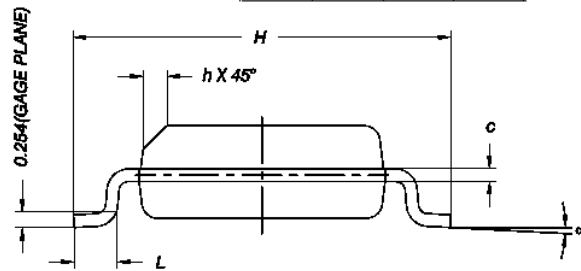
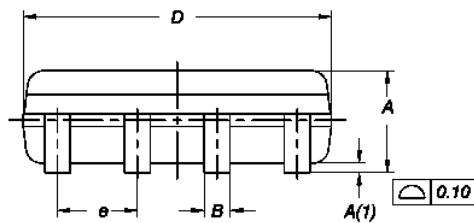

Note : Package body size, length and width do not include mold flash, protrusions and gate burrs.

DISCLAIMER:

The Products are not designed for use in hostile environments, including, without limitation, aircraft, nuclear power generation, medical appliances, and devices or systems in which malfunction of any Product can reasonably be expected to result in a personal injury. Seller's customers using or selling Seller's products for use in such applications do so at their own risk and agree to fully defend and indemnify Seller.

Magnachip reserves the right to change the specifications and circuitry without notice at any time. Magnachip does not consider responsibility for use of any circuitry other than circuitry entirely included in a Magnachip product.  Magnachip is a registered trademark of Magnachip Semiconductor Ltd.

单击下面可查看定价，库存，交付和生命周期等信息

[>>MAGNACHIP\(美格纳\)](#)