

To \_\_\_\_\_

No. A391-040403N-01

Date 3rd Apr. '04

Type No.  
**PRAC5**

Data Sheet

<b>PCS1900 Rx SAW Filter</b>	
Application	: Rx Filter for PCS1900
Center Frequency	: 1960MHz
Size	: 2.0x1.4mm, 5pin-layout
Impedance	: 50-150ohms unbalance-balance
Part No.	: EFCH1960TCA1

Issued S. Tsuzuki

Check K. Nishimura

CIRCUIT COMPONENTS BUSINESS UNIT

**MATSUSHITA ELECTRONIC COMPONENTS CO.,LTD**

KADOMA, OSAKA, JAPAN

**PCS1900 Rx SAW Filter**

----- Unbalanced input and balanced output -----

Part No. :

Design No. : T1960XF8

Parameter		Frequency	Your request			Our preliminary spec.			Unit
			Min.	Typ.	Max.	Min.	Typ.	Max.	
Passband			1930 ... 1990			1930 ... 1990			MHz
Insertion loss		1930 ... 1990MHz					1.5	2.3	dB
Ripple in passband		1930 ... 1990MHz					0.3	1.5	dB
Amplitude imbalance		1930 ... 1990MHz				-1.5	-0.7 +0.4	+1.5	dB
Phase imbalance		1930 ... 1990MHz				-10	-1 +2	+10	deg.
Attenuation	Att1	DC ... 1830MHz				30	40		dB
	Att2	1830 ... 1910MHz ( T=+15 ... +60 deg.C )				12	16		dB
		1830 ... 1910MHz ( T=-10 ... +80 deg.C )				10			dB
	Att3	2010 ... 2070MHz ( T=+15 ... +60 deg.C )				12	16		dB
		2010 ... 2070MHz ( T=-10 ... +80 deg.C )				10			dB
	Att4	2070 ... 2500MHz				20	22		dB
	Att5	2500 ... 4000MHz				25	31		dB
	Att6	4000 ... 6000MHz				20	48		dB
VSWR	Input	1930 ... 1990MHz					2.1	2.4	
	Output	1930 ... 1990MHz					2.1	2.4	
Input impedance (Single Ended)						50			Ohm
Output impedance (Differential)						150 // 22 nH			Ohm
Maximum drive level								13	dBm
Operating temperature						-10		+80	deg. C
Storage temperature						-40		+85	deg. C

# PCS1900 Rx SAW Filter

----- Unbalanced input and balanced output -----

Part No. :

Design No. : T1960XF8

Jig Loss = 0.3dB

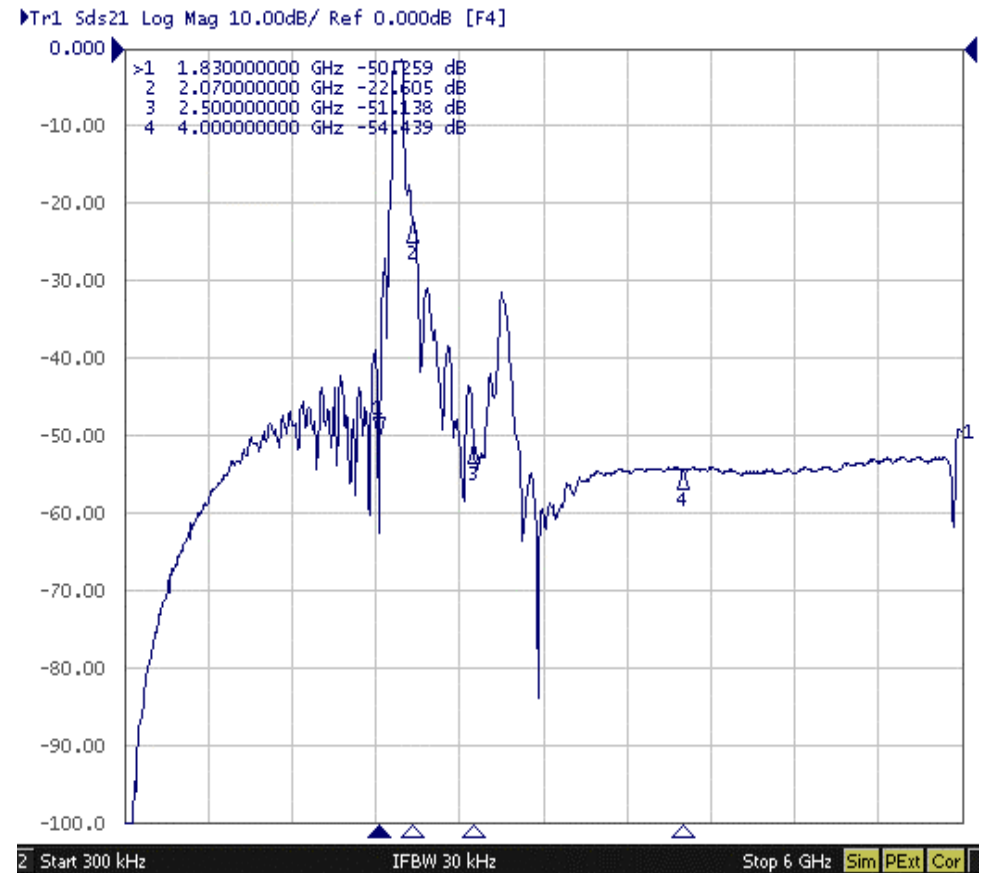
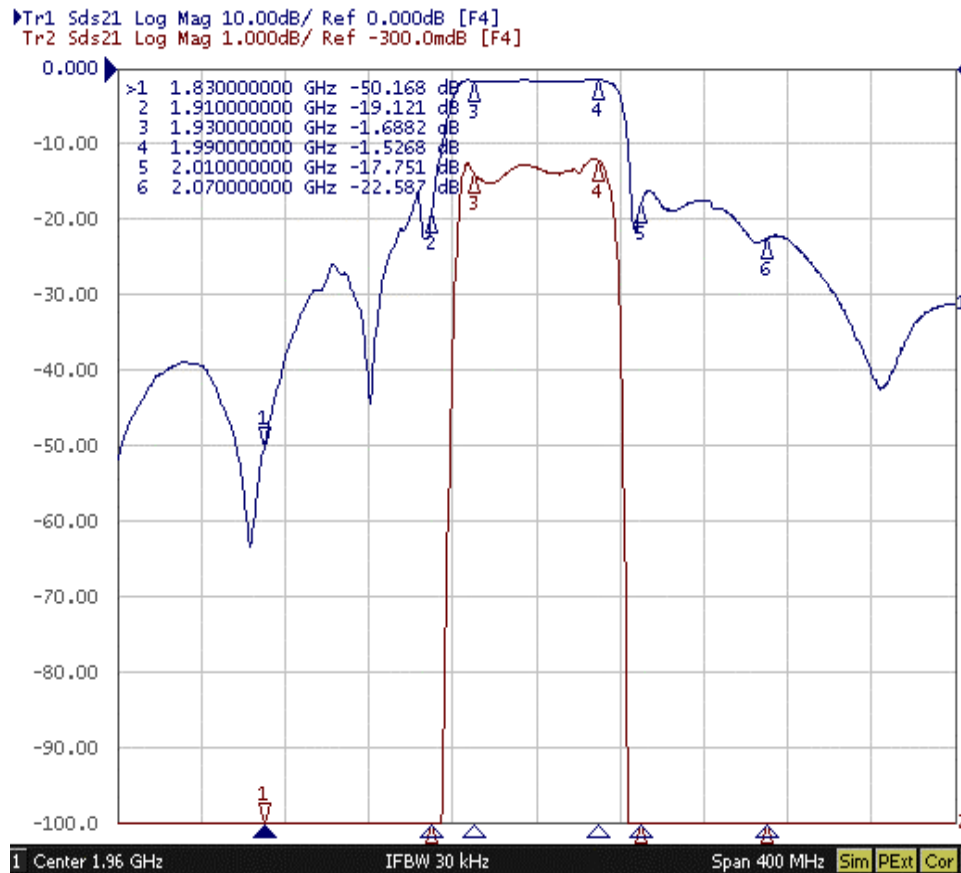

# PCS1900 Rx SAW Filter

----- Unbalanced input and balanced output -----

Part No. :

Design No. : T1960XF8

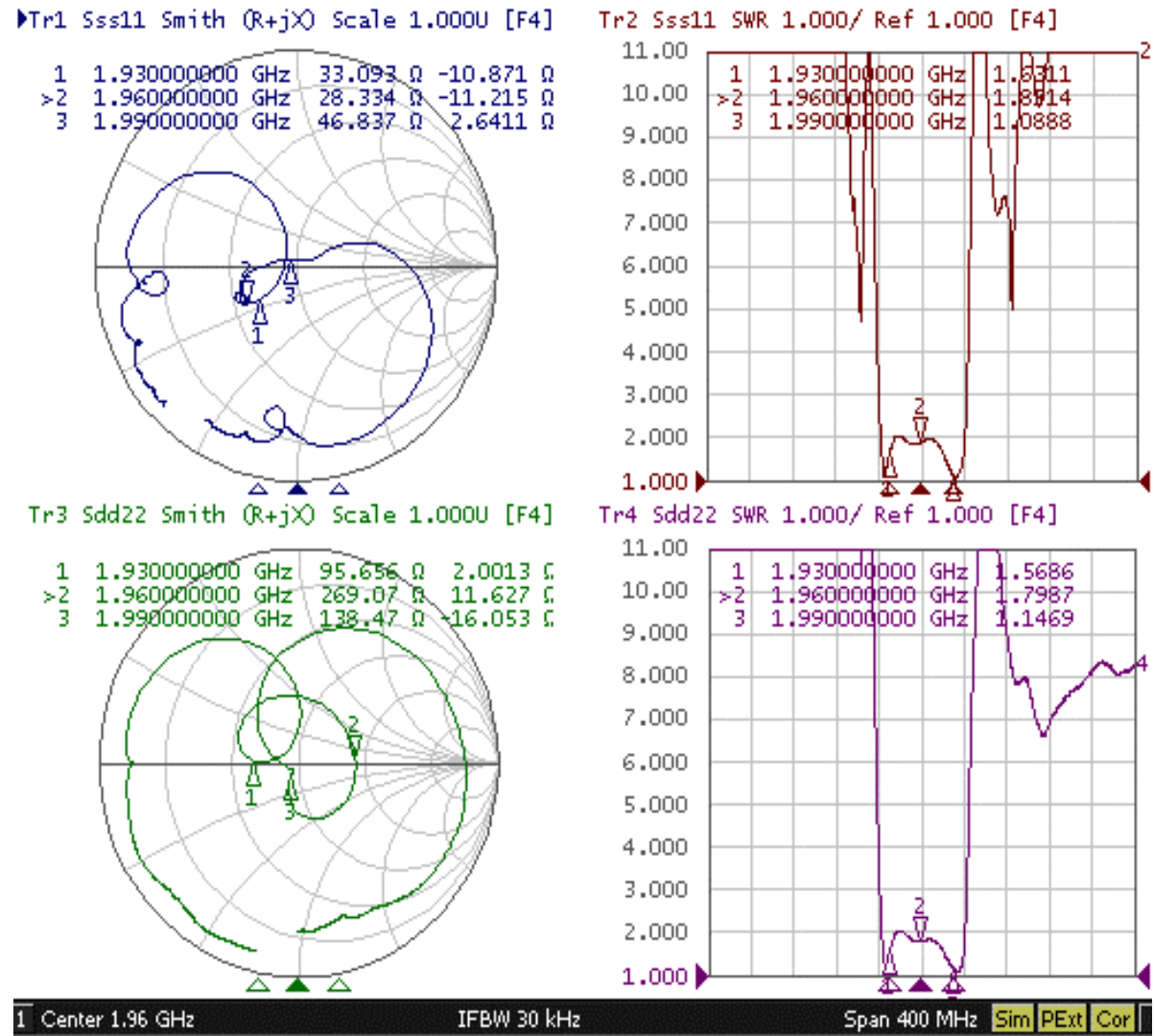

## PCS1900 Rx SAW Filter

----- Unbalanced input and balanced output -----

Part No. :

Design No. : T1960XF8

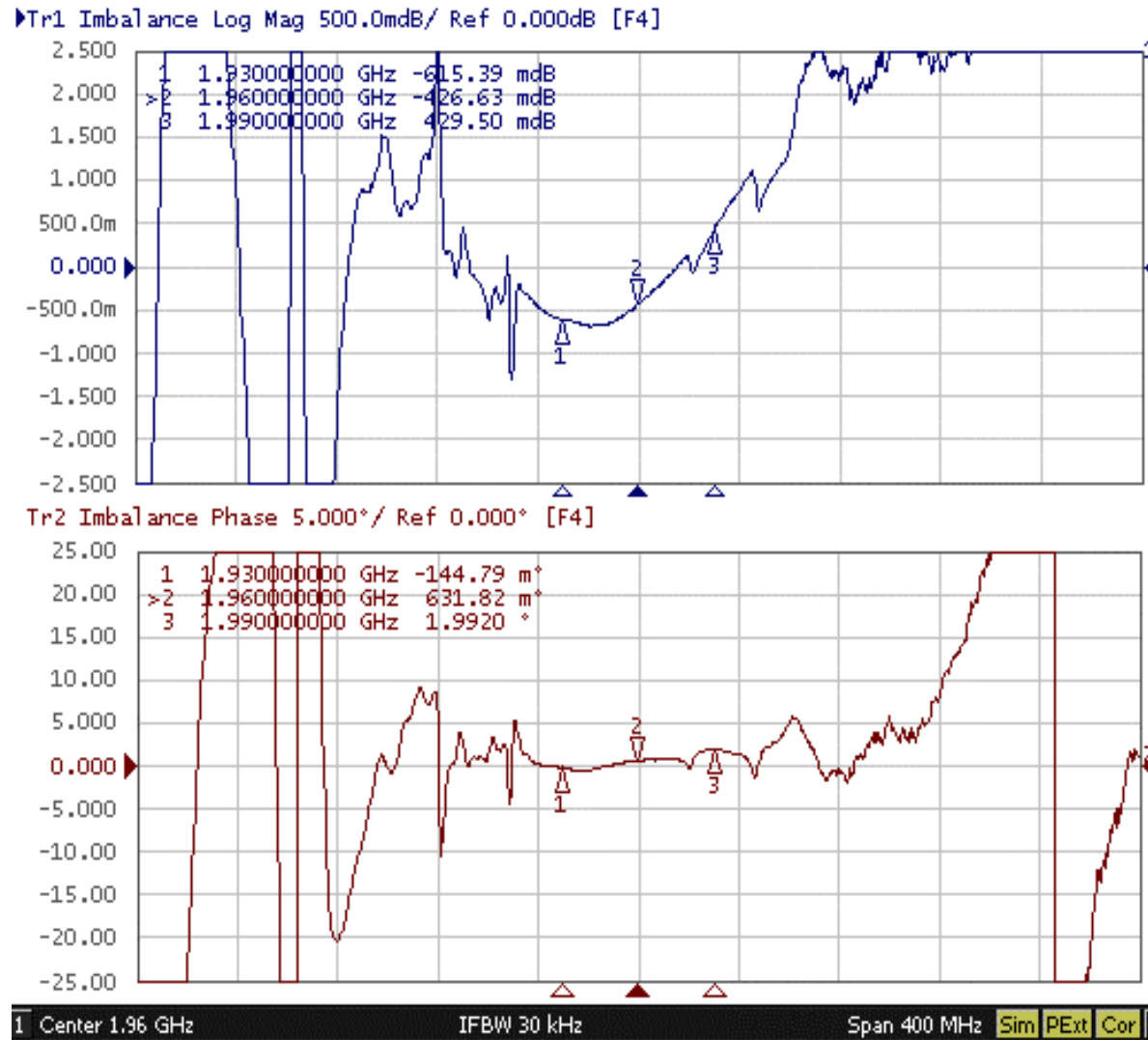

THIRD ANGLE PROJECTION

Tolerance : +/-0.05

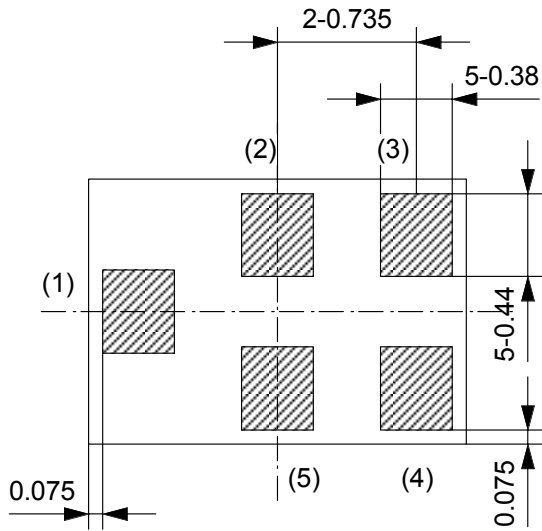
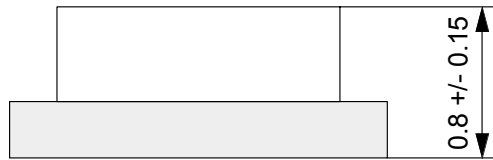
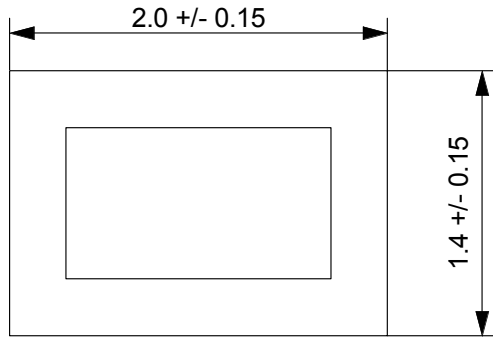

- (1) Input
- (2) GND
- (3) Output
- (4) Output
- (5) GND

**Note :**  
The design manufacturing process,  
and Specification of this device  
are subject to change without  
notice.

UNLESS OTHERWISE SPECIFIED

BASIC DIMENSIONS		TOLERANCE
UP TO	INCL	
TO	INCL	
TO	INCL	
TO	INCL	
ABOVE		

--	--	--

ISSUE	REVISIONS	DATE
MATERIAL	FINISH	SCALE
DESIGN		
DRAW		
CHECK		
APPROVAL		
DRAWING NO.		

NAME	TYPE NO.
------	----------

**SAW Filter**

**CERAMIC BUSINESS UNIT, LCR DEVICE COMPANY  
MATSUSHITA ELECTRONIC COMPONENTS CO.,LTD.  
KADOMA, OSAKA, JAPAN**

DO NOT SCALE DRAWING

REVISIONS INDICATED BY Δ

ALL DIMENSIONS ARE IN MILLIMETERS

# Measurement Circuit

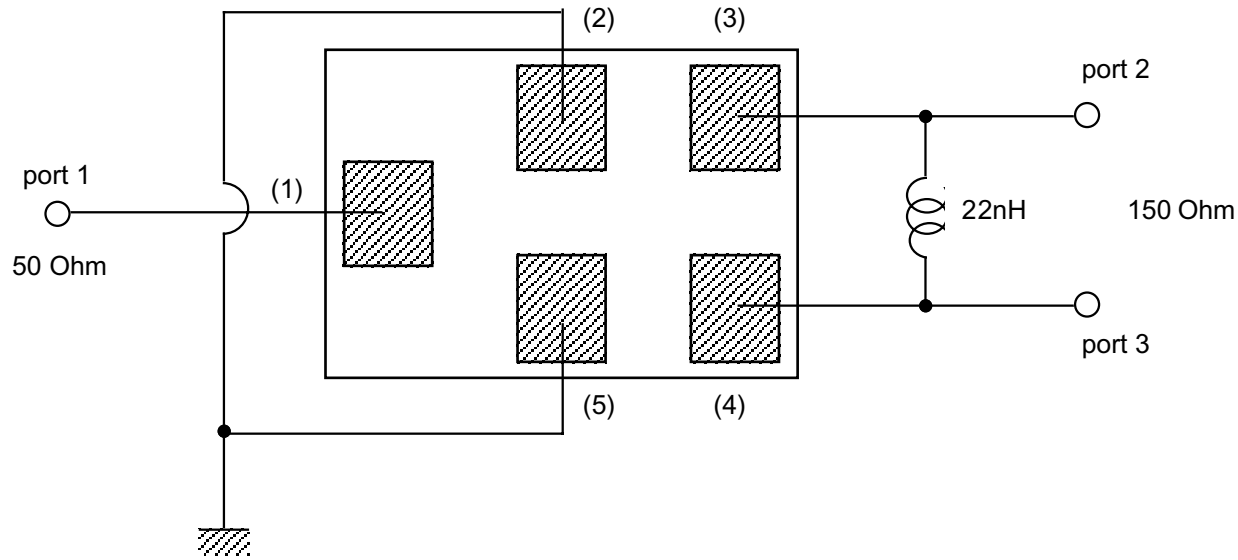

Input impedance : 50 Ohm ( Single ended )  
 Output impedance : 150 Ohm ( Differential )

UNLESS OTHERWISE SPECIFIED		
BASIC DIMENSIONS		TOLERANCE
UP TO	INCL	
TO	INCL	
TO	INCL	
TO	INCL	
ABOVE		

--	--	--

ISSUE	REVISIONS		DATE
MATERIAL	FINISH	SCALE	
DESIGN			
DRAW			
CHECK			
APPROVAL			
DRAWING NO.			

NAME	TYPE NO.
SAW Filter	

**CERAMIC BUSINESS UNIT, LCR DEVICE COMPANY  
 MATSUSHITA ELECTRONIC COMPONENTS CO.,LTD.  
 KADOMA, OSAKA, JAPAN**

Fig. 2





单击下面可查看定价，库存，交付和生命周期等信息

[>>Panasonic\(松下\)](#)