

Approved	Checked	Designed	DEVELOPMENT SPECIFICATION				
		<i>X. Gama</i>		P/N: LN J 2 0 6 R 5 R U X			

T Y P E	Red Light Emitting Diode					
A P P L I C A T I O N	Indicators					
M A T E R I A L	GaP					
O U T L I N E	Attached					
A B S O L U T E M A X I M U M R A T I N G S	P	※ I _{FP}	I _{FDK}	V _R	Topr	Tstg
	60	60	20	4	-25~+85	-30~+100
	mW	mA	mA	V	°C	°C
C O N D I T I O N	T _a = 25 ± 3 °C					

T e s t S p e c i f i c a t i o n

I t e m	Symbol	C o n d i t i o n	Typ	Limit		Unit
				Min	Max	
Forward Voltage	V _F	I _F = 10 mA	2.03		2.6	V
Reverse Leakage Current	I _R	V _R = 4 V			10	μA
Luminous Intensity	I _O	I _F = 10 mA · DC	0.4	0.15		mcd
Peak Emission Wavelength	λ _p	I _F = 10 mA · DC	700			nm
Spectral Line Half Width	Δλ	I _F = 10 mA · DC	100			nm

- ※ · The Condition of I_{FP} is duty 10 %, Pulse width 1 ms
- Please contact the Panasonic local office if you design at low current (below 1 mA DC) or pulse current operation and have any questions.

NOTE

1. Compositions of the lead ... Cu/Ni/Au plating
2. Soldering conditions.
Refer to Handling note.
3. Care should be taken that soldering is done within 3-days after opening the dry package and reel.
4. Package: Light red diffusion type.
5. Circuit to operate LED.

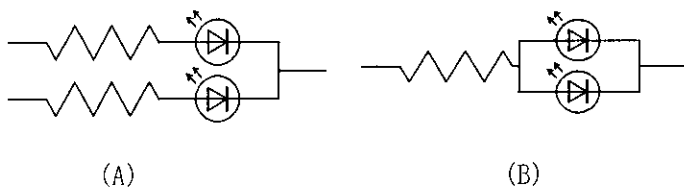

- (A) Recommended circuit.
- (B) The difference of brightness between the LED could be found due to the V_F characteristics of each LED.

Oct. 27. 2001			

Approved Checked Designed

DEVELOPMENT SPECIFICATION

X. Ozawa

P/N:LNJ206R5RUX

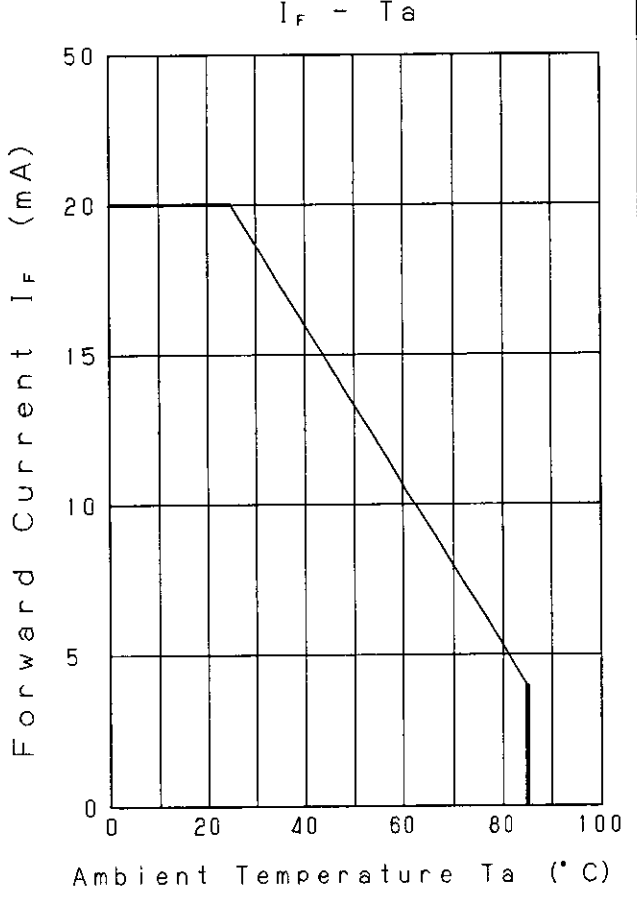
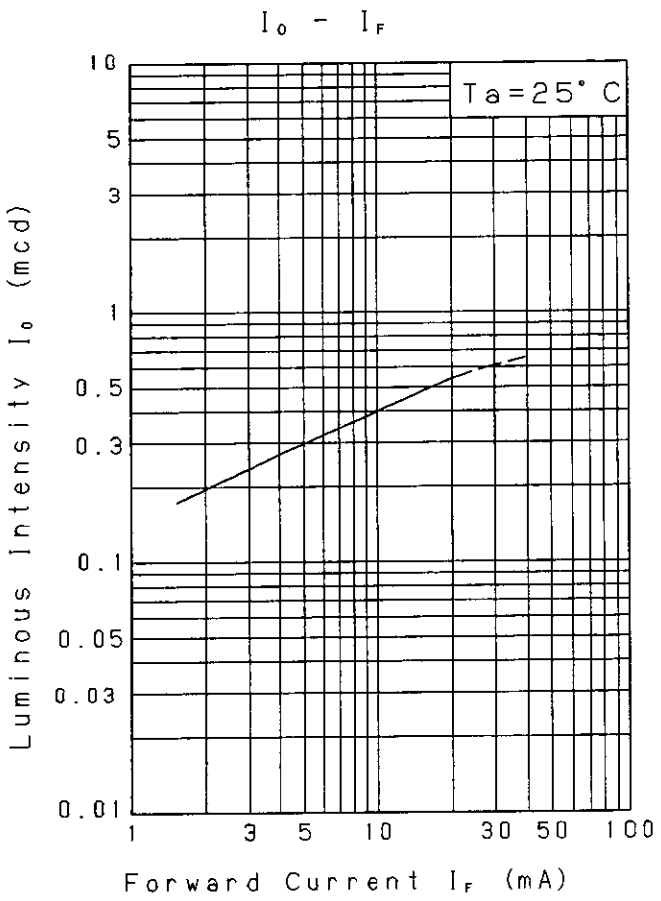
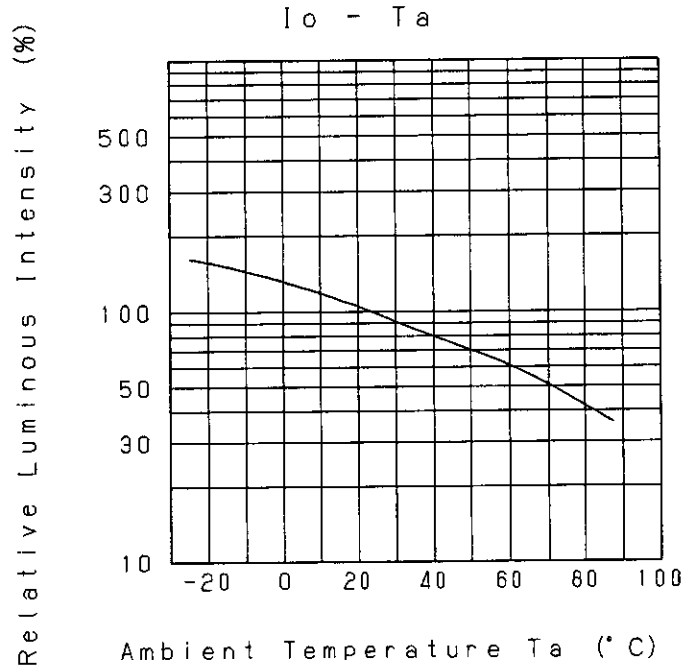
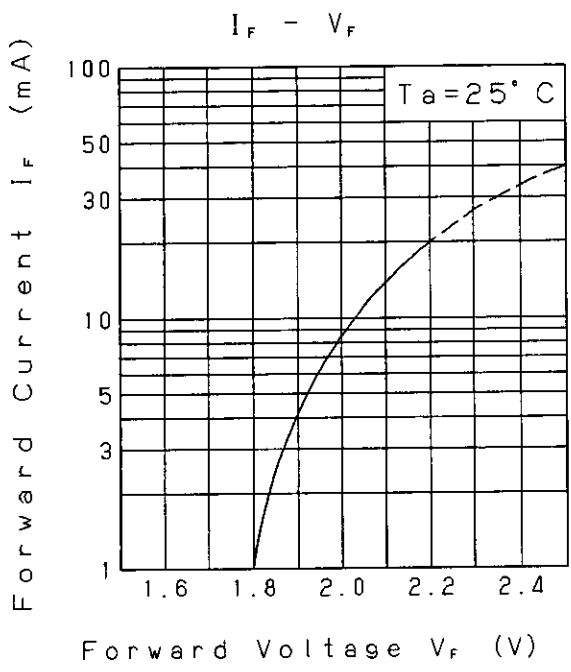

Oct. 27. 2001

Panasonic

KAGOSHIMA MATSUSHITA ELECTRONICS CO., LTD.

KB-H-022-018B

Approved	Checked	Designed	DEVELOPMENT SPECIFICATION			
		<i>K. Oshino</i>	P/N: LN J206R5RUX			

Relative Luminous Intensity
Wavelength Characteristics

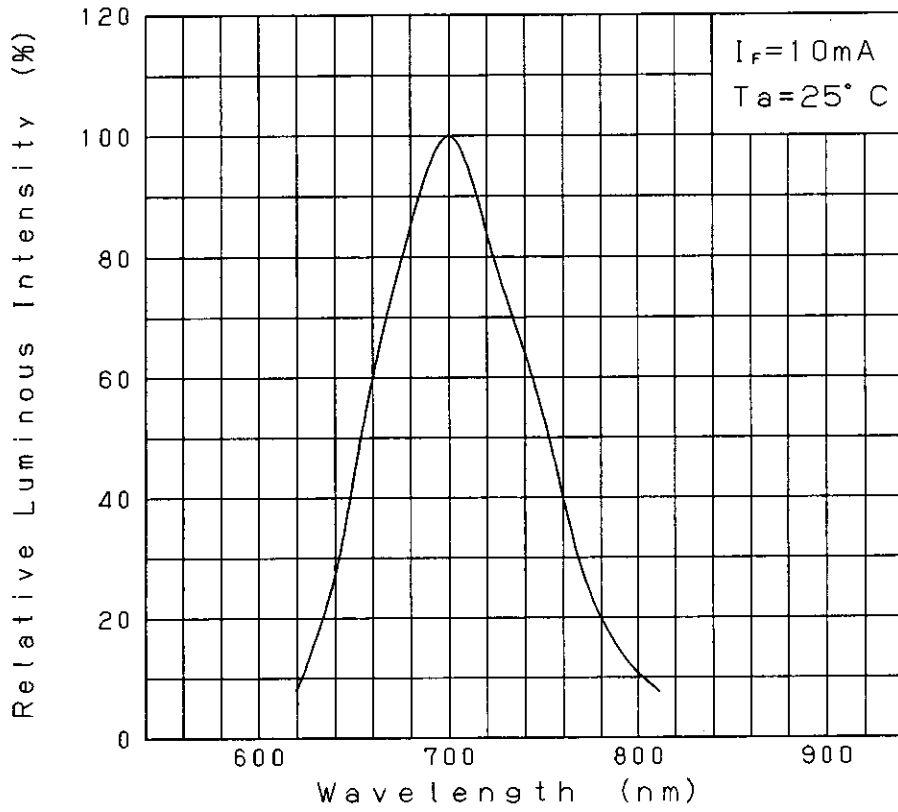

Directivity Characteristics

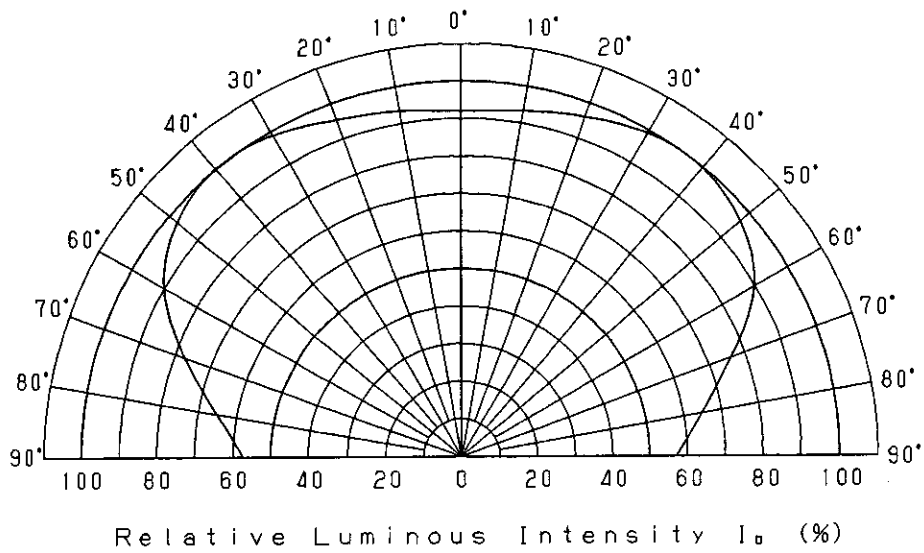

Oct. 27. 2001			

Approved	Checked	Designed
<i>M. Yamashita</i>	<i>T. Shoda</i>	<i>T. Tabata</i>

DEVELOPMENT SPECIFICATION
(OUTLINE)

P/N :

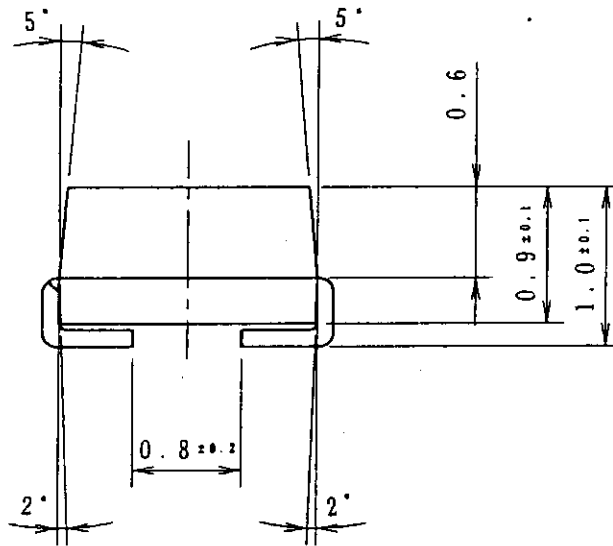
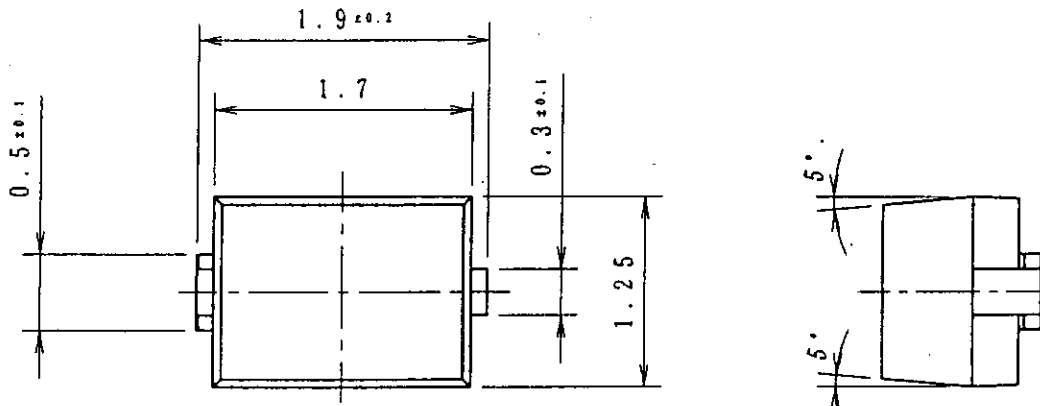

(NOTE)

1. Unit:mm
2. Tolerance unless specified is ± 0.2 .
3. Measurement of the package doesn't include gate projection.
4. Corner of the package is R 0.2max.
5. Projection's tolerance of the package is 0.2max.

Nov. 27. 1996

单击下面可查看定价，库存，交付和生命周期等信息

[>>Panasonic\(松下\)](#)