

Approved	Checked	Designed	DEVELOPMENT SPECIFICATION			17	4
<i>M. Yamashita</i>	<i>K. Kishimoto</i>	<i>T. Takata</i>					

T Y P E	Green Light Emitting Diode					
APPLICATION	Indicators					
MATERIAL	GaP					
OUTLINE	Attached					
ABSOLUTE MAXIMUM RATINGS	P 60 mW	※IFP 60 mA	IFDC 20 mA	VR 4 V	Topr -25~+85 °C	Tstg -30~+100 °C
CONDITION	Ta=25±3 °C					

Test Specification

Item	Symbol	Condition	Typ	Limit		Unit
				Min	Max	
Forward Voltage	VF	IF=10 mA	2.03		2.6	V
Reverse Leakage Current	IR	VR= 4 V			10	μA
Luminous Intensity	IO	IF=10 mA · DC	5.0	3.0		mcd
Peak Emission Wavelength	λp	IF=10 mA · DC	565			nm
Spectral Line Half Width	Δλ	IF=10 mA · DC	30			nm

※ · The Condition of IFP is duty 10 % , Pulse width 1 ms  
· Please contact the Panasonic local office if you design at low current (below 1.0 mA DC) or pulse current operation and have any questions.

NOTE

- ★1 Soldering conditions.  
Refer to handling note.
- ★2 Care should be taken that soldering is done within 3-days after opening the dry package and reel.
- ★3 Package:Light green diffusion type.
- ★4 From 6 rank up (Measurement condition ; IF=10 mA)

Rank	Specification	Unit
6	3.00~ 7.60	mcd
7	4.55~11.40	mcd

Nov. 6.1995			

Approved <i>V. V. V.</i>	Checked <i>K. K.</i>	Designed <i>T. T.</i>
-----------------------------	-------------------------	--------------------------

DEVELOPMENT SPECIFICATION

P/N: LNJ306G5TUWQ

17

5

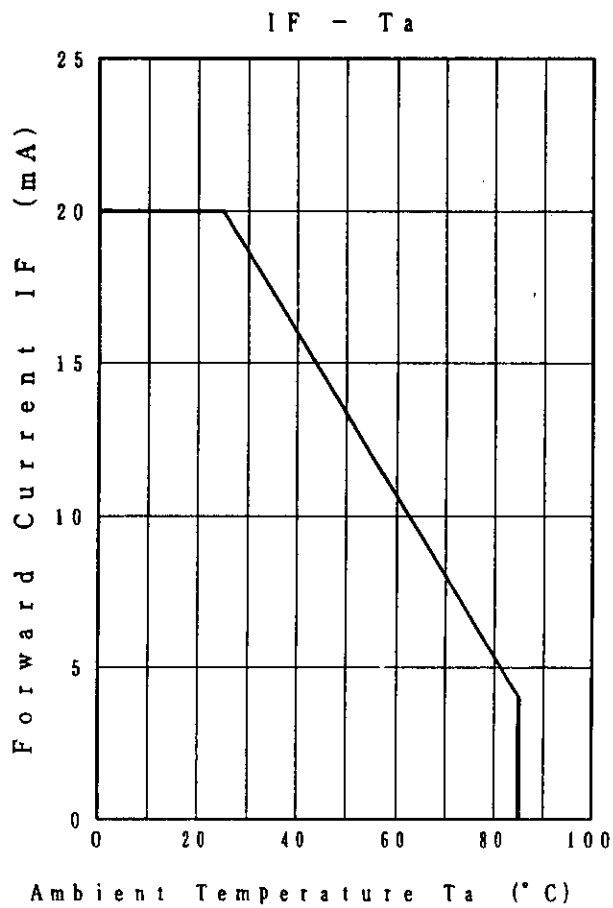
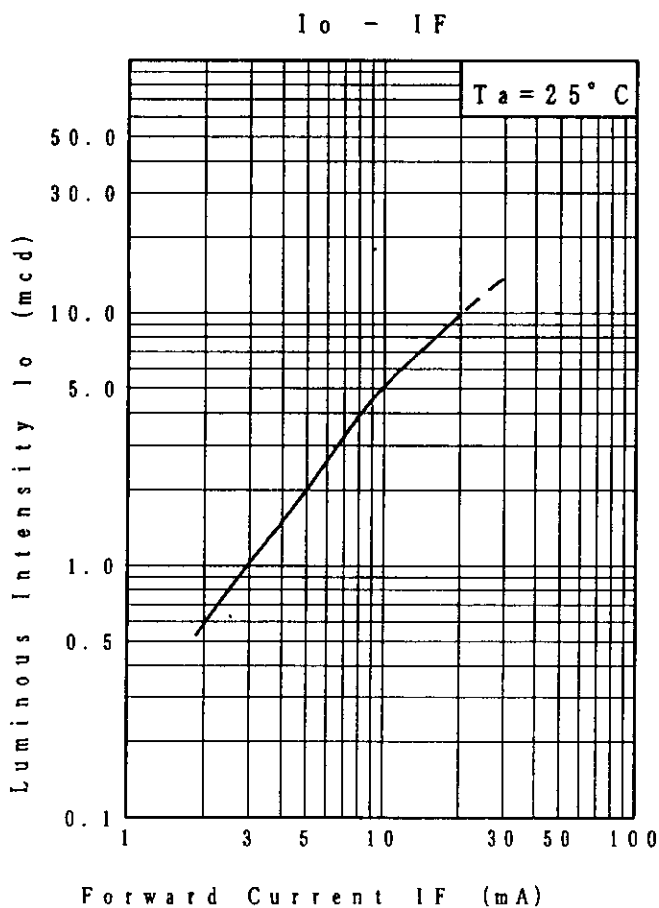
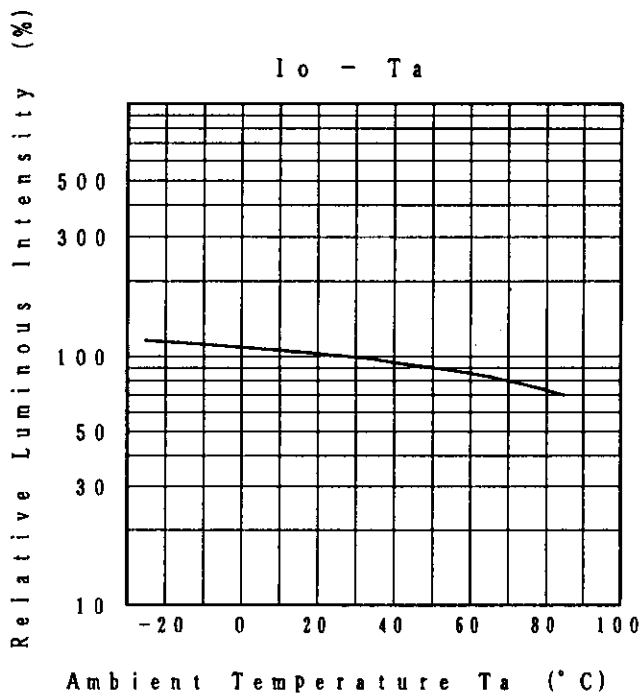
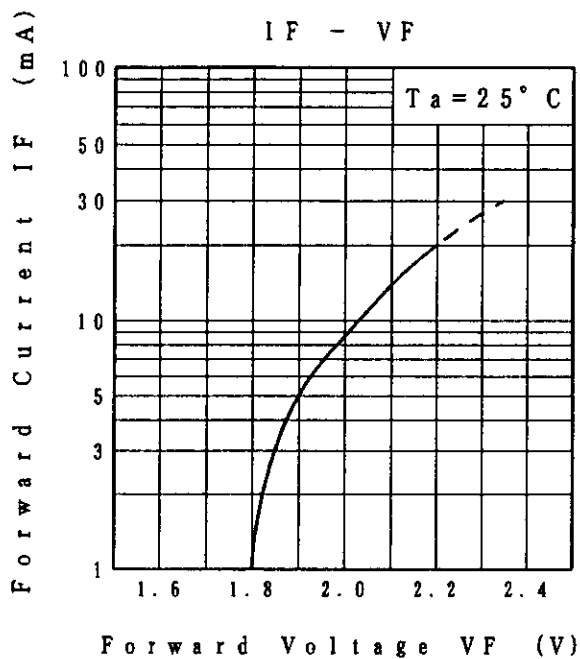

Nov. 6. 1995

Approved    Checked    Designed

*[Handwritten signatures]*

DEVELOPMENT SPECIFICATION

P/N: LNJ306G5TUWQ

17

6

Relative Luminous Intensity Wavelength Characteristics

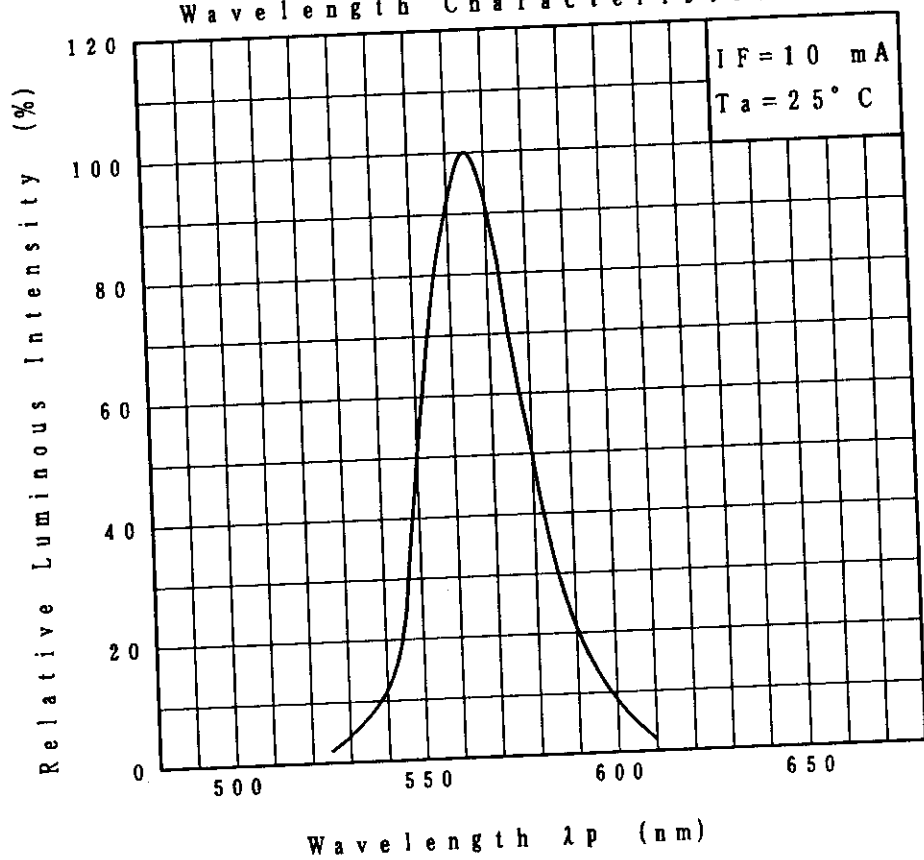

Directive Characteristics

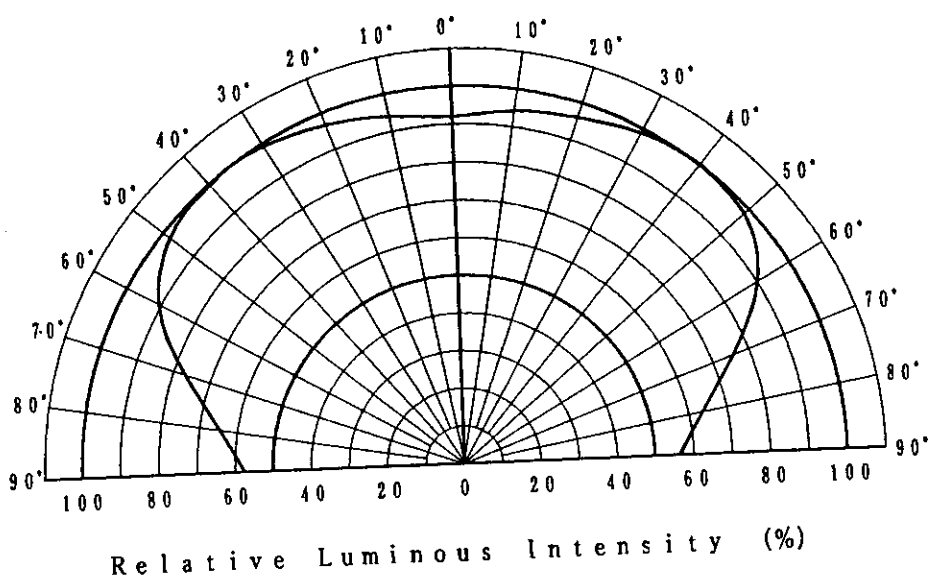

Nov. 6. 1995

KACOSHIMA MATSUSHITA ELECTRONICS CO., LTD

KR-H-022-0100

Approved <i>[Signature]</i>	Checked <i>[Signature]</i>	Designed <i>[Signature]</i>
--------------------------------	-------------------------------	--------------------------------

DEVELOPMENT SPECIFICATION

(OUTLINE)

P/N: LNJ306G5TUWQ

17

7

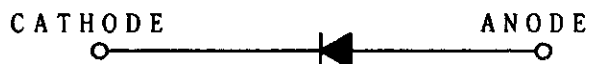
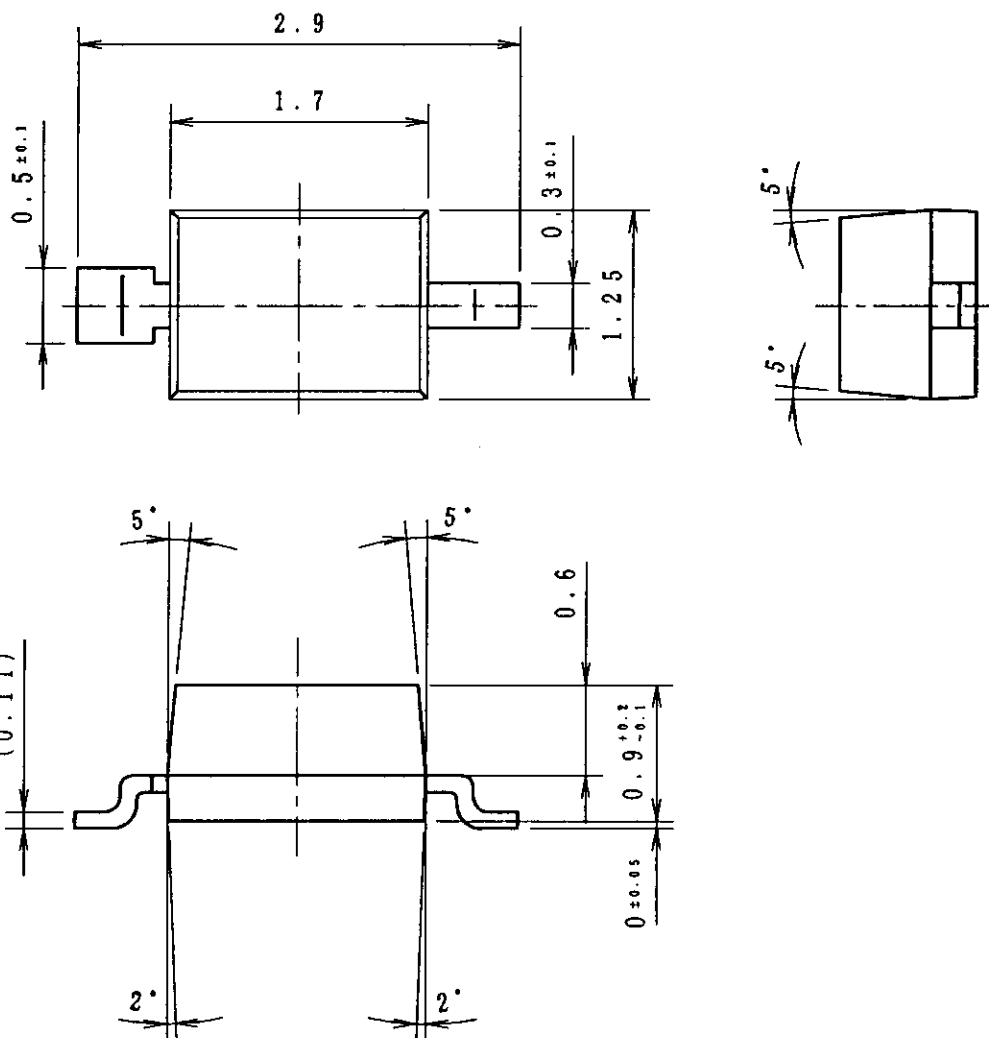

(NOTE)

1. Unit: mm
2. Tolerance unless specified is ±0.2.
3. Measurement of the package doesn't include gate projection.
4. Corner of the package is R 0.2max.
5. Projection's tolerance of the package is 0.2max.

Nov. 6. 1995

单击下面可查看定价，库存，交付和生命周期等信息

[>>Panasonic\(松下\)](#)