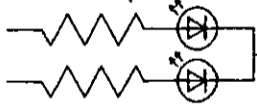
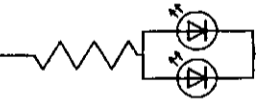

Approved	Checked	Designed	DEVELOPMENT SPECIFICATION					
	<i>H. H.</i>	<i>T. Taketa</i>	P/N: LNJ316C83RU				TEMPORARY	
T Y P E			Green Light Emitting Diode					
APPLICATION			Indicators					
MATERIAL			InGaAlP					
OUTLINE			Attached					
ABSOLUTE MAXIMUM RATINGS			P	$\#1 I_{FP}$	I_{FDC}	V_R	T_{opr}	T_{stg}
			55	60	20	4	-30~+85	-40~+100
			mW	mA	mA	V	°C	°C
CONDITION			$T_a = 25 \pm 3^\circ C$					
Test Specification								
I t e m	Symbol	C o n d i t i o n	Typ	Limit		Unit		
				Min	Max			
Forward Voltage	V_F	$I_F = 10 \text{ mA}$	2.03		2.5	V		
Reverse Leakage Current	I_R	$V_R = 4 \text{ V}$			10	μA		
Luminous Intensity $\#2$	I_O	$I_F = 10 \text{ mA DC}$	22	11		mcd		
Peak Emission Wavelength	λ_p	$I_F = 10 \text{ mA DC}$	575			nm		
Spectral Line Half Width	$\Delta \lambda$	$I_F = 10 \text{ mA DC}$	15			nm		
<p>$\#1$. The Condition of I_{FP} is duty 10 % . Pulse width 1 ms</p> <p>$\#2$. Tolerance of luminous intensity: $\pm 20\%$.</p> <p>NOTE</p> <p>★1. Please contact the Panasonic local office if you design at low current (below 1mA DC) or pulse current operation and have any questions.</p> <p>★2. Soldering conditions.....Refer to Handling note.</p> <p>★3. Compositions of the lead Cu/Ni/Au plating</p> <p>★4. Package...Clear type.</p> <p>★4. Beware of destruction by static electricity in handling the LED.</p> <p>★5. Circuit to operate LED.</p>								
					(A) Recommended circuit.			
					(B) The difference of brightness between the LED could be found due to the V_f characteristics of each LED.			
Mar. 26. 2001								

Panasonic

KAGOSHIMA MATSUSHITA ELECTRONICS CO., LTD

KB-H-022-018B

Approved	Checked	Designed	DEVELOPMENT SPECIFICATION	TEMPORARY
	<i>M. W.</i>	<i>T. Takata</i>		

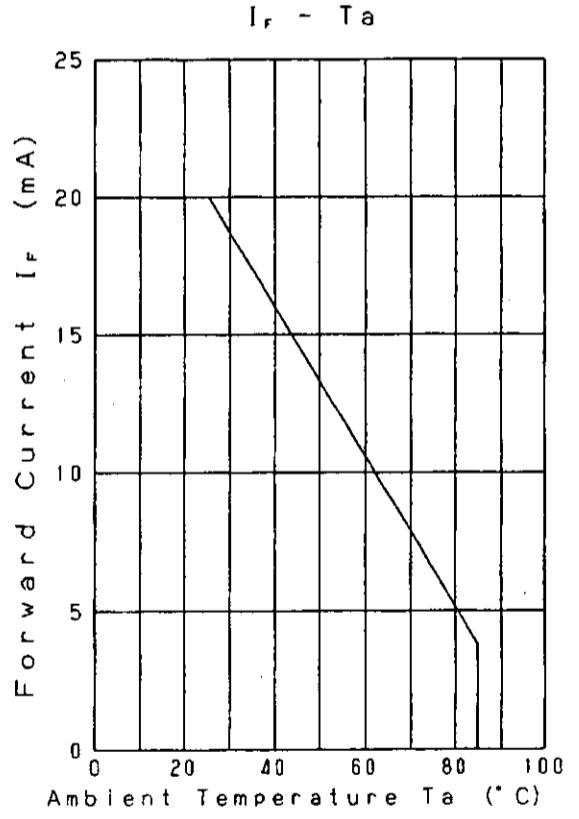
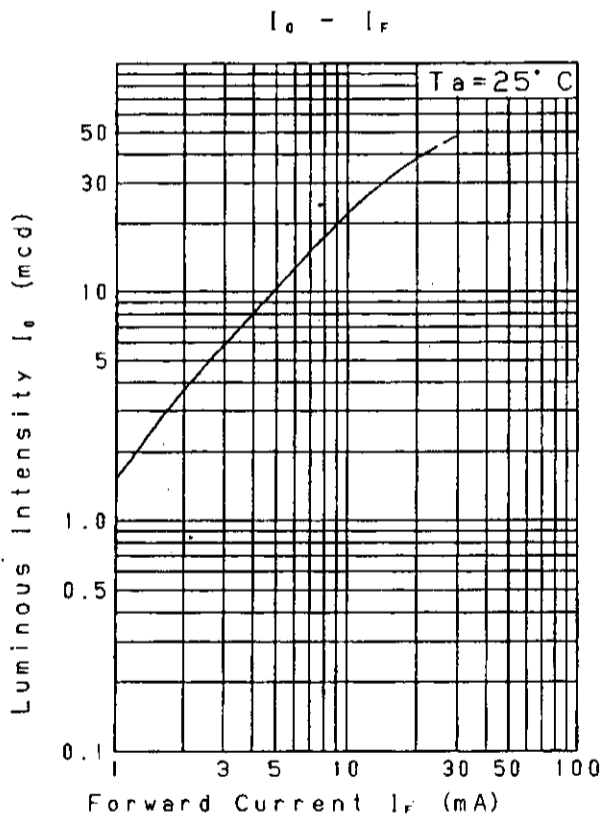
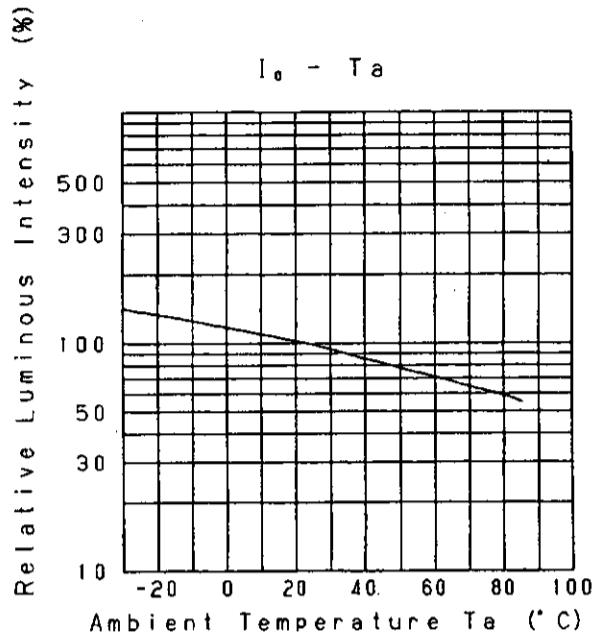
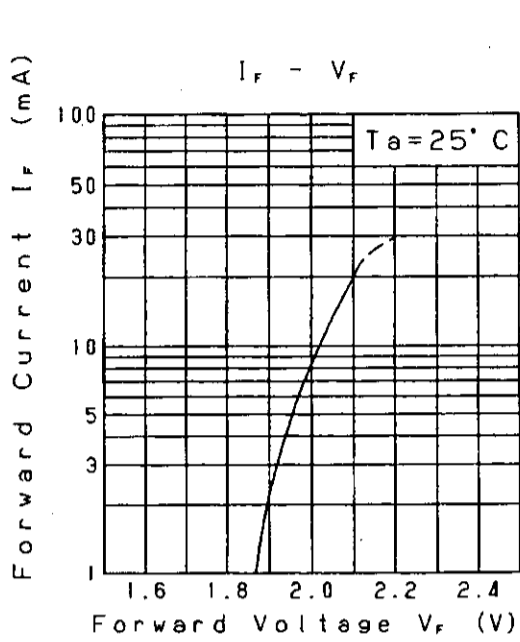

Mar. 26, 2001			
---------------	--	--	--

Product: KAGOSHIMA MATSUYITA ELECTRONIC CO., LTD. 4044 000 0100

Approved	Checked	Designed
	<i>M. Hi</i>	<i>T. Takata</i>

DEVELOPMENT SPECIFICATION

P/N: LNJ316C83RU

TEMPORARY

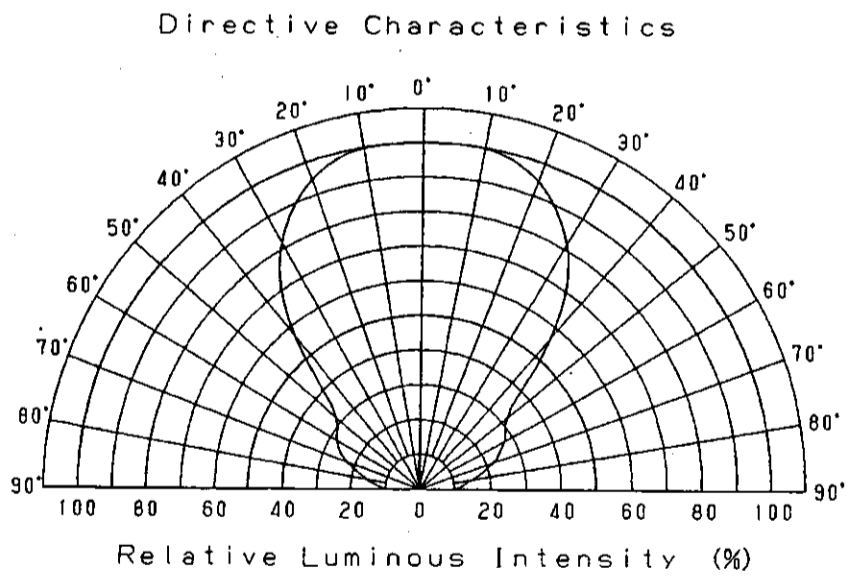
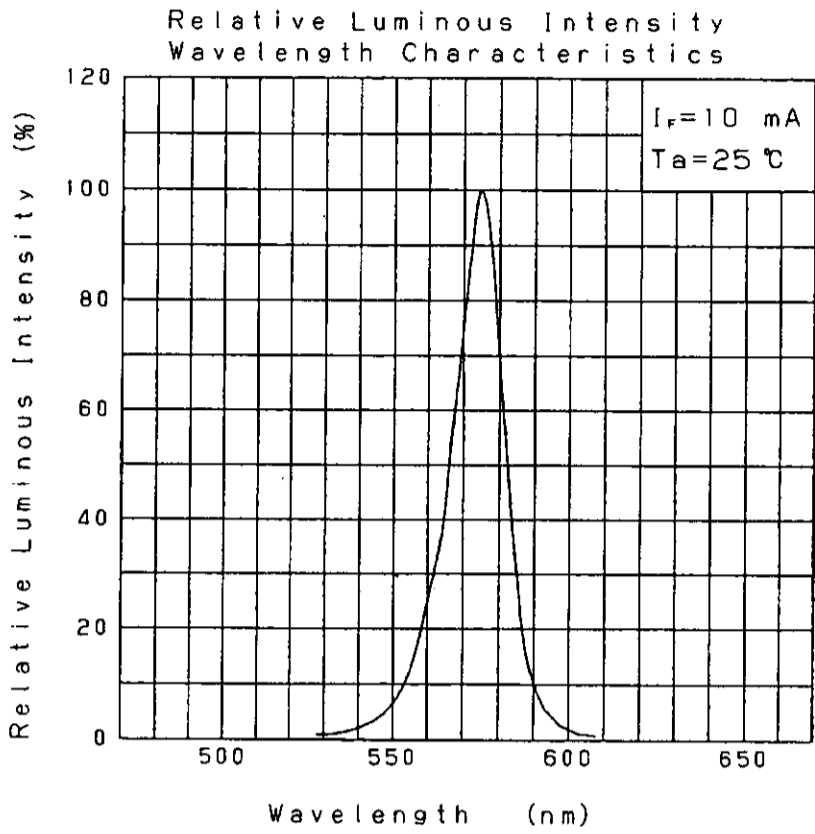

Mar. 26. 2001		

Panasonic

KAGOSHIMA MATSUSHITA ELECTRONICS CO., LTD.

KB11-022-016B

Approved	Checked	Designed	DEVELOPMENT SPECIFICATION (OUTLINE) P/N: LNJ316C83RU	TEMPORARY
	<i>M. W.</i>	<i>T. Tabata</i>		

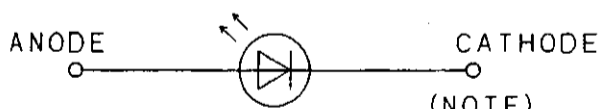
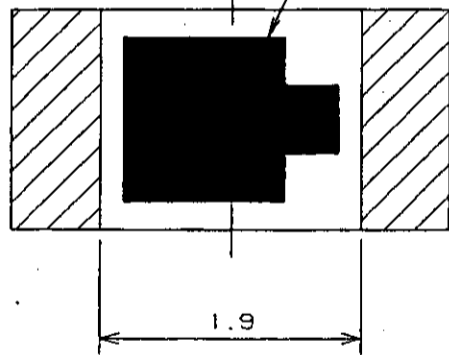
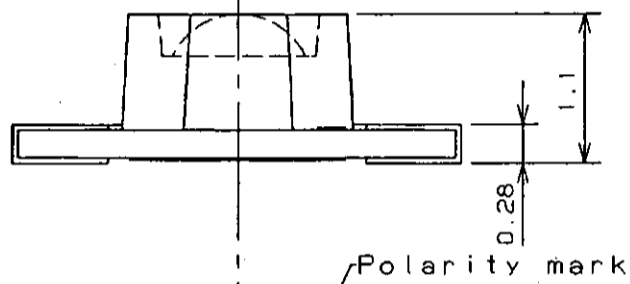
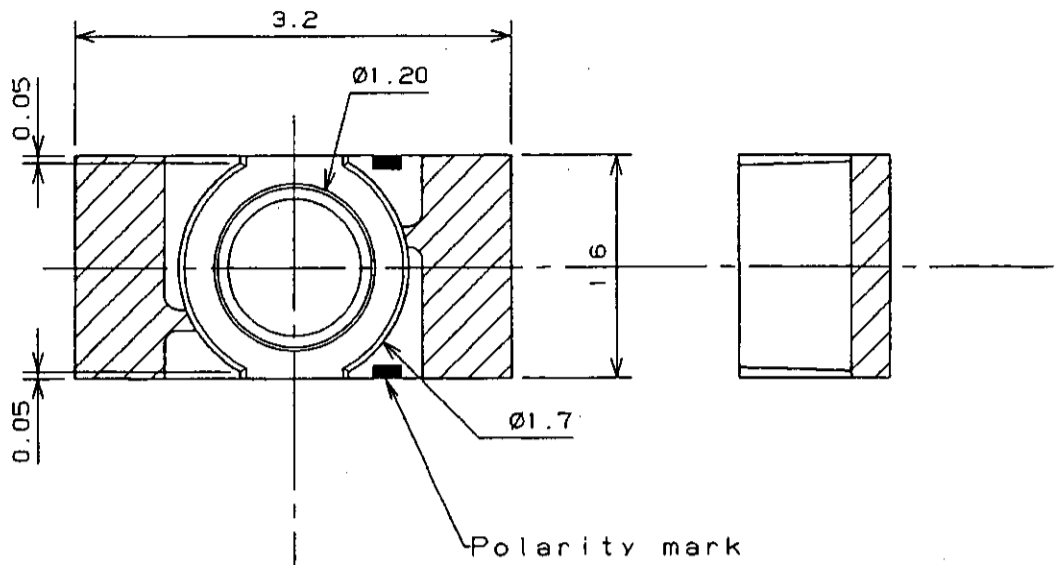

(NOTE)

1. Unit: mm

2. Tolerance unless specified is ± 0.15 .

3. indicate Au terminal.

Mar. 26. 2001			
---------------	--	--	--

Panasonic

KAGOSHIMA MATSUSHITA ELECTRONICS CO. LTD

KR-H-022-01AR

单击下面可查看定价，库存，交付和生命周期等信息

[>>Panasonic\(松下\)](#)