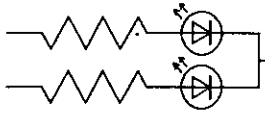
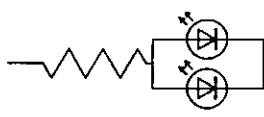

Approved	Checked	Designed	DEVELOPMENT SPECIFICATION							
		<i>T. Tabata</i>	P/N: LNJ816C88RA				TEMPORARY			
T Y P E			Orange Light Emitting Diode							
A P P L I C A T I O N			Indications							
M A T E R I A L			InGaAlP							
O U T L I N E			Attached							
A B S O L U T E M A X I M U M R A T I N G S			P	#1 I <sub>FP</sub>	I <sub>FDC</sub>	V <sub>R</sub>	Topr	Tstg		
			55	60	20	4	-30~+85	-40~+100		
			mW	mA	mA	V	°C	°C		
C O N D I T I O N			Ta=25±3°C							
Test Specification										
I t e m	Symbol	C o n d i t i o n	Typ	Limit		Unit				
				Min	Max					
Forward Voltage	V <sub>F</sub>	I <sub>F</sub> =10mA	1.9		2.5	V				
Reverse Leakage Current	I <sub>R</sub>	V <sub>R</sub> = 3V			100	μA				
Luminous Intensity #2	I <sub>O</sub>	I <sub>F</sub> =10mA DC	9.8	5.2		mcd				
Peak Emission Wavelength	λ <sub>p</sub>	I <sub>F</sub> =10mA DC	620			nm				
Spectral Line Half Width	Δλ	I <sub>F</sub> =10mA DC	17			nm				
#1. The Condition of I <sub>FP</sub> is duty 10%, Pulse width 1 ms #2. Tolerance of luminous intensity: ±20%.										
<b>NOTE</b> ★1. Please contact the Panasonic local office if you design at low current (below 1mA DC) or pulse current operation and have any questions. ★2. Soldering conditions...Refer to Handling note. ★3. Compositions of the lead... Cu/Ni/Au plating ★4. Beware of destruction by static electricity in handling the LED. ★5. Circuit to operate LED.										
									(A) Recommended circuit. (B) The difference of brightness between the LED could be found due to the V <sub>F</sub> characteristics of each LED.	
Oct. 18. 2001										

Approved	Checked	Designed
		T. Takata

DEVELOPMENT SPECIFICATION

P/N: LNJ816C88RA

TEMPORARY

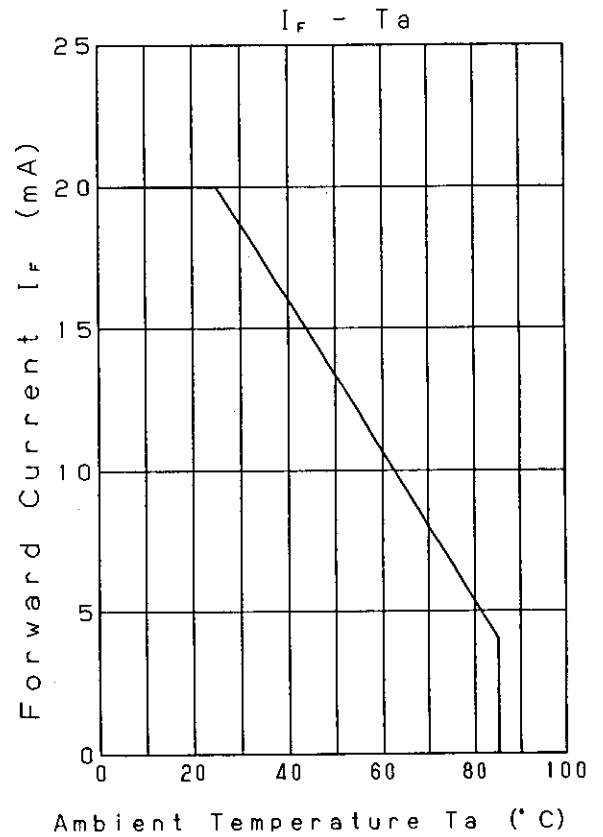
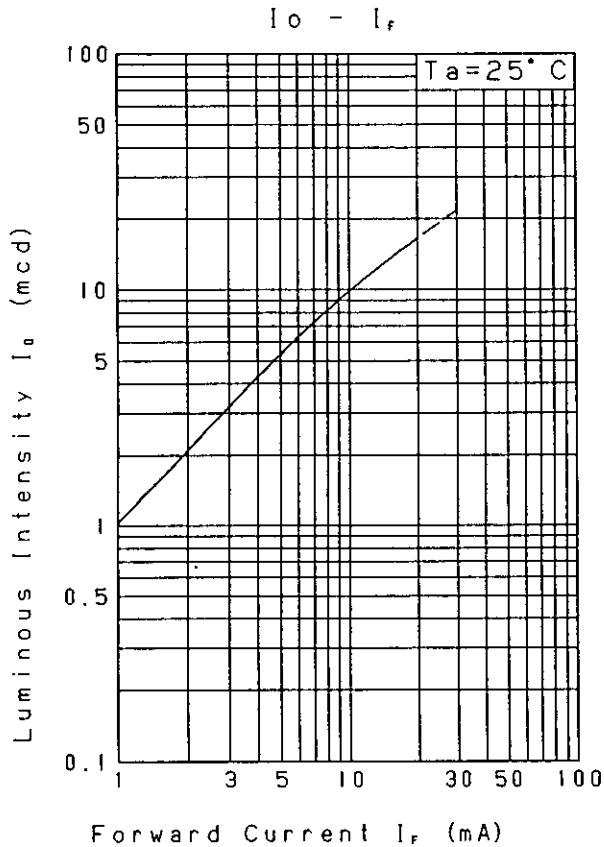
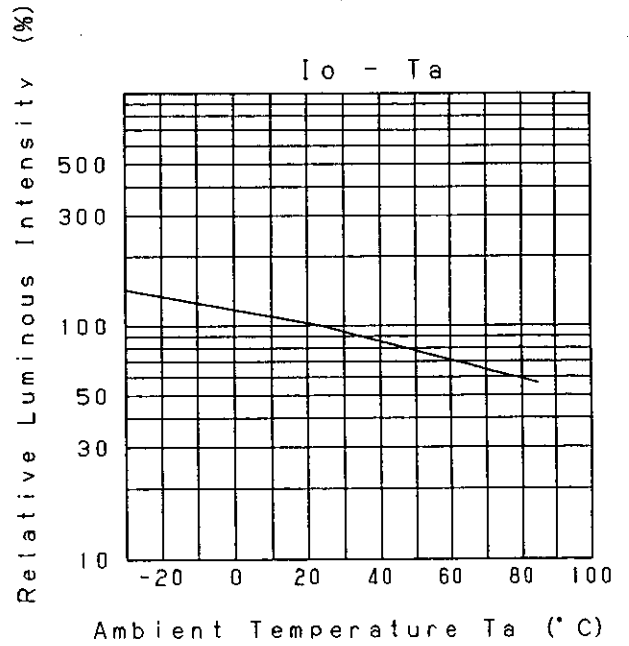
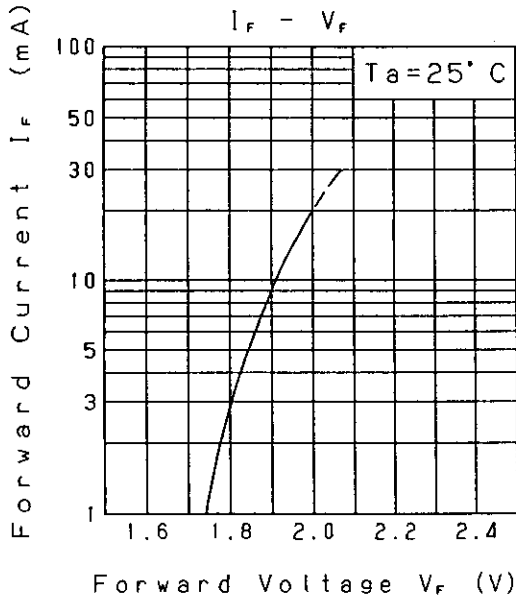

Nov. 7. 2001

Approved	Checked	Designed	DEVELOPMENT SPECIFICATION	TEMPORARY
		T. Tabata		

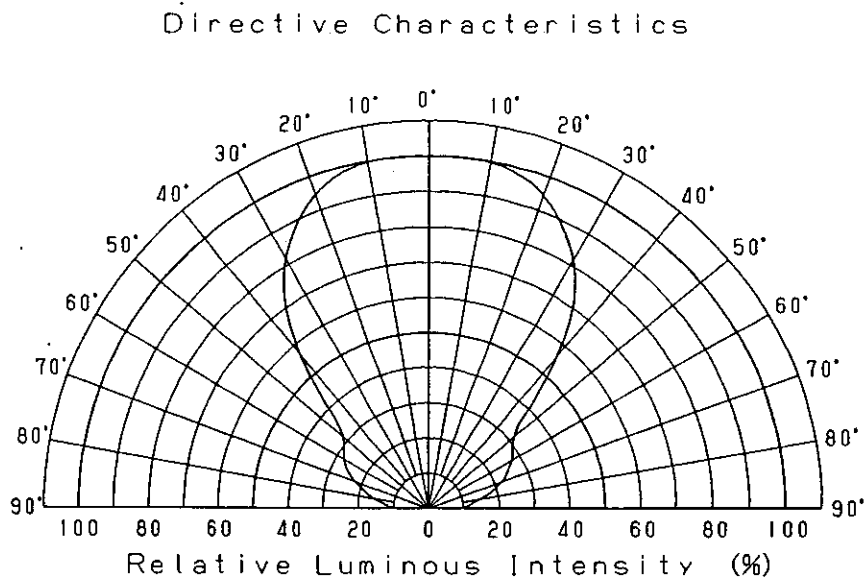
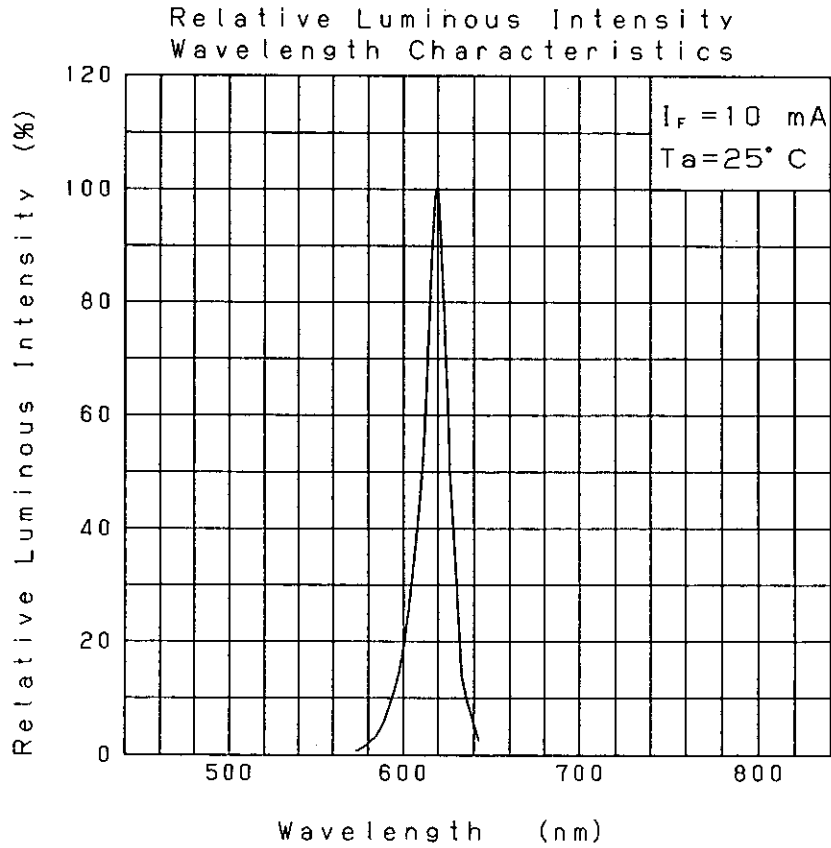

Nov. 7. 2001			
--------------	--	--	--

Approved <i>T. Akeda</i>	Checked <i>M. Ni</i>	Designed <i>T. Taketa</i>	DEVELOPMENT SPECIFICATION (OUTLINE) P/N:	

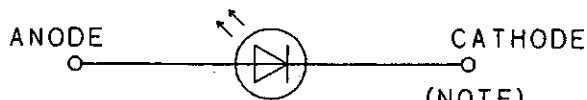
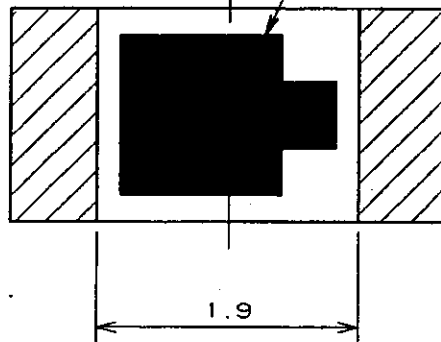
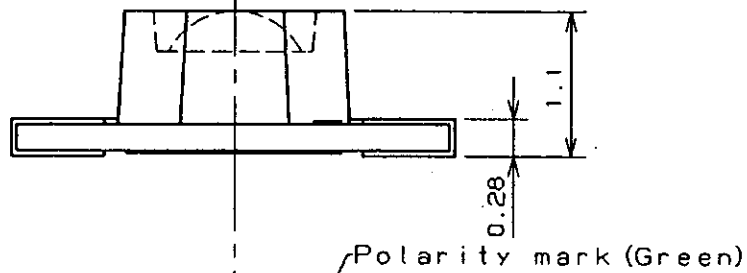
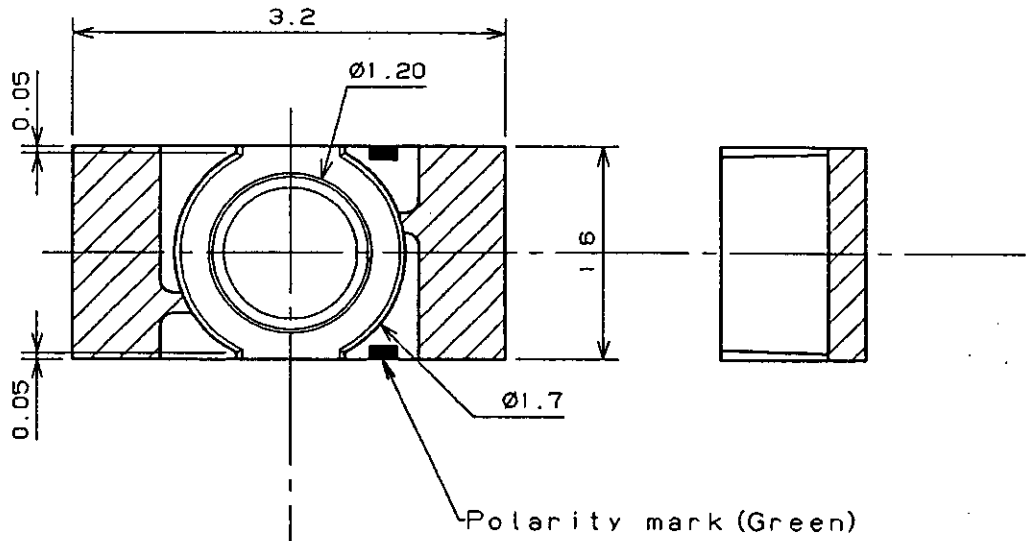

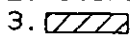
- (NOTE)  
 1. Unit: mm  
 2. Tolerance unless specified is  $\pm 0.15$ .  
 3.  indicate Au terminal.

Jan. 31. 2000			
---------------	--	--	--

单击下面可查看定价，库存，交付和生命周期等信息

[>>Panasonic\(松下\)](#)