

## Connector assembly frame - HC-CIF-B24-HFFD-WH-AL - 1404213

Please be informed that the data shown in this PDF Document is generated from our Online Catalog. Please find the complete data in the user's documentation. Our General Terms of Use for Downloads are valid (<http://download.phoenixcontact.com>)



HEAVYCON plug assembly frame, upper part for double locking latch, for HC-CIF...BFWD.. lower parts with double locking latch or for HC-CIF...BFFD.. lower parts, for type B24 contact inserts, with M4 screws with 3 mm Allen screw head

### Product Features

- ✓ Sturdy metal version
- ✓ Open base, pre-assembled cable harnesses can be used
- ✓ Standardized design; both PE sheets for inserts are connected conductively
- ✓ Safe capacitive PE even when connected slightly askew



### Key commercial data

Packing unit	1 1
Custom tariff number	85389099
Country of origin	Germany

### Technical data

#### Dimensions

Length	150.2 mm
--------	----------

#### Ambient conditions

Ambient temperature (operation)	-40 °C ... 125 °C
---------------------------------	-------------------

#### General

Design	For B24
Material	Cast aluminum, uncoated
Connection	For screw locking: M4, 3 mm Allen screw, 2 Nm tightening torque

## Connector assembly frame - HC-CIF-B24-HFFD-WH-AL - 1404213

### Classifications

#### eCl@ss

eCl@ss 4.0	27140816
eCl@ss 4.1	27140816
eCl@ss 5.0	27143424
eCl@ss 5.1	27143424
eCl@ss 6.0	27143424
eCl@ss 7.0	27440209
eCl@ss 8.0	27440209

#### ETIM

ETIM 3.0	EC002310
ETIM 4.0	EC002310
ETIM 5.0	EC002310

#### UNSPSC

UNSPSC 6.01	43172601
UNSPSC 7.0901	39121416
UNSPSC 11	43172601
UNSPSC 12.01	39121408
UNSPSC 13.2	39121408

### Accessories

#### Accessories

#### Device marking

Plastic label - US-EMLP (20X9) SR - 0828884



Plastic label, Card, silver, Unlabeled, Can be labeled with: THERMOMARK CARD PLUS, THERMOMARK CARD,  
Mounting type: Adhesive, Lettering field: 20 x 9 mm

### Drawings

## Connector assembly frame - HC-CIF-B24-HFFD-WH-AL - 1404213

Dimensioned drawing

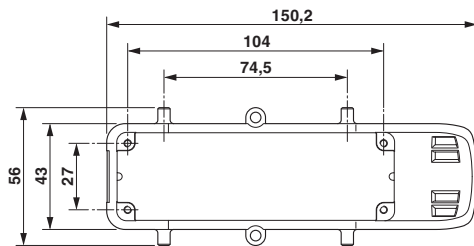

Dimensional drawing top view

Dimensioned drawing

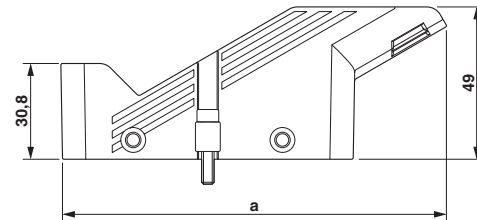

Dimensional drawing, a = 150.2 mm

单击下面可查看定价，库存，交付和生命周期等信息

[>>Phoenix Contact\(菲尼克斯\)](#)