

Bus system flat-type plug - SACC-EC-FSD-4CON-M16/0,5 SCO - 1535215

Please be informed that the data shown in this PDF Document is generated from our Online Catalog. Please find the complete data in the user's documentation. Our General Terms of Use for Downloads are valid (<http://download.phoenixcontact.com>)



Bus system flush-type socket, PROFINET, 4-pos., M12-SPEEDCON, D-coded, front/screw mounting with M16 thread, can be positioned, with 0.5 m TPE litz wire, 4 x 0.34 mm²



Key commercial data

Packing unit	1 PCE
Catalog page	Page 29 (PC-2011)
GTIN	 4 046356 026963
Custom tariff number	85444290
Country of origin	GERMANY

Technical data

Mechanical characteristics

Standard - Electrical safety	M12 plug-in connector IEC 61076-2-101
Number of positions	4
Shielded	No
Connection method	Individual wires
Length of cable	0.5 m
Ambient temperature (operation)	-25 °C ... 85 °C (Plug / socket)
Ambient temperature (operation)	-25 °C ... 90 °C (cable, fixed installation)
Ambient temperature (operation)	(cable, flexible installation)

Material data

Inflammability class according to UL 94	V0
Contact carrier material	PA 66
Contact material	CuZn

Bus system flat-type plug - SACC-EC-FSD-4CON-M16/0,5 SCO - 1535215

Technical data

Material data

Contact surface material	Ni/Au
Cable gland material	Zinc die-cast, nickel-plated
Sealing material	NBR
Degree of protection	IP67

Electrical characteristics

Number of positions	4
Nominal voltage U_N	250 V
Nominal current I_N	4 A
Surge voltage category	II
Pollution degree	3

Classifications

ETIM

ETIM 2.0	EC001297
ETIM 3.0	EC002061
ETIM 4.0	EC002061
ETIM 5.0	EC002061

UNSPSC

UNSPSC 11	31251501
UNSPSC 12.01	31251501
UNSPSC 13.2	31251501
UNSPSC 6.01	31251501
UNSPSC 7.0901	31251501

eCl@ss

eCl@ss 4.0	27140815
eCl@ss 4.1	27140815
eCl@ss 5.0	27143423
eCl@ss 5.1	27143423
eCl@ss 6.0	27143423
eCl@ss 7.0	27449001

Approvals

Approvals

Bus system flat-type plug - SACC-EC-FSD-4CON-M16/0,5 SCO - 1535215

Approvals

Approvals

UL Recognized / GOST

Ex Approvals

Approvals submitted

Approval details

UL Recognized	
mm ² /AWG/kcmil	26-20
Nominal current I _N	4 A
Nominal voltage U _N	250 V

GOST	
------	--

Drawings

Dimensioned drawing

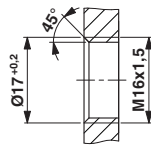

Housing cutout for M16 fastening thread, mounting panel with thread

Schematic diagram

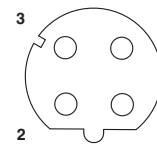

Pin assignment M12 socket, 4-pos., D-coded, female side

Bus system flat-type plug - SACC-EC-FSD-4CON-M16/0,5 SCO - 1535215

Dimensioned drawing

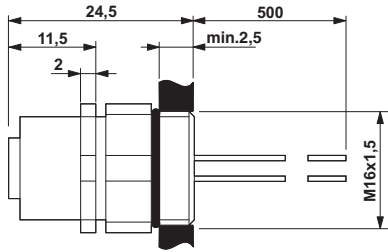

Circuit diagram

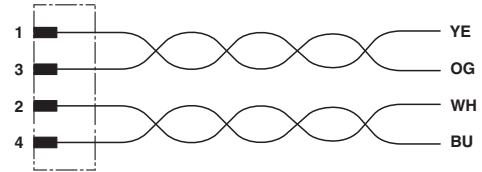

M12 flush-type socket, can be positioned

Contact assignment of the M12 socket

单击下面可查看定价，库存，交付和生命周期等信息

[>>Phoenix Contact\(菲尼克斯\)](#)