

Housing - HC-B 16-KMQ-H-O1M32 - 1460181

Please be informed that the data shown in this PDF Document is generated from our Online Catalog. Please find the complete data in the user's documentation. Our General Terms of Use for Downloads are valid (<http://download.phoenixcontact.com>)



HEAVYCON B16 coupling housing, with double locking latch, height: 82 mm, with 1 x M32 gland, straight cable outlet



Key commercial data

| | |
|----------------------|----------|
| Packing unit | 1 pc |
| Custom tariff number | 85389099 |
| Country of origin | Germany |

Technical data

Dimensions

| | |
|--------|-------|
| Height | 82 mm |
| Width | 43 mm |
| Length | 94 mm |

Ambient conditions

| | |
|---------------------------------|-------------------|
| Ambient temperature (operation) | -40 °C ... 125 °C |
|---------------------------------|-------------------|

General

| | |
|------------------------------|--|
| Note | For contact inserts HC-B16, BB32, D40, DD72, HS6, M, K |
| Design | B16 |
| Housing type | Coupling housings |
| Locking type | With double locking latch |
| No. of cable exits | 1 |
| Cable exit | Straight |
| Screw connection | None |
| Type of the screw connection | 1x M32 |
| Housing material | Aluminum die-cast |
| Housing surface material | Powder-coated, gray |

Housing - HC-B 16-KMQ-H-O1M32 - 1460181

Technical data

General

| | |
|------------------------------|-------------------------------------|
| Seal material | NBR |
| Material lock | Stainless steel, handle: PA |
| Material grip body interlock | PA |
| Assembly instructions | For half and full screw connections |

Classifications

eCl@ss

| | |
|------------|----------|
| eCl@ss 4.0 | 27140816 |
| eCl@ss 4.1 | 27140816 |
| eCl@ss 5.0 | 27143424 |
| eCl@ss 5.1 | 27143424 |
| eCl@ss 6.0 | 27143424 |
| eCl@ss 7.0 | 27440209 |
| eCl@ss 8.0 | 27440209 |

ETIM

| | |
|----------|----------|
| ETIM 3.0 | EC000437 |
| ETIM 4.0 | EC000437 |
| ETIM 5.0 | EC000437 |

UNSPSC

| | |
|---------------|----------|
| UNSPSC 6.01 | 31261502 |
| UNSPSC 7.0901 | 31261502 |
| UNSPSC 11 | 31261502 |
| UNSPSC 12.01 | 31261502 |
| UNSPSC 13.2 | 31261502 |

Drawings

Housing - HC-B 16-KMQ-H-O1M32 - 1460181

Dimensioned drawing

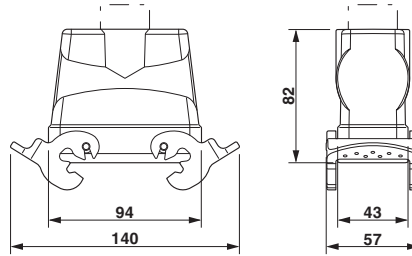

Dimensional drawing

© Phoenix Contact 2013 - all rights reserved
<http://www.phoenixcontact.com>

单击下面可查看定价，库存，交付和生命周期等信息

[>>Phoenix Contact\(菲尼克斯\)](#)