

# Device connector, rear mounting - SACC-DSI-M8FS-4CON-M10-L180 SH - 1456129

Please be informed that the data shown in this PDF Document is generated from our Online Catalog. Please find the complete data in the user's documentation. Our General Terms of Use for Downloads are valid (<http://phoenixcontact.com/download>)



Sensor/actuator flush-type connector, socket, 4-pos. M8, rear/screw mounting with M10 fastening thread, with straight solder connection

## Your advantages

- Easy PCB assembly: one-piece connectors for wave soldering
- Standard pin assignments and codings for signal transmission with a uniform design-in design
- For high transmission reliability: optional shield connection to the housing and latching on the PCB



## Key Commercial Data

|              |               |
|--------------|---------------|
| Packing unit | 20 pc         |
| GTIN         |               |
| GTIN         | 4046356605762 |

## Technical data

### Ambient conditions

|                                 |                  |
|---------------------------------|------------------|
| Ambient temperature (operation) | -25 °C ... 85 °C |
|                                 | -25 °C ... 85 °C |
| Degree of protection            | IP67             |

### General

|                       |  |
|-----------------------|--|
| Note                  | The electrical and mechanical data specified assume that the connector pair is correctly locked and mounted. If the connector is unlocked and if there is a danger of contamination, the connector must be sealed using a protective cap > IP54. Influences arising from litz wires, cables or PCB assembly must also be taken into consideration. |
| Rated current at 40°C | 4 A  |
| Rated voltage         | 48 V AC  |
|                       | 60 V DC  |

# Device connector, rear mounting - SACC-DSI-M8FS-4CON-M10-L180 SH - 1456129

## Technical data

### General

|                             |                                     |
|-----------------------------|-------------------------------------|
| Rated surge voltage         | 1.5 kV                              |
| Number of positions         | 4                                   |
| Insulation resistance       | ≥ 100 MΩ                            |
| Coding                      | A - standard                        |
| Standards/regulations       | M8 connector IEC 61076-2-104        |
| Status display              | No                                  |
| Overvoltage category        | II                                  |
| Degree of pollution         | 3                                   |
| Connection method           | Solder pins                         |
| Insertion/withdrawal cycles | > 100                               |
| Tightening torque           | 1 Nm ... 1.5 Nm (Installation-side) |
| Mounting type               | Rear mounting M10 With flat nut     |
| Thread type                 | M10                                 |

### Material

|  |                              |
|--|------------------------------|
| Flammability rating according to UL 94 | HB                           |
| Contact material                       | Cu alloy                     |
| Contact surface material               | Au                           |
| Contact carrier material               | PA 6.6                       |
| Material, knurls                       | Zinc die-cast, nickel-plated |
| Sealing material                       | NBR                          |
| Additional material specifications     | PU 2K (Grout material)       |

### Cable

|                          |                              |
|--------------------------|------------------------------|
| Standards/specifications | M8 connector IEC 61076-2-104 |
|--------------------------|------------------------------|

### Standards and Regulations

|                          |                              |
|--------------------------|------------------------------|
| Standards/specifications | M8 connector IEC 61076-2-104 |
|--------------------------|------------------------------|

### Environmental Product Compliance

|            |  |
|------------|--|
| REACH SVHC | Lead 7439-92-1   |
| China RoHS | Environmentally Friendly Use Period = 50 years   |
|            | For information on hazardous substances, refer to the manufacturer's declaration available under "Downloads" |

## Drawings

# Device connector, rear mounting - SACC-DSI-M8FS-4CON-M10-L180 SH - 1456129

Dimensional drawing

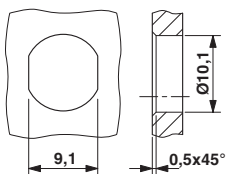

Schematic diagram

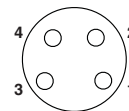

Pin assignment M8 socket, 4-pos., view female side

Mounting panel with feed-through hole

Drilling diagram

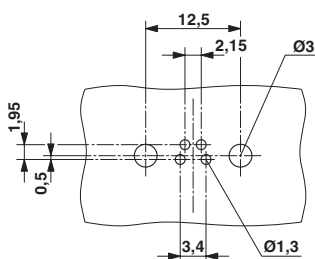

Dimensional drawing

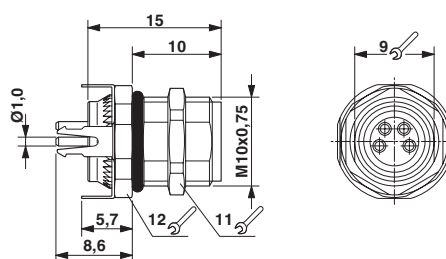

Drilling diagram

M8 flush-type socket

## Classifications

### eCl@ss

|               |          |
|---------------|----------|
| eCl@ss 10.0.1 | 27440102 |
| eCl@ss 11.0   | 27440102 |
| eCl@ss 4.0    | 27140800 |
| eCl@ss 4.1    | 27140800 |
| eCl@ss 5.0    | 27143400 |
| eCl@ss 5.1    | 27143400 |
| eCl@ss 6.0    | 27279200 |
| eCl@ss 7.0    | 27440103 |
| eCl@ss 9.0    | 27440102 |

### ETIM

|          |          |
|----------|----------|
| ETIM 4.0 | EC002061 |
| ETIM 6.0 | EC002061 |
| ETIM 7.0 | EC002635 |

### UNSPSC

|               |          |
|---------------|----------|
| UNSPSC 6.01   | 31251501 |
| UNSPSC 7.0901 | 31251501 |
| UNSPSC 11     | 31251501 |

# Device connector, rear mounting - SACC-DSI-M8FS-4CON-M10-L180 SH - 1456129

## Classifications

### UNSPSC

|              |          |
|--------------|----------|
| UNSPSC 12.01 | 31251501 |
| UNSPSC 13.2  | 39121413 |
| UNSPSC 18.0  | 39121413 |
| UNSPSC 19.0  | 39121413 |
| UNSPSC 20.0  | 39121413 |
| UNSPSC 21.0  | 39121400 |

## Approvals

### Approvals

#### Approvals

UL Recognized / cUL Recognized / EAC / cULus Recognized

#### Ex Approvals

### Approval details

|                            |   |   |               |
|----------------------------|---|---|---------------|
| UL Recognized              |  | <a href="http://database.ul.com/cgi-bin/XYV/template/LISEXT/1FRAME/index.htm">http://database.ul.com/cgi-bin/XYV/template/LISEXT/1FRAME/index.htm</a> | FILE E 221474 |
| Nominal voltage UN         | 30 V  |   |               |
| Nominal current IN         | 4 A   |   |               |
| mm <sup>2</sup> /AWG/kcmil | 24  |   |               |

|                            |   |   |               |
|----------------------------|---|---|---------------|
| cUL Recognized             |  | <a href="http://database.ul.com/cgi-bin/XYV/template/LISEXT/1FRAME/index.htm">http://database.ul.com/cgi-bin/XYV/template/LISEXT/1FRAME/index.htm</a> | FILE E 221474 |
| Nominal voltage UN         | 30 V  |   |               |
| Nominal current IN         | 4 A   |   |               |
| mm <sup>2</sup> /AWG/kcmil | 24  |   |               |

|     |   |         |
|-----|---|---------|
| EAC |  | B.01687 |
|-----|---|---------|

## Device connector, rear mounting - SACC-DSI-M8FS-4CON-M10-L180 SH - 1456129

### Approvals

cULus Recognized



Phoenix Contact 2022 © - all rights reserved  
<http://www.phoenixcontact.com>

PHOENIX CONTACT GmbH & Co. KG  
Flachsmarktstr. 8  
32825 Blomberg  
Germany  
Tel. +49 5235 300  
Fax +49 5235 3 41200  
<http://www.phoenixcontact.com>

单击下面可查看定价，库存，交付和生命周期等信息

[>>Phoenix Contact \(菲尼克斯\)](#)