

# Flush-type connector - SACC-DSI-M 8FS-4CON-M12/0,5 - 1453452

Please be informed that the data shown in this PDF Document is generated from our Online Catalog. Please find the complete data in the user's documentation. Our General Terms of Use for Downloads are valid (<http://download.phoenixcontact.com>)



Sensor/actuator flush-type socket, 4-pos., M8, rear/screw mounting with M12 thread, with 0.5 m TPE litz wire, 4 x 0.25 mm<sup>2</sup>



## Key commercial data

Packing unit	0
Minimum order quantity	1
Catalog page	Page 39 (PC-2011)
GTIN	 4 046356 554404
Custom tariff number	85444290
Country of origin	GERMANY

## Technical data

### General data

Rated current at 40°C	4 A
Rated voltage	30 V
Number of positions	4
Volume resistance	≤ 3 mΩ
Insulation resistance	≥ 100 MΩ
Length of cable	0.5 m
Ambient temperature (operation)	-25 °C ... 85 °C (female)

### General characteristics

Standards/regulations	M8 plug-in connector IEC 61076-2-104
Coding	A - standard
Surge voltage category	II
Pollution degree	3
Degree of protection	IP67
Contact material	Cu alloy
Contact surface material	Au
Contact carrier material	PUR / PA66
Material, knurls	Nickel-plated brass

# Flush-type connector - SACC-DSI-M 8FS-4CON-M12/0,5 - 1453452

## Technical data

### General characteristics

Sealing material	Viton
Mounting type	Rear mounting M12 x 1
Connection method	Individual wires
Status display	No

### Conductor data

Cable type	TPE litz wire
Conductor cross section	0.25 mm <sup>2</sup>
AWG signal line	24
Conductor structure signal line	14x 0.15 mm
Core diameter including insulation	1.15 mm ±0.07 mm
Thickness, insulation	0.21 mm
Wire colors	brown, white, blue, black
Material conductor insulation	TPE
Conductor material	Tin-plated Cu litz wires
Insulation resistance	≥ 20 MΩ*km
Conductor resistance	≥ 80 Ω/km
Nominal voltage, conductor	300 V
Test voltage, conductor	2000 V AC
Ambient temperature (operation)	-25 °C ... 90 °C (cable, fixed installation)

## Classifications

### eclass

eCl@ss 4.0	27250313
eCl@ss 4.1	27250313
eCl@ss 5.0	27260701
eCl@ss 5.1	27260701
eCl@ss 6.0	27279220
eCl@ss 7.0	27440103

### etim

ETIM 3.0	EC002061
ETIM 4.0	EC002061

### unspsc

UNSPSC 6.01	31251501
UNSPSC 7.0901	31251501
UNSPSC 11	31251501
UNSPSC 12.01	31251501
UNSPSC 13.2	31251501

# Flush-type connector - SACC-DSI-M 8FS-4CON-M12/0,5 - 1453452

## Approvals

Approvals

Approvals

GOST

Ex Approvals

Approvals submitted

## Approval details



## Drawings

### Schematic diagram

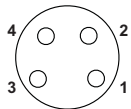

Pin assignment M8 socket, 4-pos., view female side

### Dimensioned drawing

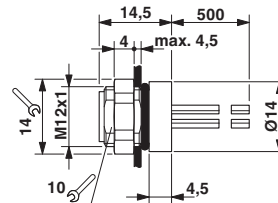

M8 flush-type socket

### Dimensioned drawing

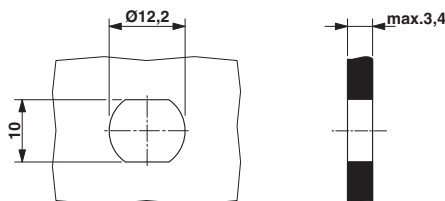

Housing cutout for M8 flush-type connector, socket, one-section

### Circuit diagram

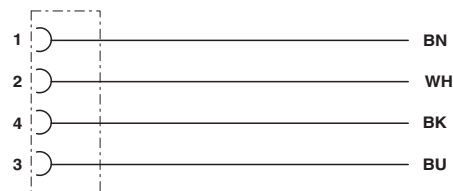

Contact assignment of M8 plugs/sockets

单击下面可查看定价，库存，交付和生命周期等信息

[>>Phoenix Contact\(菲尼克斯\)](#)