

Electronic housing - ME MAX 22,5 U-U1 BK - 2279541

Please be informed that the data shown in this PDF Document is generated from our Online Catalog. Please find the complete data in the user's documentation. Our General Terms of Use for Downloads are valid (<http://download.phoenixcontact.com>)



Electronics housing, consisting of: left and right housing shells, front plate, transparent cover, metal foot catch and spring, open housing, 4-pos. (1 x 4-pos.), width: 22.5 mm

The illustration shows the housing versions

Product Features

- ✓ Plug-in connection with screw, spring-cage or fast connection technology
- ✓ Labels for additional labeling as an option
- ✓ DIN rail bus connector as an option
- ✓ Large front surface for high-pos. plugs or operating and setting elements
- ✓ Large PCB surface despite compact housing dimensions
- ✓ The fitted cover is easy to adapt and print
- ✓ Easy module replacement without interrupting the contact chain
- ✓ Functional earth ground contact as an option
- ✓ Fixed or plug-in connection technology can be combined on up to three connection levels, with different pitches
- ✓ Transparent front cover can be swiveled



Key commercial data

Packing unit	1 1
Minimum order quantity	50 1
Custom tariff number	85472000
Country of origin	Germany

Classifications

eCl@ss

eCl@ss 4.0	27180401
eCl@ss 4.1	27180401
eCl@ss 5.0	27180506
eCl@ss 5.1	27180506

Electronic housing - ME MAX 22,5 U-U1 BK - 2279541

Classifications

eCl@ss

eCl@ss 6.0	27180802
eCl@ss 7.0	27182702
eCl@ss 8.0	27182702

ETIM

ETIM 2.0	EC001031
ETIM 3.0	EC001031
ETIM 4.0	EC001031

UNSPSC

UNSPSC 6.01	31261501
UNSPSC 7.0901	31261501
UNSPSC 11	31261501
UNSPSC 12.01	31261501
UNSPSC 13.2	31261501

Approvals

Approvals

Approvals

UL Recognized

Ex Approvals

Approvals submitted

Approval details

UL Recognized 

Accessories

Accessories

Ground contact

Electronic housing - ME MAX 22,5 U-U1 BK - 2279541

Accessories

Electronic housing - ME FE-CONTACT - 2908294



Functional earth ground contact, for intermediate elements.

Drawings

Dimensioned drawing

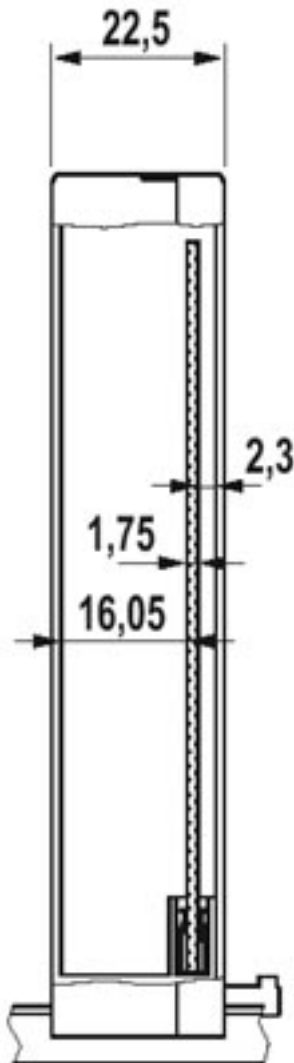

Dimensioned drawing

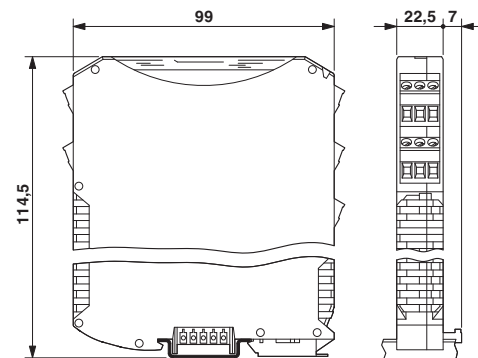

Electronic housing - ME MAX 22,5 U-U1 BK - 2279541

Drilling diagram

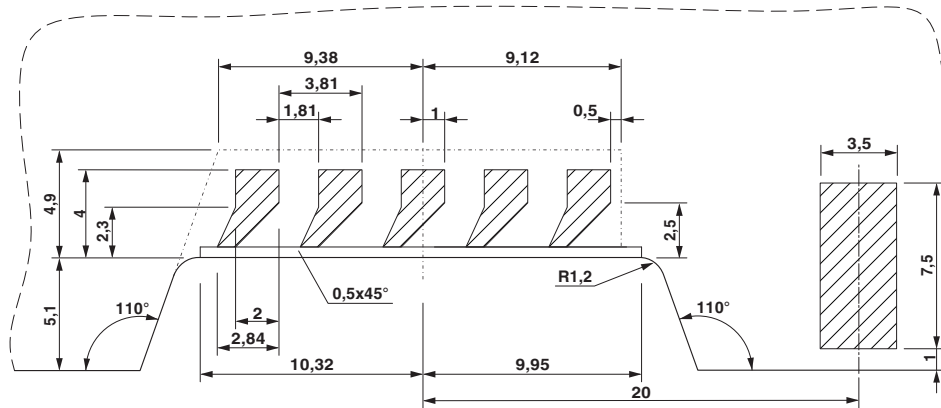

Detailed dimensional drawing of the DIN rail connector contact pads

Electronic housing - ME MAX 22,5 U-U1 BK - 2279541

Explosion drawing

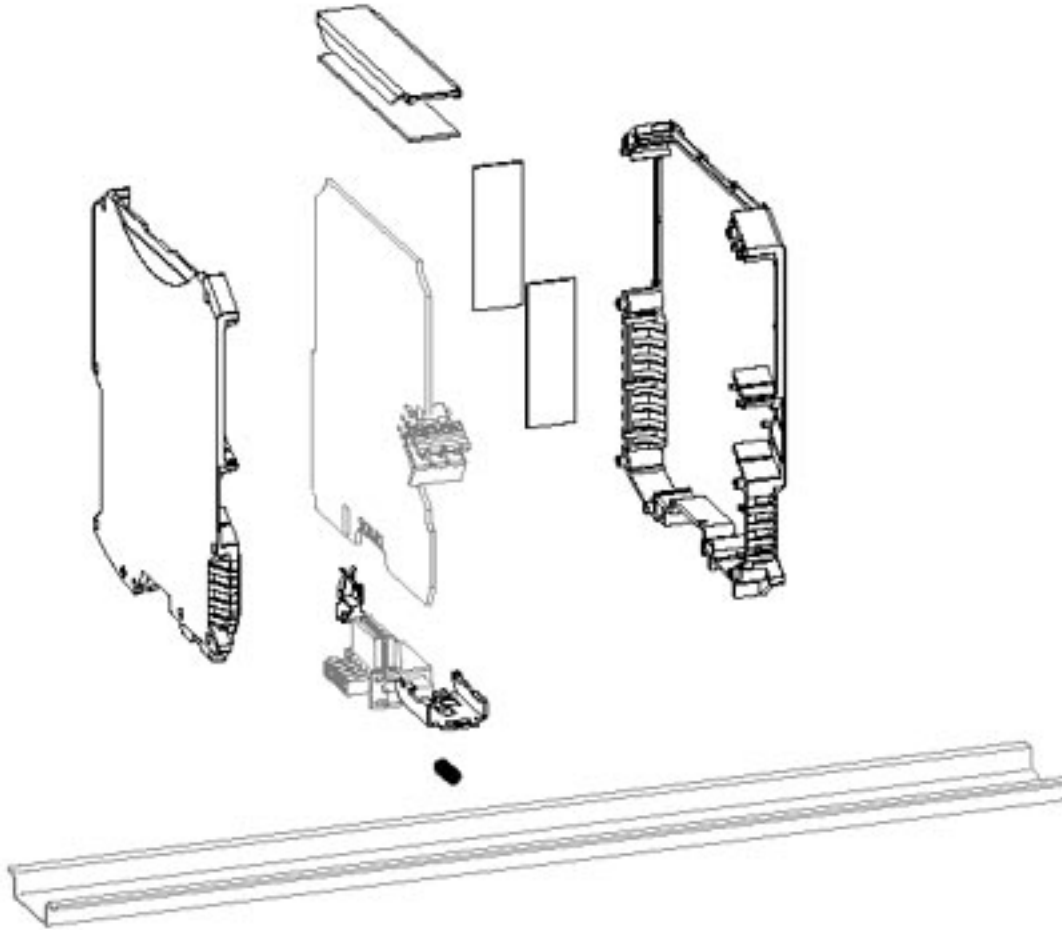

The illustration shows a version of the product (open housing) with accessories

Electronic housing - ME MAX 22,5 U-U1 BK - 2279541

Dimensioned drawing

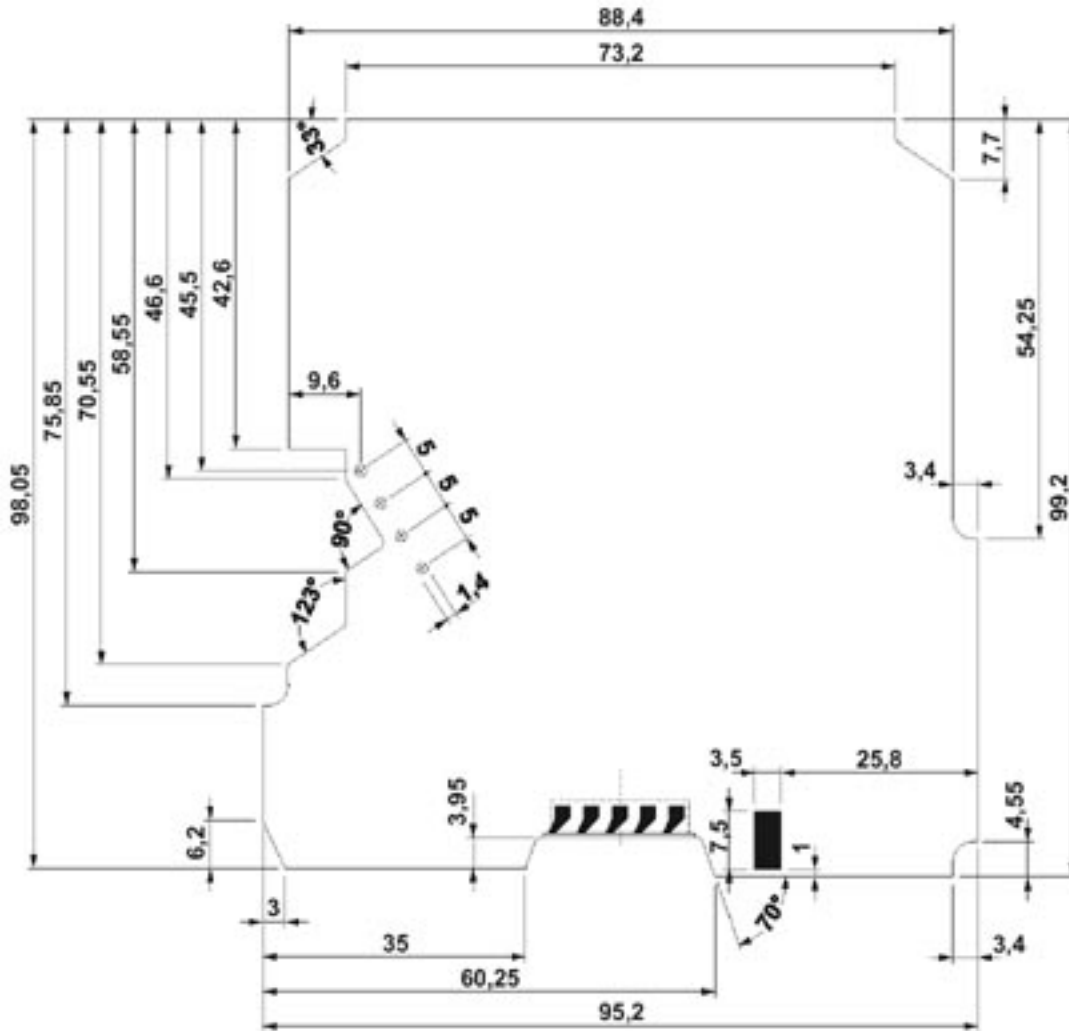

Dimensional drawing of the ME MAX U-U1 printed circuit board for plug connection (MSTBO), view: component side

单击下面可查看定价，库存，交付和生命周期等信息

[>>Phoenix Contact\(菲尼克斯\)](#)