

## Current transformer - PACT MCR-V2-6315- 95-1500-5A-1 - 2277242

Please be informed that the data shown in this PDF Document is generated from our Online Catalog. Please find the complete data in the user's documentation. Our General Terms of Use for Downloads are valid (<http://phoenixcontact.com/download>)



Window-type current transformer, 1,500 A AC primary current; 5 A AC secondary current; accuracy class 1; 10 VA rated power

### Product Features

- Primary rated current I<sub>pn</sub>: 0 ... (200 ... 2500) A
- Circular conductor dimensions: Ø 53 mm
- Rail dimensions: 63 x 15 mm, 2x 50 x 10 mm, 40 x 40 mm



### Key commercial data

Packing unit	1 pc
Custom tariff number	85043129
Country of origin	Germany

### Technical data

#### Dimensions

Primary round conductor (diameter)	53 mm
Primary round conductor (width)	63 mm
Primary round conductor (height)	15 mm
Note on dimensions	2
Primary round conductor (width)	50 mm
Primary round conductor (height)	10 mm
Width	30 mm
Height	121 mm
Depth	95 mm
Width with alternative assembly	95 mm
Height with alternative assembly	121 mm
Depth with alternative assembly	30 mm

# Current transformer - PACT MCR-V2-6315- 95-1500-5A-1 - 2277242

## Technical data

### Ambient conditions

Ambient temperature (operation)	-25 °C ... 40 °C
Ambient temperature (storage/transport)	-25 °C ... 40 °C

### Input data

Thermal rated short-time current	$I_{th} = 60 * I_n$
Rated surge current	$I_{dyn} = 2.5 * I_{th}$
Rated frequency: Standard converter	50 Hz ... 60 Hz
Surge current limitation factor	FS 5
Rated power	10 VA
Primary rated current $I_{pn}$	0 A ... 1500 A
Secondary rated current $I_{sn}$	5 A AC

### General

Converter type	Plug-on converters
Class	1
Can be calibrated	no
Rated insulation voltage	1 kV
Test voltage input/output	3 kV (50 Hz, 1 min.)
Standards/regulations	IEC 60044-1
Color	black
Housing material	Polyamide PA fiberglass reinforced

## Classifications

### eCl@ss

eCl@ss 4.0	27210902
eCl@ss 4.1	27210902
eCl@ss 5.0	27210902
eCl@ss 5.1	27210902
eCl@ss 6.0	27210902
eCl@ss 7.0	27210902
eCl@ss 8.0	27210902

### ETIM

ETIM 2.0	EC001505
ETIM 3.0	EC001505
ETIM 4.0	EC002048
ETIM 5.0	EC002048

# Current transformer - PACT MCR-V2-6315- 95-1500-5A-1 - 2277242

## Classifications

### UNSPSC

UNSPSC 6.01	30211501
UNSPSC 7.0901	39121019
UNSPSC 11	39121006
UNSPSC 12.01	39121006
UNSPSC 13.2	39121006

## Drawings

Dimensioned drawing

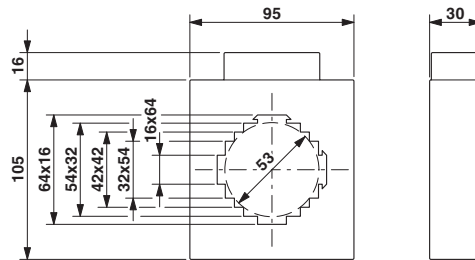

单击下面可查看定价，库存，交付和生命周期等信息

[>>Phoenix Contact \(菲尼克斯\)](#)