

# Flush-type connector - SACC-DSI-M8FS-8CON-M10/0,5 - 1424229

Please be informed that the data shown in this PDF Document is generated from our Online Catalog. Please find the complete data in the user's documentation. Our General Terms of Use for Downloads are valid (<http://download.phoenixcontact.com>)



Sensor/actuator flush-type socket, 8-pos., M8, rear/screw mounting with M10 fastening thread, with 0.5 m TPE litz wire, 8 x 0.14 mm<sup>2</sup>



## Key commercial data

Packing unit	0
Minimum order quantity	1
GTIN	 4 046356 712408
Custom tariff number	85366990
Country of origin	GERMANY

## Technical data

### General data

Rated current at 40°C	1.5 A
Rated voltage	30 V
Number of positions	8
Volume resistance	≤ 3 mΩ
Insulation resistance	≥ 100 MΩ
Length of cable	0.5 m
Ambient temperature (operation)	-25 °C ... 85 °C

### General characteristics

Standards/regulations	M8 plug-in connector IEC 61076-2-104
Surge voltage category	II
Pollution degree	3
Degree of protection	IP67
Contact material	Cu alloy
Contact surface material	Au
Contact carrier material	PUR / PA66
Material, knurls	Zinc die-cast, nickel-plated
Mounting type	Rear mounting M10
Connection method	Individual wires

# Flush-type connector - SACC-DSI-M8FS-8CON-M10/0,5 - 1424229

## Technical data

### General characteristics

Status display	No
----------------	----

### Conductor data

Cable type	PVC litz wire
AWG signal line	26
Wire colors	white, brown, green, yellow, gray, pink, blue, red
Conductor material	Tin-plated Cu litz wires
Ambient temperature (operation)	-25 °C ... 85 °C

## Classifications

### ETIM

ETIM 3.0	EC002061
ETIM 4.0	EC002635
ETIM 5.0	EC002635

### UNSPSC

UNSPSC 11	31251501
UNSPSC 12.01	31251501
UNSPSC 13.2	31251501
UNSPSC 6.01	31251501
UNSPSC 7.0901	31251501

### eCl@ss

eCl@ss 4.0	27140815
eCl@ss 4.1	27140815
eCl@ss 5.0	27143423
eCl@ss 5.1	27143423
eCl@ss 6.0	27143423
eCl@ss 7.0	27449001

## Drawings

### Dimensioned drawing

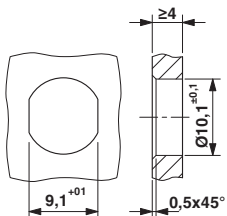

### Schematic diagram

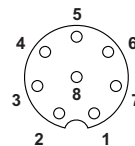

Connector pin assignment of M8 socket, 8-pos., view of socket side

Mounting panel with feed-through hole



单击下面可查看定价，库存，交付和生命周期等信息

[>>Phoenix Contact \(菲尼克斯\)](#)