

Printed-circuit board connector - MKDSO 2,5/ 3-R - 1707218

Please be informed that the data shown in this PDF Document is generated from our Online Catalog. Please find the complete data in the user's documentation. Our General Terms of Use for Downloads are valid (<http://download.phoenixcontact.com>)



PCB terminal block, Nominal current: 24 A, Nom. voltage: 400 V, Pitch: 5 mm, Number of positions: 3, Connection method: Screw connection, Mounting: Soldering, Conductor/PCB connection direction: 0 °, Color: green, Article with lateral pin exit

Product Features

- PCB terminal block for ME/ME MAX electronics housing
- PCB terminal block orthogonal to the PCB
- 5 mm pitch



Key commercial data

| | |
|------------------------|---|
| Packing unit | 1 PCE |
| Minimum order quantity | 50 PCE |
| GTIN |  4 017918 136802 |
| Custom tariff number | 85369010 |
| Country of origin | GERMANY |

Technical data

| | |
|--------------|---------------------------------------|
| Product type | Printed circuit board terminal |
| Approval | CSA |
| Approval | UL Recognized |
| Approval | VDE report with production monitoring |
| Approval | cUL Recognized |
| Approval | GOST |
| Approval | CCA |
| Approval | IECEE CB Scheme |
| Approval | GOST |
| Approval | cULus Recognized |

Printed-circuit board connector - MKDSO 2,5/ 3-R - 1707218

Technical data

| | |
|--------------------------|------------------|
| Rated voltage (IEC) | 400 |
| Rated current (IEC) | 24 |
| Mounting type | Soldering |
| Number of positions | 3 |
| Pitch | 5 mm |
| Levels | Single-level |
| Connection cross section | 2.5 |
| Connection technology | Screw connection |

Classifications

ETIM

| | |
|----------|----------|
| ETIM 2.0 | EC001031 |
| ETIM 3.0 | EC001031 |
| ETIM 4.0 | EC002643 |
| ETIM 5.0 | EC002643 |

UNSPSC

| | |
|---------------|----------|
| UNSPSC 11 | 31261501 |
| UNSPSC 12.01 | 31261501 |
| UNSPSC 13.2 | 31261501 |
| UNSPSC 6.01 | 31261501 |
| UNSPSC 7.0901 | 31261501 |

eCl@ss

| | |
|------------|----------|
| eCl@ss 4.0 | 27180401 |
| eCl@ss 4.1 | 27180401 |
| eCl@ss 5.0 | 27180506 |
| eCl@ss 5.1 | 27141190 |
| eCl@ss 6.0 | 27141190 |
| eCl@ss 7.0 | 27141190 |

Approvals

Approvals

Approvals

CSA / UL Recognized / VDE Gutachten mit Fertigungsüberwachung / cUL Recognized / GOST / CCA / IECCEB Scheme / GOST / cULus Recognized

Printed-circuit board connector - MKDSO 2,5/ 3-R - 1707218

Approvals

Ex Approvals

Approvals submitted

Approval details

| | | |
|---|-------|-------|
| CSA  | | |
| | B | D |
| mm ² /AWG/kcmil | 28-12 | 28-12 |
| Nominal current I _N | 10 A | 10 A |
| Nominal voltage U _N | 300 V | 300 V |

| | | |
|---|-------|-------|
| UL Recognized  | | |
| | B | D |
| mm ² /AWG/kcmil | 30-12 | 30-12 |
| Nominal current I _N | 20 A | 10 A |
| Nominal voltage U _N | 300 V | 300 V |

| | |
|---|---------|
| VDE Gutachten mit Fertigungsüberwachung  | |
| mm ² /AWG/kcmil | 0.2-2.5 |
| Nominal current I _N | 24 A |
| Nominal voltage U _N | 450 V |

| | | |
|--|-------|-------|
| cUL Recognized  | | |
| | B | D |
| mm ² /AWG/kcmil | 30-12 | 30-12 |
| Nominal current I _N | 20 A | 10 A |
| Nominal voltage U _N | 300 V | 300 V |

Printed-circuit board connector - MKDSO 2,5/ 3-R - 1707218

Approvals

| | |
|------|--|
| GOST | |
|------|--|

| | |
|--------------------------------|-------|
| CCA | |
| mm ² /AWG/kcmil | 2.5 |
| Nominal current I _N | 24 A |
| Nominal voltage U _N | 450 V |

| | |
|--------------------------------|-------|
| IECEE CB Scheme | |
| mm ² /AWG/kcmil | 2.5 |
| Nominal current I _N | 24 A |
| Nominal voltage U _N | 450 V |

| | |
|------|--|
| GOST | |
|------|--|

| | |
|------------------|--|
| cULus Recognized | |
|------------------|--|

Drawings

Drilling diagram

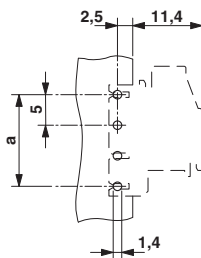

Dimensioned drawing

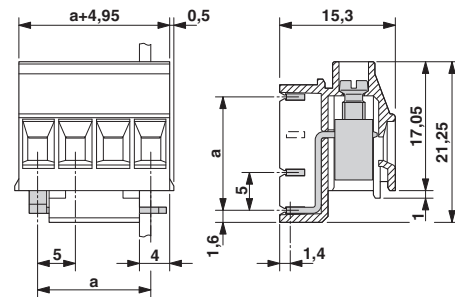

Printed-circuit board connector - MKDSO 2,5/ 3-R - 1707218

Schematic diagram

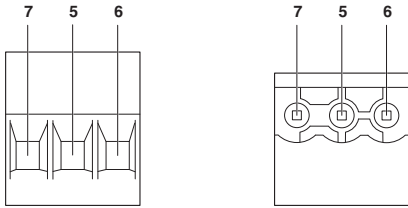

Schematic diagram

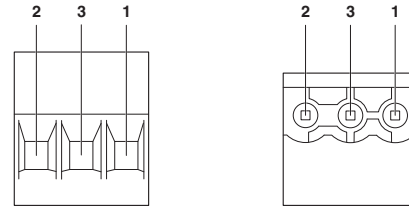

Pin assignment right

Pin assignment left

单击下面可查看定价，库存，交付和生命周期等信息

[>>Phoenix Contact\(菲尼克斯\)](#)