

Female test connector - PSBJ 4/15/6 BU - 0303354

Please be informed that the data shown in this PDF Document is generated from our Online Catalog. Please find the complete data in the user's documentation. Our General Terms of Use for Downloads are valid (<http://phoenixcontact.com/download>)



Female test connector, Color: blue

The figure shows the transparent version

Product Features

- The test socket PSBJ... is used in place of the normal bridge screw and ensures the voltage pick-off on a bridged group of terminals
- The test sockets are tailored to the special applications encountered in the power supply industry



Key Commercial Data

Packing unit	1 pc
Minimum order quantity	10 pc
GTIN	 4 017918 000462
Weight per Piece (excluding packing)	3.46 g
Custom tariff number	85366990
Country of origin	Poland

Technical data

Dimensions

Length	6 mm
Width	6 mm
Pin diameter	4.00 mm

General

Color	blue
Material	Brass

Female test connector - PSBJ 4/15/6 BU - 0303354

Technical data

Ambient temperature (operation)	-40 °C ... 80 °C
---------------------------------	------------------

Classifications

eCl@ss

eCl@ss 4.0	27141127
eCl@ss 4.1	27141127
eCl@ss 5.0	27141127
eCl@ss 5.1	27141111
eCl@ss 6.0	27141148
eCl@ss 7.0	27141148
eCl@ss 8.0	27440313

ETIM

ETIM 2.0	EC000897
ETIM 3.0	EC000897
ETIM 4.0	EC002255
ETIM 5.0	EC002255

UNSPSC

UNSPSC 6.01	30211812
UNSPSC 7.0901	39121410
UNSPSC 11	39121411
UNSPSC 12.01	39121411
UNSPSC 13.2	39121411

Approvals

Approvals

Approvals

EAC / EAC

Ex Approvals

Approvals submitted

Female test connector - PSBJ 4/15/6 BU - 0303354

Approvals

Approval details

EAC

EAC

Drawings

Dimensional drawing

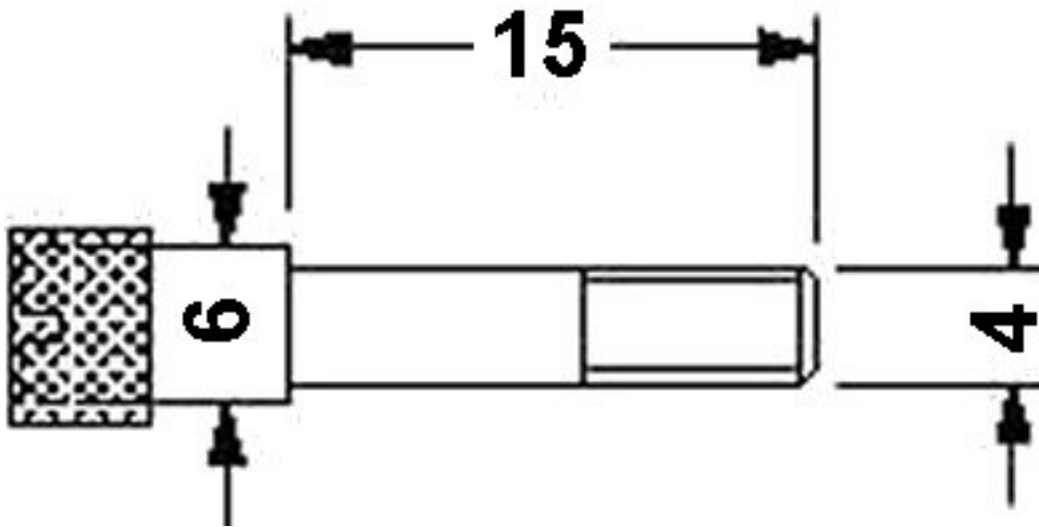

单击下面可查看定价，库存，交付和生命周期等信息

[>>Phoenix Contact\(菲尼克斯\)](#)