

Housing - HC-ADV-B10-SHFH-2STM20-EEE - 1408737

Please be informed that the data shown in this PDF Document is generated from our Online Catalog. Please find the complete data in the user's documentation. Our General Terms of Use for Downloads are valid (<http://download.phoenixcontact.com>)



HEAVYCON ADVANCE B10 box mounting base, for M6 screw locking, salt-water-resistant aluminum, with 2 x M20 thread, without surface coating



Key commercial data

Packing unit	1 1
Custom tariff number	85389099
Country of origin	China

Technical data

Dimensions

Height	68 mm
Width	45 mm
Length	105 mm

Ambient conditions

Schutzart Gehäuse (IP)	IP65
	IP68 (0.2 bar/24 h)
	IP69K
Ambient temperature (operation)	-40 °C ... 125 °C

General

Note	For contact inserts HC-B10, BB18, DD42, M, K8/24
Design	B10
Housing type	Box mounting bases
Locking type	Screw locking
Fixing screws	M6
No. of cable exits	2
Cable exit	Lateral

Housing - HC-ADV-B10-SHFH-2STM20-EEE - 1408737

Technical data

General

Screw connection	None
Type of the screw connection	2x M20
Housing material	Die-cast aluminum, salt water resistant
Housing surface material	Uncoated
Connection	To ensure optimum shielding, any insulating powder coating must be removed from the housing support area on the control cabinet panel

Classifications

eCl@ss

eCl@ss 4.0	27140816
eCl@ss 4.1	27140816
eCl@ss 5.0	27143424
eCl@ss 5.1	27143424
eCl@ss 6.0	27261203
eCl@ss 7.0	27440202
eCl@ss 8.0	27440202

ETIM

ETIM 4.0	EC000437
ETIM 5.0	EC000437

UNSPSC

UNSPSC 6.01	31261502
UNSPSC 7.0901	31261502
UNSPSC 11	31261502
UNSPSC 12.01	31261502
UNSPSC 13.2	31261502

Accessories

Accessories

Protective cover

Housing - HC-ADV-B10-SHFH-2STM20-EEE - 1408737

Accessories

Protective covers - HC-B 10-TMS-SD-IP50 - 1690749



HEAVYCON ADVANCE IP50 protective cover B10, for panel mounting side, with clip locking, with retaining cord, diameter of retaining cord eyelet 3 mm

Protective covers - HC-B 10-TMS-SD-IP65 - 1690781



HEAVYCON ADVANCE IP65 protective cover B10, for panel mounting side, with screw locking, with retaining cord, diameter of retaining cord eyelet 3 mm

Drawings

Dimensioned drawing

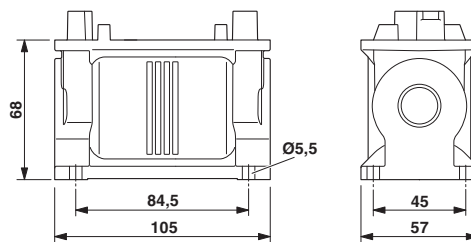

Dimensional drawing

单击下面可查看定价，库存，交付和生命周期等信息

[>>Phoenix Contact\(菲尼克斯\)](#)