

Cable lug - C-PCI 1,5/2 - 3240064

Please be informed that the data shown in this PDF Document is generated from our Online Catalog. Please find the complete data in the user's documentation. Our General Terms of Use for Downloads are valid (<http://download.phoenixcontact.com>)

Pin cable lug, red, 0.5 - 1.5 mm², L1=12 mm



Product Features

- Electrolytic tin plating
- Hard-soldered crimping zone for maximum pull-out forces
- Halogen-free
- 'EASY ENTRY' for easy and reliable conductor entry



Key commercial data

Packing unit	1 PCE
Minimum order quantity	100 PCE
Weight per Piece (excluding packing)	0.8 GRM
Custom tariff number	85369010
Country of origin	China

Technical data

Dimensions

Length (b)	22.5 mm
Length contact range	12 mm
Length of insulation sleeve (c)	10.5 mm
Inner dimension of the insulating collar (d)	4.1 mm
Inner diameter (f)	2 mm
Material thickness (g)	0.75 mm

Ambient conditions

Ambient temperature (operation)	-20 °C ... 105 °C
---------------------------------	-------------------

General

Cable lug - C-PCI 1,5/2 - 3240064

Technical data

General

Color	red
Stripping length	7 mm
Components	Halogen-free
Inflammability class according to UL 94	V2
Material	Copper

Classifications

eCl@ss

eCl@ss 4.0	27060701
eCl@ss 4.1	27060701
eCl@ss 5.0	27400201
eCl@ss 5.1	27400201
eCl@ss 6.0	27400201
eCl@ss 7.0	27400201
eCl@ss 8.0	27400201

ETIM

ETIM 2.0	EC000005
ETIM 3.0	EC000005
ETIM 4.0	EC001052
ETIM 5.0	EC001052

UNSPSC

UNSPSC 6.01	27113201
UNSPSC 7.0901	27121703
UNSPSC 11	27121703
UNSPSC 12.01	27121703
UNSPSC 13.2	27121703

Drawings

Cable lug - C-PCI 1,5/2 - 3240064

Dimensioned drawing

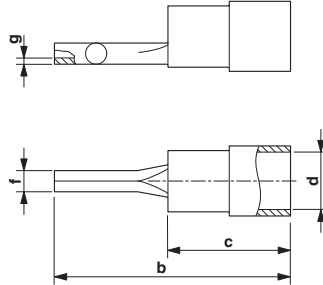

单击下面可查看定价，库存，交付和生命周期等信息

[>>Phoenix Contact\(菲尼克斯\)](#)